

PENDANT FIXTURE INSTALLATION INSTRUCTIONS

Please read carefully and save these instructions, as you may need them a later date.

CAUTION

Turn off the main power at the circuit breaker before installing the fixture, in order to prevent possible shock.

GENERAL

All electrical connections must be in accordance with local and National Electrical Code (N.E.C) standards. If you are unfamiliar with proper electrical wiring connections obtain the services of a qualified electrician.

Remove the fixture and the mounting package from the box and make sure that no parts are missing by referencing the illustrations on the installation instructions.

ASSEMBLY AND INSTALLATION

1. Thread the Thread tube(18) to Connector(17).
2. Attach the Tube(19), Tube cover(20), Flat washer(21), Rubber washer(22), Glass(28), Rubber washer(23), Flat washer(24) secure with Hex nut(25).
3. Attach the Cap(26) to the fixture then secure with the Finial(27).
4. Screw the Nipple(8) with the Hex Nut (13) and Key washer (12) to the Mounting Bar (6) . Attach Mounting Bar (6) to the Outlet Box(1) by the Mounting Screw(7). Screw the Collar Loop (10) to the Nipple (8).
5. Screw Loop(16) onto the fixture.
6. Link the Chain (15) onto the fixture, slide the Collar Ring (11) and Canopy (9) through the Chain. Link the other end of chain to the Collar Loop (10). Weave the fixture wire and ground wire through the chain to the Outlet box.
7. Pull out the outlet wire and ground wire from the Outlet Box. Make wire connections:
 ---Ribbed wire(w/o marking) from light to White Wire(2) from power source.
 ---Smooth wire(w/ marking) from light to Black Wire(3) from power source.
 ---Loop the Ground Wire(4) to Cross Bar(6) with a Green Screw(14).
8. Attach the Canopy (9) against the Outlet box, secure with the Collar ring (11).
9. Install bulbs:(bulbs not included)
 (Please don't exceed the maximum capacity that recommended on the Sockets).

INSTALLATION IS NOW COMPLETED.

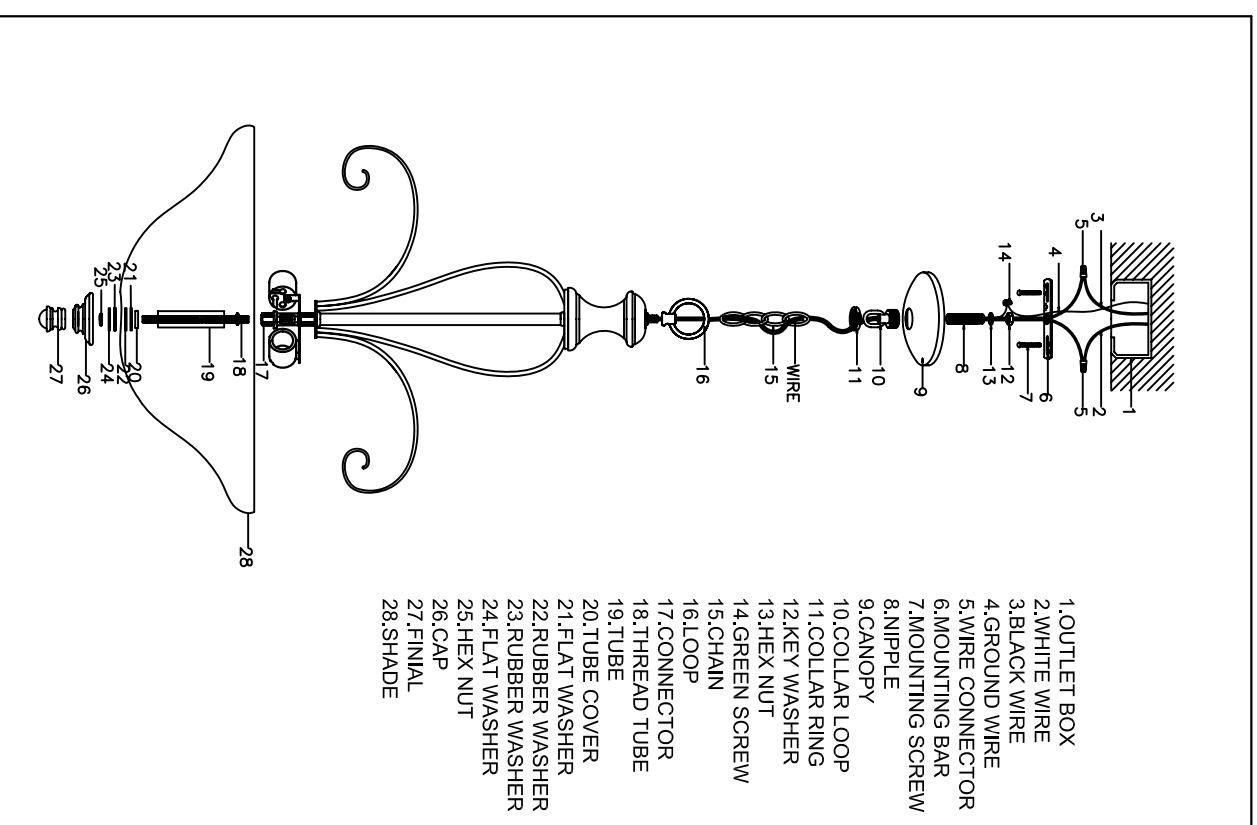

FOR ITEM 2001P