

Instruction: New Construction Housing

Model: WR-6RTLD30-T,WR-6RTLD30H-**T, WR-6RTLD30-X-**T, WR-6RTLD30H-X-**T, WR-6RTLD30-**EM,WR-6RTLD30-X-**EM,WR-6RTLD30H-**EM, WR-6RTLD30H-X-**EM series**

Important:

Read all instructions before installing.

For installation by a qualified electrician.

System is intended for installation in accordance with National Electric Code, and local regulations.

Consult with local inspector to assure compliance.

To reduce the risk of fire, electrical shock and injuries to persons, turn off power at main switch before installing or modifying the system.

Warning: (Risk of fire) do not install insulation within 3 inches of fixture sides, or junction box, or in a manner to entrap heat.

Retain instructions for future maintenance reference.

Overview:

Housings for this series are non-insulation contact, new construction type. Housing requires a trim which order separately.

Mounting:

1. Cut out a hole 6 7/8" in the drywall with template.
2. Install the mounting frame by adjustable mounting bar (see Fig.1).
3. Adjust the mounting frame to a proper height by loosening the nuts on both adjustable brackets and setting up the mounting frame. Make sure that the bottom edge of the mounting frame is flush with the finished ceiling. Tighten the nuts (see Fig.2).
4. Remove the spring latched door of the junction box and connect the fixture wires to the building wires: insert each supplied wire into appropriate junction box's connector. Connect brown/black fixture wire to hot, blue/white fixture wire to neutral and green fixture wire to ground (as Fig.3).
5. Place all wiring and connectors back in junction box and replace the junction box's door.
6. After installing in the drywall, if necessary, adjust fixture to the plaster frame for ceiling thickness by loosening hex screws that attach the round housing (as Fig.4).
7. Pull socket cup through hole of the mounting frame (as Fig.5).

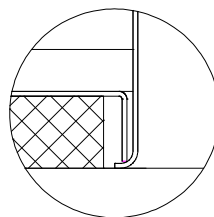
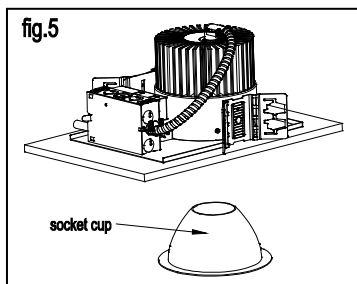
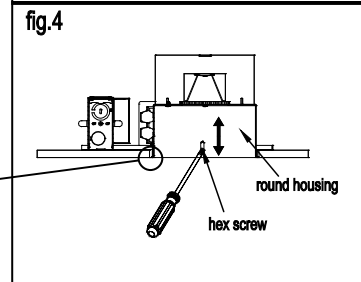
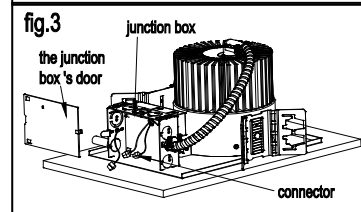
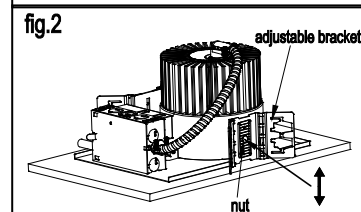
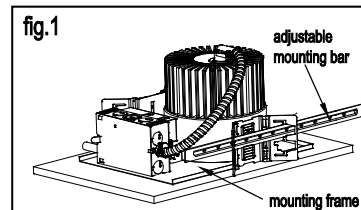

Use template supplied to make appropriate cutout for trim installation.

Model	Trim(order separately)	Cutout
WR-6RTLD30-**T, WR-6RTLD30H-**T, WR-6RTLD30-X-**T, WR-6RTLD30H-X-**T, WR-6RTLD30-**EM, WR-6RTLD30H-**EM, WR-6RTLD30-X-**EM, WR-6RTLD30H-X-**EM	WR-6R1LD-T	6 7/8"

Remark: ** indicate the CCT, 27=2700K, 30=3000K, 35=3500K, 40=4000K.