

**FLEXRAIL2 – CFL TRACK HEAD**

**SERIES HM-W218**

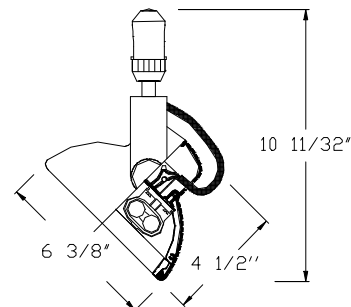
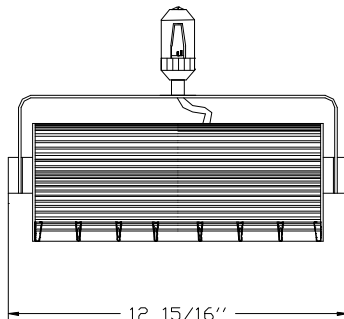

**Ordering Matrix**

Model	Lamp	Finish
<input type="text"/>	<input type="text"/>	<input type="text"/>
HM-W2	18	PT BZ

Ordering Example (model number – lamp – finish): HM-W218-PT

**Product Details**

<b>Description:</b>	Flexrail2 compatible CFL wall wash style track head for use in applications where comfortable energy efficient track mounted fixtures are desired.
<b>Materials:</b>	Extruded aluminum body with decorative horizontal fins. Clear aluminum reflector, clear aluminum louver, yoke and knob mounting and aiming adjustment system.
<b>Ballast:</b>	High power factor electronic ballast, 120V.
<b>Aiming:</b>	350° horizontal rotation and 180° vertical aiming with built-in yoke and hub mounting system. Two cast knobs (one on each side of fixture) allow for easy fixing and adjustment of track head aiming angle.
<b>Lamping:</b>	Two 18w twin-tube 4-pin CFL lamps. 2G11 base socket.
<b>Finish:</b>	Abrasion resistant platinum or bronze paint finish. PT = Platinum metal finish BZ = Designer Bronze metal finish
<b>Listing:</b>	UL & CUL Listed.

**Specification Features**

- Specification grade extruded aluminum track head with yoke and hub aiming adjustment system to assure precise directional adjustment.
- Compact Fluorescent lamps available in warm (2700K), neutral (3500K), and cool (4000K) colors, ordered separately.
- Straight forward design allows for tool less re-lamping of fixture.
- 5 year product warranty.

**BALLAST DATA**

Input Voltage	120V 50/60Hz
Operating Input Power (W)	39W
Input Current (A)	0.36 Amp
Power Factor	0.94
Protection: Open Lamp / Shorted Lamp	Yes
Ballast Min. Starting Temp.	-20°F