

R-F71 MR11/Bi-Pin Flood Solid Brass

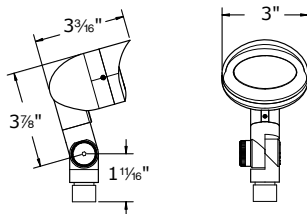

R-F71B-NAZ (NAZ) Natural Antique Bronze

- MR11 or T3 bi-pin lamp (20W, 30° [FTD] MR11 and 20W T3 included)
- Solid die-cast brass luminaire
- Oval and round light distributions
- Sleek design with soft edges
- 1/2" NPS knuckle with ABS stake included for quick installation
- Large easy to adjust knuckle (can be tightened with a 1/4" hex key)
- Potted knuckle to limit water and insect intrusion into luminaire
- Natural antique bronze patina finish (NAZ), standard
- Two oval reflectors included with the fixture for wide and medium wall washing
- Gore® waterproof vented fixture for high exposure areas
- Fixture can be mounted upright or upside down
- 12 volt UL 1838 listed luminaire is safe for wet locations up to 20W
- Fixed G4/GZ4 socket
- Shroud is lockable with hex key (included)
- 25' of 16 AWG SPT-2W cable and direct-bury wire connectors included
- Optional cast brass or powder coated cast aluminum stake
- Requires low voltage power supply, ordered separately



Solid Brass knuckle is easily adjustable and may be secured with an hex key. The knuckle is potted to limit moisture and insect intrusion.



OPTIONAL PARTS

MODEL NO	DESCRIPTION
R-A3A	Aluminum Stake Powder Coat
R-A3B	Natural Solid Brass Stake

Model	Material	Lamp	Natural Finishes	Powder Coat
R-F71	B Solid Brass	MR11 or	2000 hr, 20W	NAZ NAP PAB PBZ
			36° [BAB]	NAR NAS PDV POC
		T3 Bin-Pin	2000 hr, 20W	NOC UFB PRI PSD
			T3	NFC PTB PWB PTW

R-F71B - NAZ

MODEL NO	MATERIAL	FINISH
	B=Brass	Natural Antique Bronze

*We reserve the right to change specifications without notice.