

Washlet® S300

SW553 (Round Type)
SW554 (Elongated Type)

TOTO

1155 Southern Road
Morrow, GA 30260
(770) 282 8686

washlet®

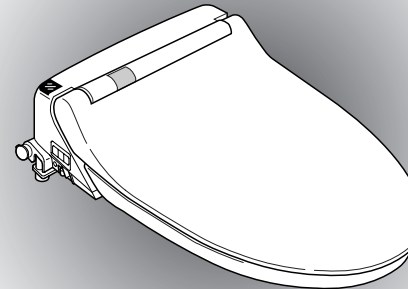

For your safety, be sure to inspect your S300 occasionally.

- Is the power plug abnormally hot?
- Is the power plug covered with dust?
- Is the outlet loose?
- Is your S300 operating differently than usual?

* In case anything is abnormal, contact TOTO USA to prevent a fire or an electrical shock.

0GU9151
2006.7.26
D06992

Thank you for your recent purchase of the TOTO® Washlet®.
Please read the enclosed information to ensure the safe
use of your product.



Important Safety Instructions	2	Introduction
Performance Features	6	
Name of Parts	8	
Before Using the Washlet®	10	Operation
How to Use the Washlet®	12	
For Best Results	14	
• Adjusting the Temperature	14	
• Deodorization	15	
To Conserve Energy	16	Maintenance
• Saving Power with the Timer	16	
• "Auto" Power Saving	17	
Caring For Your Washlet®	19	Troubleshooting
• Before cleaning the Washlet®	19	
• Daily Care and Maintenance	20	
• Thorough Cleaning	21	
• Other Care and Maintenance	23	
• Cleaning the Power Plug	23	
• Cleaning the Deodorizer Filter	24	
• Cleaning the Wand	24	
• Cleaning the Water Supply Filter	25	
Prevention of Damage from Freezing	27	Limited Warranty
Troubleshooting	30	
Specifications	34	
Limited Warranty	35	



Important Safety Instructions



Be sure to read the following safety instructions and use the product only as described in this manual. Please follow basic safety instructions to ensure the safe use of your product.

READ ALL INSTRUCTIONS BEFORE USING

The following symbols are used to indicate important safety instructions for the use of the product.

Symbol	Definition
	The  symbol indicates a prohibited use of the product. The symbol to the left means "Do not disassemble this product".
	This symbol is used to indicate a required step in the use of this product. The symbol to the left means "Always follow this precaution".

 DANGER			
Avoid direct contact with water	Do not wash the main unit or electrical plug with water or detergent. <ul style="list-style-type: none"> Doing so may cause fire or electrical shock. 		
Do not use this product in wet or damp places	Do not use this product in wet or damp places, such as a shower or bathtub area. <ul style="list-style-type: none"> Doing so may cause fire or electrical shock. 		
Do not disassemble	Never disassemble, repair or modify this product. <ul style="list-style-type: none"> Doing so may cause fire or electrical shock. 		
Do not handle the electrical plug with wet hands	Do not handle the electrical plug with wet hands. <ul style="list-style-type: none"> Doing so may cause electrical shock. 		
	Discontinue use of a malfunctioning product. <ul style="list-style-type: none"> If the following occurs, disconnect the electrical plug from the wall outlet, and close the water shutoff valve to prevent the flow of water. <table border="0" style="width: 100%; background-color: #f0f0f0;"> <tr> <td style="vertical-align: top;"> Possible malfunctions: <ul style="list-style-type: none"> Water leaks from either the main unit or the water pipes. The product makes a strange noise or emits a strange odor. </td> <td style="vertical-align: top;"> <ul style="list-style-type: none"> The product feels extremely hot. The product is cracked or broken. The product is smoking. </td> </tr> </table> Continued use of a malfunctioning product may result in fire or electrical shock or cause water damage. 	Possible malfunctions: <ul style="list-style-type: none"> Water leaks from either the main unit or the water pipes. The product makes a strange noise or emits a strange odor. 	<ul style="list-style-type: none"> The product feels extremely hot. The product is cracked or broken. The product is smoking.
Possible malfunctions: <ul style="list-style-type: none"> Water leaks from either the main unit or the water pipes. The product makes a strange noise or emits a strange odor. 	<ul style="list-style-type: none"> The product feels extremely hot. The product is cracked or broken. The product is smoking. 		

 DANGER	
	Avoid damaging the electrical cord or toilet seat cord. <div style="background-color: #333; color: white; padding: 5px; margin: 5px 0;"> Do not crack, bend, twist or pull the cords. Do not treat or heat the cords or place heavy objects on top of them </div> <ul style="list-style-type: none"> Use of damaged electrical cords may result in a short circuit, electrical shock or fire.
	Do not use a loose or faulty electrical outlet. <ul style="list-style-type: none"> Doing so may cause fire or electrical shock.
	This product should be used with 120V, 60Hz electrical current only. <ul style="list-style-type: none"> Use of multi-prong outlet adapters with this product may result in overheating or fire.
	Only use tap water or potable water (ground water). <ul style="list-style-type: none"> Use of water that is not safe for drinking may cause irritation or injury to the skin.
	Do not insert fingers or any other object into the warm air blower outlet. <div style="background-color: #333; color: white; padding: 5px; margin: 5px 0;"> Do not obstruct the outlet with clothing or your hand </div> <ul style="list-style-type: none"> Obstruction of the warm air blower outlet could result in injury or property damage.
	Improper use of heated toilet seats can result in a low-grade burn. <ul style="list-style-type: none"> When sitting on the heated toilet seat for extended periods of time, turn the temperature setting to OFF. Make sure that the temperature setting for the heated toilet seat has been set to the OFF position before being used by the following: <ul style="list-style-type: none"> Young children, the aged or users who cannot perform appropriate setting of the temperature. Sick or disabled users who do not have freedom of movement. Users who are on medication that causes drowsiness. Users that have consumed a great deal of alcohol or who are extremely tired and may fall asleep while using the toilet.
	Periodically remove dust and dirt from the electrical plug and make sure it is securely plugged into the wall outlet. <ul style="list-style-type: none"> Failure to do so may result in electrical shock or fire. Pull the plug out from the outlet and wipe clean with a dry cloth.
	Do not unplug by pulling on cord. To unplug, grasp the plug, not the cord. <ul style="list-style-type: none"> Pulling on the cord may cause damage and result in electrical shock or fire.
Removal of the electrical plug	When removing the main unit for cleaning, be sure to unplug the electrical cord from the wall outlet to prevent the risk of electrical shock.
Grounded Outlet	Make sure that a proper grounded (3 prong) outlet has been installed. <ul style="list-style-type: none"> Failure to install in a grounded outlet could result in electrical shock in the event of a malfunction or short circuit.



WARNING



Use only a mild dish detergent diluted with water to clean your Washlet. Do not use the following to clean the Washlet.

Toilet bowl cleaner, household cleaner, benzene, paint thinner, powdered cleanser, or nylon scrubbing pads.

- Use of any cleaning product other than diluted dish detergent may crack the plastic and cause injury to the user or may damage the hose resulting in water leakage.

Do not stand on or place heavy objects on top of the toilet.

- To avoid injury or damage to the toilet unit, do not stand on or place heavy objects on top of the toilet.

Do not raise the toilet seat or lid while objects are resting on top of the toilet.

- Lifting the toilet seat/cover with objects resting on them could cause the main unit to become detached, resulting in injury.

Do not bend or crush the water hose.

- Bending or crushing the water hose may result in water leakage.

To prevent sudden water leakage, do not remove the water filter and drain valve when the water shutoff valve is open.

- Refer to Page 25 for instructions on cleaning the water filter.
- Do not install base plate to Washlet when not attached to the toilet. Fire or damage may result.

Do not use this product while smoking.

- To avoid the risk of fire, do not smoke while using this product.



When not using the Washlet over an extended period of time, drain the water out of the hose and pull the electrical plug from the wall outlet.

- Water left standing in the toilet hose over an extended period of time could cause irritation to the skin. Refer to Page 27 for instructions on draining the hose.

If water leakage should occur, always close the water shutoff valve and then turn off the water.

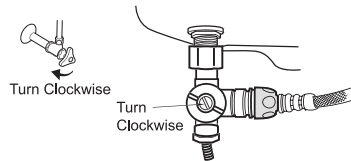

When installing the water drain valve with water filter, make sure that it is securely tightened in its proper position.

- Improper tightening of the water valve may result in water leakage.

Preventing damage due to frozen pipes and hoses.

- Frozen water pipes will cause the main unit and the pipes to break, resulting in water leakage.
- Regulate the room temperature to prevent the pipes and hoses from freezing during cold months. Refer to Page 27 for instructions on how to prevent frozen pipes



DANGER

To reduce the risk of electrocution:

1. Do not use while bathing.
2. Do not place or store products where it can fall or be pulled into tub or sink.
3. Do not place in or drop into water or other liquid.
4. Do not reach for a product that has fallen into water. Unplug immediately.



WARNING

To reduce the risk of burns, electrocution, fire or injury to persons:

1. Close supervision is necessary when this product is used by, on, or near children or invalids.
2. Use this product only for its intended use as described in this manual. Do not use attachments not recommended by the manufacturer.
3. Never operate this product if it has a damaged cord or plug, if it is not working properly, if it has been dropped or damaged, or dropped in water. Return the product to a service center for examination and repair.
4. Keep cord away from heated surfaces.
5. Never block the air openings of the product or place it on a soft surface, such as a bed or couch, where the air openings may be blocked. Keep the air openings free of lint, hair, and the like.
6. Never use while sleepy or drowsy.
7. Never drop or insert any object into any opening or hose.
8. Do not use outdoors or operate where aerosol (spray) products are being used or where oxygen is being administered.
9. Connect this product to a properly grounded outlet only. See Grounding Instructions.
10. Reservoir should be filled with water only.

Grounding Instructions

This product should be grounded. In the event of an electrical short circuit, grounding reduces the risk of electric shock by providing an escape wire for the electrical current. This product is equipped with a cord having a grounding wire with a grounding plug. The plug must be plugged into an outlet that is properly installed and grounded.



DANGER - Improper use of the grounding plug can result in a risk of electric shock.

If repair or replacement of the cord or plug is necessary, do not connect the grounding wire to either flat blade terminal. The wire insulation having an outer surface that is green with or without yellow stripes is the grounding wire.

Check with a qualified electrician or serviceman if the grounding wire instructions are not completely understood, or if in doubt as to whether the product is properly grounded.

This product is factory equipped with a specific electric cord and plug to permit connection to a proper electric circuit. Make sure that the product is connected to an outlet having the same configuration as the plug. No adapter should be used with this product. Do not modify the plug provided - if it will not fit in the outlet, have the proper outlet installed by a qualified electrician. If the product must be reconnected for use on a different type of electric circuit, the reconnection should be made by qualified service personnel.

If it is necessary to use an extension cord, use only a three wire extension cord that has a three blade grounding plug, and a three-slot receptacle that will accept the plug on the product. Replace or repair a damaged cord.

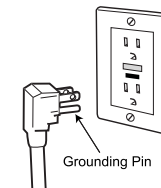

Save these instructions.

Performance Features

Washing Functions		Reference Page
Rear Cleansing	<ul style="list-style-type: none"> The wash alternates between a gentle spray and a forceful spray 70 times per second for a thorough rear wash while using less water. 	12
Soft Rear Cleansing		
Front Cleansing	<ul style="list-style-type: none"> The soft cleansing and front cleansing provide a soft, yet thorough, whirling flow of water. 	
Wand Position Adjustment	<ul style="list-style-type: none"> The wand's position can be adjusted forward and backward. 	12
Pressure Adjustment	<ul style="list-style-type: none"> The water pressure of the spray can be adjusted. 	12
Oscillating Wash	<ul style="list-style-type: none"> The wand moves back and forth, cleaning a wide area thoroughly. 	12
Pulsating Wash	<ul style="list-style-type: none"> A combination of soft/strong water pressure is used to wash. 	12

Amenities		Reference Page
Heated Toilet Seat	<ul style="list-style-type: none"> Warms the toilet seat. 	—
Heated Dryer	<ul style="list-style-type: none"> Dries the wet areas with warm air. 	13
Temperature Adjustment	<ul style="list-style-type: none"> The temperatures of the water, toilet seat and dryer can be adjusted 	14
Deodorizer	<ul style="list-style-type: none"> Removes odor from the toilet bowl. 	15
Remote Control	<ul style="list-style-type: none"> Allows for easy operation while seated. 	9
Soft Close Hinges	<ul style="list-style-type: none"> Gently lowers the toilet seat and lid. 	—
Seat Sensor	<ul style="list-style-type: none"> The sensor detects when someone sits on the toilet seat and activates all of the functions. 	13

Energy Saving Features		Reference Page
Timer Energy Saver	<ul style="list-style-type: none"> Once set, the toilet seat heater will shut off at the same time every day and save power. (the power-saving time can be set to 3, 6, or 9 hours.) 	16, 17
Auto Energy Saver	<ul style="list-style-type: none"> The time when the toilet is not used much is remembered and the toilet seat temperature is lowered automatically. 	17, 18
Power On/Off Button	<ul style="list-style-type: none"> When this button is set to "Off", the heated toilet seat and other features will be turned off allowing even more power savings. 	11

Cleaning Features		Reference Page
Easy Removal of the Toilet Seat and Lid	<ul style="list-style-type: none"> The toilet seat and lid can be removed easily, making clean-up easy. 	21, 22
One-Touch Washlet Removal	<ul style="list-style-type: none"> The Washlet can be removed with a single touch. The toilet can be cleaned all the way to the back, easily. 	23
Wand Self-cleaning	<ul style="list-style-type: none"> Before and after flushing, the wand tip is automatically cleaned very thoroughly. 	—
Full Wand Cleaning	<ul style="list-style-type: none"> Each time the wand extends or stores itself, it is cleaned thoroughly. 	—
Wand Cleaning Button	<ul style="list-style-type: none"> The wand will extend without spraying any hot water, so it can be cleaned very easily. 	24

Names of Parts

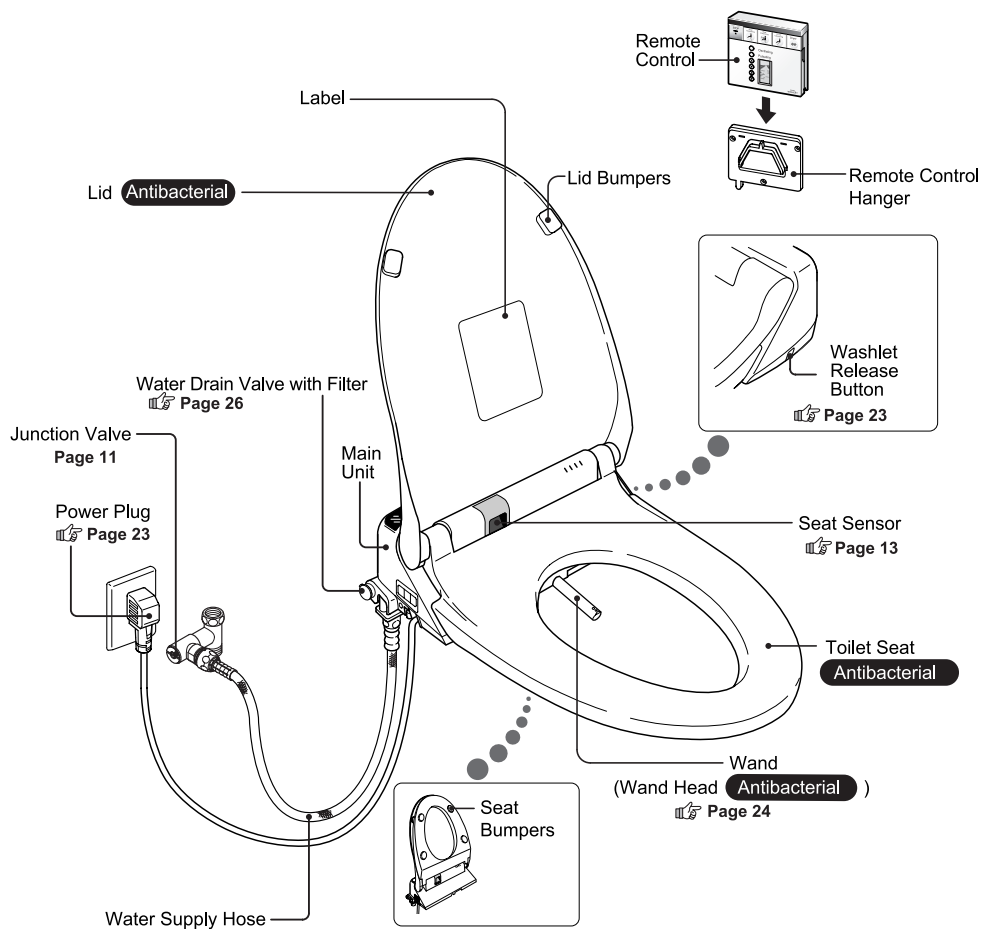

Main Unit Bottom

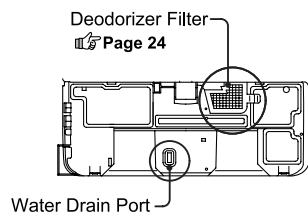

Main Unit Rear

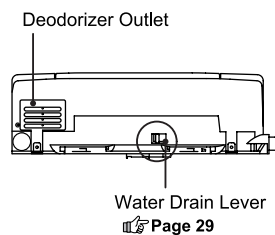

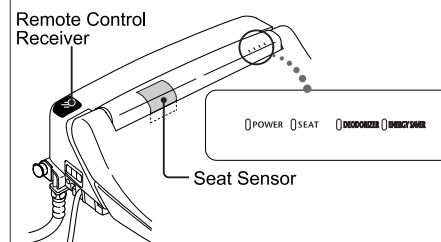

Main Unit Display

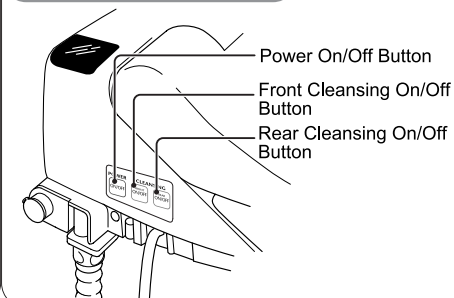

Main Unit Controls



Remote Control

These buttons   have imprints (bumps) for those with impaired vision.

With the cover closed

Antibacterial...The buttons have been treated with an antibacterial finish.

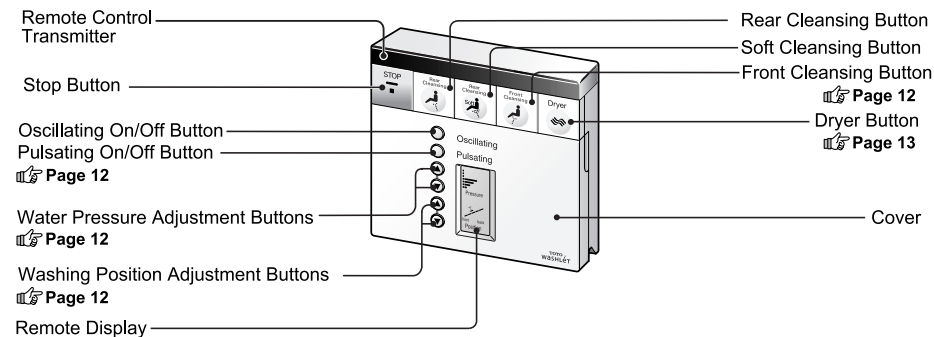

With the cover open

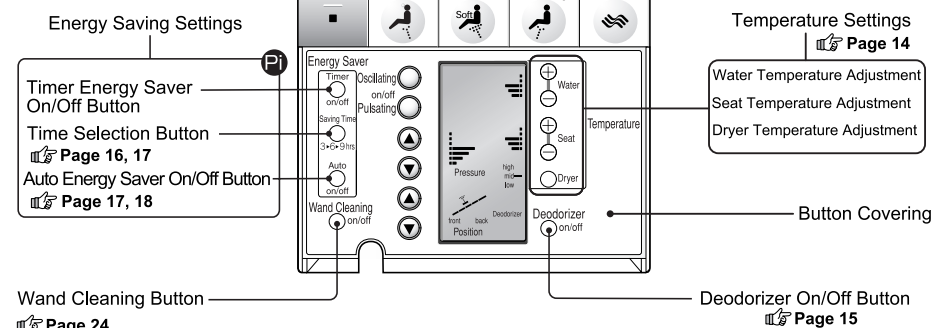

Pi...When the main unit receives a signal from the remote control, electronic tones will sound.

Before Using the Washlet®

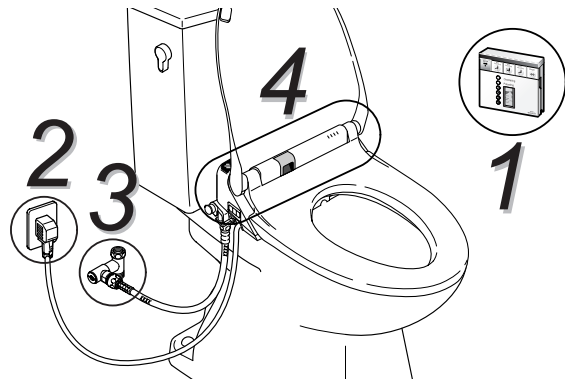

Preparation

1 Putting batteries in the remote control

- 1 Remove the remote control from the hanger.
 - Holding both sides of the remote control, lift it straight upwards.
- 2 Open the battery cover on the back of the remote control.
- 3 Insert 2 AA batteries.
- 4 Close the battery cover.

Tip 1

- When the batteries are set correctly in place, the remote control display will look like the picture at right.

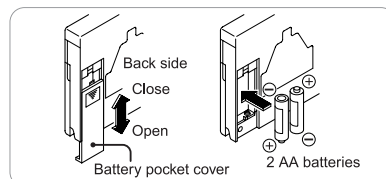
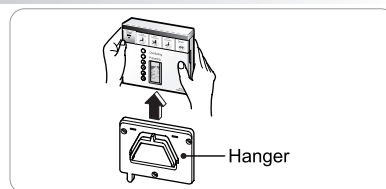

Remote Control Display



Batteries

- In order to keep batteries from splitting or leaking, please be sure to observe the following.
 - Use new batteries of the same type, for replacements.
 - Remove the batteries when not using the unit for long periods of time.
 - Do not use rechargeable batteries.

Tip 1

- When replacing the batteries or cleaning the unit, please turn the Power On/Off button on the main unit controls to Off. Otherwise, if you press a button, the Washlet could perform an unwanted action.
- When replacing the batteries, the On/Off settings for the Timer Energy Saver could be lost. Please reconfigure the settings after changing the batteries.



2 Insert the plug into the wall outlet.

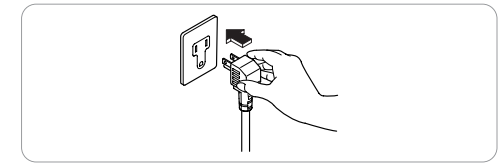

3 Opening the water shut-off valve and the junction valve.

- Turn on the junction valve with a flathead screwdriver.

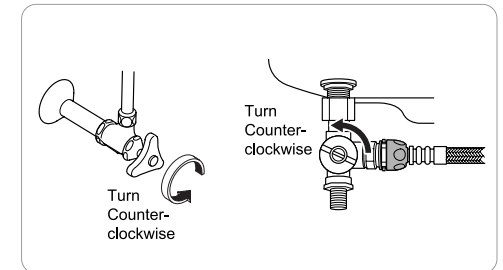

Check

4 Check the main unit display.

Are the "POWER" LED and the "SEAT" LED on the main unit display lit?

Tip 2

If the "POWER" LED is not lit, then it won't be possible to use all the functions. Press the  button on the main unit controls. (The LED will turn on.)

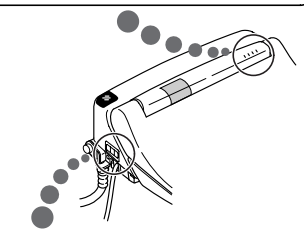
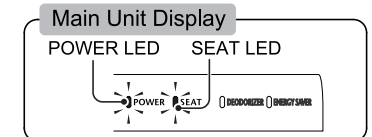

Main Unit Control

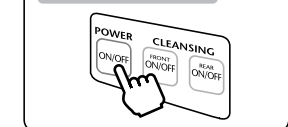

Tip 2

Please refer to "Adjusting the temperature" on page 14 concerning turning the toilet seat "on" or "off" or adjusting the temperature.

How to Use the Washlet®

Standard method of use

1 Sit on the toilet seat.

The seat sensor will go on and all of the functions will be available.

- In order to prepare to spray warm water, water will be sprayed into the toilet around the wand for several seconds.
- The Deodorizer will start.

2 Wash

Tip 1

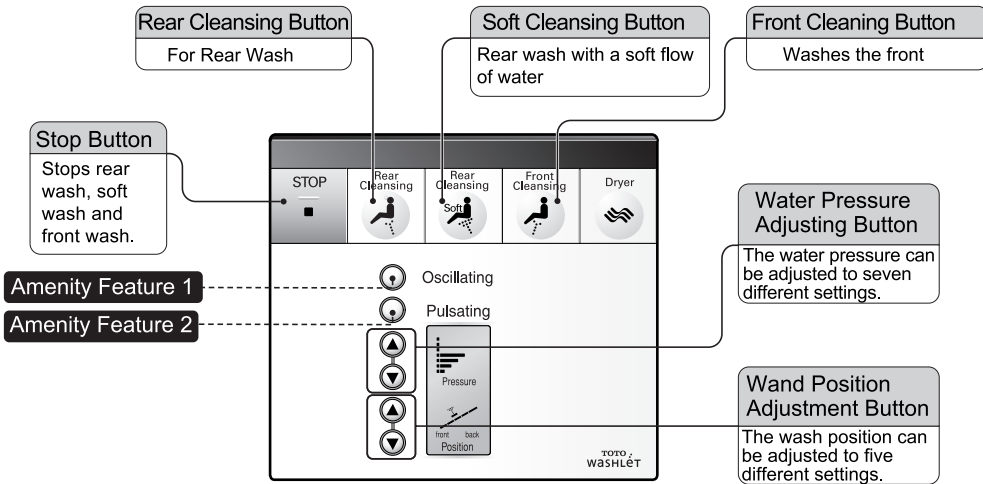

For Better Results

Amenity Feature 1 Oscillating

The wand moves back and forth, washing a broad area thoroughly.



- 1 Press the desired button
- 2 Press
 - Oscillating function will begin
- 3 Press once more
 - Oscillating function will end

Amenity Feature 2 Pulsating

Alternates hard and soft water pressure.



- 1 Press the desired button
- 2 Press
 - Pulsating function will begin
- 3 Press once more
 - Pulsating function will end

Tip 1 Please sit squarely on the toilet.
This will provide better cleansing and reduce any splashing.

3 Drying

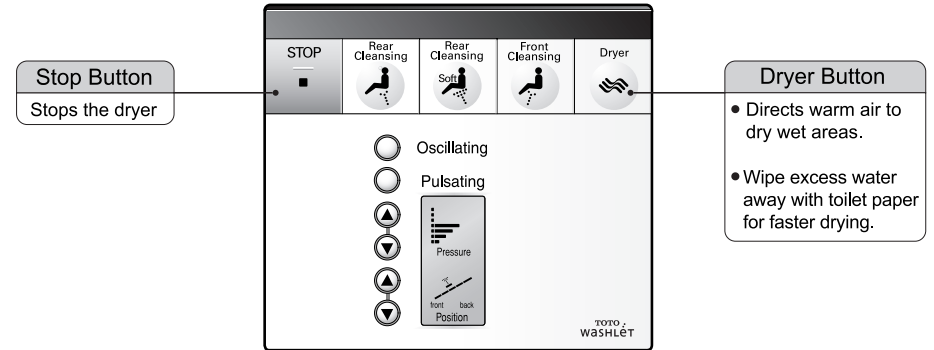

4 Standing up from the toilet

- The deodorizer will end after approximately 1 minute.

About the seat sensor

- The seat sensor detects when a person is seated on the toilet.
- Infrared light is emitted by the seat sensor as shown in the diagram.
- Based on the conditions of use, the seat sensor may not properly detect the user.



See Page 33

When the batteries in the remote control run out

- Wash by pressing the or buttons on the main unit controls.

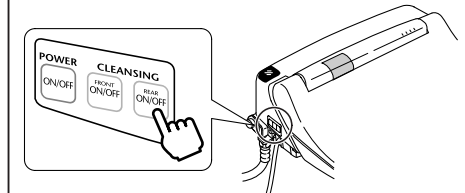

For Best Results

Adjusting the Temperature

- You can adjust the temperature of the spray water, the toilet seat and the dryer with the remote control.

1 Open the cover of the remote control.

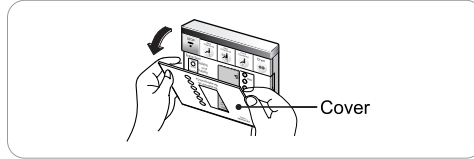

2 Adjust the Temperature

- Adjust the temperature of the spray water and the toilet seat using the \oplus \ominus buttons. To turn the feature off, press the \ominus button repeatedly until the temperature display turns off.
- The dryer temperature can be adjusted to one of 3 levels using the \oplus \ominus buttons.

The water temperature can be adjusted, (86 to 104°F) (30 to 40°C)

The toilet seat temperature can be adjusted (81 to 97°F) (27 to 36°C)

The dryer temperature can be adjusted. (3 levels)

Main Unit Display

When the toilet seat temperature is turned on, the "SEAT" LED will turn on.

This LED turns on.

Deodorizer

- Sitting down on the toilet seat begins deodorizer functions.

1 Sit down on the toilet seat

Deodorizer begins

- Make sure that the "Deodorizer" is set to turn on in the remote control. Open the remote cover and press the Deodorizer On/Off button.
- The "DEODORIZER" LED on the main unit display turns on.

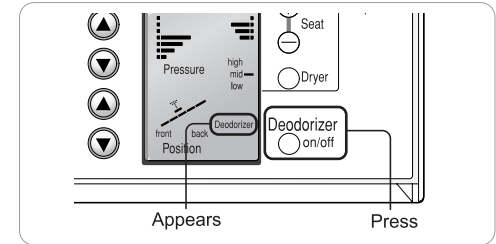
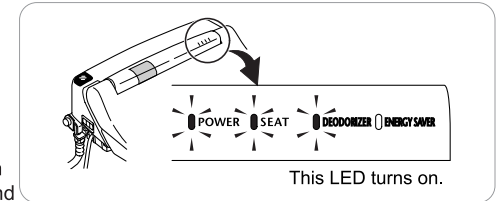

2 Stand up from the toilet seat

After 1 minute, it will stop automatically.

- The "DEODORIZER" LED on the main unit display will turn off.

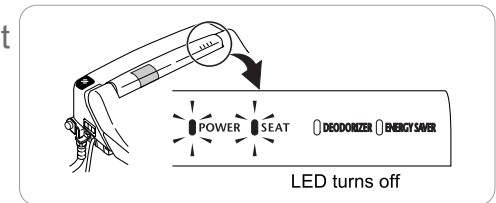

To Conserve Energy

Saving Power Using the Timer Energy Saver.

The Timer Energy Saver

- Once the settings are configured, power saving will take place every day at that time. During the timer power saving, the toilet seat heater will be turned off. The power saving times can be set to 3, 6, or 9 hours.
- For example, to save time from 1:00 a.m. until 7:00 a.m. (6 hours)

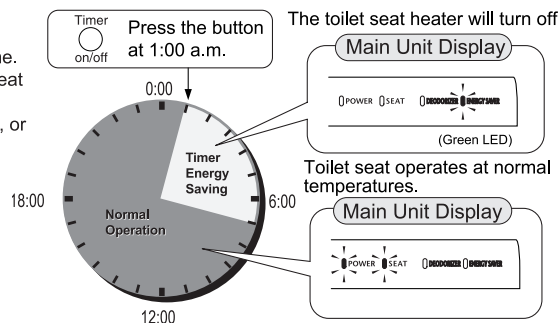

Example: When saving power from 1:00 a.m. until 7:00 a.m. (six hours)

- Press the button on the remote control at the time you to begin saving energy. (1:00 a.m.)

Energy Saving Will Begin

- The words "Timer" and "Saving Time: 6 hrs." will be displayed on the remote control display. **Tip 1**
- During timer energy saving, the "ENERGY SAVER" LED (green) will light up on the main unit display.

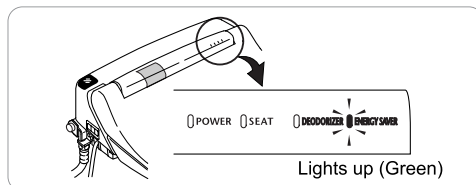
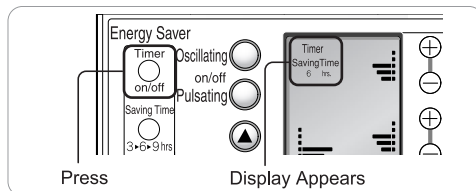

Changing the Energy Saving Period.

- Press **Tip 2**

- Each time the button is pressed, the display will change from 3 to 6 to 9. Select the desired time.
- When you change the energy saver time (3,6 or 9 hrs), the timer start time will reset.

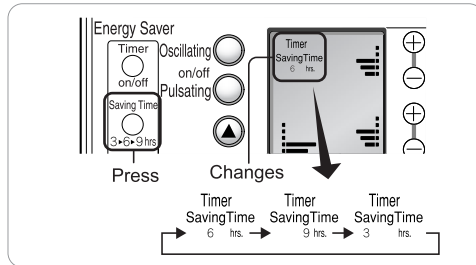

Tip 1 The Washlet can still be used, even while saving power. If someone sits on the toilet seat during the energy saving period, the toilet seat heater will turn on temporarily. It takes about 15 minutes for the seat to heat up.

Tip 2 When you want to change the timer energy saver start time, first shut off the timer energy saver and then press the button once again.

Turning Off the Timer Energy Saver

- Press **Timer energy saving is turned off.**

- The "Timer" and "Saving Time" display will turn off.
- The "POWER" and "SEAT" LEDs in the main unit display will turn on.

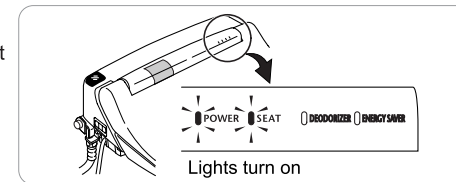
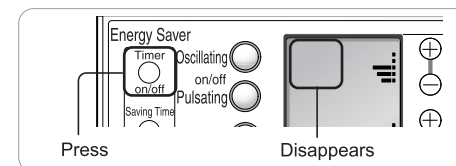

Auto Energy Saver

The Auto Energy Saver

- The Washlet will store the time periods when the toilet is used, find low use times and automatically lower the toilet seat temperature to save energy.

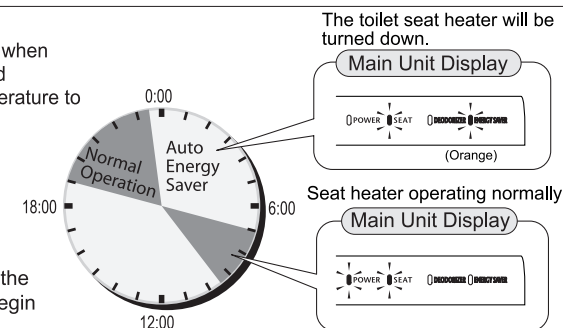

- If there are only two uses per week in the same time period, energy saving will begin as a low use time.

- Press the button.
- The word "Auto" will appear on the remote control.

The temperature of the toilet seat will be lowered automatically and energy saving will begin. **Tip 3, 4**

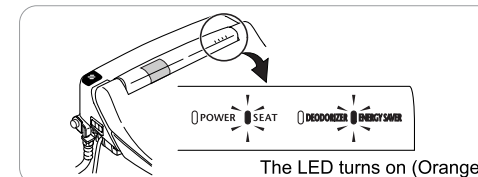
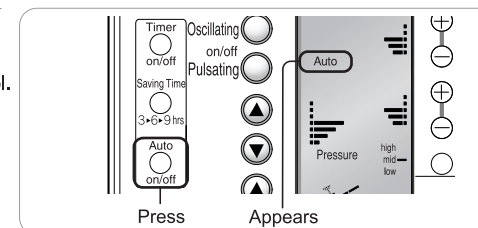

Tip 3 It takes two to three days to find the time periods in which the toilet is not used very often. During that period, power saving will take place gradually.

Tip 4 The Washlet can still be used, even during auto energy saving. If someone sits on the toilet seat during the energy saving period, the toilet seat heater will turn on temporarily.

To Turn Off the Auto Energy Saver

■ Press 

Energy saving is turned off

- The word "Auto" will disappear from the remote display.
- The "POWER" LED on the main unit display will turn on.

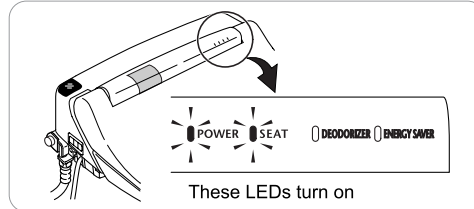
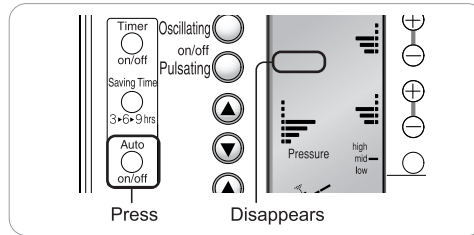

When using both timer energy saver and auto energy saver

- The buttons can be pressed in any order.

■ Press the  at the time you want to begin saving energy.

-  See page 16 for Timer Energy Saver.

■ Press 

-  See page 17 for Auto Energy Saver.

For example, energy saving as follows

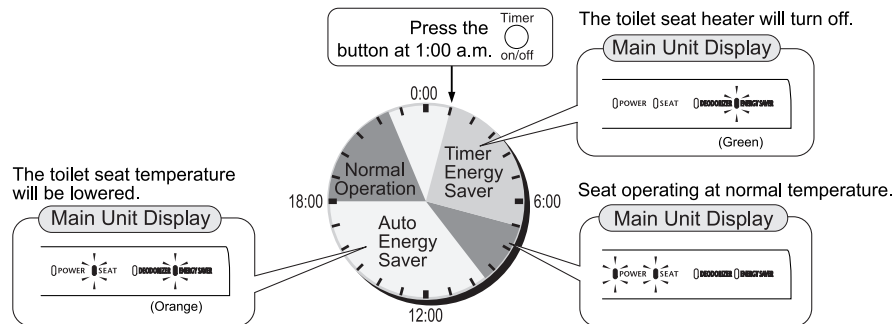

- When not using the timer energy saver, the auto energy saver will be operational, saving power.

Caring for your Washlet®

Before cleaning the Washlet®

■ Each component can be disassembled for a thorough cleaning.

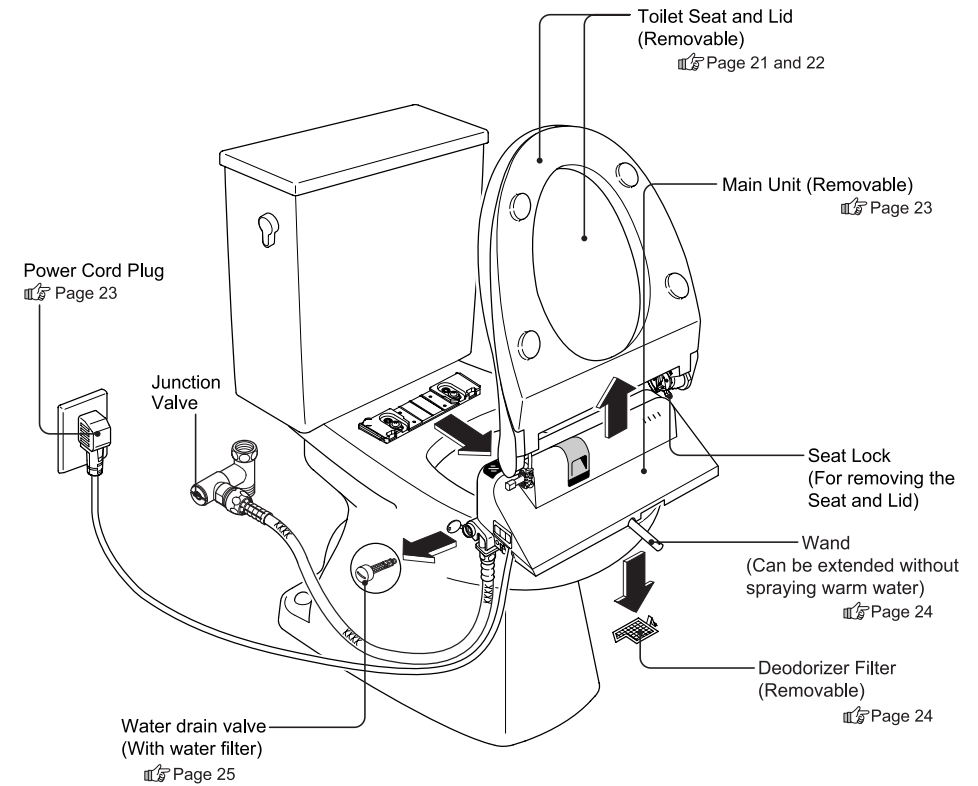

Daily Care and Maintenance

Cleaning the Washlet, toilet seat and lid

Wipe with a soft, damp cloth.

- Dampen a soft cloth with water and wipe these surfaces after wringing well.

Tip 1, 2

Please Note!

The toilet seat and lid can be removed easily so that they can be cleaned thoroughly.

- The use of excess force during cleaning can cause the toilet seat or lid to come off.
- 🔧 If the toilet seat or lid come off, refer to page 22 to reattach them.

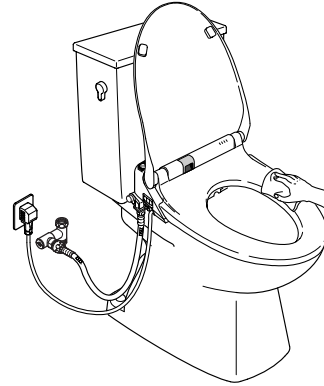

When very dirty...

- Wipe down with a soft cloth, using a diluted dish soap (neutral alkalinity).
- Ripe down with a fresh damp rag after that.

If there is toilet cleaner on the Washlet or seat surface...

- Dampen a soft cloth with water and wipe up the drops immediately.

Please Note!

When using harsh toilet bowl cleaners...

- When using detergent or disinfectants inside the toilet, please leave the toilet seat and lid, open and clean the Washlet surfaces of spilled drops quickly (Within 3 minutes). Additionally, wipe away all traces of detergent from the toilet itself. (Vaporized gas from detergents used on toilets can get inside the Washlet and cause malfunctions).

Tip 1

- The product is made of plastic. Do not wipe the surfaces with a dry cloth or toilet paper. Doing so can cause scratches.
- The Washlet is an electrical product. Be very careful not to let water get inside it. Wipe detergent away completely so that no residue remains in the gaps between surfaces.

Tip 2

- Keep the seat sensor, and remote receiver clean! Many of the functions will not work if these become dirty.

🔧 Pages 13 and 30 - 33.

Thorough Cleaning of the Washlet®

Cleaning the Washlet main unit, toilet seat and lid

- The toilet lid and seat can be removed, so every surface of the unit can be cleaned.

Removing the Toilet Seat and Lid

- 1 Open the toilet seat and lid and raise the seat lock (Grey) until you hear a "Click".

Point

Raise the seat lock until you hear the **Click**.

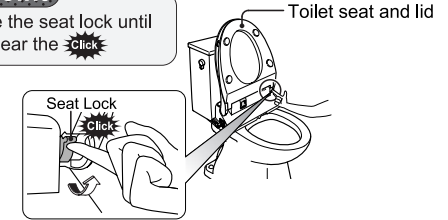

- 2 Take hold of the toilet seat and lid at the base

Align the toilet lid with the top side of the seat sensor window (black)

Pull straight up on the toilet seat and lid with both hands.

Point

Align the toilet lid with the top side of the seat sensor window.

Point

Take hold of the seat and lid with both hands.

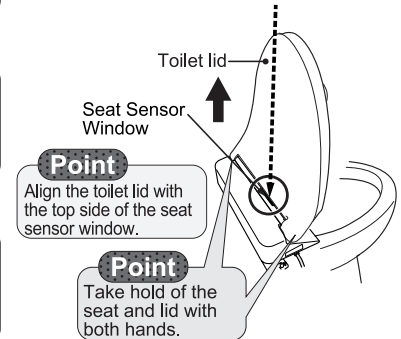

The toilet seat cord can only be pulled approximately 2 inches (5 cm). Please do not use excessive force when pulling. (It could cause a broken electrical connection.)

Please do not pull up at an angle or use excessive force. (Otherwise, damage could result.)

- 3 Place the toilet seat/lid on the toilet as shown in the diagram.

- 4 Clean the main unit as well as the toilet seat and lid.

- 🧽 Clean within the guidelines offered under "Daily Care and Maintenance" on page 20.

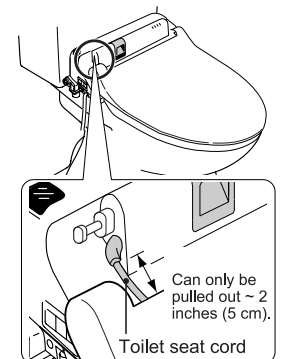

The toilet lid can be removed from the seat

(Removing the Lid)

1 Place your fingers on the seat lock on the right side and move hinge towards the inside (about 1/4 inches (5 mm)).

2 Remove the lid from the seat

- The seat lock and hinge cannot be removed from the toilet seat.

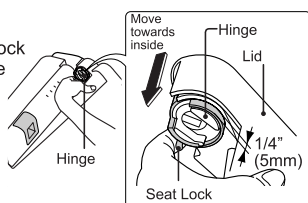

(Reattaching the Lid)

1 Align the lid with the toilet seat from the left side.

2 Move the hinge on the right towards the outside.

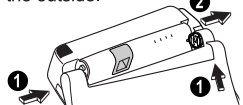

Attaching the toilet seat / lid

5 Check that the toilet pins are pointing up and down.

- When they are not pointing up and down, use a pair of pliers to move the pins into a vertical orientation.

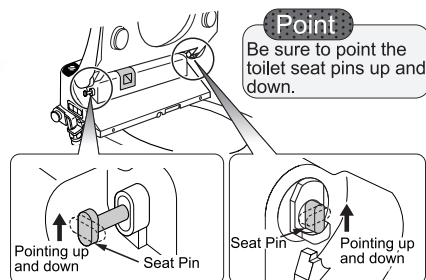

6 Check that the seat lock (grey) is raised.

- If the seat lock is not raised all the way up, it won't be possible to attach the toilet seat/lid.



7 Align the toilet seat and lid with the top side of the seat sensor window (Black) and push firmly onto the toilet seat pins.

- Attach the unit so that the blue line of the toilet seat cord does not get twisted.

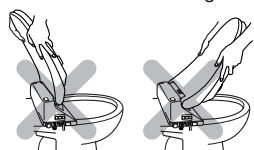

Pressing into place at an angle can cause damage.

Point
Press the right and left at the same time.

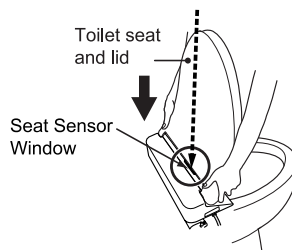

8 Lower the seat locks (Grey) firmly until you hear a "click".

- If the seat lock won't go down, the toilet seat/lid are not attached. Please remove the toilet seat and lid again.

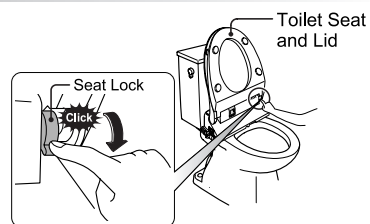

Cleaning the gaps between the Washlet main unit and the toilet

- The main unit can be removed to clean the upper surface of the toilet and the lower surface of the main unit.

(Clean about once a month)

1 Unplug the power cord

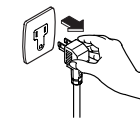

2 Remove the main unit

- With the main unit release button on the right side of the unit pressed in, pull the main unit forward.
- Please do not pull with excessive force because of the water supply hose and the power cord.

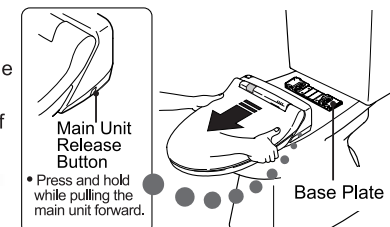

3 Clean the area

- Clean within the guidelines offered under "Daily Care and Maintenance" on page 20.

4 Attach the main unit

- Align the center of the main unit and the base plate.
 - Slide the main unit along the surface of the toilet and press all the way into place until a "click" is heard.
- If the main unit is not securely on the base plate, the Washlet will not function.

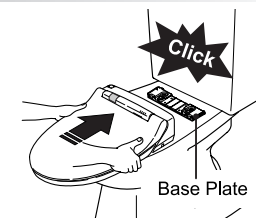

5 Plug the power cord in.

Other Care and Maintenance

Cleaning and inspecting the power supply plug

- Please check the power supply plug around once a month to make sure that it is in proper working condition.

1 Unplug the power cord

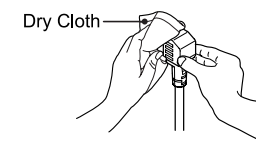

2 Clean

- Remove any dust that is on the blades of the plug using a dry cloth.

3 Plug the power cord in

- Plug the power cord in securely, all the way to the base.

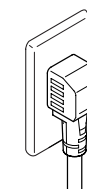

Cleaning the Deodorizer Filter (About once a month)

○ If an odor is smelled, please remove the main unit and clean the deodorizer filter

1 Remove the deodorizer filter

- Press on the clip at the end of the filter and pull it forward.

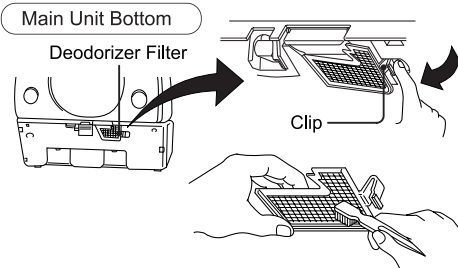

2 Clean

- Use a toothbrush or similar implement to remove dust on the filter. **Tip 1**

3 Attach the deodorizing filter

- Hook the left side of the filter onto the main unit and slide the filter securely until you hear the click "Click".
- Never use the Washlet without a filter. (It could cause malfunctions.)

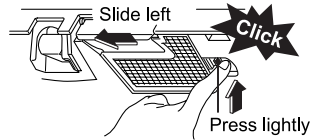

Cleaning the Wand

○ The wand can be extended without spraying warm water, which makes cleaning easy.

1 Extend the wand

- Press the **Wand Cleaning on/off** button on the remote control.

The wand will extend

- After about 5 minutes, the wand will store itself automatically.

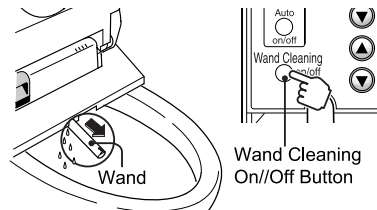

2 Clean

- Wipe away any dirt with a soft cloth.
- Do not pull the wand with excessive force or push against it. (Otherwise, malfunctions could result.)

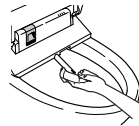

3 Store the wand

- Press the **Wand Cleaning on/off** button again.

The wand will store itself and then wash itself automatically.

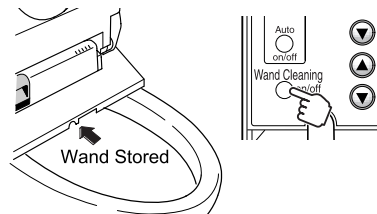

Tip 1 Cleaning the Filter

- The filter can be washed in water, but please remove any moisture before reattaching it. We recommend replacing the filter when it becomes soiled or blocked.

Tip 2 Water will spray from the base of the wand as part of the cleaning process.

Cleaning the Water Supply Filter

○ If you feel as though the water pressure has weakened, clean the water supply filter.

1 Turn off the water shut off valve and the junction valve.

- Please close the junction valve with a flathead screwdriver.
- Turn the toilet tank lever and run the water out of the tank. (This will relieve pressure in the water supply hose.)

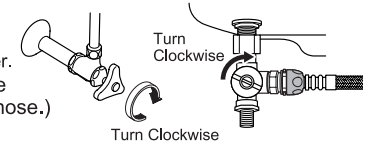

Caution

- Do not remove the water shut off valve (with water filter) when the shut off valve and junction valve are opened.

2 Open the cover (Grey) using a flathead screwdriver.

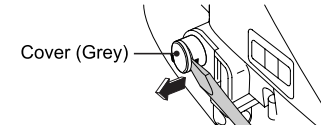

3 Remove the water drain valve with the water supply filter.

- After loosening the water shut off valve (with filter) pull on it to remove it from the main unit.

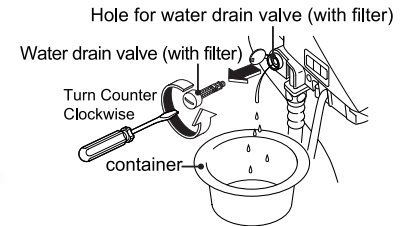

4 Clean

- Wash and remove sediment blocking the filter with water.

For fine sediment, use a toothbrush or similar implement in order to remove everything completely. Please use a cotton swab or similar implement to remove sediment that is caught in the hole for the water drain valve (with water filter).

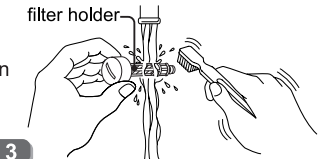

5 Install the water drain valve (with water filter)

- Push the water drain valve (with water filter) into place and tighten securely using a flathead screwdriver.

Caution

- Tighten the water drain valve (with filter) securely. Failure to tighten it securely could result in leaks.

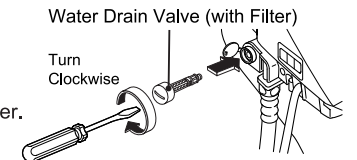

Tip 3 Cleaning the filter

- Please use plain water (without detergent) for washing.
- Do not remove or break the filter. We recommend replacing the filter when it becomes soiled or blocked.

6 Remove the water filter

To access the "junction valve" filter, the junction valve cover must be removed. Use a large flathead screwdriver or coin and turn the valve cover counter-clockwise. Place a container underneath the junction valve. After removing the junction valve cover, gently pull the filter out.

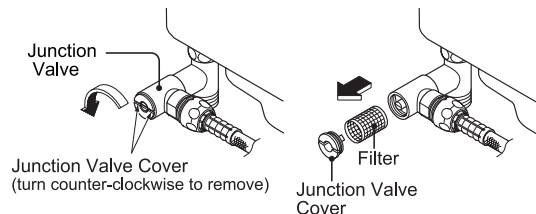

7 Clean the filter

Remove sediment from the filter using a toothbrush.

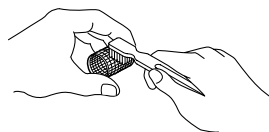

8 Insert the junction valve cover with filter

Push the junction valve cover with filter into the junction valve and turn it clockwise. Be sure to tighten it securely.

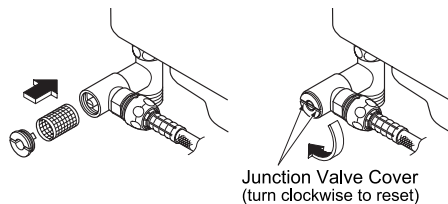

9 Open the water shut off valve and junction valve

• Open the junction valve with a flathead screwdriver. Make sure that there is no water leaking from the water drain valve (with filter) or from the junction valve cover.

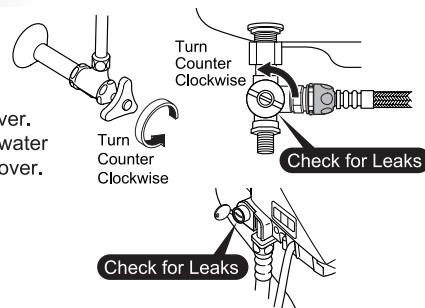

10 Close the cover (Grey)

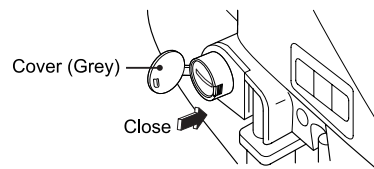

Prevention of Damage Due to Frozen Water Pipes

When Freezing is Anticipated

Tip 1

Please warm the bathroom interior when the ambient temperatures are expected to be sub-freezing. Or, when that is not possible, please remove the water from the system. When there is a risk of freezing, please prevent it by taking the following steps. If the product freezes, the unit could be damaged, resulting in leaks.

Water Removal

1 Removing water from the toilet tank

- Turn off the water supply by turning off the water shut off valve and the junction valve.
 - Turn of the junction valve with a flathead screwdriver.

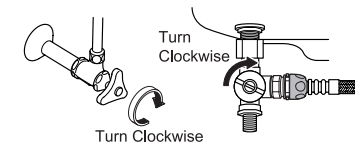

- Turn the toilet tank lever and remove the water from the tank.

Tip 2

2 Removing the water from the hoses

- Push the **Wand Cleaning on/off** button on the remote control. (Remove the residual water in the product interior.)
- Open up the cover (Grey) using a flathead screwdriver.
- After loosening the water drain valve (with filter) using a flathead screwdriver, pull it out.

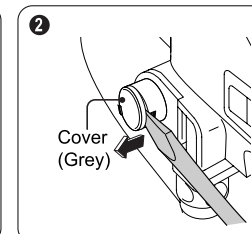
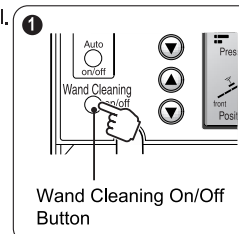

Caution

Do not remove the water drain valve (with filter) while the water shut off and junction valves are open.

- Otherwise, water will spray out.

- Make the water supply hose horizontal and remove the water from inside the hose (about 1 oz. (30 ml)).

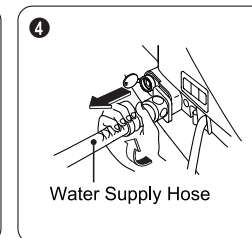
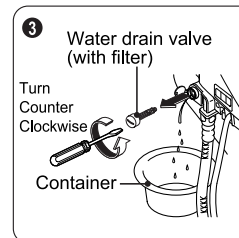

Tip 1

When freezing temperatures are anticipated Please do not use the power saving features. The product could be damaged by freezing.

☞ See page 17 about stopping the timer energy saver.

☞ See page 18 about stopping the auto energy saver.

Tip 2

Please keep the toilet tank lever turned until the tank has completely emptied.

5 Press the **Wand Cleaning** button once more.
(the wand will retract.)

6 Push the water drain valve (with filter) into place and tighten securely with a flathead screwdriver.

Caution

- Tighten the water drain valve (with filter) securely. If not tightened **Mandatory** securely, there could be leaks.

7 Replace the cover (Grey)

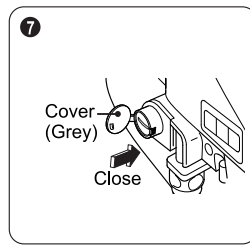
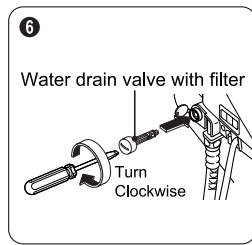

3 Keeping the Washlet Warm

1 Be sure that the **POWER** button is set "On" and that the seat temperature on the remote control is set to high.

2 Close the toilet lid.

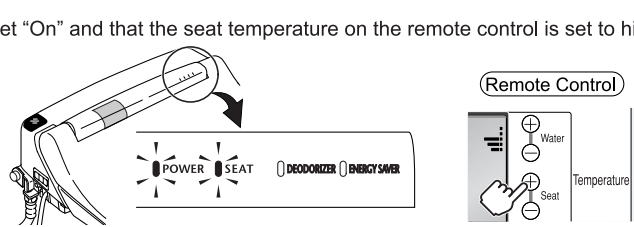

Procedure for Long Periods of Disuse

When not using the Washlet for extended periods, changes in the water could cause skin inflammation. There is also a chance that the product could freeze, so please remove the water. **Tip 1**

Removing the Water

1 Remove the water in the toilet tank. **See Page 27**

2 Remove the water in the hoses. **See Page 27 - 28**

3 Unplug the power cord.

• Be sure to unplug the power cord before removing the Washlet main unit from the toilet.

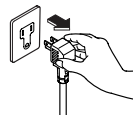

4 Remove the Washlet main unit.

• Place the Washlet on top of the toilet at the front.

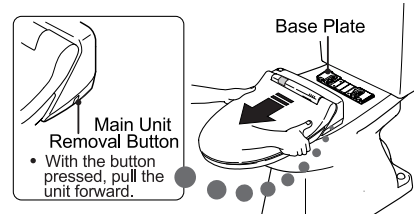

5 Move the drain lever to the open position and drain the water out of the main unit.

- The drain lever will not work unless the main unit is removed.
- The water (about 1 1/2 oz. (40 mL)) will drain in to the toilet from underneath the main unit.

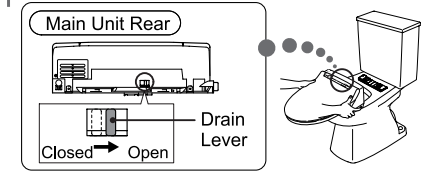

6 Return the drain lever to the "closed" position.

7 Attach the main unit

- Center the Washlet and the base plate.
- Push the Washlet backward across the toilet surface until a "click" is heard.

Unless the Washlet is fully attached to the base plate, it will not function.

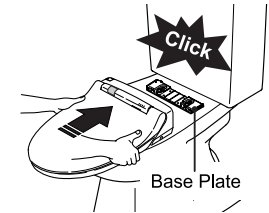

8 Pour Anti-Freeze into the toilet

Reusing After Prolonged Disuse.

1 Open up the water shut off valve and the junction valve

- Open the junction valve with a flathead screwdriver. Confirm that no water is leaking from the main unit or hoses.

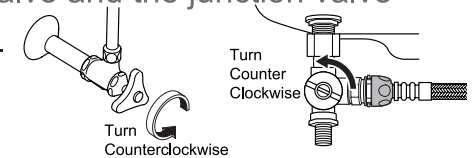

2 Plug the power supply cord into the outlet

3 Spray water out of the wand **Tip 2**

- Cover the seat sensor with white paper and spray water from the wand by pressing the buttons. (Catch the water in a paper cup or similar container.)



Tip 1 When leaving a site for the winter...
When using at a cabin or other location...
Please remove the water! There can be severe cold spells during wintertime absences.
Please be sure to remove the water in order to avoid freezing.

Tip 2 When the residual water is frozen and the water won't run, please warm the toilet interior, the supply hoses, and shut off valve using cloths immersed in hot water.

Troubleshooting

Please check the following before calling for service.
If that doesn't solve the problem, please call TOTO U.S.A., Inc. Technical Support at (888) 295-8134

⚠ Caution

Mandatory

Whenever there is a leak, turn off the water shut off valve and the junction valve to stop the supply of water.

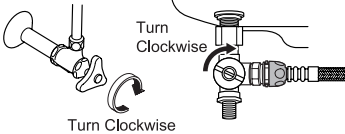

Turn Clockwise

■ Please check the following before requesting repairs.





General

Problem	Check (Cause)	Response
Doesn't work at all	Is there a power outage or a tripped circuit breaker?	Please wait until the power is restored. Or, set the circuit breaker to "on".
	Are all of the LEDs on the main unit display out?	Press the  button on the main unit controls. 🔧 Page 11
	Has the main unit slipped off of the base plate?	Remove the main unit and reattach it to the base plate. 🔧 Page 23

Rear Cleansing / Front Cleansing

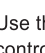
Problem	Check (Cause)	Response
Water will not spray	Has the water been shut off?	Press the  button and wait for the water to be turned back on.
	Are the water shut off valve and junction valve closed?	Open the water shut off valve and junction valve. 🔧 Page 11
	Is the seat sensor working properly?	Read the section about the seat sensor. 🔧 Page 33

Rear Cleansing / Front Cleansing

Problem	Check (Cause)	Response
The water pressure is low	Is the pressure set too low?	Press the water pressure adjustment  button on the remote control. 🔧 Page 12
	Is the water supply filter blocked?	Please clean the water supply filter. 🔧 Page 25, 26
The cleansing water is cold	Is the water temperature set to "off", or to low?	Use the  buttons on the remote control to adjust it. 🔧 Page 14
The cleansing water turned off early	 and  buttons turn off automatically after 5 minutes.	Press the  or  button again. 🔧 Page 12
	Is the seat sensor working properly?	Read the section about the seat sensor. 🔧 Page 33
After sitting on the toilet seat, water flows into the toilet from around the wand for several seconds.	When the seat sensor functions, it runs the water to prepare to spray warm water. Additionally, changing position while seated can cause the seat sensor to turn on or off, causing water to flow for several seconds from around the wand. It is not malfunctioning.	-

Heated Toilet Seat

Problem	Check (Cause)	Response
The toilet seat doesn't get warm	Is the toilet seat temperature set to "Off" or to low settings?	Make adjustments using the  buttons on the remote control. 🔧 Page 14
	Is the unit in timer energy save mode?	After sitting on the toilet seat, the heater turns on and warms up in about 15 minutes. 🔧 Page 16
	Is the unit on auto energy save mode?	After sitting on the toilet seat, it will warm up temporarily. 🔧 Page 17
The toilet seat is cold	After 1 hour after sitting on the toilet seat, the seat heater will shut off. If you move away from the toilet, the seat heater will turn on again automatically.	-

Dryer

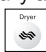
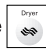
Problem	Check (Cause)	Response
The dryer temperature is low	Is the dryer temperature set to "low"?	Make adjustments using the  buttons on the remote control. 🔧 Page 14
The dryer stopped working early	The dryer stops automatically about 10 minutes after pressing the  button.	Press the  button again. 🔧 Page 13
	Is the seat sensor working properly?	Please read the section about the seat sensor. 🔧 Page 33
The dryer doesn't work at all	Is the seat sensor working properly?	Please read the section about the seat sensor. 🔧 Page 33

Deodorizer

Problem	Check (Cause)	Response
Deodorizer doesn't work	Is the seat sensor working properly?	Please read the section about the seat sensor. Page 33
It sometimes doesn't remove odor	Is the deodorizer filter blocked?	<ul style="list-style-type: none"> • Please clean the deodorizer filter Page 24 • If odor is still a problem even after cleaning the deodorizer filter, call TOTO technical support. Page 30
Deodorizer starts on its own	Under the following circumstances, the seat sensor may function and trigger the deodorizer. It is not malfunctioning. <ul style="list-style-type: none"> • When standing in front of the Washlet • During Cleaning • When the toilet handle is flushed, ect. 	-

Energy Saver Function

Problem	Check (Cause)	Response
The auto energy saver does not work even after the button is pressed	It takes 2 to 3 days to determine the time periods when the toilet is not used very often. When the same time period is used about three times a week, the power saving will not work during that time period. It is not malfunctioning.	-
The energy savers don't start at the correct time	Was the power cord unplugged or has there been a power outage? Did you replace the batteries in the remote control, unplug the power cord, or have a power outage? (If so, the time may be incorrect.)	It may not function properly that day, but it should be functioning properly by the next day. Press the or button on the remote control and reconfigure the settings. Gradually, it will save power during the correct time. Page 16 -17
Energy saving does not occur	Did you replace the batteries in the remote control? (The settings may have reset.)	Press the or button on the remote control and reconfigure the settings. Page 16 -17

Soft Close

Problem	Check (Cause)	Response
After a cover is placed on the seat or lid, they close too fast.	Due to the added weight of the cover, the seat and lid will close more quickly. This is not a malfunction.	-
The speed of the seat and lid closure differ in the summer and winter	Due to changes in room temperature, the seat and lid may close more quickly or slowly. This is not a malfunction.	-

Remote Control

Problem	Check (Cause)	Response
The remote control doesn't work	Are the batteries dead?	Replace the batteries. Page 10
	Is the polarity of the batteries correct?	Insert the batteries correctly. Page 10
	Is the transmitter on the remote control covered?	Remove any debris with a cloth.
	Is there debris or drops of water on the receiver on the Washlet?	Remove any debris or water drops with a cloth.
	Is the seat sensor unable to function properly?	Please read the section about the seat sensor. Page 33
	When you push the buttons on the remote control, does the remote display module turn off temporarily? If so, the batteries are dead.	Replace the batteries with new ones. Page 10
The settings changed after replacing the batteries	The settings will change when the batteries are replaced. The settings will return to their default setting.	Please reconfigure the settings.

Seat Sensor

Problem	Check (Cause)	Response
The rear cleansing or deodorizer work when no one is seated on the Washlet	Is the seat sensor covered? Is there debris or water drops on the sensor window?	Do not cover the seat sensor. Pages 8 and 13 Please remove any debris or water drops with a cloth.
The rear cleansing and deodorizer don't work, even when someone is seated	The seat sensor may have trouble functioning depending upon the manner of sitting, standing, color of clothing, fabric, ect. Is clothing covering the seat sensor? Is there debris or drops of water on the seat sensor window?	Please sit squarely on the toilet seat, changing your stance or rearranging your clothing so that the sensor detects bare skin. Please move the clothing out of the way and remove any debris or water.

Other

Problem	Check (Cause)	Response
Though no one is seated, water runs out of the wand	Under the following circumstances, the seat sensor may function and trigger the deodorizer. It is not malfunctioning. <ul style="list-style-type: none"> • When standing in front of the Washlet • During cleaning • When the toilet handle is flushed, ect. When the interior of the Washlet gets too cold, it sometimes empties itself to avoid freezing. When it does, the tank may drain for about 10 seconds. This is not a malfunction.	-
The main unit is loose	Are the bolts holding the base plate in place loose?	Please tighten the base plate bolts securely.
Water is leaking	Are the junction nuts loose?	Please tighten them with a monkey wrench.

Specifications

Items		S300	
Rated Power Supply		120 VAC 60Hz	
Rated Power Consumption		1277W	
Standard power consumption per hour	Round	22Wh	
	Elongated	21Wh	
Power Cord Length		3 ft. (1.0 m)	
Washlet	Spray Amount	Rear Cleansing	About 9 -14.5 oz/min (0.27-0.43L/min)
		Soft Cleansing	About 9 -14.5 oz/min (0.27-0.43L/min)
		Front Cleansing	About 9.5 -14.5 oz/min (0.29-0.43L/min)
	Water Temperature		About 86 -104°F (30 - 40°C)
	Heater Capacity		1200W (Instantaneous)
	Safety Devices		Temperature fuse, Bimetal switch (excess heat), Float switch (empty water)
Backflow Prevention Devices		Vacuum breaker, One-way valve	
Dryer	Dryer Temperature		About 104 -140°F (40 - 60°C)
	Airflow Capacity		10.5 feet ³ /min (0.30 m ³ /min)
	Heater Power		350W
	Safety Devices		Temperature Fuse
Heated Seat	Surface Temperature		About 81 -97°F (27 - 36°C) (With Auto Energy Saver: 79°F (26°C))
	Heater Power		50W
	Safety Devices		Temperature Fuse
Deodorizer	Type		Activated O ₂
	Airflow Capacity		5.5 feet ³ /min (0.16 m ³ /min)
Supply Water Pressure		20 Psi - 80 Psi (0.14 MPa - 0.55 MPa)	
Supply Water Temperature		32 -96°F (0 - 35°C)	
Ambient Temperature		32 -104°F (0 - 40°C)	
Product Dimensions	Round	15 3/4" x 19 3/4" x 5 1/8" (W 400mm, D 502mm, H 131mm)	
	Elongated	15 3/4" x 20 15/16" x 5 1/8" (W 400mm, D 532mm, H 131mm)	
Product weight		11 1/2 lbs. (5.2kg)	

Limited Warranty

One Year Limited Warranty

1) TOTO USA, Inc ("TOTO") warrants its products to be free from manufacturing defects under normal use and service for a period of one (1) year from the date of purchase. This warranty is extended only to the ORIGINAL PURCHASER.

TOTO's obligations under this warranty are limited to repair or replacement, at TOTO's option, of products or parts found to be defective, provided that such products were properly installed and used in accordance with instructions. TOTO reserves the right to make such inspections as may be necessary in order to determine the cause of the defect. TOTO will not charge for labor or parts in connection with warranty repairs or replacements. TOTO is not responsible for the cost of removal, return and/or reinstallation of products.

2) This warranty does not apply to the following items:

- Damage or loss sustained in a natural calamity such as fire, earthquake, flood, thunder and/ or electrical storm, etc.
- Damage or loss resulting from any unreasonable use, misuse, abuse, negligence, or improper maintenance of the product.
- Damage or loss resulting from removal, improper repair, or modification of the product.
- Damage or loss resulting from sediments or foreign matter contained in a water system.
- Damage or loss resulting from improper installation or from installation of a Washlet in a harsh and/or hazardous environment.

This includes locations where the water pressure exceeds the maximum allowed by local codes. Note: model codes allow a maximum of 80 PSI. Check local code for requirement.

3) This warranty applies only to the Washlet, and not to any other items such as the toilet bowl, etc.

4) To obtain warranty repair service under this warranty, you must take the defective product or deliver it prepaid (shipping and handling) to an authorized TOTO USA, INC. service center. To find the closest authorized dealer, please call 1-800-350-TOTO (8686).

5) In order for this limited warranty to be valid, TOTO USA, INC. must receive the completed attached warranty registration card and your proof of purchase within 30 days of the original purchase date.

6) If the danger label which has been placed over the seams on the back of the Washlet's main unit is broken or otherwise not intact, this limited warranty is void.

This written warranty is the only warranty made by TOTO. Repair or replacement as provided under this warranty shall be the exclusive remedy available to the purchaser. TOTO shall not be responsible for loss of the product or for other incidental, special or consequential damages or expenses incurred by the purchaser, or for labor or other costs due to installation or removal, or costs of repairs by others, or for any other expense not specifically stated above. TO THE EXTENT PERMITTED BY LAW, TOTO DISCLAIMS ALL OTHER IMPLIED WARRANTIES INCLUDING THAT OF MERCHANTABILITY AND FITNESS FOR A PARTICULAR PURPOSE. TOTO ALSO DISCLAIMS ANY LIABILITY FOR SPECIAL, INCIDENTAL, OR CONSEQUENTIAL DAMAGES. Some states do not allow limitations of how long an implied warranty lasts or the exclusion or limitation of special, incidental or consequential damages, so these limitations and exclusions may not apply to you. This warranty gives the consumer specific legal rights. You may also have other rights that vary from state to state. This warranty is to the original purchaser only, and excludes product damage due to installation error, product abuse, or product misuse, whether performed by a contractor, service company, or the consumer.

Warning! TOTO shall not be responsible or liable for any failure of, or damage to, this plumbing product or product component caused by either chloramines in the treatment of public water supply or cleaners containing chlorine (calcium hypochlorite).

Note: The use of a high concentrate of chlorine or chlorine related products can seriously damage the fittings. This damage can cause leakage and serious property damage.

THIS IS OUR EXCLUSIVE WRITTEN WARRANTY.