



WALL COLLECTION

GENERAL PRODUCT INFORMATION:



This product can mount to either a 4" square electrical box with round plaster ring or an octagon electrical box.

This product is suitable for indoor damp locations.

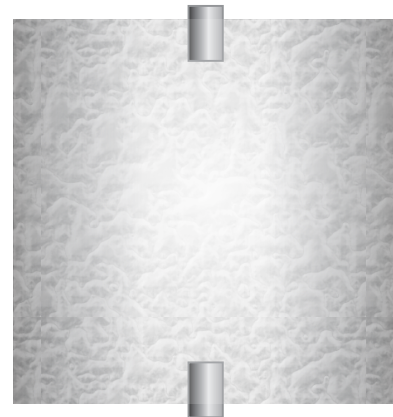

CAUTION—RISK OF FIRE
 This product requires installation by a qualified electrician. Before installing be sure to read all instructions and DISCONNECT POWER TO THE ELECTRICAL BOX.

Mount the Sconce

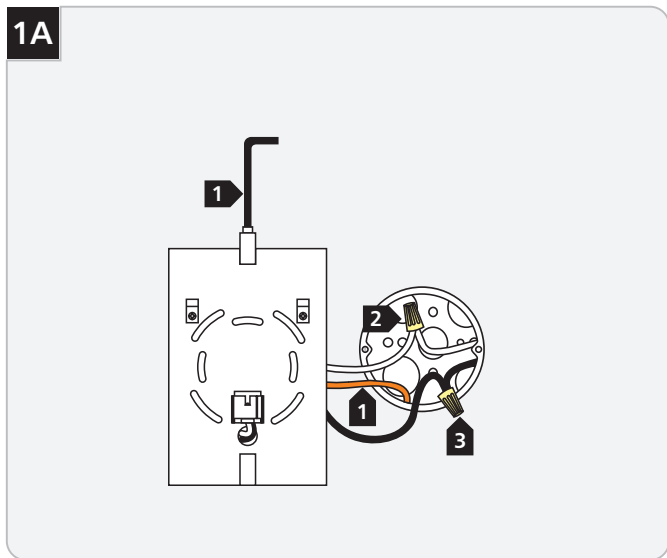

- 1 Loosen the Allen-head screw and remove the upper arm.
- 2 Connect the braided copper wire to a suitable ground in accordance with local electrical codes.
- 3 Connect the white fixture wire to the neutral 120 volt power line wire with a wire nut.
- 4 Connect the black fixture wire to the hot 120 volt power line wire with a wire nut.

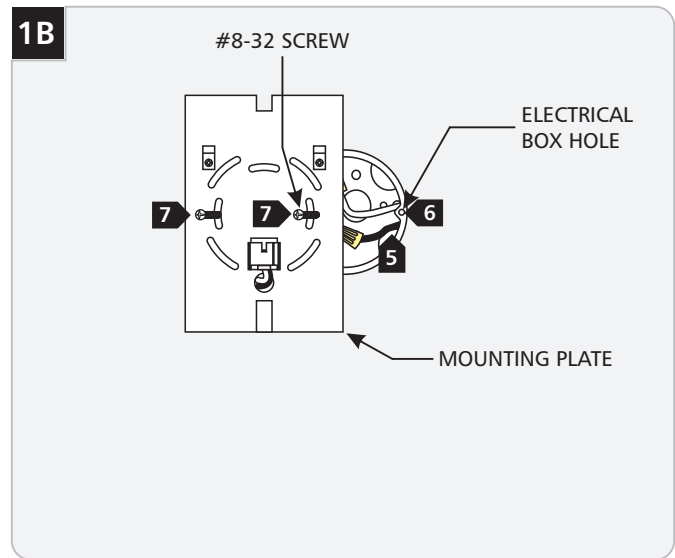

- 5 Properly place all wires and wire nut connections into the electrical box.
- 6 Line up two mounting plate slots with the two electrical box holes.
- 7 Level the mounting plate vertically and secure it to the electrical box with the two #8-32 screws.

Install the Lamp

2A

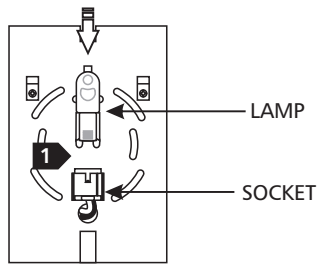

CAUTION: To reduce the risk of a burn or electric shock during relamping, disconnect the power to the fixture.

Use **MAX** 120 Volt, **60 Watt** Type T4, G9 Base Bi-Pin Halogen Lamp.



- 1 Push the lamp base completely into the socket.

To install a fabric shade, continue to section 2B.
To install a glass shade, continue to section 2C.

SAVE THESE INSTRUCTIONS!



TECH LIGHTING®

7400 Linder Ave, Skokie, IL 60077

847.410.4400

www.techlighting.com

© 2008 Tech Lighting, L.L.C. All rights reserved. The "Tech Lighting" graphic is a registered trademark of Tech Lighting, L.L.C. Tech Lighting reserves the right to change specifications for product improvements without notification.

A Generation Brands Company

Install the Fabric Shade

2B

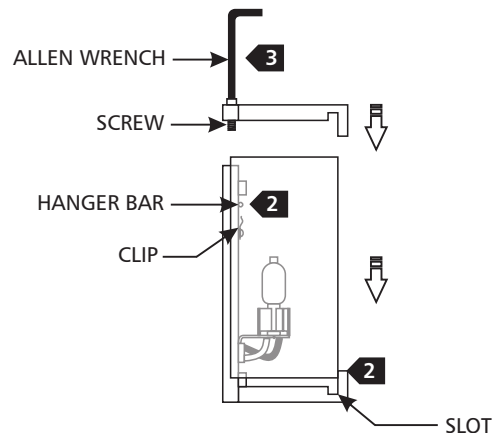

- 2 Carefully slide the shade into the slot on the lower arm while sliding the hanger bar onto the clips.
- 3 To secure the shade, attach the upper arm by tightening the Allen-head screw.

Install the Glass Shade

2C

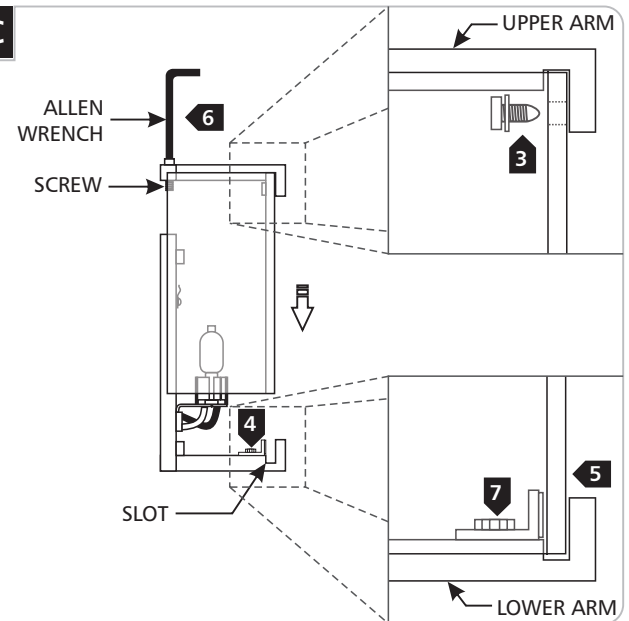

- 2 Remove the screw and washer from the upper arm.
- 3 Slide the screw with washer through the hole in the shade and screw it back into the upper arm.
- 4 Slightly loosen the thumbscrew in the lower arm.
- 5 Carefully slide the shade into the slot on the lower arm.
- 6 Tighten the Allen-head screw.
- 7 Reaching in from the bottom, push the shade support plate against the shade and tighten the thumbscrew.