

# Echo Compact Fluorescent Pendant

700T\_ECP\_-CF

2.1

**2** thousand  
degrees

PENDANTS

## GENERAL PRODUCT INFORMATION:



This product is suitable for damp locations.



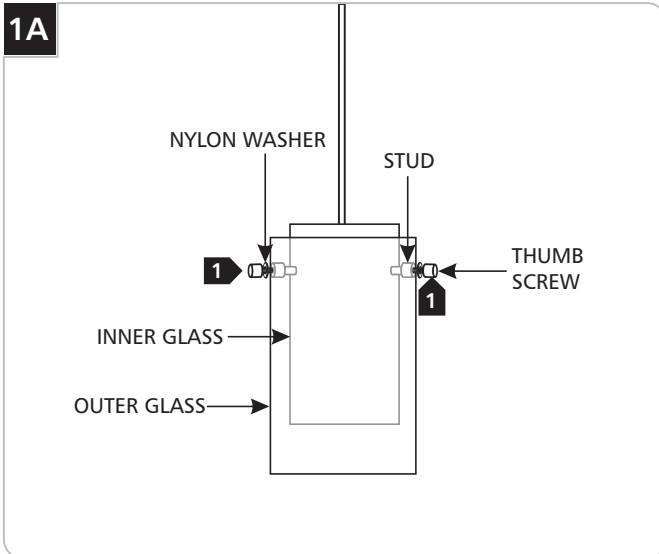

## Installing the Outer Glass & Lamp

**CAUTION:** To reduce the risk of a burn or electric shock during relamping, disconnect the power to the fixture.

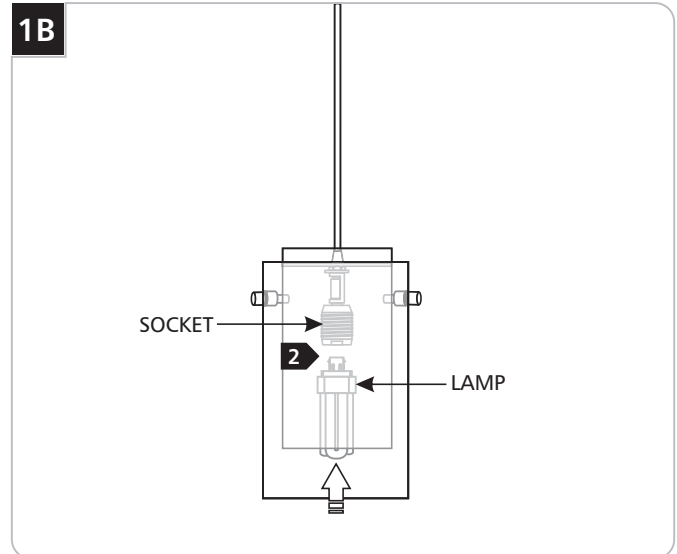

**1** Line up the outer glass holes with the inner glass studs and secure the outer glass to inner glass with provided thumb screws and nylon washers.



Use **MAX 18 Watt GX24Q-2 Base Triple Tube Compact Fluorescent Lamp.** 

**2** Push the lamp pins firmly all the way into the socket holes.

**SAVE THESE INSTRUCTIONS!**



7400 Linder Ave, Skokie, IL 60077  
847.410.4400

[www.2thousanddegrees.com](http://www.2thousanddegrees.com)

© 2008 Tech Lighting, L.L.C. All rights reserved. The "2thousand degrees" graphic is a registered trademark of 2thousand degrees. 2thousand degrees reserves the right to change specifications for product improvements without notification.

A Generation Brands Company