



Ensemble™

42" Shower Back Wall

72212100



Features

- Modular design allows it to be moved around corners and through doorways with ease.
- Durable high gloss finish.
- Smooth, curve wall design.

Material

- Compression molded from our exclusive Vikrell® material.

Installation

- Tongue-and-groove modular design allows for easy "snap together" installation.
- Some caulk required for proper installation.

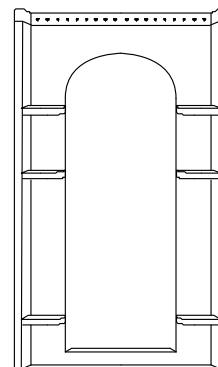

Codes/Standards

CSA B45.5/IAPMO Z124

ASTM E162

ASTM E662

Greenguard UL 2818 - Gold

STERLING® Warranty - Fixtures Made of Solid Vikrell Material

See website for detailed warranty information.

Available Color/Finishes

Color tiles intended for reference only.

Color	Code	Description
-------	------	-------------



0

White



96

Biscuit



Ensemble™
42" Shower Back Wall
72212100

No image available.

This product is a component and not intended to be a standalone installation.

Technical Information

All product dimensions are nominal.

Door height required: 70-1/2" (1791 mm)

Door width required: 38-5/8" (981 mm)