

## IMPORTANT SAFETY INSTRUCTIONS

- Be sure the electricity to the system you are working on is turned off; either the fuse removed or the circuit breaker set at off.
- Use of other manufacturers components will void warranty, listing and create a potential safety hazard.
- If you are unclear as to how to proceed, contact a qualified electrician.
- You don't need special tools to install this fixture.
- Be sure to follow the steps in the order given.
- Proper wiring is essential for the safe operation of this fixture.
- Fixtures with photocells should be mounted at least 48" from all sides to avoid reflection of light back onto photocell, causing the photocell to malfunction or flicker.
- Read instructions carefully.
- Save these instructions.

**NOTE: DO NOT INSTALL ON A POST OF A POLE THAT RESULTS IN A VERTICAL RISE OF 25 FEET OR HIGHER.**

**NOTE: THIS GLASS IS HANDCRAFTED, THE SLIGHT IMPERFECTIONS IN THE GLASS ADD TO THE AUTHENTICITY OF THE FIXTURE.**

**NOTE FOR FIXTURES THAT ARE SOLID BRASS OR SOLID COPPER: YOUR HANDCRAFTED, SOLID BRASS/SOLID COPPER LIGHTING FIXTURE HAS BEEN COATED WITH A DURABLE, BAKED ON ACRYLIC LACQUER WHICH GIVES MAXIMUM PROTECTION AGAINST THE WEATHER. IN TIME, HOWEVER, THE BRIGHTNESS OF THE BRASS WILL TARNISH GIVING WAY TO AN AUTHENTIC OLD WORLD BRASS FINISH. NOTE: TO KEEP YOUR SOLID POLISHED BRASS/COPPER FIXTURE LOOKING NEW FOR YEARS TO COME, REGULARLY APPLY A GOOD QUALITY NON-ABRASIVE CAR WAX TO ALL METAL SURFACES, GIVING THE FIXTURE AN EXTRA PROTECTIVE COATING. IF THIS ADDITIONAL CARE IS NOT TAKEN, YOUR FIXTURE WILL TURN INTO A PATINA FINISH OVER TIME**

## CLEANING

To clean, wipe fixture with a soft cloth. Clean glass with a mild soap. Do not use abrasive materials such as scouring pads or powders, steel wool or abrasive paper.

## ORDERING PARTS

Keep this sheet for future reference, and in case you need to order replacement parts. Parts for this fixture can be ordered from place of purchase. Be sure to use exact wording from illustration when ordering parts.

## BEFORE YOU BEGIN

Carefully remove the fixture from the carton and check that all parts are included, as shown in figure 1. Be careful not to misplace any of the screws or parts which are needed to install this fixture.

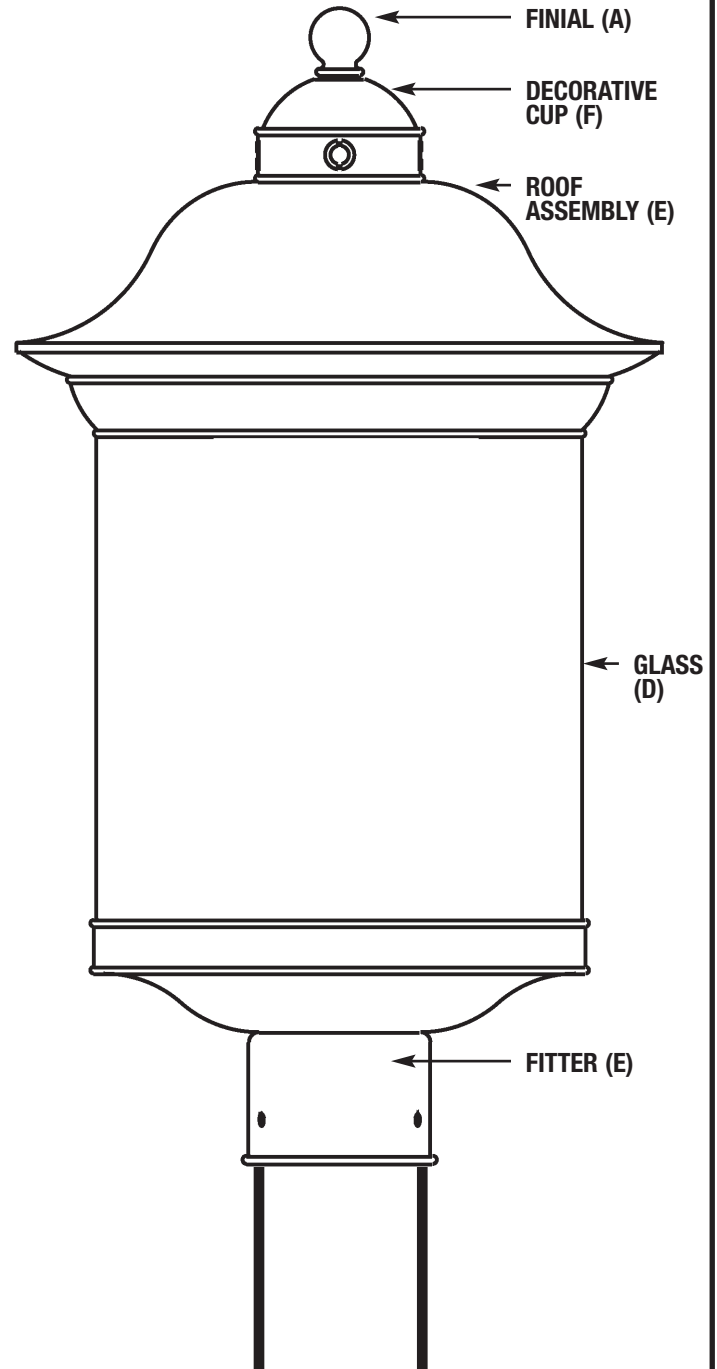

FIGURE 1

\*NOT INCLUDED

**IMPORTANT: DO NOT ATTACH FIXTURE DIRECTLY TO OUTLET BOX.**

**STEP 1:**

A. Take note of the color of the wire(s) on your fixture. Identify which group your fixture wire(s) falls into and connect the wires according to the directions below:

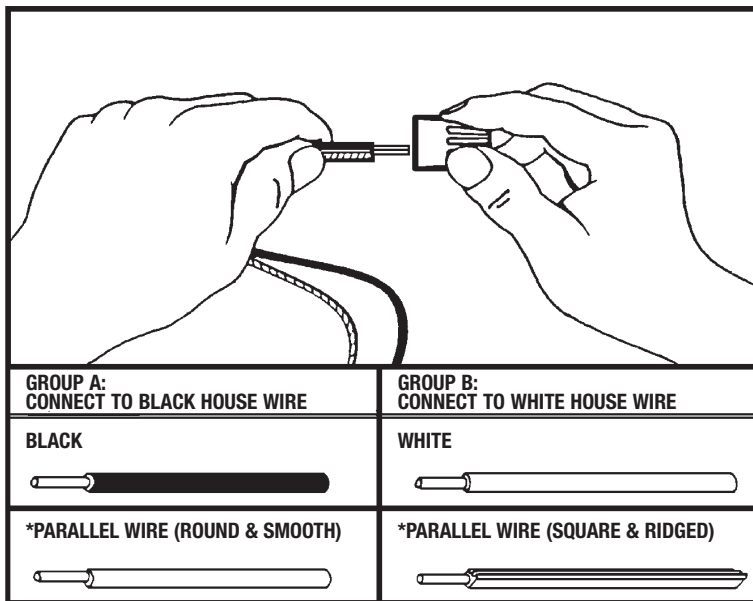

\*Note: When parallel wire is used, the tracer wire is square shaped or ridged and less tracer wire is round in shape or smooth (Seen best when viewed from wire end). To separate wires, grasp the ends of each wire and pull apart.

- B.** Take your fixture wire(s) from group A and place evenly against the black wire from the outlet box. **DO NOT** twist wires together before using wire connectors.
- C.** Fit a wire connector (not supplied) over the wires and thread the connector clockwise until you feel a firm resistance.
- D.** Gently try to remove the wires from the connector, If you can remove the wires, carefully re-do steps B and C, as above and check again for a firm connection.
- E.** Connect the fixture wire from group B to the white wire from the outlet box in the same manner.

**STEP 2:**

**GROUNDING INSTRUCTIONS:** Connect the ground wire from the fixture (bare metal or green insulated wire) to the ground wire from the power supply (bare metal or green insulated wire) using a small wire connector (not supplied). **NEVER CONNECT GROUND WIRE TO BLACK OR WHITE POWER SUPPLY WIRES.**

**STEP 3:**

Slide fitter (F) onto post. Secure in place with screws if applicable.

Make sure no bare wires can be seen outside wire connectors.

**STEP 1:**

Install self ballasted lamp (B) by twisting into socket (C) gently.

**STEP 2:**

Install glass (D) and roof assembly (E), decorative cup (F) over center rod and secure with finial (A).

**FIXTURES WITH A ONE PIECE LAMP / BALLAST COMBINATION**

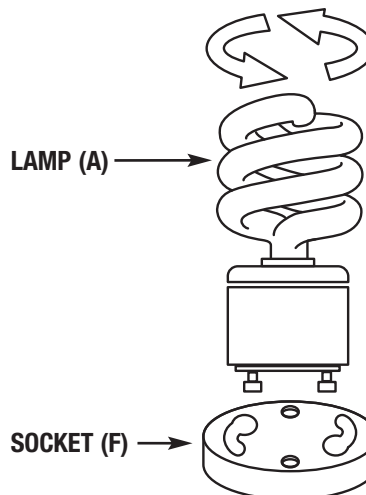

**FIGURE 2**