

Trim Diagram
Refrax™ Pendant REW1006-**

Important: Label on back contains important information on your crystal option. Please save in case you ever need to order matching crystal.

SCHONBEK®



Trim Diagram
Refrax™ Pendant REW1006-**

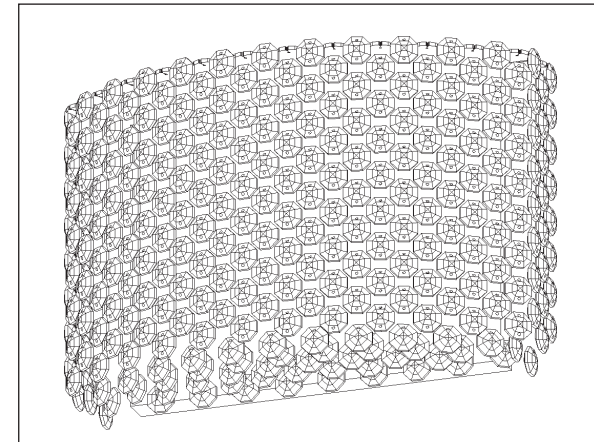

5 Lights
Length: 9½", Width: 4", Height: 6½"

This design is the proprietary trade dress/trademark of Swarovski Lighting, LTD.

Please save your trim diagram for future reference.

IMPORTANT: Label on back contains important information on your crystal option. Please save in case you ever need to order matching crystal.

SCHONBEK® is a member of the Swarovski group.

Swarovski Lighting, LTD., 61 Industrial Blvd., Plattsburgh NY 12901-1908
Tel: 800.836.1892 or 518.563.7500 www.schonbek.com

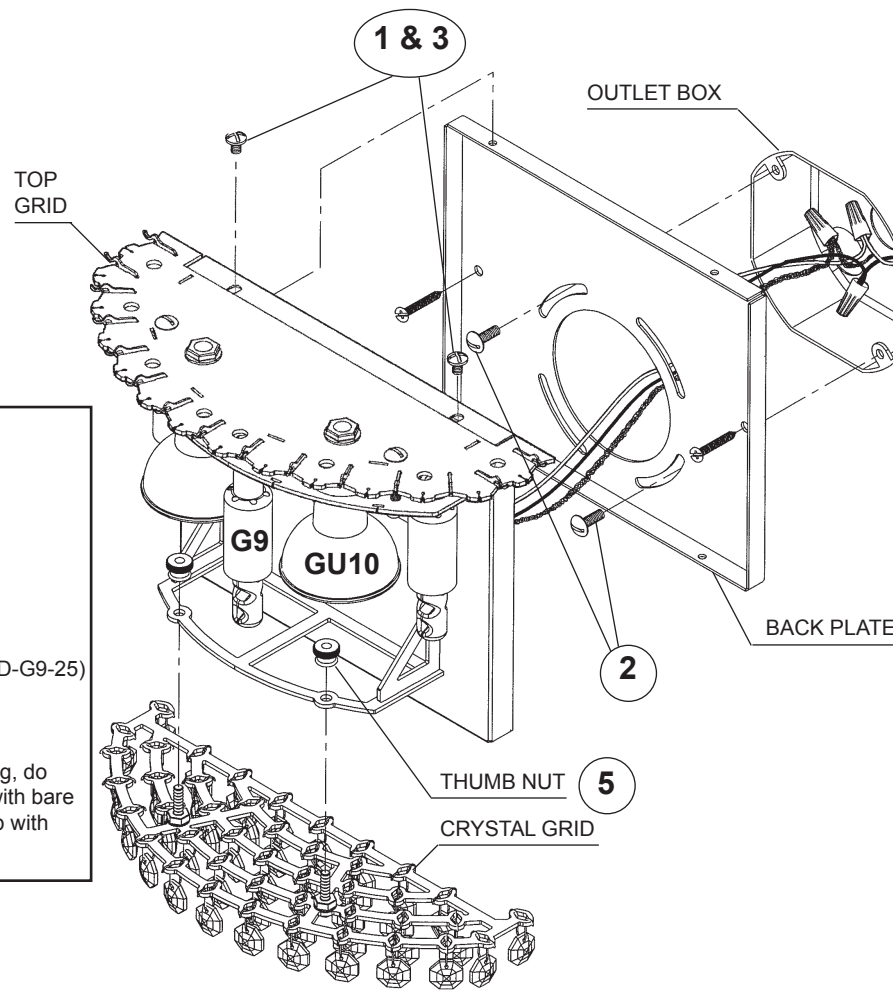

4

2 - GU10
(Wide Flood)
(supplied - Schonbek # :
EXN/GU10)
50 Watts Max.

3 - G9 JCD
25 Watts Recommended
(Supplied - Schonbek #JCD-G9-25)
40 Watts Max
Hanging Weight: 4 pounds

To avoid damaging, do NOT touch bulb with bare hands. Install bulb with clean cloth or tissue.

How to Install G9 & GU10 Bulbs and Refrax™ Wall Bracket:

- 1 Loosen the (4) wall sconce screws and separate the back plate from the wall sconce. Feed stem and ground wires through back plate, then attach to power wires and ground wire in outlet box.
- 2 Attach back plate to the outlet box with the (2) back plate screws NOT supplied.
- 3 Attach wall sconce to back plate and tighten the four screws loosened previously.
- 4 Use G9 JCD bulbs in the small sockets. Plug bulbs carefully but completely into sockets. Use only GU10 base bulb in the larger sockets. Align the legs, insert and turn clockwise carefully but completely. Only use bulbs marked "suitable for open luminaires" OR bearing this symbol:
- 5 Install bottom crystal grid with two thumb nuts (already screwed onto grid) to bottom of the chandelier.
- 6 Hang A chains first, following the crystal map. Hook the connectors into the pinholes located towards the outside of the top grid. See illustration to the left.
- 7 Hang B chains by sliding the octagon with an open hole onto the pin. Chains B will nest into position between A chains. See illustration to the left.

