

Trim Diagram  
Refrax™ Pendant RE0509-\*\*

Important: Label on back contains important information on your crystal option. Please save in case you ever need to order matching crystal.

**SCHONBEK®**

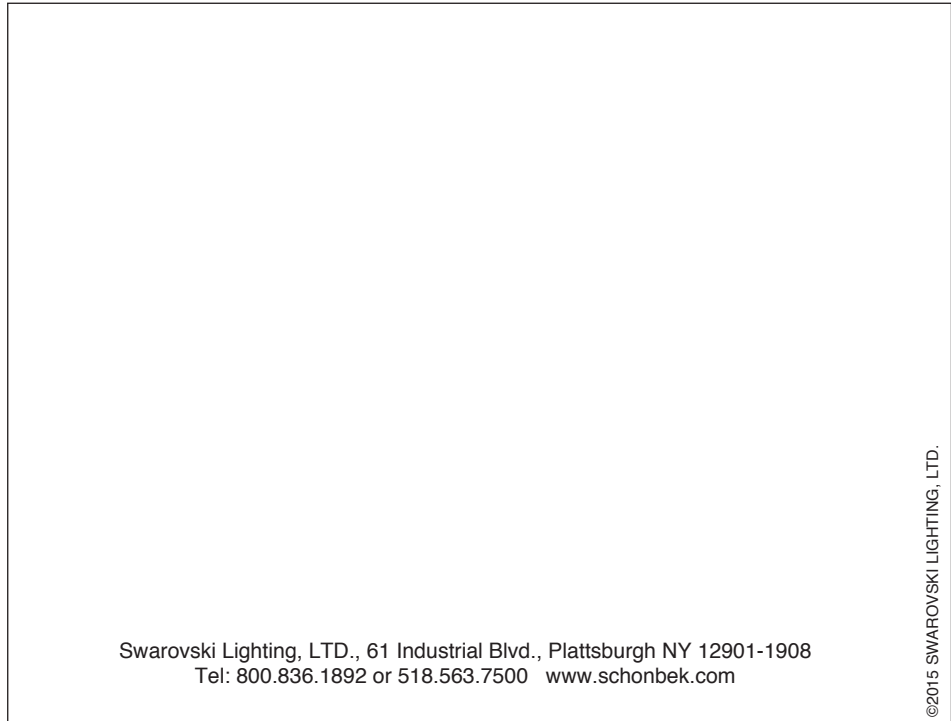

Swarovski Lighting, LTD., 61 Industrial Blvd., Plattsburgh NY 12901-1908  
Tel: 800.836.1892 or 518.563.7500 www.schonbek.com

©2015 SWAROVSKI LIGHTING, LTD.



**SCHONBEK®**

Trim Diagram  
Refrax™ Pendant RE0509-\*\*

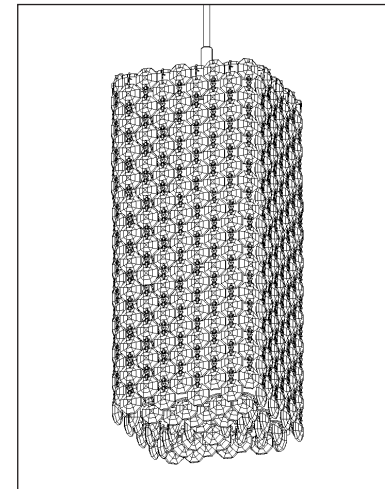

1 Light  
Length: 5", Width: 5", Height: 9"

This design is the proprietary trade dress/trademark of Swarovski Lighting, LTD.

Please save your trim diagram for future reference.

**IMPORTANT:** Label on back contains important information on your crystal option. Please save in case you ever need to order matching crystal.

SCHONBEK® is a member of the Swarovski group.

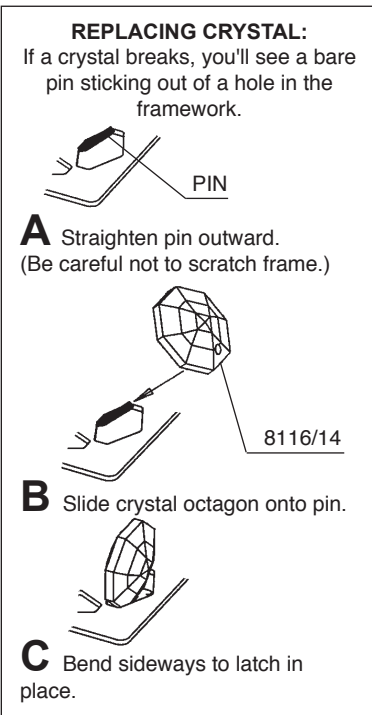
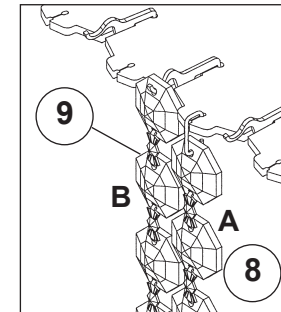
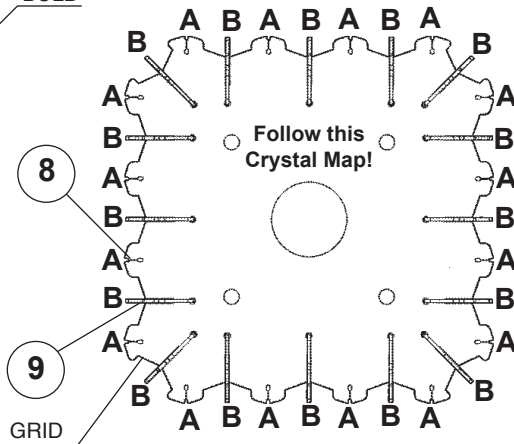
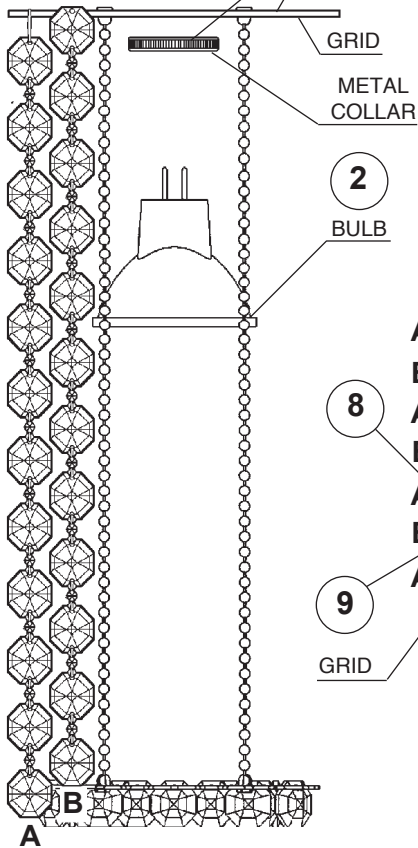
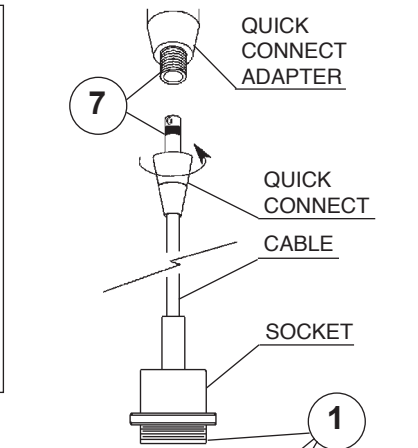
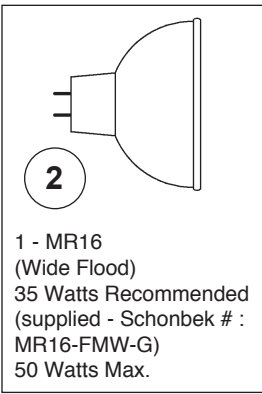

**How to Install MR16 Bulb and Refrax™ Pendant:**

Pendants may be mounted to monorail systems, monopoints or line voltage track by coupling to the quick connect transformer adapter. Attached to the socket is a cable that may be cut on site during installation to any length (see instructions below).

- 1 Position the pendant grid against the socket and secure in place by screwing the metal collar onto the socket.
- 2 Plug bulb carefully but completely into socket. Use only an MR16 glass covered lamp bulb.

**How to Shorten the Cable:**

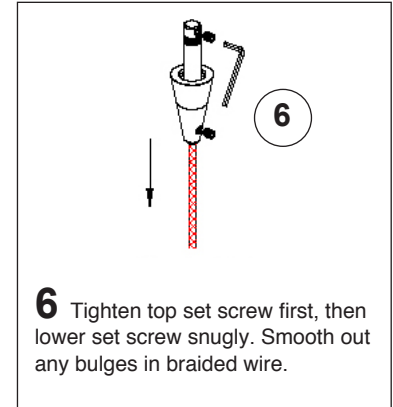
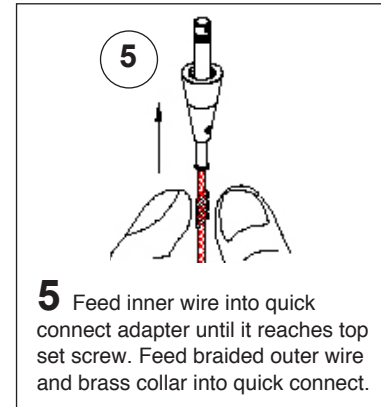
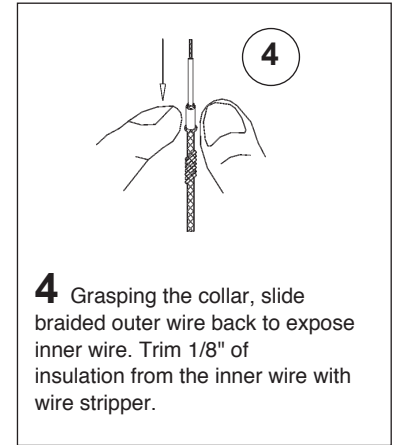
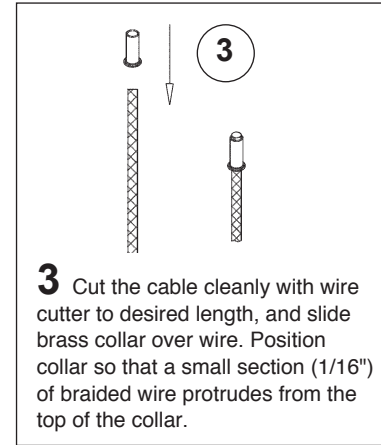

- 7 Screw quick connect into quick connect adapter until it seats. If you adjust the orientation of the pendant, be careful not to loosen the connection.
- 8 Hang A chains first, following the crystal map. Hook the connectors into the pinholes located towards the outside of the grid. See illustration to the left.
- 9 Hang B chains by sliding the octagon with an open hole onto the pin. Chains B will nest into position between A chains. See illustration to the left.

