

Trim Diagram
Matrix MC0408**

Important: Label on back contains important information on your crystal color. Please save in case you ever need to order matching crystal.

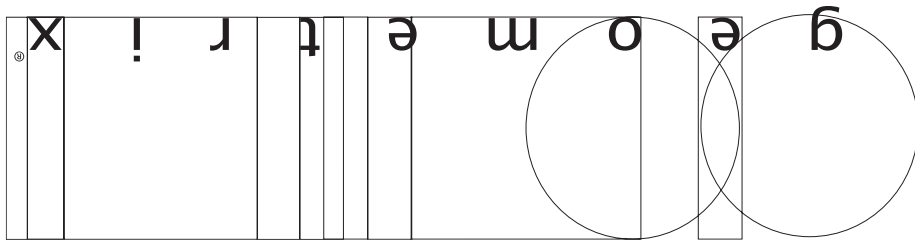

SCHONBEK
BEYOND LIGHTING®

Schonbek Worldwide Lighting Inc., 61 Industrial Blvd., Plattsburgh NY 12901-1908
Tel: 800.836.1892 or 518.563.7500 www.schonbek.com

© 2004 SCHONBEK WORLDWIDE LIGHTING INC., A. SCHONBEK & CO. LTD. WORLDWIDE COPYRIGHT RESERVED

US PATENT 6,712,490 B2 & #D523,169

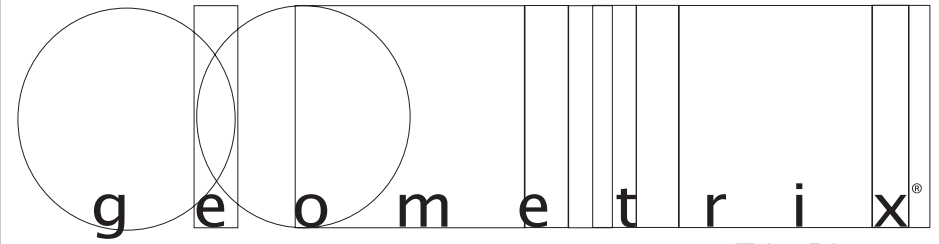

Trim Diagram
Matrix Pendant MC0408**

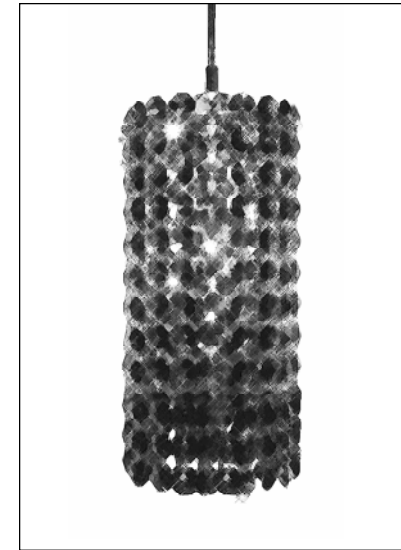

1 Light
4" x 8"

Geometrix™ is designed by Schonbek with Strass® crystal by Swarovski.



This design is the proprietary trade dress/trademark of Schonbek Worldwide Lighting Inc

Please save your trim diagram for future reference.

IMPORTANT: Label on back contains important information on your crystal color. Please save in case you ever need to order matching crystal.



SCHONBEK
BEYOND LIGHTING®

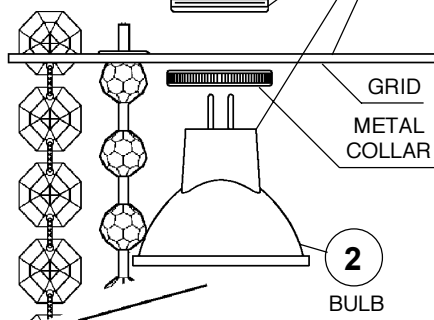
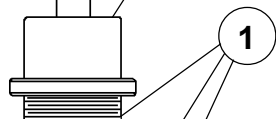
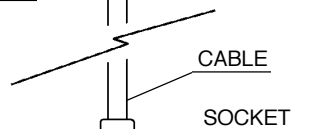
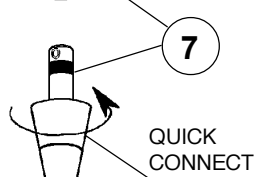
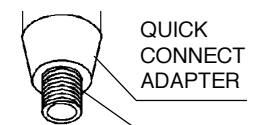
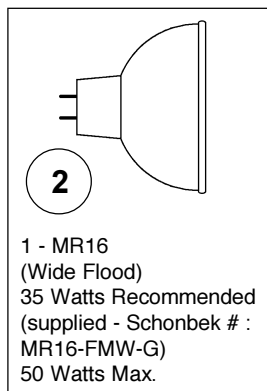

Above top crystal bead in chain is a disk with tab. Make sure the tab seats firmly and lays flat in tab-shaped cut-out in grid.

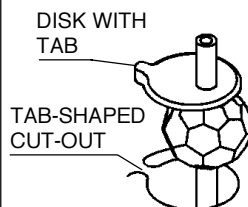

Follow this
Crystal Color Map!

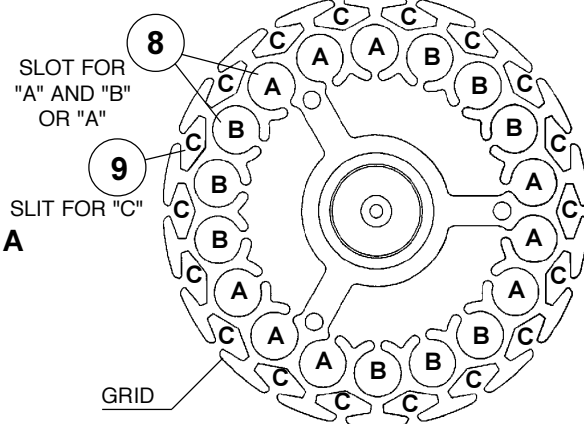

How to Install MR16 Bulb and Matrix™ Pendant:

Pendants may be mounted to monorail systems, monopoints or line voltage track by coupling to the quick connect transformer adapter. Attached to the socket is a cable that may be cut on site during installation to any length (see instructions below).

1 Position the pendant grid against the socket and secure in place by screwing the metal collar onto the socket.

2 Plug bulb carefully but completely into socket. Use only an MR16 glass covered lamp bulb.

How to Shorten the Cable:

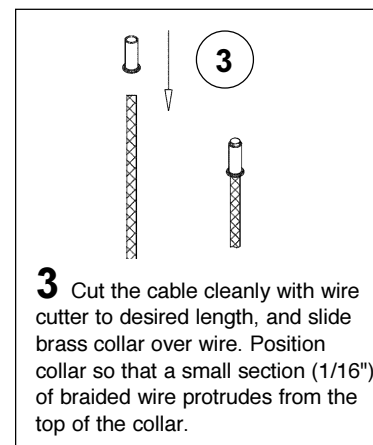

3 Cut the cable cleanly with wire cutter to desired length, and slide brass collar over wire. Position collar so that a small section (1/16") of braided wire protrudes from the top of the collar.

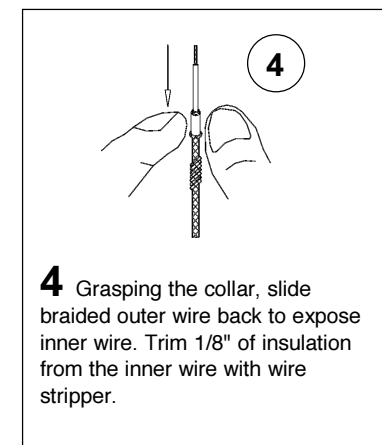

4 Grasping the collar, slide braided outer wire back to expose inner wire. Trim 1/8" of insulation from the inner wire with wire stripper.

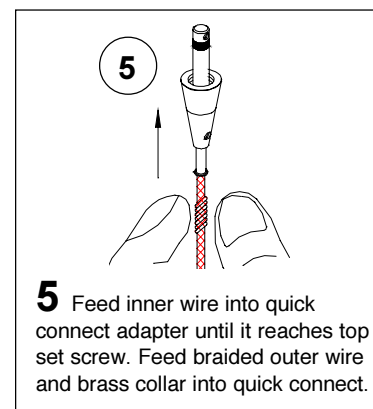

5 Feed inner wire into quick connect adapter until it reaches top set screw. Feed braided outer wire and brass collar into quick connect.

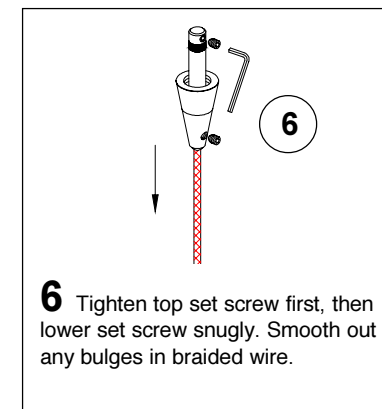

6 Tighten top set screw first, then lower set screw snugly. Smooth out any bulges in braided wire.

7 Screw quick connect into quick connect adapter until it seats. If you adjust the orientation of the pendant, be careful not to loosen the connection.

8 A For Standard Color trimsets: Hang A and B bead chains first, following the Crystal Color Map. Drop strands of crystal beads through slots in top grid. Make sure to follow A - B pattern shown.

B For Premium Color trimsets: Hang A bead chains first, following the Crystal Color Map. Drop strands of crystal beads through slots in top grid.

IMPORTANT: Be sure to thread bottoms of crystal bead chains into slots in bottom grid to secure them in place.

9 Grasp C chain of crystal by the top crystal. Slip the chain through side opening of the grid slit. It will nest into position between the top and second crystal.