

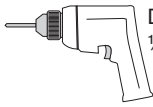

BE365 Door Preparation Instructions For Door With Existing Holes

Tools Needed

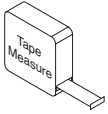

Drill Bits Needed:
1/8", 7/8", 1"

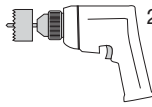

2 1/8" Hole Saw

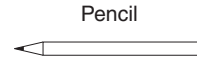

Pencil



Chisel

1 Measure Door Width

If the door is thinner than 1 3/8" or thicker than 1 3/4", then the lock will not fit properly on the door.

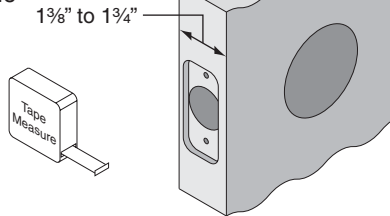

2 Measure for Backset

If existing backset is not 2 3/8" or 2 3/4", then the lock will not fit properly on the door.

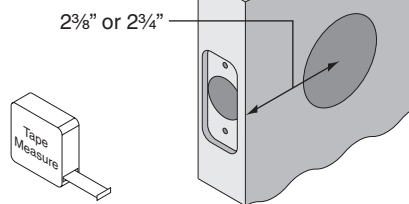

3 Measure Hole Sizes

If hole sizes are larger than those shown, then the lock will not fit properly on the door.

If hole sizes are smaller than those shown, see steps 4 and 5.

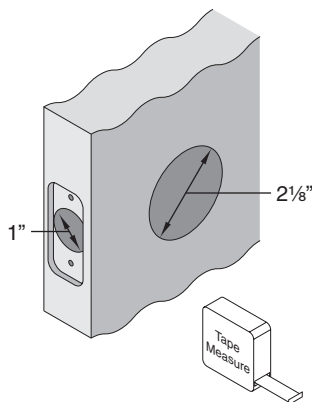

4 If Needed, Enlarge Hole in Door

If hole in door is smaller than 2 1/8", then use 2 1/8" hole saw to enlarge hole.

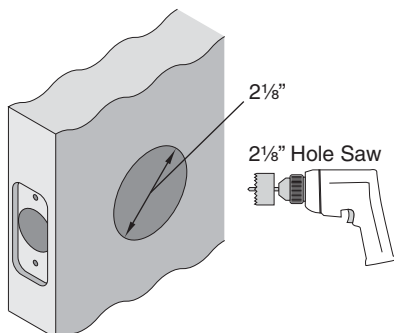

5 If Needed, Enlarge Hole in Door Edge

If hole in door edge is smaller than 1", then use 1" drill bit to enlarge hole.

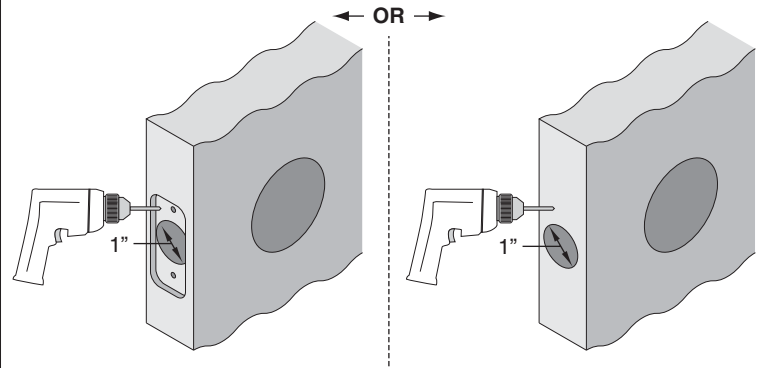

6 Check Strike (Door Jamb) Preparation

- Place new strike box and strike against door jamb.
- If strike box and strike do not fit properly, use pencil to trace around strike box and strike and mark hole positions.
- If needed, use chisel and drill to correct door jamb preparation.

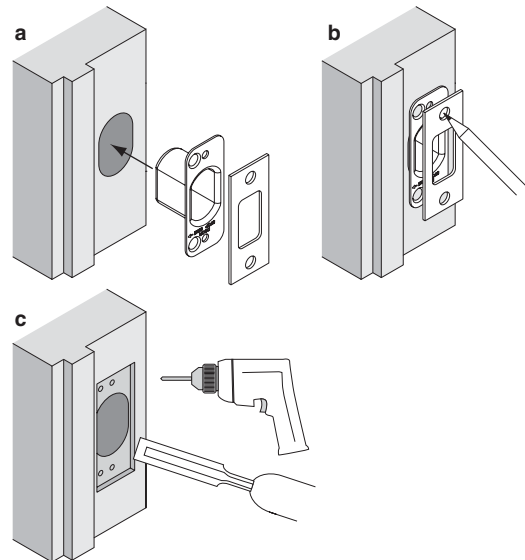



BE365 Door Preparation Instructions For Door With No Holes

Tools Needed

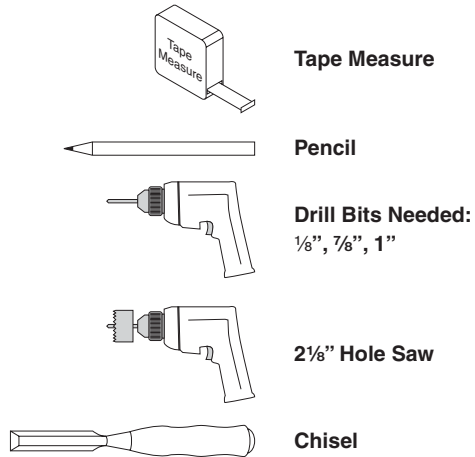

1

Measure Door Width

If the door is thinner than $1\frac{3}{8}$ " or thicker than $1\frac{3}{4}$ ", then the lock will not fit properly on the door.

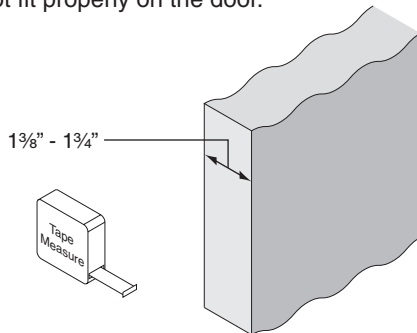

2

Mark Lock Centerline on Door Face and Door Edge

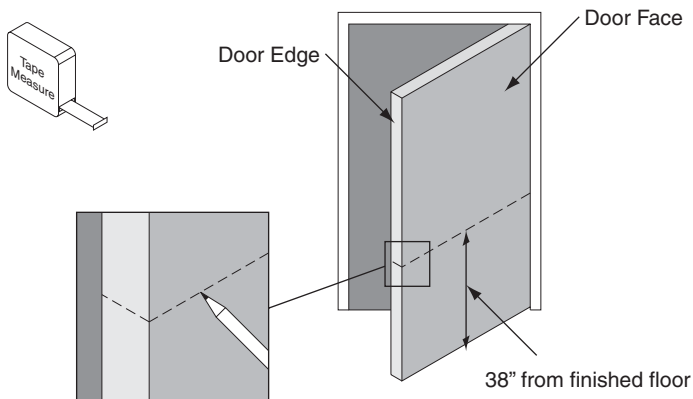

3

Mark and Drill Hole in Door Face with 2 $\frac{1}{8}$ " Hole Saw

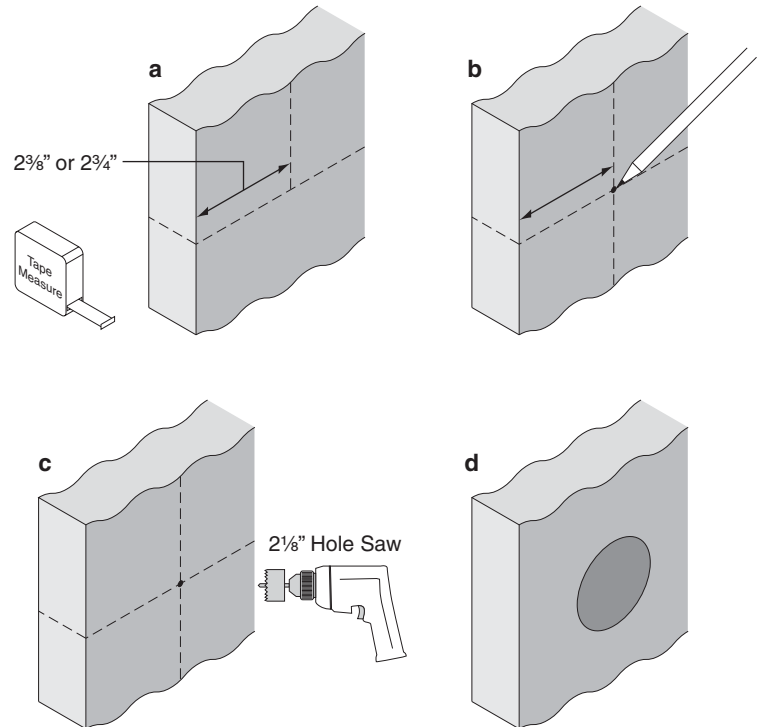

4

Mark and Drill Hole in Door Edge

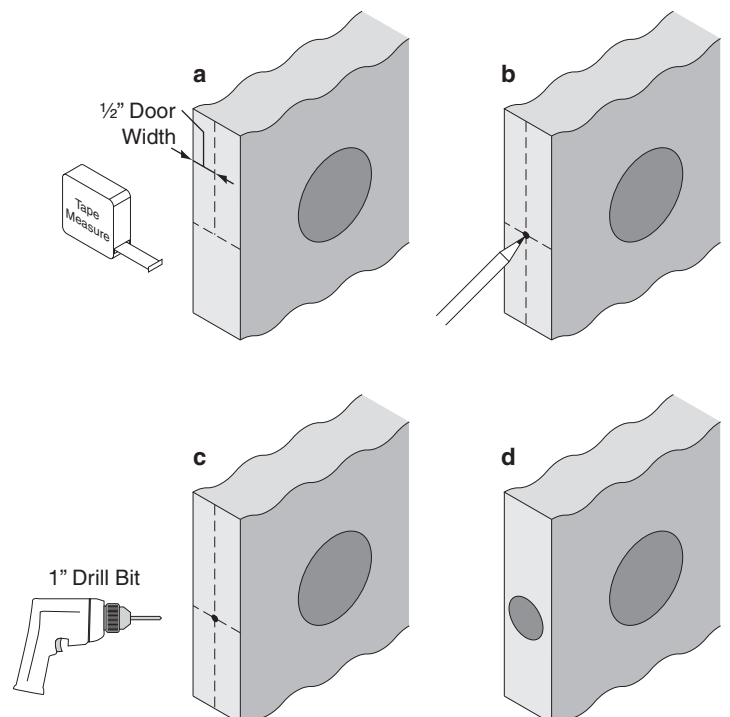

5

If Necessary, Mortise for Latch

- Insert latch into door edge hole.
- Use pencil to trace latch and mark holes.
- Remove latch and drill two $\frac{1}{8}$ " pilot holes.
- Use chisel to create latch mortise.

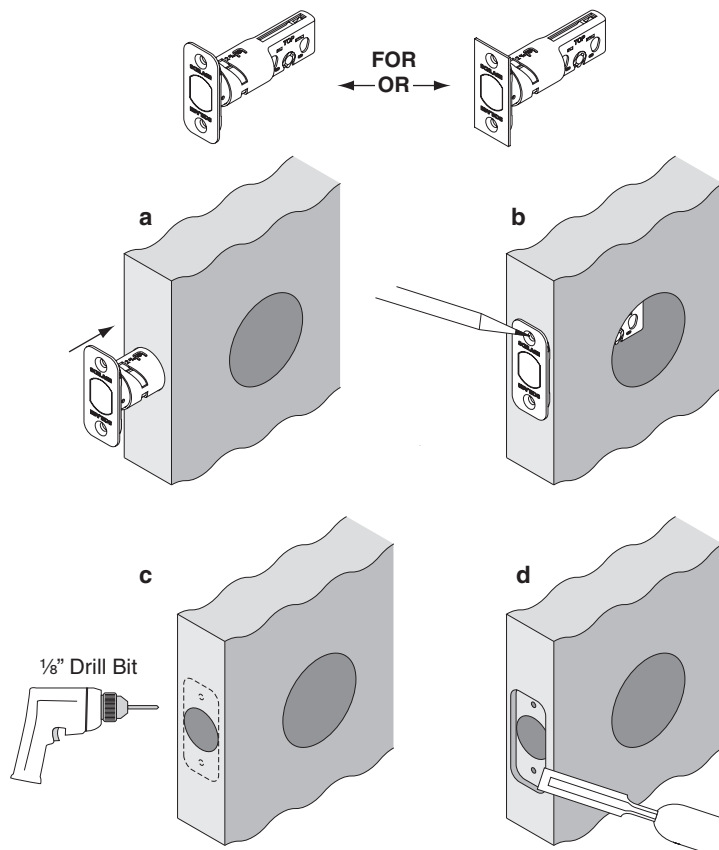

6

Measure and Mark Door Jamb for Strike

- Measure 38" from finished floor and mark on door jamb.
- Mark center for strike hole exactly opposite latch hole.

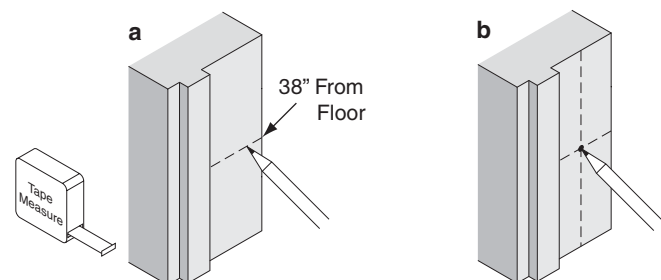
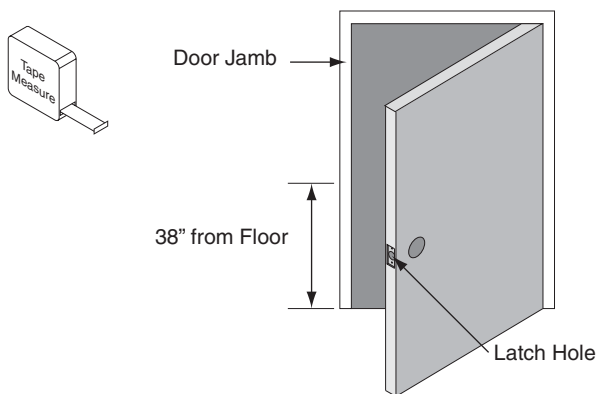

7

Mark and Drill Holes for Strike

- Drill two (2) 1" holes, $\frac{1}{4}$ " deep, as shown. Chisel out excess material.
- Line up strike box and strike with hole in door jamb.
- Use pencil to trace strike and mark holes.
- Drill five (5) $\frac{1}{8}$ " pilot holes and use chisel to create strike mortise.

