

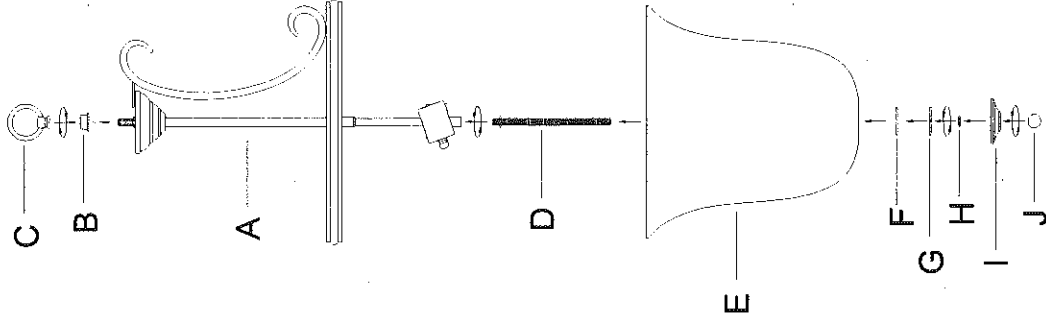

ASSEMBLY INSTRUCTIONS
ITEM NO.: 7-5786-2-69/7-5786-2-13



B → A → C → D → E → F → G → H → I → J

1. Carefully unpack and identify all parts referring to the illustration for parts identification.
2. Turn power to the installation point **OFF**.
3. Place cap (B) over the protruding nipple of fixture body (A) and secure fixture loop (C), until snug.
4. Thread nipple (D) into coupling at bottom of the fixture body (A) as shown in the diagram.
5. Carefully place glass (E), rubber washer (F) and flat washer (G) over the nipple (D) and secure hex nut (H), until snug.
6. Place font (I) over the nipple (D) and secure finial (J), until snug.
7. Install proper bulbs (not provided) to sockets referring to the markings and/or labels on the fixture for maximum wattage.
8. Restore power to the installation point **ON**. Retain this sheet for future reference.