

# PROGRESS P/N: P8531-01

## DIGITAL TIME SWITCH

### Combined Daily / Weekly Electronic timer

Operating instructions. Please read before use.

#### Features:

- Up to 12 On and Off switches a day / 84 On and Off switches a week
- Option to program individual days or 8 different weekday groups
- Minimum switching period one minute
- Summer time / Winter timer changeover
- Easy to read LCD display
- Random automatic On/Off security feature
- Manual override button
- Battery back up: Alkaline battery 1.5V "AA" size (Battery not included)

#### Setting the time.

1. Press and hold the CLOCK key. With this key held pressed, the DAY key can be used to select the correct day, the HOURS key to select the correct hour and the MIN key to select the correct minutes. When the MIN key is released the time will be set with the seconds starting from 0. Either holding down or repeatedly pressing the appropriate button can advance the days, hours and the minutes. Please take note of AM or PM being indicated in the LCD display and adjust as required.

#### Programming of switching times.

Your Auto Time switch has the capacity for 12 On/Off switches. By using the blocks of days available you can save program capacity.

The blocks of days are:

Mon, Tues, Wed, Thurs, Fri, Sat, Sun

Individual days of the week

Mon, Tues, Wed, Thurs, Fri

Sat, Sun

Mon, Tues, Wed, Thurs, Fri, Sat

Mon, Wed, Fri

Tues, Thurs, Sat

Mon, Tues, Wed

Thurs, Fri, Sat

2. For each On time and each Off time the DAY, HOURS and MIN must be set.
3. Press the PROG key once to set the first on time – you will see "ON" and the number "1" appear on the left of the LCD display. This indicates that you can now enter the first On time. Press the DAY button to choose the required day or block of days, and then set the hour and minutes using the HOURS and MIN buttons.
4. When you have completed setting the required On time press the PROG Button to validate the entry and move on to the first Off time – you will see "Off" and the number "1" appear on the left of the LCD display. This indicates that you can now enter the first Off time by using the DAY, HOURS and MIN buttons as above. Press the PROG button to validate this entry.
5. Repeat for the remaining 11 On/Off settings as required.
6. When you have set the required On/Off settings, press the CLOCK button to return the display to the clock. The timer will now be ready to operate.

Note: To change your settings, press the PROG button repeatedly to get to the setting you desire to change. Change the setting by using the DAY, HOURS and MIN buttons as above. You can check the settings you have programmed by pressing the PROG button repeatedly – each setting will appear on the screen.

#### Manual Override Switch

You can choose permanent ON, permanent OFF and Auto mode by switching the Manual Switch. The program settings will only work in Auto mode.

#### Random automatic On/Off security feature

To activate or deactivate the random feature press the DAY and HOURS buttons simultaneously. With this option selected the timer will switch On and Off in a random pattern based on the set program with a time variation of 2-32 minutes added to the set switch times.

For example, if timer should be ON 5:30 to 11:15, the program adds between 2-32 minutes to 5:30. Likewise, it adds between 2-32 minutes to 11:15. This is ideal for use with a light, switching it On and Off automatically when you are out to make your home look occupied but still not exactly the same time every day.

#### Switchover summertime / wintertime / summertime, time zone change.

To change from winter time to summer time press the HOURS and MIN buttons simultaneously. The clock will be set forward one hour and a "S" will appear on the display. Repeat the same procedure in order to return to winter time.

Note: If you purchase this unit during the summer, when setting the clock, set the time for one hour less than the correct time. When the unit is in the auto mode press the HOURS and MIN keys simultaneously. The unit will then adjust to the correct "summer" time and the "S" will appear on the LCD.

#### Reset Button

To reset the unit, both the time and programmed On/Off settings, press the reset button.

#### Display

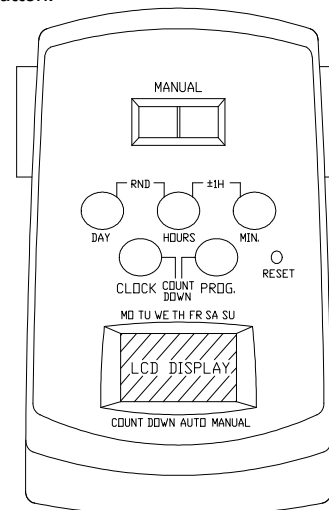

#### Important Safety precautions

Do not use on an extension lead.

Do not plug this timer into another time switch.

Do not plug any device performing mechanical movement directly into the timer.

Fan heaters, and heaters with exposed elements should not be left unattended, and it is recommended that these types of appliances are not connected to timers.

Do not insert needles or any other metal objects into mains outlet.

Avoid moisture, extreme temperatures, shock and vibration.

Use indoors only. Recommended ambient temperature -10 degree C to 40 degree C.

Do not open the timer. Only Authorized Service Personnel must perform repairs.

To clean casing and display, use a soft cloth. Do not use chemical or scouring agents. Do not submerge in water. Keep device out of the reach of children.

#### Specification

Input-AC 110-130V 60Hz Output- 15A resistive load.

Operating temp: -10 degree C to 40 degree C.

Minimum setting time: 1 minute

Battery back up recommended to use: alkaline battery "AA" size 1.5V.

**Note: Please press the "RESET" button if there is no display on the LCD when electricity is turned on.**