



Compact Fluorescent

Clear & White Glass

Sconce

Energy Star

Type _____

-09EBWB

P7093

Catalog No.	Finish	Lamping	Socket	Dimensions (Inches)			
	Brushed Nickel			A	B	C	D
P7093	-09EBWB	2-13w Quad 4 pin (Included)	G24q-1	11-1/4	11-5/16	3-1/2	3

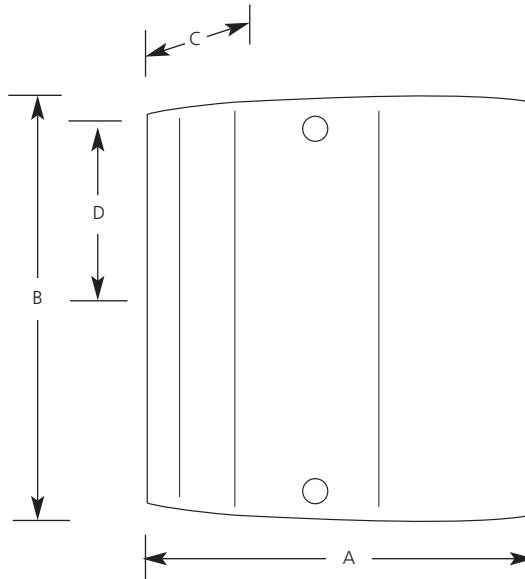

Specifications:

General

- Smooth white glass diffuser
- Glass diffuser has top cover to shield the lamps
- Cover is attached with two brushed nickel threaded balls
- Complies with "Americans with Disabilities Act" - ADA
- Steel construction
- Energy Star certified
- Two 13w 4 pin quad compact fluorescent lamps included
- Plated brushed nickel (-09)

Mounting

- Wall mount
- Unit covers a standard recessed 4" octagonal outlet box
- Mounting strap for outlet box included

Electrical

- 120v NPF electronic ballast
- 4 pin G24q-1 based sockets
- Pre-wired

Labeling

- UL-CUL listed



Progress Lighting
701 Millennium Blvd.
Greenville, South Carolina
29607

www.progresslighting.com