



LED

**6" Pro-Optic® LED Wall Wash Downlight**  
120-277V  
0-10V Dimming

**Recessed**



Type \_\_\_\_\_  
-EB  
P8005

All Items **MTO**

**LED Housing**  
**Catalog No. Description**

P8005-EB 6" LED New Construction Wall Wash Housing

**LED Trim**

Catalog No.	Reflector Finish	LED Color Temp
<input type="checkbox"/> P8006 6" LED Wall Wash, 1100lm	<input type="checkbox"/> -21A Clear Alzak®	<input type="checkbox"/> /30K 3000 Kelvin
<input type="checkbox"/> P8051 6" LED Wall Wash, 2000lm	<input type="checkbox"/> -22A Gold Alzak®	<input type="checkbox"/> /35K 3500 Kelvin
		<input type="checkbox"/> /40K 4000 Kelvin

Example: P8006-21A/30K (Ordered separately)

Ceiling Cutout: see guide

Maximum Ceiling Thickness: 1-1/2"

**STANDARD ORIENTATION**

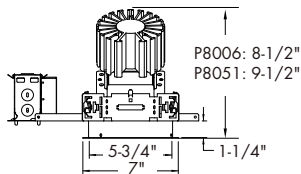
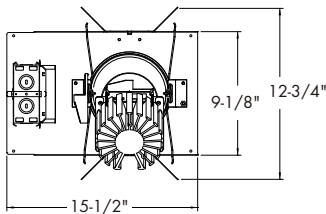

**FIELD CONFIGURABLE ORIENTATION**

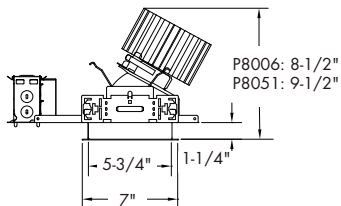
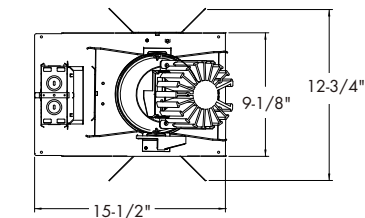

**Specifications:**

General

- Commercial grade LED downlight combines superior brightness control with energy savings and low maintenance
- Suitable for commercial, retail or other institutional applications with ambient temperatures up to 40°C (104°F)

Housing

- One piece 22 gauge non-corrosive steel platform
- Wall Wash orientation may be field adjusted in 90° increments to housing
- Light commercial bar hangers included. Universal adjustable mounting brackets also accept 1/2" EMT or lathing channel (by others)
- Pre-wired J-box with snap on cover for easy access
- Approved for 8 (4 in/4 out) No. 12 AWG conductors rated for 90°C through wiring
- Snap in connections from driver compartment allow easy installation of LED trim assembly without tools above or below ceiling
- Standard with ballast disconnect
- Can be upgraded to accommodate technology improvements

LED Driver

- Efficient Class 2 driver specifically designed for optimal performance with Fortimo DLM module system

- 120-277VAC input, 50/60Hz
- >0.90 Power Factor
- Compliant to FCC 47CFR Part 15 Class A
- Flicker-free 0-10V Dimming to 10%
- Intergrated thermal feedback loop to ensure driver life of 50,000 hrs

LED Light Engine/Reflector

- Uses Philips Fortimo DLM 1100 lumen or 2000 lumen LED modules
- 50,000 hrs at 70% lumen maintenance
- 80 CRI in 30K, 35K or 40K CCT
- Remote phosphor LED technology utilizes high-brightness royal blue LEDs allowing phosphor lens to be exposed to less heat degradation than traditional LEDs
- Provides more controlled color consistency fixture to fixture and over life
- Energy efficient providing 50 LPW delivered from fixture
- High purity aluminum reflector in white or Alzak. Painted white flange standard.

Labeling

- cCSAus certified to US and Canadian standards
- Non-IC rated.
- Suitable for wet locations
- 5 year warranty

Progress Lighting  
701 Millennium Blvd.  
Greenville, South Carolina  
29607

www.progresslighting.com



LED

6" Pro-Optic® LED Wall Wash Downlight

Recessed

P8005/P8006/P8051

P8005 Housing with DRIVER DATA	P8006 (1100 lumen)			P8051 (2000 lumen)		
	30K	35K	40K	30K	35K	40K
Input Voltage	120-277V	120-277V	120-277V	120-277V	120-277V	120-277V
Input Frequency	50/60 Hz	50/60 Hz	50/60 Hz	50/60 Hz	50/60 Hz	50/60 Hz
Input Current	0.146A (120v) 0.063 (277v)	0.156A (120v) 0.067 (277v)	0.137A (120v) 0.059 (277v)	0.146A (120v) 0.063 (277v)	0.156A (120v) 0.067 (277v)	0.137A(120v) 0.059 (277v)
Input Power	17.3W	18.5W	16.3W	36W	34W	33W
Constant Current Output	200-700mA	200-700mA	200-700mA	200-700mA	200-700mA	200-700mA
Power Factor	≥0.90	≥0.90	≥0.90	≥0.90	≥0.90	≥0.90
THD	<20%	<20%	<20%	<20%	<20%	<20%
EMI Filtering	FCC 47CFR Part 15, Class A	FCC 47CFR Part 15, Class A	FCC 47CFR Part 15, Class A	FCC 47CFR Part 15, Class A	FCC 47CFR Part 15, Class A	FCC 47CFR Part 15, Class A
Operating Temperature	-20°C to 55°C	-20°C to 55°C	-20°C to 55°C	-20°C to 55°C	-20°C to 55°C	-20°C to 55°C
Dimming	0-10V	0-10V	0-10V	0-10V	0-10V	0-10V
Over-voltage, over-current, short-circuit protected						

Dimming 0-10V 100% to 10%

Pro-Optic LED driver is compatible with 0-10V type dimming controls. Recommended dimming controls are listed below.

Control Manufacturer	Wallbox Dimmer	Power Booster Available
Douglas Lighting controls	WPC 5721	
Entertainment Technology	Tap Glide TG600FAM120 (120V) Tap Glide Heatsink TGH1500FAM120 (120V) Oasis OA2000FAMU (120/277V)	
Honeywell, Inc.	EL 7315A1019 and EL7315A1009	EL7305A1010
HUNT Dimming	Preset Slide: PS-010-IV-120V and PS-010-WH-120V Preset Slide: PS-010-3W-IV-120V and PS-010-3W-WH-120V Preset Slide: PS-010-IV-277V and PS-010-WH-277V Preset Slide: PS-010-3W-IV-277V and PS-010-3W-WH-277V Preset Slide, controls FD-010: PS-IFC-010-IV- and PS-IFC-010-WH-120/277V Preset Slide, controls FD-010: PS-IFC-010-3W-IV- and PS-IFC-010-3W-WH-120/277V Remoted mounted unit: FD-010-120V and FD-010-277V	
Lehigh Electric Products Co.	Solitaire	PBX
Leviton Lighting Controls Div.	Leviton Centura Fluorescent Control System IllumaTech™ IP7 Series	CN100 PE300
Lightolier Controls	Sunrise Preset slider ZP600FAM120 (120V) Momentum Preset slider MP1500FAM120 (120V) Vega Slider V2000FAMU (120/277)	
Lithonia Controls	ISD BC SLD LPCS Digital Equinox (DEQ BC)	RDM FC
Lutron Electronics Co., Inc.	Visit <a href="http://www.lutron.com/advance">www.lutron.com/advance</a> for the latest control information and selection	
PDM Electrical products	WPC-5721	
Starfield Controls	TR61 with DALI interface port	RT03 DAL Inet router
The Watt Stopper, Inc.	LS4 used with LCD-101 and LCD-103	





LED

6" Pro-Optic® LED Wall Wash Downlight

Recessed

P8005/P8006/P8051

**P8005-EB WITH P8006-21A/35K**

LED Light Engine: 3500K, 80 CRI  
 System Wattage: 18.5W  
 Fixture Delivered Lumens: 830  
 Fixture Efficacy: 46

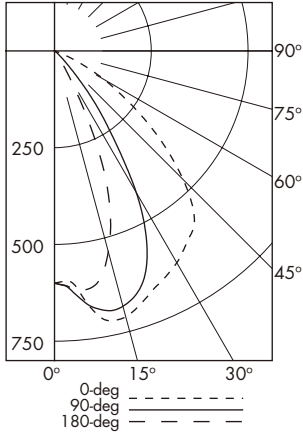

**CANDELA DISTRIBUTION**

DEG	0.0	90.0	180.0
0	600	600	600
5	608	632	619
15	711	683	537
25	656	566	235
35	599	243	19
45	470	35	4
55	243	4	1
65	65	1	0
75	1	1	0
85	0	0	0
90	0	0	0

**LUMINANCE DATA IN CANDELA/SQ. METER**

Angle in Vertical	0 DEG	90 DEG	180 DEG
45°	34598	675	338
55°	19974	104	0
65°	3530	0	0
75°	0	0	0
85°	0	0	0

MULTIPLE UNITS									
1' 2' 3' 4'				UNITS ON 3' CENTER			UNITS ON 4' CENTER		

**3' DISTANCE FIXTURE MOUNTED OUT FROM WALLS  
FOOTCANDLE DISTRIBUTION ON WALL SURFACE**

DISTANCE FROM CEILING IN FEET	1' 2' 3' 4'				UNITS ON 3' CENTER			UNITS ON 4' CENTER		
	1	1	0	0	0	1	0	1	1	0
2	14	10	2	0	14	11	14	14	4	14
3	19	15	8	2	20	23	20	19	15	19
4	14	13	9	4	18	22	18	15	17	15
5	10	9	7	5	14	17	14	12	15	12
6	6	6	6	4	11	12	11	9	11	9
7	5	4	4	3	8	9	8	7	8	7
8	3	3	3	2	6	6	6	5	6	5
9	2	2	2	2	5	5	5	4	5	4

Test No. 3972

Tested at 25°C Ambient in accordance to IESNA LM-79-2008

**P8005-EB WITH P8051-21A/35K**

LED Light Engine: 3500K, 80 CRI  
 System Wattage: 36W  
 Fixture Delivered Lumens: 1405  
 Fixture Efficacy: 39

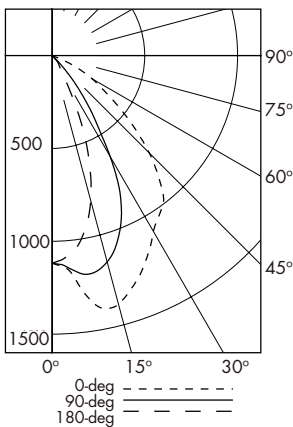

**CANDELA DISTRIBUTION**

DEG	0.0	90.0	180.0
0	1118	1118	1118
5	1171	1153	1075
15	1386	1150	808
25	1206	883	318
35	1022	375	71
45	742	64	18
55	371	4	0
65	131	1	0
75	0	1	0
85	0	1	0
90	0	0	0

**LUMINANCE DATA IN CANDELA/SQ. METER**

Angle in Vertical	0 DEG	90 DEG	180 DEG
45°	62614	5401	1519
55°	38595	416	0
65°	18496	141	0
75°	0	231	0
85°	0	685	0

MULTIPLE UNITS									
1' 2' 3' 4'				UNITS ON 3' CENTER			UNITS ON 4' CENTER		

**3' DISTANCE FIXTURE MOUNTED OUT FROM WALLS  
FOOTCANDLE DISTRIBUTION ON WALL SURFACE**

DISTANCE FROM CEILING IN FEET	1' 2' 3' 4'				UNITS ON 3' CENTER			UNITS ON 4' CENTER		
	1	1	0	0	0	1	0	1	1	0
2	22	16	5	1	22	20	22	22	10	22
3	29	23	12	4	33	35	33	30	24	30
4	24	21	14	7	30	36	30	26	28	26
5	16	16	13	8	24	29	24	20	25	20
6	12	11	10	7	19	21	19	16	19	16
7	9	8	7	6	14	16	14	13	15	13
8	6	6	6	5	11	12	11	10	11	10
9	5	5	4	4	8	9	8	8	8	8
10	4	4	3	3	7	7	7	6	7	6

Test No. 3973

Tested at 25°C Ambient in accordance to IESNA LM-79-2008

