

INSTALLATION INSTRUCTIONS



WOOD VANITY TOPS FOR DROP-IN SINKS

INTRODUCTION

Thank you for selecting our Porcher product. To ensure that your installation proceeds smoothly, read these instructions carefully before you begin. Also, review the recommended tools and materials section. Carefully unpack and examine your new plumbing fixture.

To maintain the beauty of the finish, avoid placing the furniture in direct sunlight, as sunlight causes fading. Also avoid extreme changes in temperature by arranging furniture away from radiators, heat and air vents, and air conditioning units. Avoid placing furniture directly under windows.

ALL INSTALLATION PROCEDURES MUST COMPLY IN STRICT ACCORDANCE WITH APPLICABLE LOCAL PLUMBING AND BUILDING CODES

NOTE: Not intended for use with under mount sinks

SAVE THESE INSTRUCTIONS

WOOD VANITY TOPS

| | | |
|-----------------|------------|-----------------|
| EQUILITY | | 86960-00 |
| OVALE | | 83950-00 |
| TETSU | 24" | 88980-00 |
| TETSU | 36" | 88970-00 |

Tools and Materials Required

Most of the procedures require the use of common tools and materials, which are available from hardware and plumbing, supply stores. It is essential that the tools and materials be on hand before work is begun.

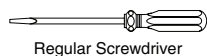

Regular Screwdriver

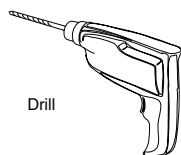

Drill

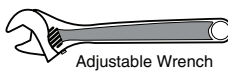

Adjustable Wrench

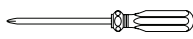

Phillips Screwdriver



Putty Knife



Saber Saw



Plumbers' Putty or
Caulking



Tape
Measure

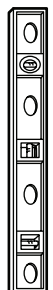

Level

**Roughing-in Dimensions
Model 86960-00**

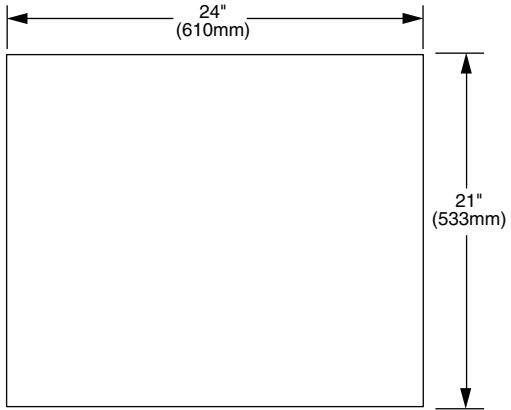

**Roughing-in Dimensions
Model 83950-00**

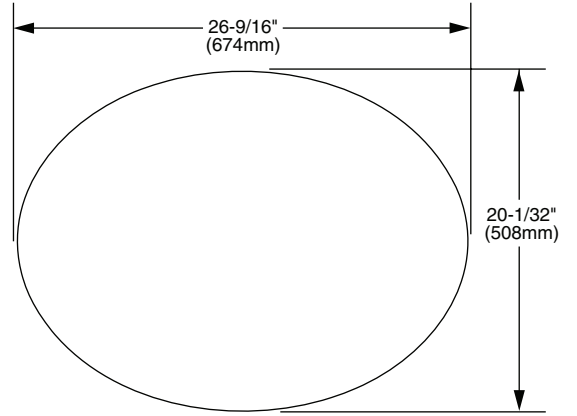

**Roughing-in Dimensions
Model 88980-00**

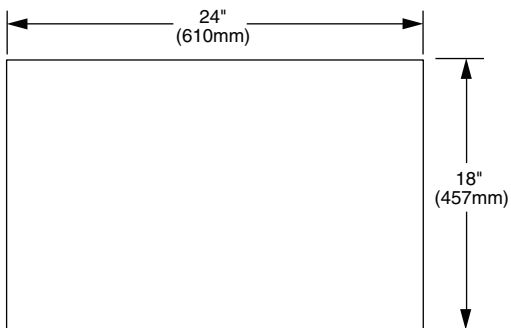

**Roughing-in Dimensions
Model 88970-00**

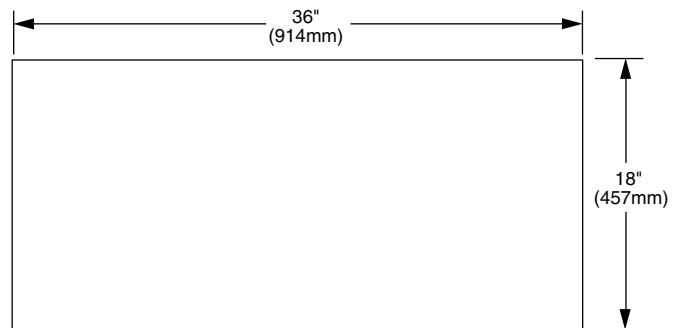

1

Determine the sink which is being installed. Follow the instructions and/or use the appropriate template for sink/drain cut-out and faucet installation..

Install drain in accordance with manufacturer's instructions.

NOTE: Porcher is not responsible for errors when the incorrect template is used.

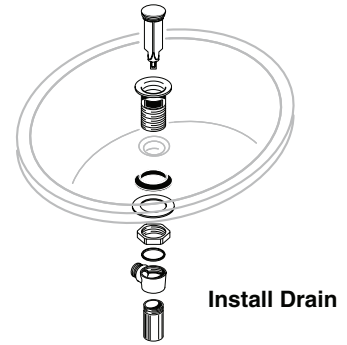
**2**

FOR MODEL NUMBERS: 88970-00 & 88980-00

Place the wood top centered left to right on the vanity and with the back edge of the top even with the rear of the vanity. Using the screws provided, secure the top through the angle brackets located on the vanity.

FOR MODEL NUMBER: 86960-00

Using wood dowels provided and wood glue (not included), secure top to vanity.

FOR MODEL NUMBER: 83950-00

Using wood dowels provided and wood glue (not included), secure top to vanity.

Using the screws provided, secure the top to the vanity.

3

Apply a bead of silicone on sink at interface with vanity top. Position sink into cut-out and secure it to top per the manufacturer's instructions.

4

Install the faucet per the manufacturer's instructions.

5

Connect the trap to the drain assembly in accordance with manufacturer's instructions. Hand tighten to check alignment.

Connect hot and cold supply lines to the shut off valves. Tighten trap joints for watertight assembly.

Care and Cleaning of Vanity

The finished solid wood and genuine wood veneer components used in your furniture are finished with a high quality, catalyzed top coat designed to withstand the wear of continuous usage for many years. Our finishing materials are specially formulated to meet the most stringent industry standards for resistance to moisture, food stains, grease, cosmetics, soap and detergents. This finish protects the wood and enhances its natural beauty. The following are guidelines and recommendations to keep your Porcher furniture looking beautiful.

Regular Exterior Cleaning requires only wiping with a damp cloth and drying with a soft, clean cloth.

Remove Oil, Grease or General Soil using a clean cloth dampened with a solution of mild soap, such as Murphy's Oil Soap® and water. Dry thoroughly.

Never use soap pads, steel wool, self polishing waxes or cleaners that contain bleach, ammonia or abrasives.

Preserve Your Finish by Removing Excess Water

PORCHER FURNITURE LIMITED WARRANTY

If inspection of this Porcher plumbing product, within one year after its initial purchase, confirms that it is defective in materials or workmanship, Porcher will repair or, at its option, exchange the product for a similar model. Variations in actual wood color and finishes which may result from natural characteristics of the wood, such as grain patterns, mineral streaks and the like, are not defects and are not covered by this warranty.

This warranty applies only to the original purchaser and installation of these products. In the event of a claim, proof of purchase will be required; save your receipt.

This limited warranty **does not apply** to local building code compliance. Since local building codes vary considerably, the purchaser of this product should check with a local building or plumbing contractor to insure local code compliance before installation.

This warranty is **void** if the product has been moved from its initial place of installation; if it has been subjected to faulty maintenance, abuse, misuse, accident or other damages; if it was not installed in accordance with Porcher's instructions; or if it has been modified in a manner inconsistent with the product as shipped by Porcher.

Porcher's option to repair or exchange the product under this warranty does not cover any labor or other costs of removal or installation, nor shall Porcher be responsible for any other incidental or consequential damages attributable to a product defect or to the repair or exchange of a defective product, all of which are expressly excluded from this warranty. This limited warranty **does not** cover any liability for consequential or incidental damages, all of which are hereby expressly disclaimed, or the extension beyond the duration of this limited warranty of any implied limited warranties, including those of merchantability or fitness for an intended purpose. (Some states or provinces do not allow the exclusion or limitation of implied warranties, so this exclusion may not apply to you).

This warranty gives you specific legal rights. You may have other statutory rights that vary from state to state or province to province, in which case this warranty does not affect such statutory rights.

In the United States:

Porcher
P.O. Box 6820
Piscataway, New Jersey, 08855
Attention: Director of Consumer Affairs

For residents of the United States, warranty information may also be obtained by calling the following toll free number: (800) 359-3261

In Canada:

Porcher
2480 Stanfield Road
Mississauga, Ontario
Canada L4Y 1S2

Toronto Area: (905) 306-1093
Toll Free: (800) 387-0369

In Mexico:

Porcher
Planta Santa Clara
Via Morelos #330
Santa Clara Coatitla
Ecatepec de Morelos 55540,
Estado de Mexico, Mexico