

### ❖ 84920 - 24" Single Door Vanity

- Inspired by English designs of the 1920's, the Archive collection is sophisticated and inviting
- The doors encompass beautifully reeded wood that bring texture and dimension
- Made of select veneers and premium hardwood construction
- Designed to resist moisture and warpage over time
- Seven step finish applied by hand includes 2 catalyzed polyurethane top coats for moisture resistance and durability
- HPL interior seals and protects from cleaners and toiletries
- Cast metal decorative pulls in a brushed finish
- European robust hinges designed for longevity and repeated use
- Includes adjustable levelers
- American craftsmanship – made in the USA



#### Nominal Dimensions:

24" x 21" x 32-5/8"  
(610mm x 533mm x 803mm)

#### Vanity Colors:



Java 621    Light Cherry 695    Maple 602    White Wood 620    Black 685

### Countertop Options:

- ❖ 84960 Stone Top - Pre-cut for Marquee Square Undercounter and an 8" widespread faucet

#### Nominal Dimensions:

24-1/4" x 21-1/4" x 3/4"  
(616mm x 540mm x 19mm)

#### Stone Top Colors:



White Carrara 550    Cream Marble 570    Black Granite 501

- ❖ 12080 Marquee Square Undercounter Lavatory

#### Nominal Dimensions:

14-5/8" x 14-5/8" x 7-1/2"  
(372mm x 372mm x 191mm)

#### Lavatory Colors:

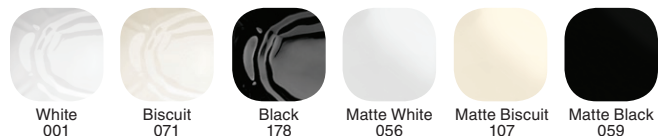

White 001    Biscuit 071    Black 178    Matte White 056    Matte Biscuit 107    Matte Black 059

#### Bowl Inside Dimensions:

11-1/2" (292mm) Wide  
11-1/2" (292mm) Front to Back  
5-1/2" (140mm) Depth

ROUGH IN DIAGRAM SHOWN  
ON REVERSE SIDE

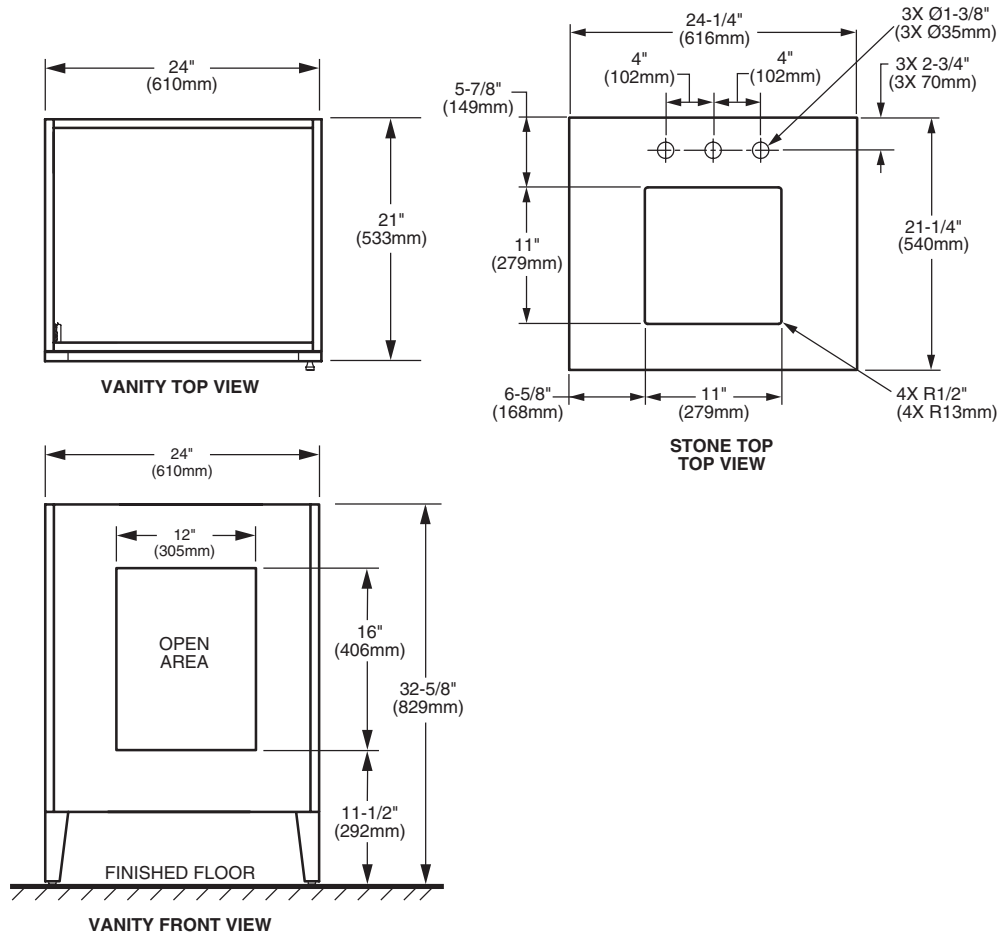

**NOTES:**

LOCATE SUPPLIES AND "P" TRAP IN OPEN AREA.  
 SECURE FURNITURE IN ACCORDANCE WITH INSTALLATION INSTRUCTIONS PROVIDED.  
 FITTINGS NOT INCLUDED AND MUST BE ORDERED SEPARATELY.  
 INSTALLATION INSTRUCTIONS SUPPLIED WITH LAVATORY.

IMPORTANT: Dimensions of fixtures are nominal and may vary within the range of tolerances established by applicable ASME standards. These measurements are subject to change or cancellation. No responsibility is assumed for use of superseded or voided pages.

**To Be Specified:**

- Color:
- Faucet:
- Faucet Finish:
- Supplies:
- 1-1/4" Trap:

**Compliance Certifications:**

- Meets or Exceeds ASME A112.19.2 - 2008/CSA B45.1-08
- CARB Phase I Compliant