



ENGINEERING EXCELLENCE

Americana Series #2AM700 PARTS BREAKDOWN SHEET

DESCRIPTION

- Deck Mount Pot Filler
- Metal Lever Handles
- Space Saving Swivel Spout
Folds in When Not in Use
- 19-3/8" Reach, 15-1/4" From
Deck to Aerator
- Ceramic Disc Cartridges
- 1-Hole Deck Mount Installation
- Designed for Cold Water
- Easy-Install 30" Flex Supply
Lines With 3/8" Connections

FINISHES

- PC Polished Chrome
- BN PVD Brushed Nickel
- SS PVD Stainless Steel
- ORB Oil Rubbed Bronze
- MZ Moroccan Bronze

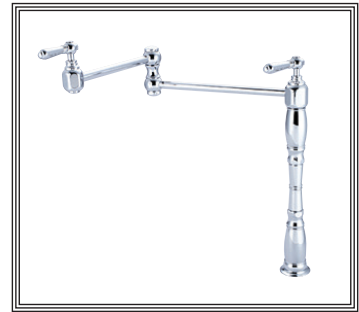

#2AM700 SHOWN * ADA 

FLOW

- Aerator Limited to 2.0 GPM

STANDARDS APPLICABLE

- ASME A112.18.1
- ANSI A117.1
- ANSI / NSF 61, SECTION 9
- CUPC / IAPMO LISTED / ADA
COMPLIANT
- CONTAINS NO MORE THAN
0.25% WEIGHTED AVERAGE
LEAD CONTENT

Model #: _____

Specific Features: _____

Project Name: _____

Submitted For: _____

Model	Description	Finishes	
#2AM700	Deck mount Pot Filler	<input type="checkbox"/> PC	<input type="checkbox"/> Other _____



ENGINEERING EXCELLENCE

Pioneer:1-800-338-9468
 Commerce, CA 90040
 www.pioneerind.com
 Pioneer Industries, Inc. © 2016

DMPB2AM700/REV. 08 2016
 Page 1 of 2

	ITEM#	DESCRIPTION
A	X-1200010*	Lever Handle
B	X-4200154*	Retainer Nut
C	X-3200004H	Ceramic Cartridge
D	X-4200093*	Handle Sleeve
E	X-4200067*	Handle Escutcheon
F	X-4900041*	2.0 GPM Aerator
G	X-5200019	Mounting Kit
H	X-5200020	Mounting Tool
1	X-4900042P*	Handle Button-Plain
2	X-4900043	Handle Screw

* Note- Please specify finish/color code while ordering.

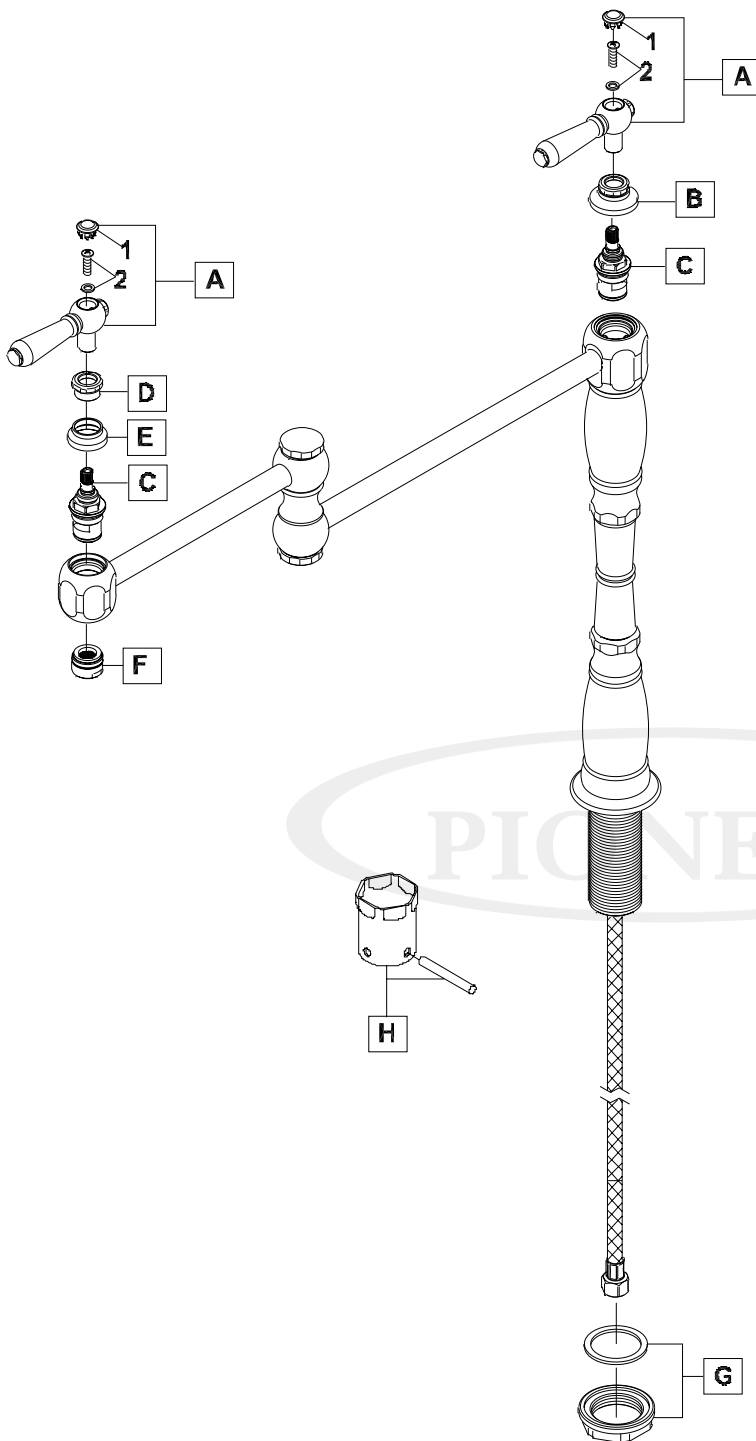

Product Diagram



ENGINEERING EXCELLENCE

Pioneer: 1-800-338-9468
 Commerce, CA 90040
 www.pioneerind.com
 Pioneer Industries, Inc. © 2016