

BILL OF MATERIAL (CURRENT LEVEL)

ITEM	PT/ASSY	DESCRIPTION	TYPE	QTY.
1	3-221	BAR SPOUT ASM - COMP	ASSEMBLY	1
2	1-130	CHAUD BUTTON W/ADH. TAB	ASSEMBLY	1
3	2-447	CROSS HANDLE ASM	ASSEMBLY	2
4	1-131	FROID BUTTON W/ADH. TAB	ASSEMBLY	1
5	10517	NUT - DOME HEX	PART	2
6	2-239	SINGLE HOLE CROSS BAR ASSEMBLY	ASSEMBLY	1
7	98037	STICKER LABEL A112.18.1	PART	1

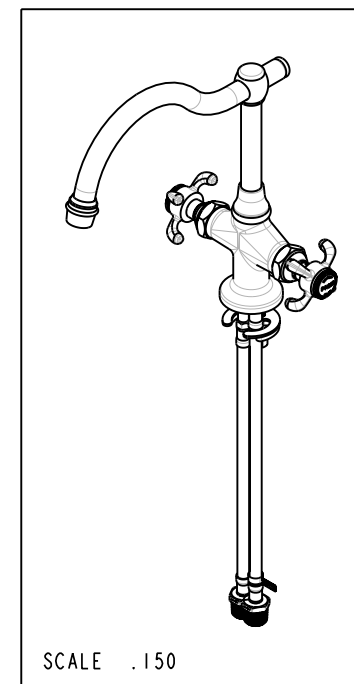

COPYRIGHT 2003 BRASSTECH, INC. THESE DRAWINGS AND THE DESIGNS DEPICTED HEREIN ARE THE PROPRIETARY PROPERTY OF BRASSTECH. ANY USE OR REPRODUCTION IS SUBJECT TO THE EXPRESS APPROVAL OF BRASSTECH. UNAUTHORIZED USE IS STRICTLY PROHIBITED. ALL RIGHTS RESERVED.

BRASSTECH
INCORPORATED
2001 E. CARNEGIE AVE.
SANTA ANA, CA 92705
(949) 417-5207

BAR FAUCET

ASSY. NO.		1688		A	EO-0274	10/20/03
SCALE .250		REF. -		-	EO-0256	02/17/04
SHEET 1 OF 2		REV		REV	DESC	DATE

SPECIFICATION DWG

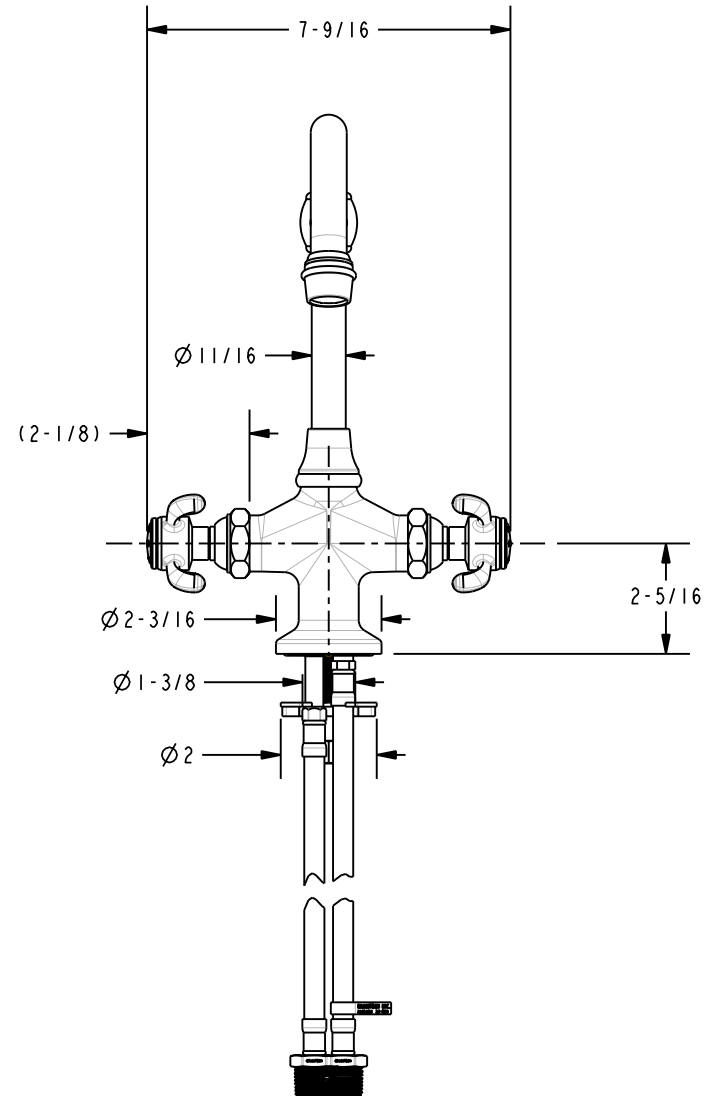
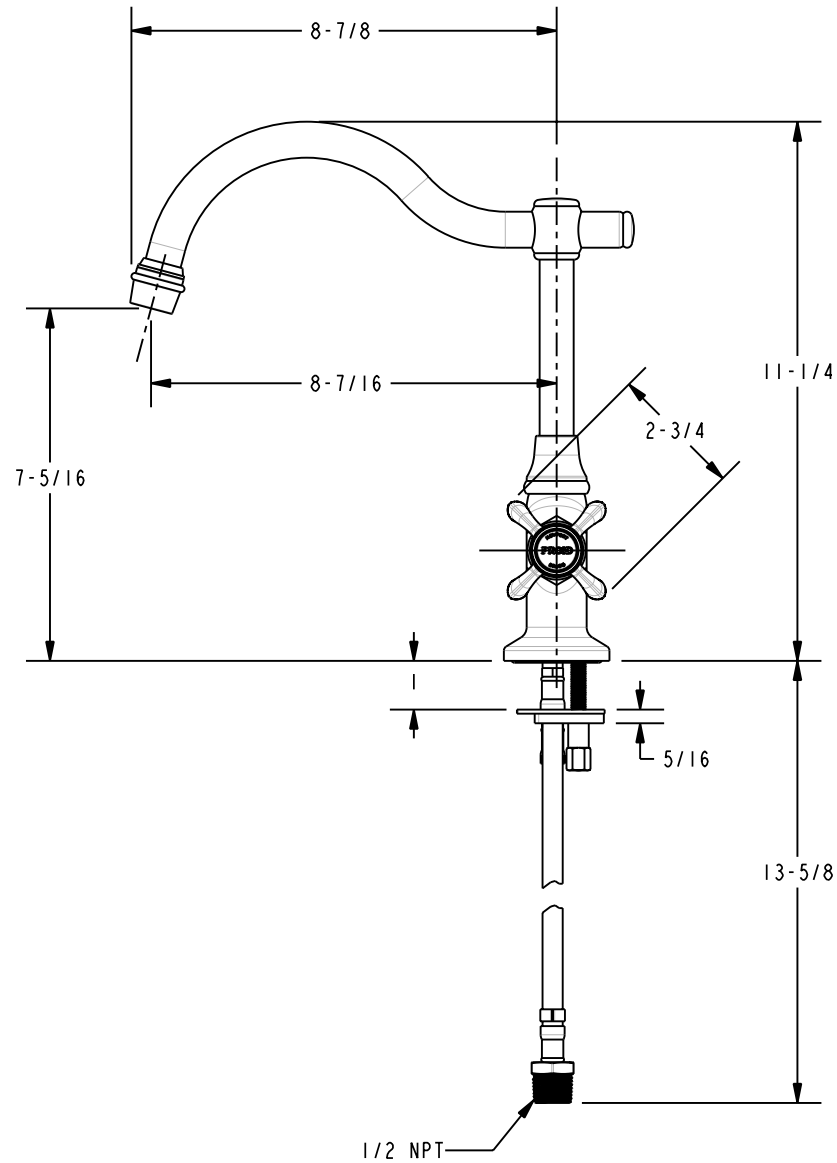

DIMENSIONS ARE IN INCHES AND AN APPROXIMATION OF A TYPICAL INSTALLATION

COPYRIGHT 2004 BRASSTECH, INC. THESE DRAWINGS AND THE DESIGNS DEPICTED HEREIN ARE THE PROPRIETARY PROPERTY OF BRASSTECH. ANY USE OR REPRODUCTION IS SUBJECT TO THE EXPRESS APPROVAL OF BRASSTECH. UNAUTHORIZED USE IS STRICTLY PROHIBITED. ALL RIGHTS RESERVED.

BRASSTECH INCORPORATED		2001 E. CARNEGIE AVE. SANTA ANA, CA 92705 (949) 417-5207
DWG NO.	1688	REV A
SCALE	.250	REF. -
SHEET 2 OF 2		