

NOTES:



TORQUE TO 15-20 LBS.



ATTACH 1/2" ELBOW TO VALVE BODY USING CABLE TIE.

BILL OF MATERIAL (CURRENT LEVEL)

ITEM	PT/ASSY	DESCRIPTION	TYPE	QTY.
1	11989	VALVE BODY, IN-WALL LAV 1/2" NPT	PART	1
2	1-510	T/S CARTRIDGE-COLD	ASSEMBLY	1
3	1-511	T/S CARTRIDGE-HOT	ASSEMBLY	1
4	98042	WARNING LABEL	PART	1
5	92289	1/2" ELBOW	PART	1
6	91476	CABLE TIE	PART	1
7	98029	STICKER, 14-16 FT-LBS TORQUE	PART	2

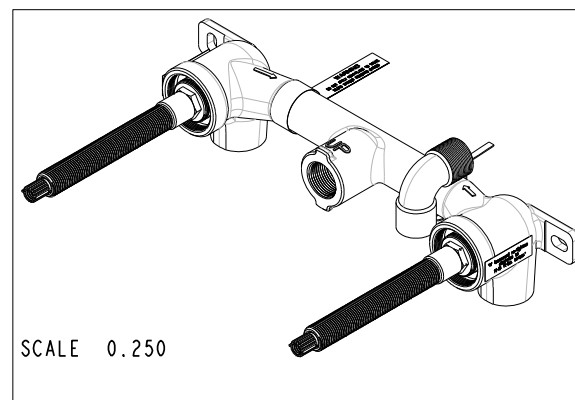
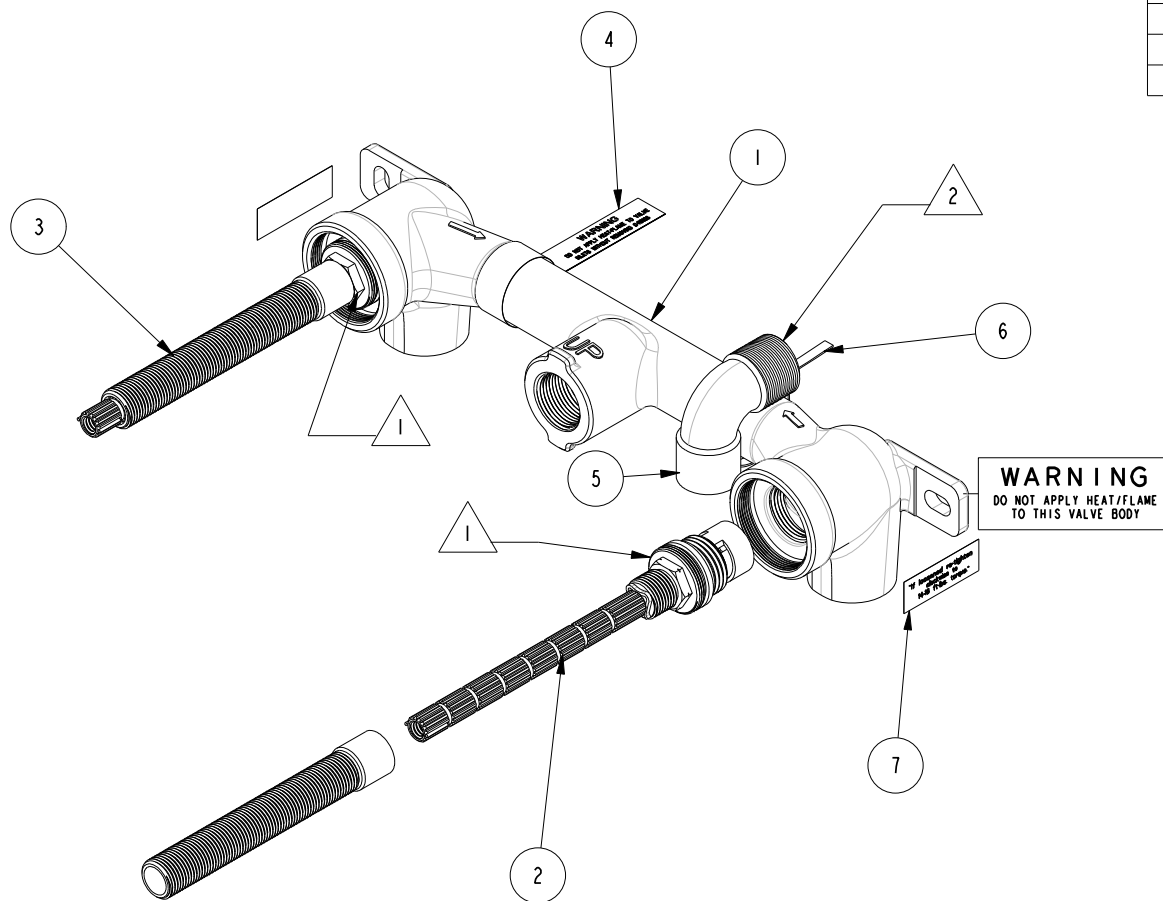

COPYRIGHT 2005 BRASSTECH, INC. THESE DRAWINGS AND THE DESIGNS DEPICTED HEREIN ARE THE PROPRIETARY PROPERTY OF BRASSTECH. ANY USE OR REPRODUCTION IS SUBJECT TO THE EXPRESS APPROVAL OF BRASSTECH. UNAUTHORIZED USE IS STRICTLY PROHIBITED. ALL RIGHTS RESERVED.

BRASSTECH
INCORPORATED
2001 E. CARNEGIE AVE.
SANTA ANA, CA 92705
(949) 417-5207

TUB - VALVE ROUGH

ASSY. NO.	C	EN-2395	12/13/12
1-500	B	EN-1246	06/08/09
SCALE 0.400	REV	REV DESC	DATE