

4

3

2

1

NOTE:



APPLY LIGHT FILM OF SYNTHETIC MULTI PURPOSE SUPER LUBE GREASE  
WWW.SUPER-LUBE.COM, OR EQUIVALENT, TO O-RING AREA

## BILL OF MATERIAL (CURRENT LEVEL)

ITEM	PT/ASSY	DESCRIPTION	TYPE	QTY.
1	80263	BONNET	PART	2
2	80228	ESCUTCHEON	PART	2
3	8-107	HANDLE ASM	ASSEMBLY	2
4	91255	O-RING, (PARKER #2-011)	PART	2
5	80264	ROD - 20 TOOTH	PART	2
6	1-636	ROMAN TUB 2-VALVE ROUGH	ASSEMBLY	1
7	8-099	ROMAN TUB SPOUT ASM	ASSEMBLY	1

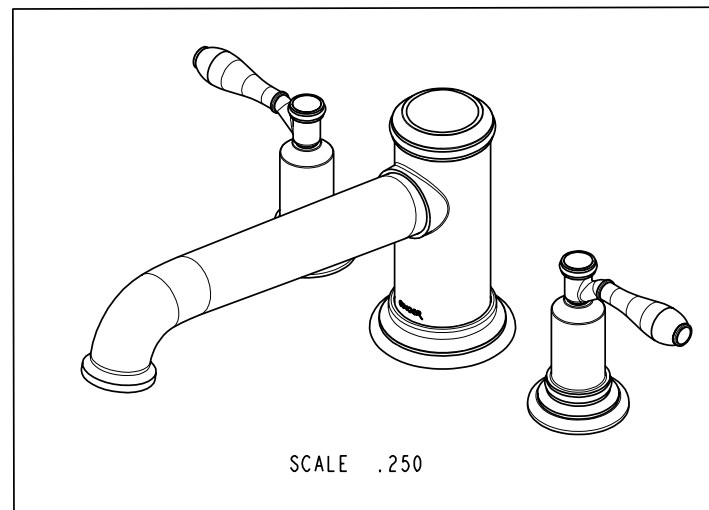
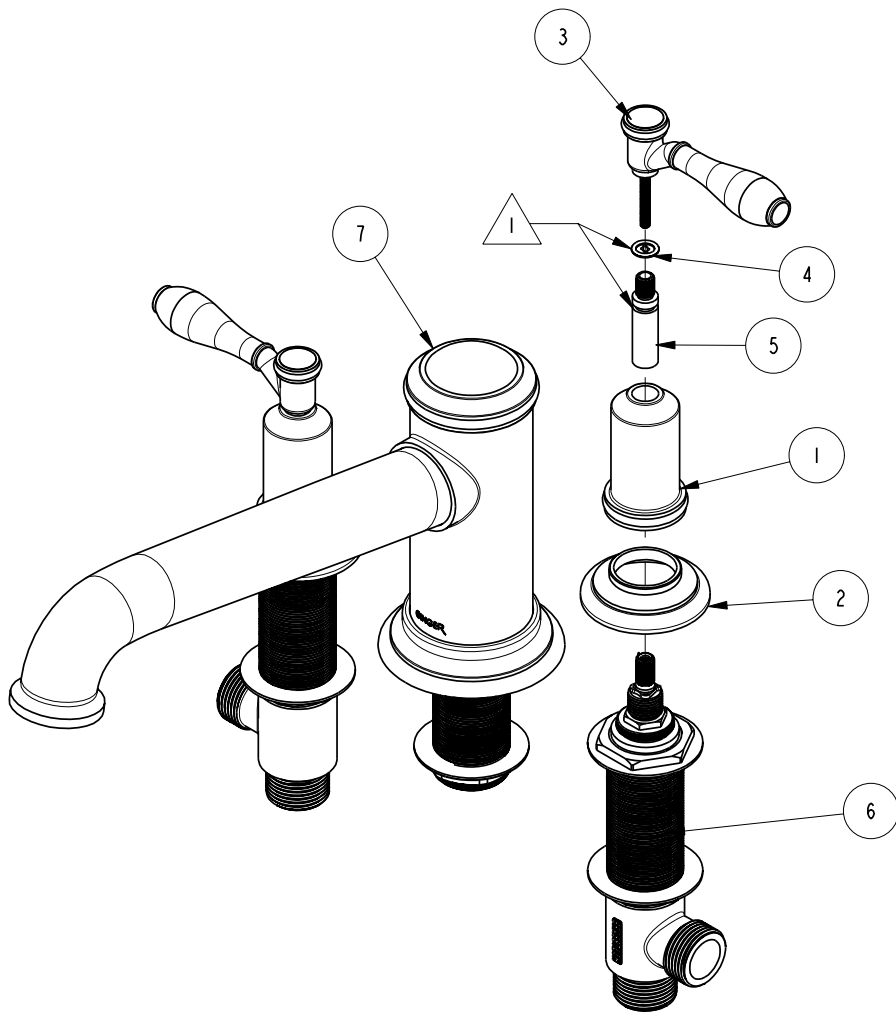

SCALE .250

COPYRIGHT 2005 GINGER. THESE DRAWINGS AND THE DESIGNS DEPICTED HEREIN ARE THE PROPRIETARY PROPERTY OF GINGER. ANY USE OR REPRODUCTION IS SUBJECT TO THE EXPRESS APPROVAL OF GINGER. UNAUTHORIZED USE IS STRICTLY PROHIBITED. ALL RIGHTS RESERVED.

**GINGER**

460-N GREENWAY INDUSTRIAL DRIVE  
FORT WILL, SC 29708  
(803) 547-5786

ROMAN TUB ASM

ASSY. NO.

G45-006

SCALE .320

REF. -

SHEET 1 OF 3

REV

EO-1003

05/30/08

REV DESC

DATE

4

3

2

1

# SPECIFICATION DWG

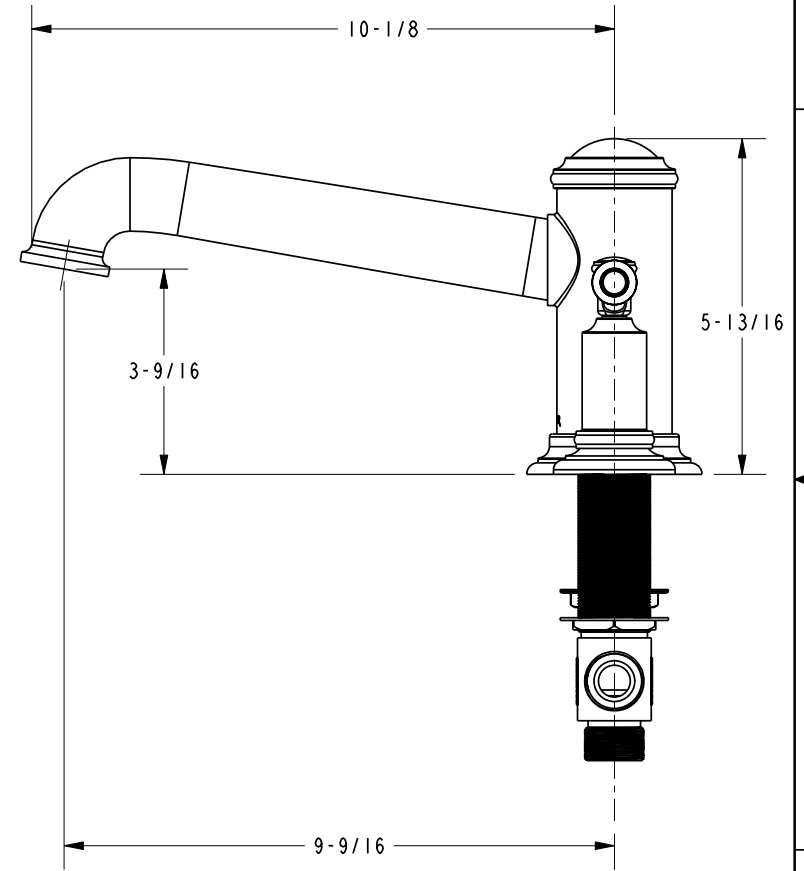
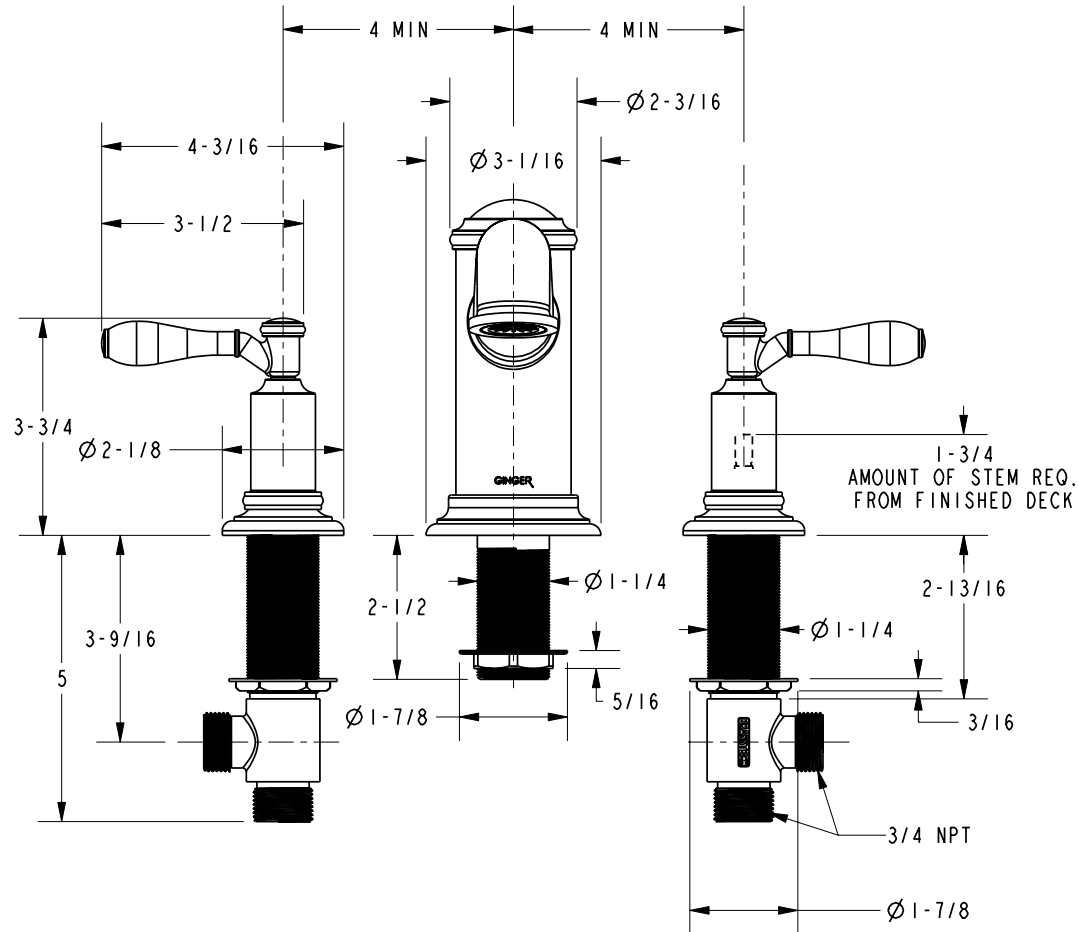

DIMENSIONS ARE IN INCHES AND AN APPROXIMATION OF A TYPICAL INSTALLATION

COPYRIGHT 2005 GINGER. THESE DRAWINGS AND THE DESIGNS DEPICTED HEREIN ARE THE PROPRIETARY PROPERTY OF GINGER. ANY USE OR REPRODUCTION IS SUBJECT TO THE EXPRESS APPROVAL OF GINGER. UNAUTHORIZED USE IS STRICTLY PROHIBITED. ALL RIGHTS RESERVED.

<b>GINGER</b>		460-N GREENWAY INDUSTRIAL DRIVE FORT MILL, SC 29708 (803) 547-5786	
DWG NO.	G45-006		REV -
SCALE .300	REF. -	SHEET 2	OF 3

# SPECIFICATION DWG

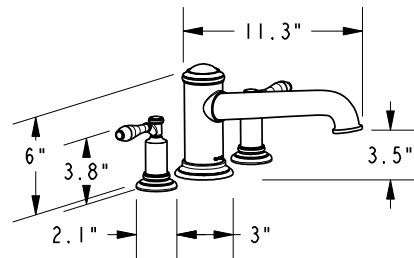

DIMENSIONS ARE IN INCHES AND AN APPROXIMATION OF A TYPICAL INSTALLATION

COPYRIGHT 2005 GINGER. THESE DRAWINGS AND THE DESIGNS DEPICTED HEREIN ARE THE PROPRIETARY PROPERTY OF GINGER. ANY USE OR REPRODUCTION IS SUBJECT TO THE EXPRESS APPROVAL OF GINGER. UNAUTHORIZED USE IS STRICTLY PROHIBITED. ALL RIGHTS RESERVED.

<b>GINGER</b>		460-N GREENWAY INDUSTRIAL DRIVE FORT MILL, SC 29708 (803) 547-5786	
DWG NO.	G45-006		REV -
SCALE .320	REF. -	SHEET 3	OF 3