

BILL OF MATERIAL (CURRENT LEVEL)				
ITEM	PT/ASSY	DESCRIPTION	TYPE	QTY.
1	10288	3/16" POP UP ROD	PART	1
2	10048	ESCUTCHEON W/S VALVE	PART	2
3	10523	HEX ESCUTCHEON BONNET	PART	2
4	325	POP UP ASSEMBLY	ASSEMBLY	1
5	10289	POP-UP KNOB	PART	1
6	2-108	TWIST HANDLE ASM	ASSEMBLY	2
7	1-525	W/S VALVE INSTALLATION	ASSEMBLY	1
8	3-168	WIDE SPREAD SPOUT ONLY	ASSEMBLY	1

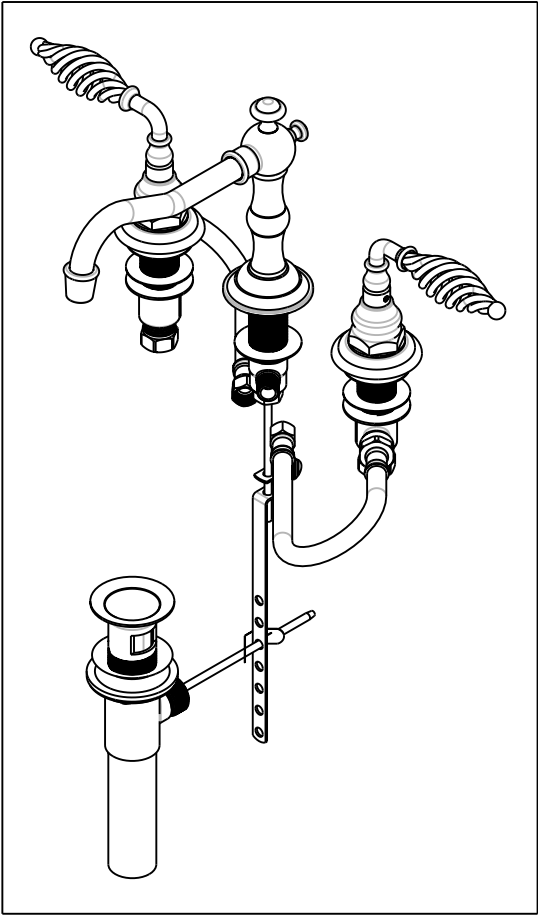

**SPECIFICATION DWG**

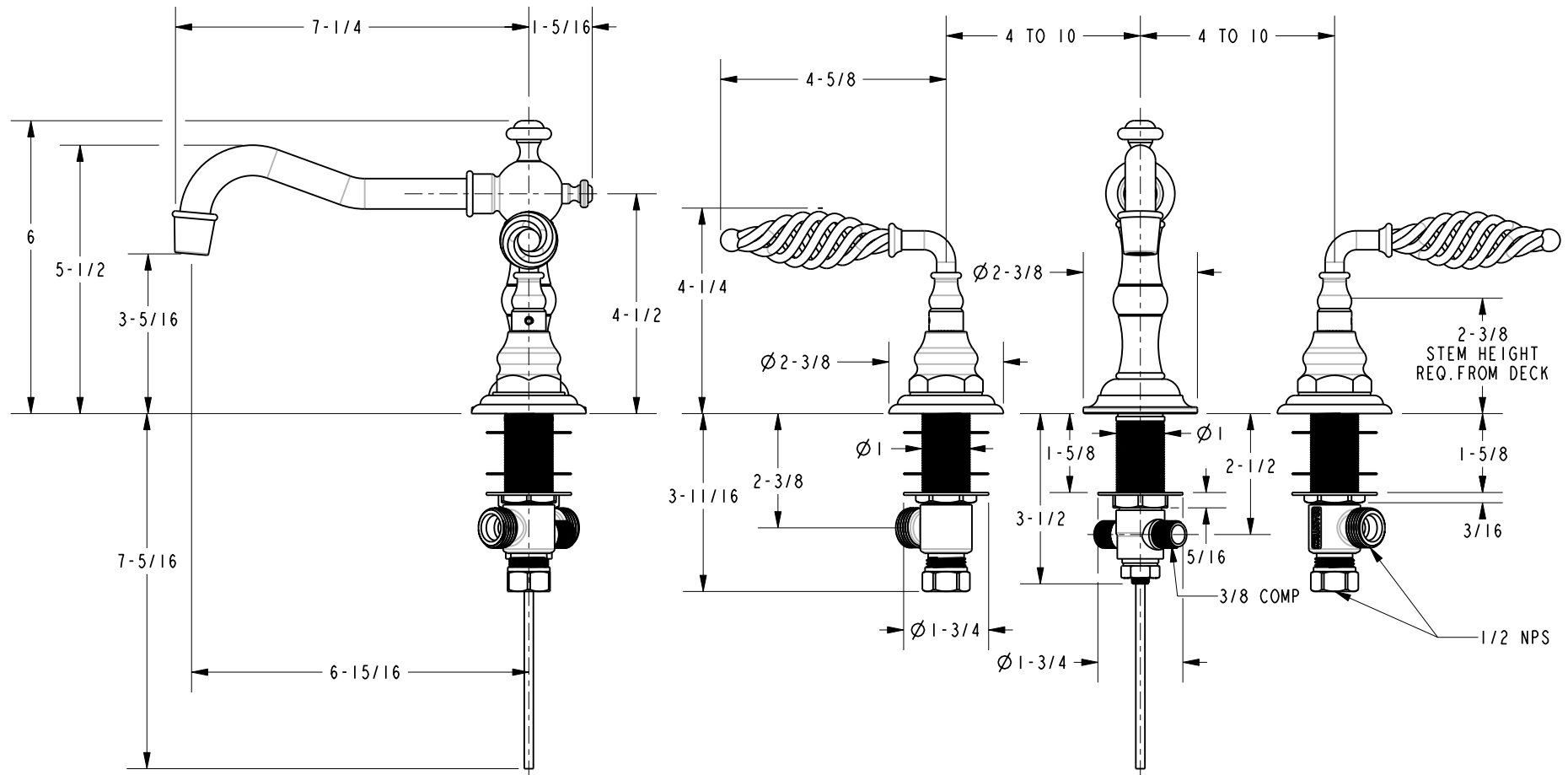

DIMENSIONS ARE IN INCHES AND AN APPROXIMATION OF A TYPICAL INSTALLATION

COPYRIGHT 2005 BRASSTECH, INC. THESE DRAWINGS AND THE DESIGNS DEPICTED HEREIN ARE THE PROPRIETARY PROPERTY OF BRASSTECH. ANY USE OR REPRODUCTION IS SUBJECT TO THE EXPRESS APPROVAL OF BRASSTECH. UNAUTHORIZED USE IS STRICTLY PROHIBITED. ALL RIGHTS RESERVED.

<b>BRASSTECH</b> INCORPORATED		2001 E. CARNEGIE AVE. SALT LAKE CITY, UT 84105 (949) 417-5207	
DWG NO. 2100			REV A
SCALE 0.300	REF. -	SHEET 2 OF 2	