

4

3

2

1

D

C

B

A

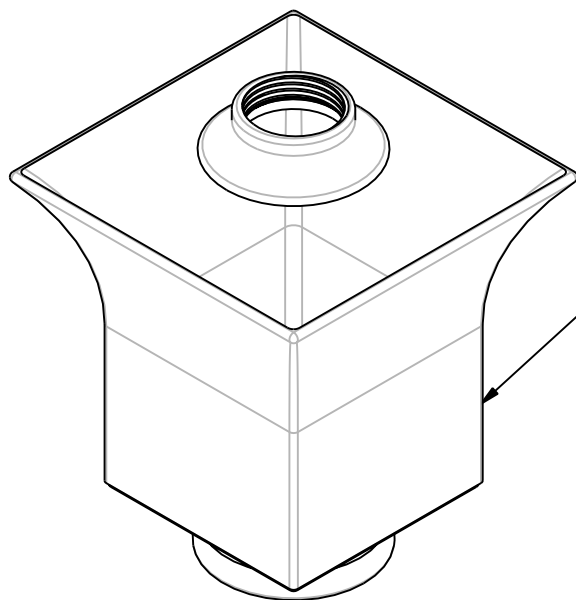

2

1

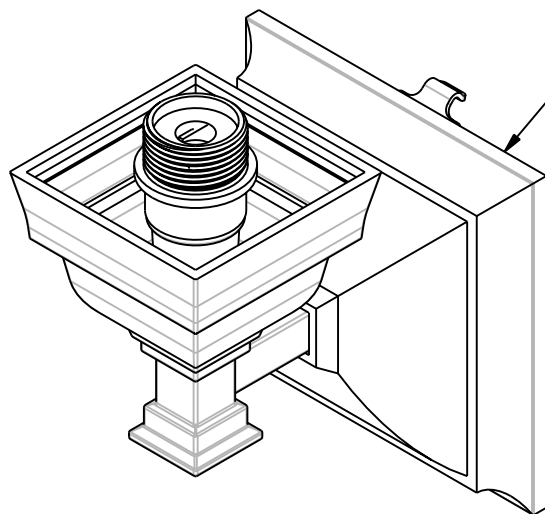

## BILL OF MATERIAL (CURRENT LEVEL)

ITEM	PT/ASSY	DESCRIPTION	TYPE	QTY.
1	19-51	LUM SQ SGL W/O SHADE	ASSEMBLY	1
2	SC	SHADE - PKGD SQ ETH	ASSEMBLY	1

D

C

B

A

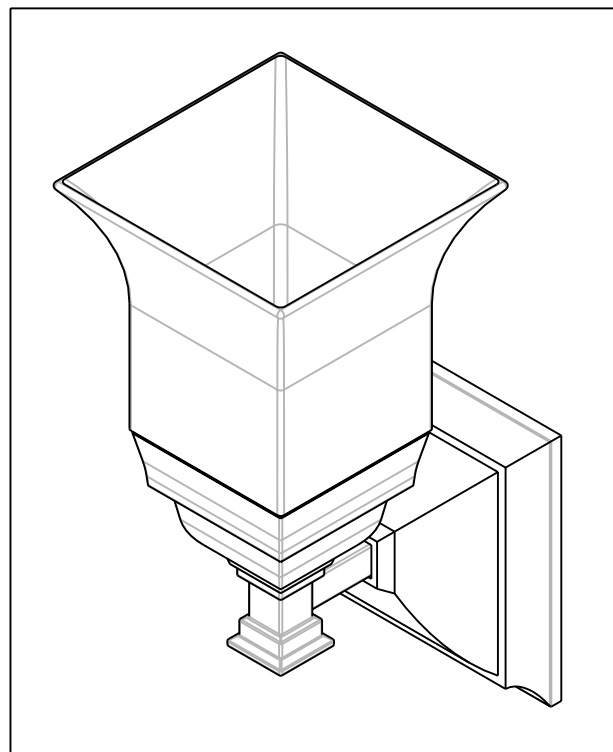

COPYRIGHT 2003 BRASSTECH, INC. THESE DRAWINGS AND THE DESIGNS DEPICTED HEREIN ARE THE PROPRIETARY PROPERTY OF BRASSTECH. ANY USE OR REPRODUCTION IS SUBJECT TO THE EXPRESS APPROVAL OF BRASSTECH. UNAUTHORIZED USE IS STRICTLY PROHIBITED. ALL RIGHTS RESERVED.

**BRASSTECH**  
INCORPORATED

2001 E. CARNEGIE AVE.  
SANTA ANA, CA 92705  
(949) 417-5207

LUM SGL W/ SQ ET SHADE

ASSY. NO.

19-51SC

SCALE 0.500

REF. -

SHEET

OF

REV

RELEASED

02/05/02

REV DESC

DATE

4

3

2

1

4

3

2

1

NOTES:

## SPECIFICATION DWG

D

C

B

A

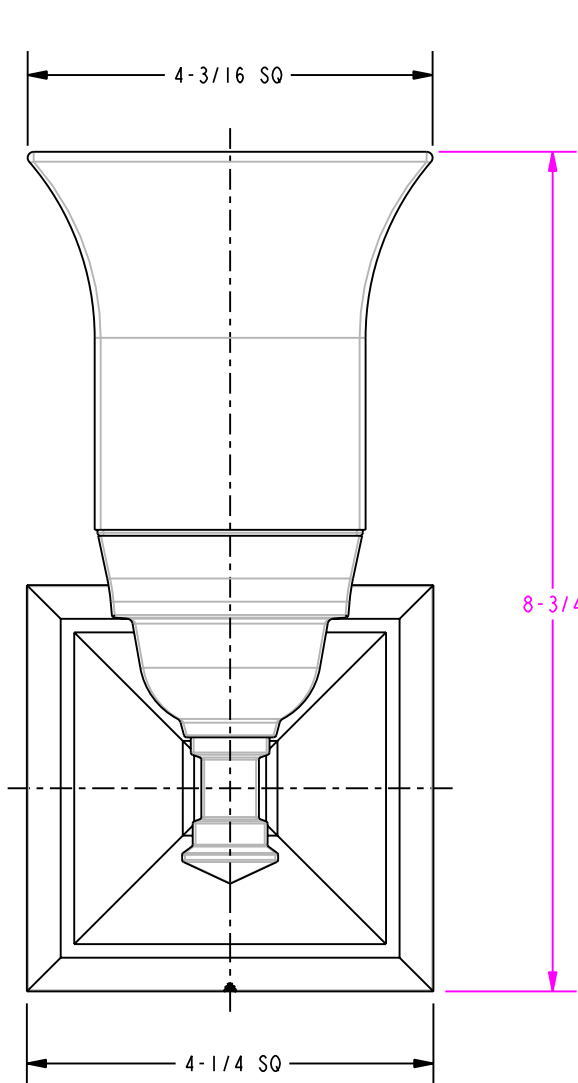

D

C

B

A

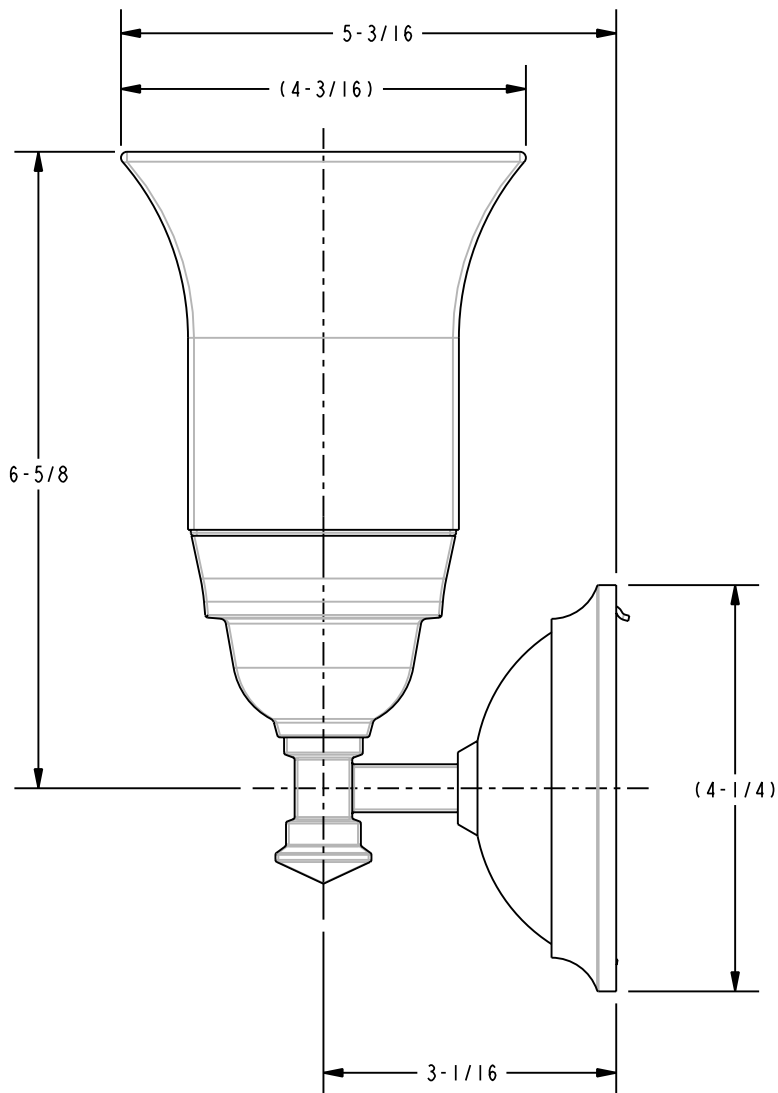

DIMENSIONS ARE IN INCHES AND AN APPROXIMATION OF A TYPICAL INSTALLATION

**BRASSTECH** 2001 E. CARNEGIE AVE.  
INCORPORATED SANTA ANA, CA 92705  
(949) 417-5207

LUM SGL W/ SQ ET SHADE

ASSY. NO.

19-5ISC\_SPEC

-

SCALE 0.500

REF. -

SHEET 1

OF 1

COPYRIGHT ©

4

3

2

1