

USER GUIDE

LED LIGHTED MIRROR



Model: MM2028LEDR, MM2432LEDR, MM2828LEDSQ, MM3232LEDR, 63404040, MM4040LEDSQ, MM5636LEDR, MM6028LEDR

IMPORTANT SAFETY INFORMATION

Please read through this installation instruction so you will know how to install and operate your model properly. Keep this document in a safe place for future reference after use.

WARNING

This product must be installed in accordance with the installation instruction by qualified technician. Failure to follow instruction could result in death or serious bodily injury.

CAUTION

This product must be serviced by qualified personnel. ALWAYS unplug the power cord or turn off the circuit breaker before service.

PACKAGE CONTENTS

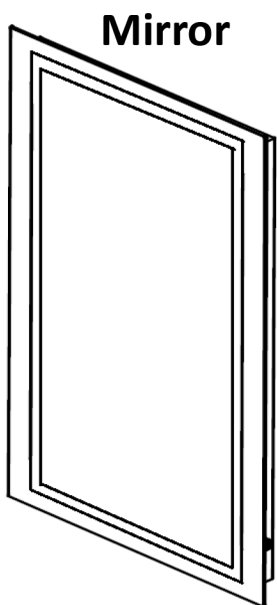

(x1)

Mounting Bracket

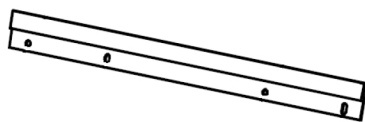

(Model MM2028LEDR x1)
(Model MM2432LEDR x1)
(Model MM3232LEDR x1)
(Model MM5636LEDR x1)
(Model MM6028LEDR x1)

Screw

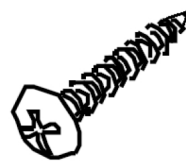

(Model MM2028LEDR x4)
(Model MM2432LEDR x4)
(Model MM3232LEDR x4)
(Model MM5636LEDR x8)
(Model MM6028LEDR x8)

Drywall Anchor



(Model MM2028LEDR x4)
(Model MM2432LEDR x4)
(Model MM3232LEDR x4)
(Model MM5636LEDR x8)
(Model MM6028LEDR x8)

INSTALLATION

1

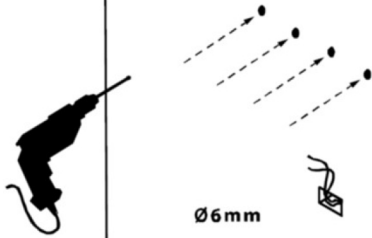

For drywall installation, mark the hole locations and drill Φ 6mm holes for the drywall anchors. Install a junction box behind the mirror for power connections.

2

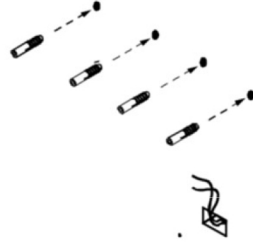

Insert provided drywall anchors.

3

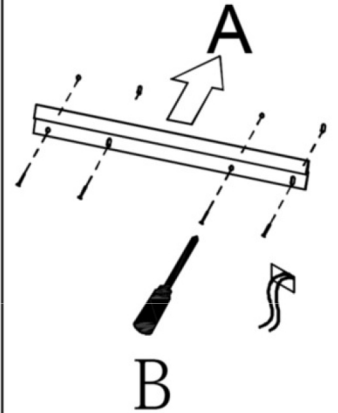

Install the mounting bracket.

4

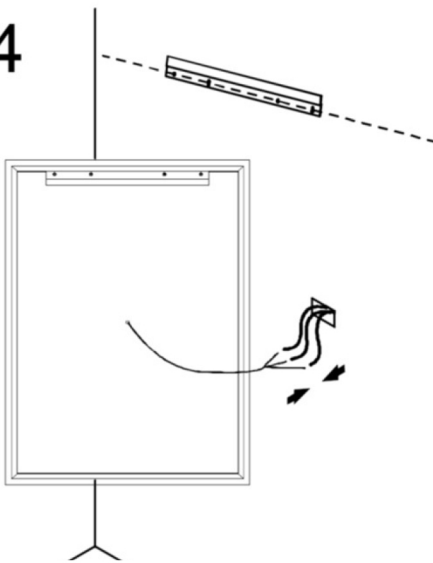

Connect to 120 VAC, 60Hz power supply.

5

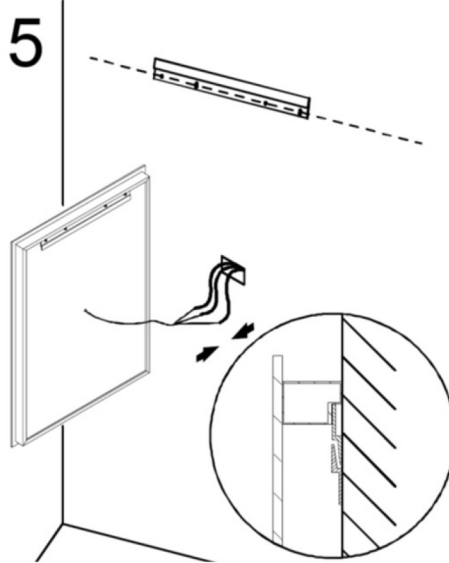

Hang the mirror to the wall and make sure the bracket in the back of the mirror lineup with the mounting bracket properly.

6

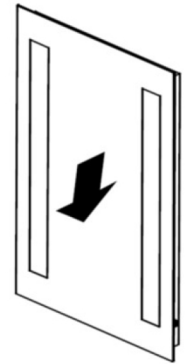

Press the mirror down slightly and make sure the brackets fit properly.



- Using the wall studs to hang the mirror is highly recommended.
- This mirror is NOT designed to work with dimmable wall switch.
- Before fixing the mounting location, please make sure there is no interference to the IR sensor. It requires a minimum clearance of 4-1/2" and will not function normally when interference occurs. Measure from the top of the backsplash if one is used. Remove the objects in vicinity or relocate the mirror and try again.

INSTALLATION DIMENSIONS

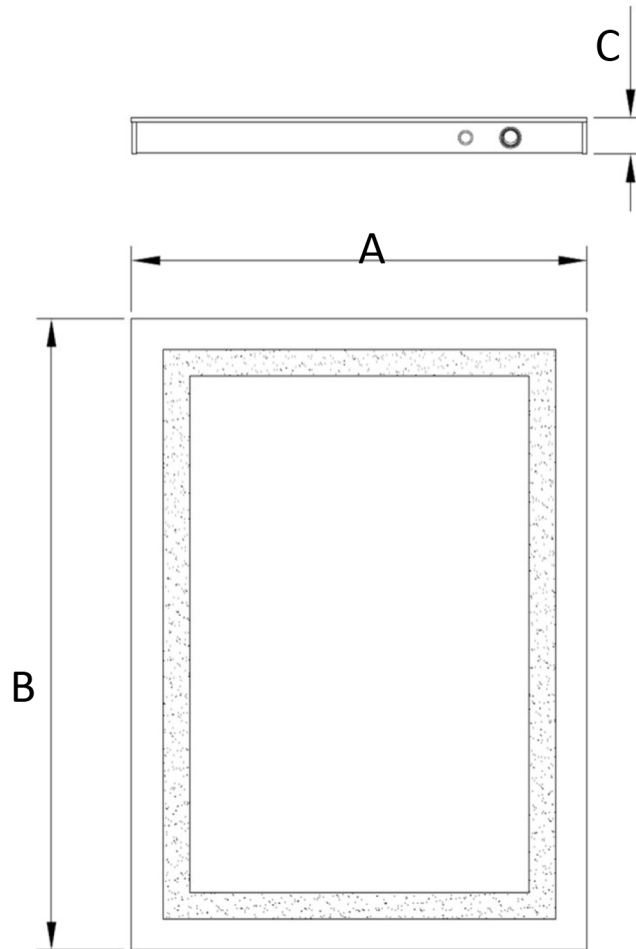

Model #	A	B	C	Brightness (Lumens)	Power Consumption (Watts)
MM2028LEDR	20	28	1 5/8	1110	18
MM2432LEDR	24	32	1 5/8	1350	22
MM3232LEDR	32	32	1 5/8	1600	26
MM5636LEDR	56	36	1 5/8	2460	40
MM6028LEDR	60	28	1 5/8	2350	36
MM3636LEDR	36	36	1 5/8	1620	26
63404040	40	40	1 5/8	2220	35.5
MM2828LEDSQ	28	28	1 5/8	1350	22



1. Rocker switch

- Turn switch to <|> position; lights can be controlled by the IR sensor.
- Turn switch to <O> position to turn off the lights.
- Turn switch to <||> position to turn on the lights.

2. Dimmable IR sensor

- Turn the Rocker switch to <|> position to activate the IR sensor.
- Move your hand across the IR sensor to turn the lights on or off.
- The distance between your hand and the sensor should be approx. 1”.
- To adjust the brightness of the lights, keep your hand in front of the sensor until the desirable brightness has reached and move your hand away from the sensor.
- If the lights flicker, the level of brightness might be too low; try to adjust the brightness to a higher level.



IR sensor requires a minimum clearance of **4-1/2”** and will not function normally when interference occurs. Remove the objects in vicinity or relocate the mirror and try again.

Exploded view

Part	Description
1	Mirror
2	Rocker Switch
3	Dimmable IR Sensor
4	Aluminum Frame
5	Connection Box
6	LED Driver
7	IR Sensor Driver
8	LED Strip Support
9	LED Strip
10	Galvanized Plate
11	Cable Gland
12	Mounting Bracket

