

# USER GUIDE

## LED LIGHTED MIRROR



(Items other than the mirror shown in the picture above are not included)

# IMPORTANT SAFETY INFORMATION

Please read through this installation instruction so you will know how to install and operate your model properly. Keep this document in a safe place for future reference after use.

## **WARNING**

This product must be installed in accordance with the installation instruction by qualified technician. Failure to follow instruction could result in death or serious bodily injury.

## **CAUTION**

This product must be serviced by qualified personnel. ALWAYS unplug the power cord or turn off the circuit breaker before service.

# PACKAGE CONTENTS

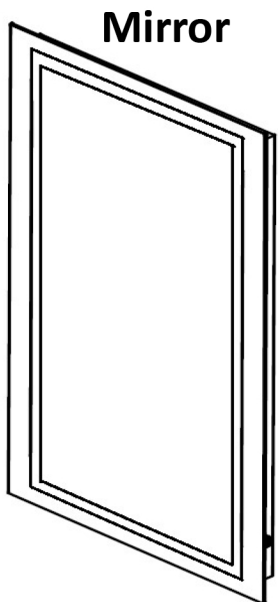

**Mirror**

(x1)

**Mounting Bracket**

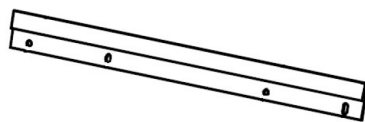

(Model 66202426 x1)

**Screw**

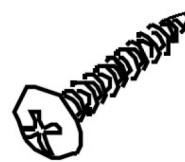

(Model 66202426 x2)

**Drywall Anchor**



(Model 66202426 x2)

- Using the wall studs to hang the mirror is highly recommended.
- This mirror is NOT designed to work with dimmable wall switch.
- Before fixing the mounting location, please make sure there is no interference to the IR sensor. It requires a minimum clearance of **4-1/2"** and will not function normally when interference occurs. Measure from the top of the backsplash if one is used. Remove the objects in vicinity or relocate the mirror and try again.

# INSTALLATION

1

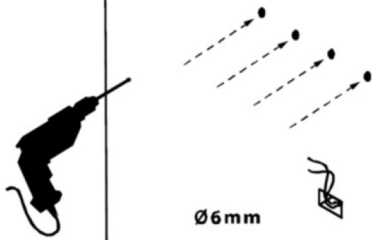

For drywall installation, mark the hole locations and drill  $\Phi$  6mm holes for the drywall anchors. Install a junction box behind the mirror for power connections.

2

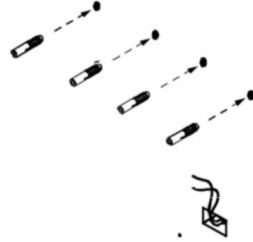

Insert provided drywall anchors.

3

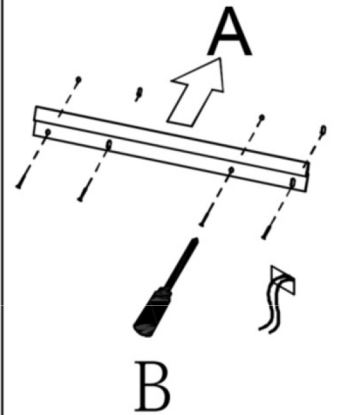

Install the mounting bracket.

4

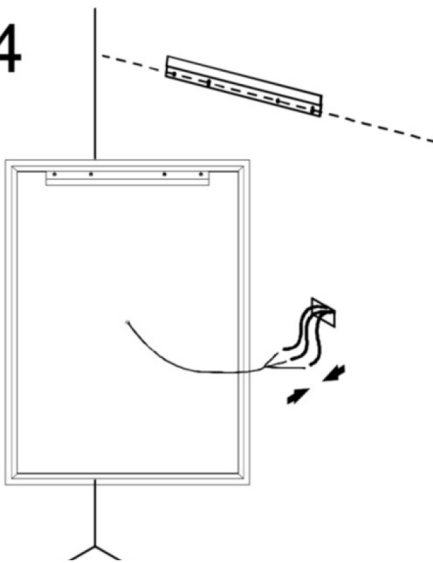

Connect to 120 VAC, 60Hz power supply.

5

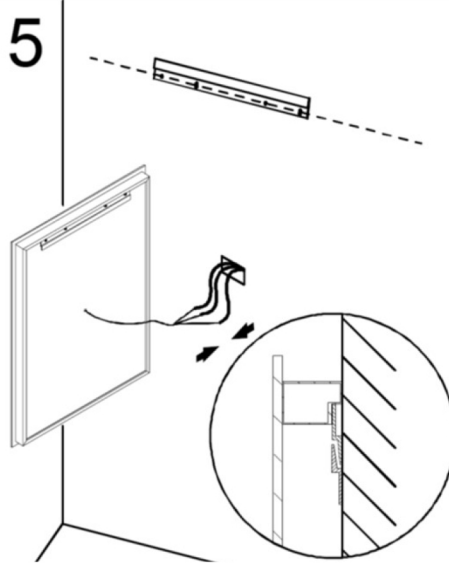

Hang the mirror to the wall and make sure the bracket in the back of the mirror lineup with the mounting bracket properly.

6

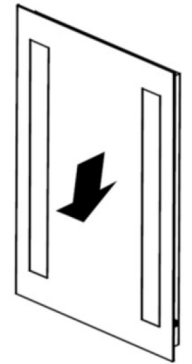

Press the mirror down slightly and make sure the brackets fit properly.



- Using the wall studs to hang the mirror is highly recommended.
- This mirror is NOT designed to work with dimmable wall switch.
- Before fixing the mounting location, please make sure there is no interference to the IR sensor. It requires a minimum clearance of **4-1/2"** and will not function normally when interference occurs. Measure from the top of the backsplash if one is used. Remove the objects in vicinity or relocate the mirror and try again.

# INSTALLATION DIMENSIONS

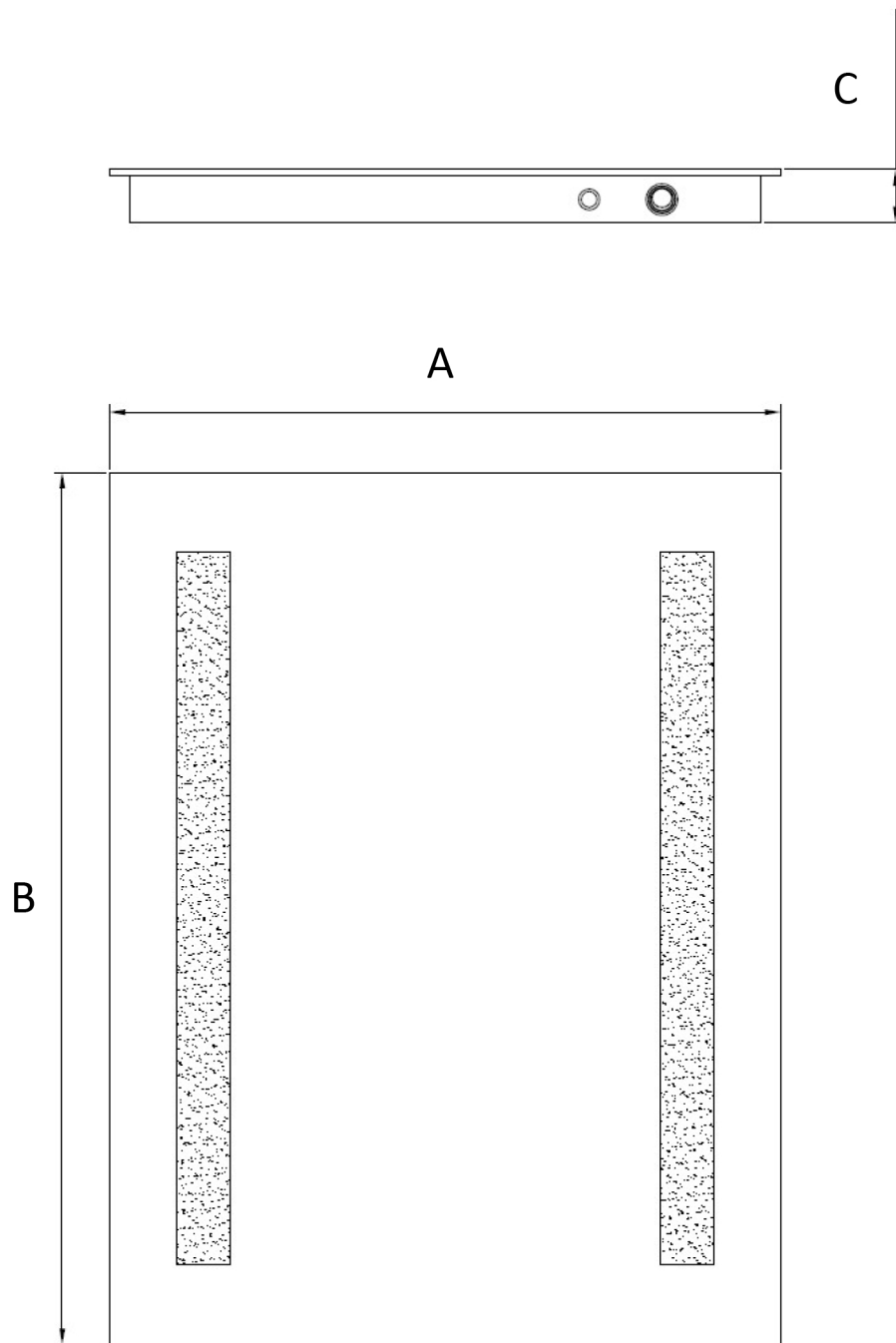

Model #	A	B	C
66202426	24	26	1 5/8

# BASIC OPERATION

## 1. Rocker switch

- a. Turn switch to <|> position; light can be controlled by the IR sensor.
- b. Turn switch to <O> position to turn off the lights.
- c. Turn switch to <||> position to turn on the light to the brightest level.



## 2. Dimmable IR sensor

- a. Turn the Rocker switch to <=> position to activate the IR sensor.
- b. Move your hand across the IR sensor to turn the lights on or off.
- c. The distance between your hand and the sensor should be approx. 1”.
- d. To adjust the brightness of the lights, turn on the lights with the IR sensor. Place your hand in front of the sensor until the desirable brightness has reached and move your hand away from the sensor.
- e. If the lights flicker, the level of brightness might be too low; try to adjust the brightness to a higher level.



IR sensor requires a minimum clearance of **4-1/2”** and will not function normally when interference occurs. Remove the objects in vicinity or relocate the mirror and try again.