

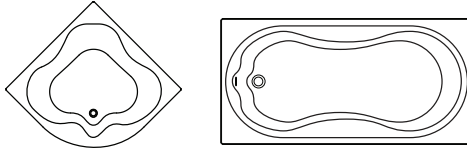

REVISION 09-29-2008



INSTALLATION & OPERATING INSTRUCTIONS FOR LUXURY BATHTUBS

SAVE THIS MANUAL: RETAIN FOR CONSUMER'S USE.

READ THESE INSTRUCTIONS COMPLETELY BEFORE INSTALLING THE PRODUCT: IF YOU HAVE ANY QUESTIONS CALL 1-800-426-8964.

**YOU MUST FOLLOW ALL INSTRUCTIONS IN THIS MANUAL:
FAILURE TO DO SO WILL RESULT IN YOUR ASSUMPTION OF LIABILITY. FAILURE TO COMPLY WITH ALL INSTRUCTIONS CAN RESULT IN PRODUCT DAMAGE AND PERSONAL INJURY.**

THIS PRODUCT COMPLIES WITH MANY NATIONALLY RECOGNIZED STANDARDS SUCH AS: ANSI Z124.1- 9, ASME A112, IAPMO AND UL 1795. YOU ARE RESPONSIBLE FOR ANY LOCAL CODES THAT MAY APPLY.

**THIS PRODUCT IS DESIGNED TO BE INSTALLED BY A LICENSED TRADESMEN.
LICENSED PLUMBERS AND ELECTRICIANS SHOULD BE EMPLOYED TO INSURE PROPER INSTALLATION. INSTALLERS ASSUME ALL LIABILITY FOR THE CORRECT INSTALLATION PROCEDURES.**

**Only accessories authorized by the manufacturer should be used with this product.
THIS PRODUCT IS DESIGNED FOR RESIDENTIAL USE AND USE BY HEALTHY INDIVIDUALS.**

IMPORTANT SAFETY INSTRUCTIONS:

WARNING! WHEN USING THIS PRODUCT, BASIC PRECAUTIONS SHOULD ALWAYS BE FOLLOWED. READ AND FOLLOW ALL INSTRUCTIONS PERTAINING TO RISK OF FIRE, ELECTRIC SHOCK, OR INJURY TO PERSONS

DANGER: To reduce the risk of injury, do not permit children to use this product unless they are closely supervised at all times.

WARNING: RISK OF ACCIDENTAL INJURY OR DROWNING; CHILDREN SHOULD NOT USE HYDROMASSAGE BATHTUB WITHOUT ADULT SUPERVISION;

WARNING: RISK OF ACCIDENTAL INJURY OR DROWNING; DO NOT USE HYDROMASSAGE BATHTUB UNLESS ALL SUCTION GUARDS ARE INSTALLED TO PREVENT BODY AND HAIR ENTRAPMENT;

WARNING: TO AVOID INJURY, EXERCISE CARE WHEN ENTERING OR EXITING THE HYDROMASSAGE BATHTUB;

WARNING: RISK OF ACCIDENTAL INJURY OR DROWNING; DO NOT USE DRUGS OR ALCOHOL BEFORE OR DURING THE USE OF A HYDROMASSAGE BATHTUB EQUIPPED WITH HEATER TO AVOID UNCONSCIOUSNESS AND POSSIBLE DROWNING;

WARNING: RISK OF FETAL INJURY; PREGNANT OR POSSIBLY PREGNANT WOMEN SHOULD CONSULT A PHYSICIAN BEFORE USING A HYDROMASSAGE BATHTUB EQUIPPED WITH HEATER;

WARNING: RISK OF HYPERTHERMIA AND POSSIBLE DROWNING; DO NOT USE A HYDROMASSAGE BATHTUB EQUIPPED WITH HEATER IMMEDIATELY FOLLOWING STRENUOUS EXERCISE;

WARNING: RISK OF ELECTRIC SHOCK; DO NOT PERMIT ELECTRIC APPLIANCES (SUCH AS A HAIR DRYER, LAMP, TELEPHONE, RADIO, OR TELEVISION) WITHIN 1.5 M (5 FT) OF THIS HYDROMASSAGE BATHTUB;

CAUTION: TEST THE GROUND FAULT CIRCUIT INTERRUPTER PROTECTING THIS APPLIANCE PERIODICALLY IN ACCORDANCE WITH THE MANUFACTURER'S INSTRUCTIONS;

WARNING: RISK OF HYPERTHERMIA AND POSSIBLE DROWNING; WATER TEMPERATURE IN EXCESS OF 38°C (100°F) MAY BE INJURIOUS TO YOUR HEALTH. CHECK AND ADJUST WATER TEMPERATURE BEFORE USE;

WARNING: RISK OF HYPERTHERMIA; PEOPLE USING MEDICATIONS AND/OR HAVING AN ADVERSE MEDICAL HISTORY SHOULD CONSULT A PHYSICIAN BEFORE USING A HYDROMASSAGE BATHTUB EQUIPPED WITH HEATER. PROLONGED IMMERSION IN WATER HOTTER THAN NORMAL BODY TEMPERATURE MAY INDUCE HYPERTHERMIA. TEST THE WATER TEMPERATURE AND ADJUST THE TEMPERATURE-REGULATING CONTROL TO REACH A WATER TEMPERATURE IN THE TUB NO HIGHER THAN 38°C (100°F) AND NECESSARY PRECAUTIONS MUST BE FOLLOWED IN ADJUSTING THE THERMOSTAT. **WARNING:** THE USE OF ALCOHOL OR DRUGS CAN GREATLY INCREASE THE RISK OF FATAL HYPERTHERMIA IN HOT TUBS AND SPAS. THE CAUSES, SYMPTOMS, AND EFFECTS OF HYPERTHERMIA MAY BE DESCRIBED AS FOLLOWS. HYPERTHERMIA OCCURS WHEN THE INTERNAL TEMPERATURE OF THE BODY REACHES A LEVEL SEVERAL DEGREES ABOVE THE NORMAL BODY TEMPERATURE OF 98.6°F (37°C). THE SYMPTOMS OF HYPERTHERMIA INCLUDE DROWSINESS, LETHARGY, AND AN INCREASE IN THE INTERNAL TEMPERATURE OF THE BODY. THE EFFECTS OF HYPERTHERMIA INCLUDE:

- 1) UNAWARENESS OF IMPENDING HAZARD;
- 2) FAILURE TO PERCEIVE HEAT;
- 3) FAILURE TO RECOGNIZE THE NEED TO EXIT HYDROMASSAGE BATHTUB;
- 4) PHYSICAL INABILITY TO EXIT HYDROMASSAGE BATHTUB;
- 5) FETAL DAMAGE IN PREGNANT WOMEN; AND
- 6) UNCONSCIOUSNESS AND DANGER OF DROWNING.

UNPACKING THE UNIT

1. Inspect the carton.
2. If you note carton damage, take a picture if possible and contact the deliverer.
3. Immediately inspect the unit for damage even if there is no visible carton damage. Once the unit is installed and there is surface damage visible, we will assume it was caused by the installer if you do not report it immediately. Installers are responsible for damage that occurs once the unit is placed in its assigned location.
4. Inspect the plumbing for any loose fittings.
5. On whirlpool units the unions on the suction and discharge sides of the pump have been marked to indicate the alignment that was present at the factory water test. If these are not aligned, retighten and test for water tightness.
6. Remove all packaging material except for the protective plastic. It was placed on the tub at the factory to eliminate abrasions from handling. It should only be removed at the final clean up.

Mirabelle Electrical Requirements

1. ALL CONNECTIONS MUST BE GFCI (Ground Fault Circuit Interrupter) PROTECTED
2. Whirlpool, Air Baths, and Total Massage units require dedicated 20 amp, 120 volt service.
3. You must provide a receptacle with a 20 amp configuration.
4. See local codes for proper wire size, if not specified, use #12 Copper only wire.
5. If you use an optional heater, then it will require its own dedicated 20 amp service.
6. Total Massage units require only one 20 amp service. However if a heater is used then a second 20 amp service is required.

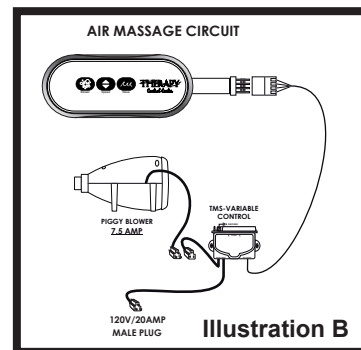
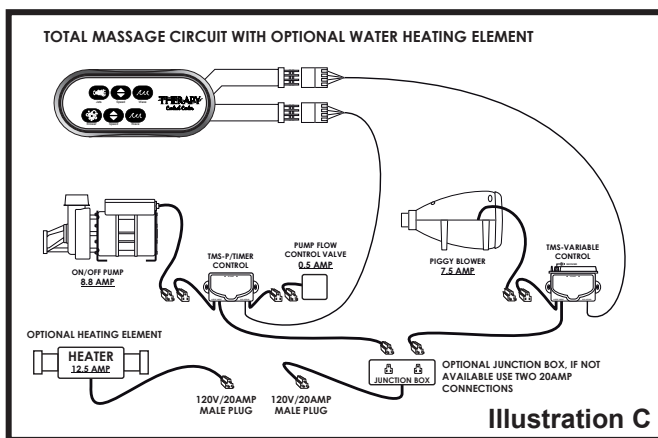

IN LINE HEATERS ALWAYS REQUIRE THEIR OWN DEDICATED 20 AMP, 120 VOLT, GFCI PROTECTED CIRCUIT.

IMPORTANT SAFETY INSTRUCTIONS:

WARNING! WHEN USING THIS PRODUCT, YOU SHOULD ALWAYS FOLLOW BASIC PRECAUTIONS. READ AND FOLLOW ALL INSTRUCTIONS PERTAINING TO RISK OF FIRE, ELECTRIC SHOCK, OR INJURY TO PERSONS

1. To install an in-line heater, simply unscrew the unions and remove the blank. The threaded pieces should remain on both sides of the pipe section.
 2. Insert the in-line heater and tighten the unions of the in-line heater to the remaining threaded portion of the heater blank.
- DANGER: To reduce the risk of injury, do not permit children to use this product unless they are closely supervised at all times.
 - Use this unit only for its intended purpose as described in this bulletin. Do not use attachments that are not recommended by the manufacturer.
 - Never drop or insert any objects into any openings.
 - The unit must be connected to a circuit interrupter (GFCI). Such a circuit is provided by the installer and should be tested on a routine basis. To test the GFCI push the test button. The GFCI should interrupt power. Push the RESET button. Power should be restored. If the GFCI fails to operate in this manner, there is ground current flowing, indicating the possibility of an electrical shock. Do not use this unit. Disconnect the unit and have the problem corrected by a qualified service representative before using.
 - Traction enhanced-textured tub bottom must remain clean to minimize slippage.
 - DANGER: RISK OF ELECTRICAL SHOCK. All pumps and heaters must be connected to a ground fault circuit interrupter (GFCI) protected outlets. Standard Line Total Massage units can be operated on a single service. In line heater must always be connected to a dedicated service.

MODEL	"L" LENGTH	"W" WIDTH	"D" HEIGHT TO DECK	"H" HEIGHT TO LIP	"A" DRAIN LOCATION	"B" DRAIN LOCA- TION
MIRS6036, MIRW6036, MIRA6036, MIRT6036	60"	36"	22"	20 1/2"	9 1/2"	18"
MIRS6042, MIRW6042, MIRA6042, MIRT6042	60"	42"	22"	20 1/2"	8 3/4"	30"
MIRS6060, MIRW6060, MIRA6060, MIRT6060	60"	60"	24"	22 1/2"	12"	41"
MIRS6640V, MIRW6640V, MIRA6640V, MIRT6640V	66"	40"	22"	20 1/2"	10"	33"
MIRS7236, MIRW7236, MIRA7236, MIRT7236	72"	36"	22"	20 1/2"	9 1/2"	18"
MIRS7242, MIRW7242, MIRA7242, MIRT7242	72"	42"	22"	20 1/2"	8 1/2"	36"
MIRS7242V, MIRW7242V, MIRA7242V, MIRT7242V	72"	42"	22"	20 1/2"	11"	36"
MIRS6636, MIRW6636, MIRA6636, MIRT6636	66"	36"	22 1/2"	21"	9 1/4"	18"
MIRS7140, MIRW7140, MIRA7140, MIRT7140	71"	40"	22 1/2"	19 1/2"	11 1/2"	35 1/2"

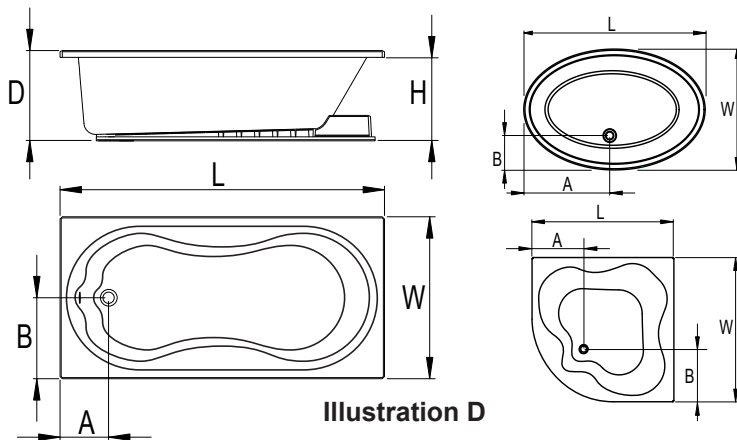

Illustration D

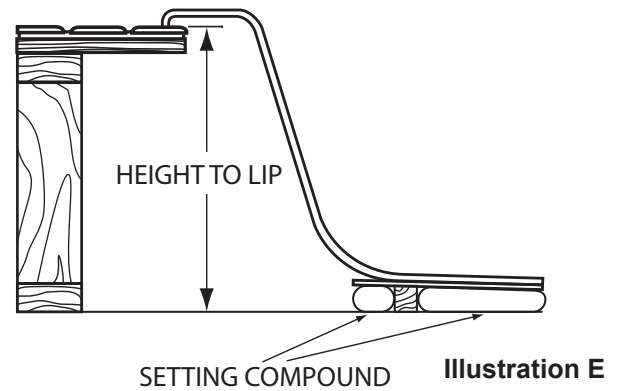

Illustration E

INSTALLATION PLANNING AND PREPARATION

- NEVER LIFT THE TUB BY THE PLUMBING.** Doing so can result in leaks.
- Check if the floor is level and of good quality. An uneven floor may impede proper installation of the product. The Floor structure must be capable of supporting at least 100 pounds per square foot.
 - Clean the area of any debris or trash.
 - Use a 5 or 6 foot level and determine if the floor is level. If it is not, calculate how much mortar you have to use to level the tub.
 - Insure that you place the drain rough at the proper location.
 - Check if the installer placed the proper electrical service near the pump location. See electrical requirements for specifications.
- If this is a deck installation, measure from the floor to the bottom of the rim to ensure that the tub is not suspended by its rim.

You should always have the entire tub floor fully supported.

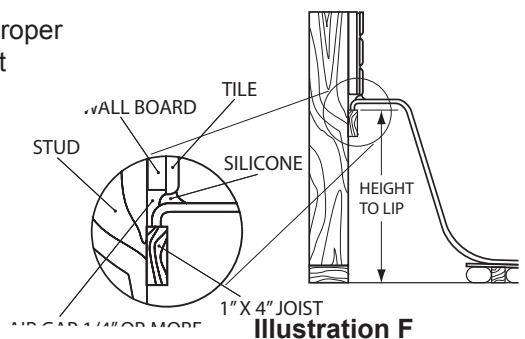

Illustration F

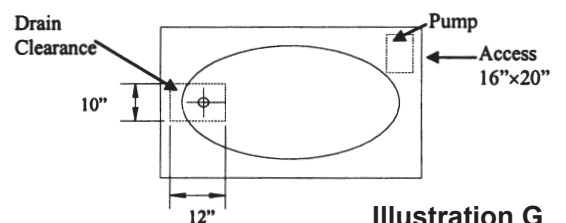

Illustration G

INSTALLATION PROCEDURES:

Installation must comply with local and national codes.

WARNING: When installing Whirlpools, Air, or Total Massage Baths, observe basic precautions, including the following:

DANGER: RISK OF ELECTRICAL SHOCK! Connect only to a separate circuit protected by a ground fault circuit interrupter (GFCI)

Installation must provide access for servicing pump/motor.

1. Install tub waste/ overflow fitting according to instructions provided.
 2. Construct support framing for the tub, allowing for a **16" X 20"** access opening for servicing the pump/motor on whirlpool models.
 3. **DECK / PENINSULAR INSTALLATION** - Deck surface can be any width. Allow for the thickness of the wall board and tile or other surface material between the deck (see "Height to Lip" illustration E & F) and underside of the tub lip.
 4. **ALCOVE / CORNER INSTALLATION** - Wooden 1" X 4" support stringers **must be attached** to surrounding walls at the recommended height. If you use a skirt, refer to the specific skirt installation instructions provided with that product.
- NOTE:** Alcove and corner installations may require the use of a Tile Flange Kit (Part# TLK and TLKC) to prevent water from penetrating the wall board. After the framing is complete, set the product in place to check the fit and make certain that it can be properly leveled. (**Caution:** if the tub is not level (use the deck surface for checking the level) water will not drain properly.)

WARNING: Never support the tub by its deck-lip or stringers, as this could result in product failure and void the Warranty. Level and fill the tub with water and test it for proper operation and drainage or possible water leaks due to transit-handling damage. Remove the tub from its framing.

5. The tub **MUST** be supported from the tub bottom and not the tub lip. The lip should only rest on the finished deck surface or support stringers. The tub bottom must be supported by a setting compound such as cement or mortar (fast cure materials are not recommended due to excessive shrinkage). A sheet of plastic film, both under and on the top of compound is recommended as a barrier. The tub should be set in place (do not handle the whirlpool by the piping) while the compound is still soft and that the compound will conform to the tub bottom. The tub should be worked down into the compound lip of the tub. It should just barely make contact with the finished deck surface or support stringers. It may be necessary to partially fill the tub with water to aid in properly setting the tub.
6. Verify that the product is level by checking the tub deck surface.
7. Place the fill spout and supply lines at your desired location. If you are installing the spout and supply lines on the deck of the tub, mark the location first and drill pilot holes from the acrylic side of the product. Use a properly sized hole saw, and drill the spout and supply line holes from the acrylic side of product.
8. Connect the water supply lines and the waste overflow.
9. Plug the pump cord into specified dedicated 120V/20A GFCI outlet to supply electrical power to the system. The cord and the plug is shipped with your system.
10. After plumbing and electrical connections have been made the tub should be cleaned of dirt and debris. Follow "Cleaning and Maintenance" instructions in these instructions.
11. In finish-out of Corner/Alcove installation, be certain to allow for an expansion gap between wall board and tub deck as well as between tile or other water material and tub deck.

INSTALLING AN OVAL TUB WITH A TEMPLATE

The back section of the installation manual contains oval cut out instructions. Use pencil and tape measure to plot the coordinates and draw the cut out. Take special care that you do not to drop the tub in the platform cutout, because the tub might break and the ensuing warranty limitations would become effective. For additional questions on installing your tub read "installation procedures" above.

TESTING THE BATH

1 Installation is not complete until the bath has been water tested.

All baths are operationally tested at the factory and certified to be free of leaks. Transportation and handling may result in leaks developing. It is necessary to test the bath while there is access to all sides of the bath.

2 The unit should be both static and operationally tested.

- i. Seal the drain and fill the tub to a normal level.
- ii. Allow the tub to stand for 5 minutes and then inspect all plumbing for leaks.
- iii. After performing the preceding test, now operate each pump and inspect for leaks. Again inspect the unions around the pump. If leaks persist from the unions after tightening; loosen the unions and insure that the O-ring is seated properly.
 1. If the pumps do not operate;
 - a. Check the breaker to insure power is on
 - b. Check the connections at the switch and pump ends to insure they are securely attached.
3. **Do not run any pumps or heaters unless the tub is filled with water to 1" below the overflow.** Damage due to dry running pumps is not covered under warranty.
4. If power is not available, then a hose should be used to fill the tub with water and a static test inspection performed.

Failure to perform these tests immediately after the tub is installed will make the installer liable for future repair costs.

CLEANING AND MAINTENANCE

Air Baths are equipped with an Automatic Cleaning and Purge Cycle

Air Baths have a pre-programmed cleaning and purge cycle built in to expel the remaining water in the air channels. It activates within 20 minutes after the Air Bath is turned off and then blows for about 2 to 3 minutes. After the cycle is completed it will shut off automatically. There is nothing to be alarmed about if you hear a blowing noise coming from the tub after the tub has been turned off. The noise you hear is the cleaning cycle in operation.

Pump and pipe circulation system should be flushed before first use and on a monthly basis when product is under normal use. Below are the recommended procedures for cleaning:

- **DO NOT RUN WHIRLPOOL DRY.** Fill the tub with hot water 2-3 inches above the jets and add 2-3 teaspoons of low foaming detergent such as dish washing machine detergent. Make certain the air control(s) are turned completely clockwise and are off.
- Switch on whirlpool and run for 10 minutes.
- Drain tub completely.
- Fill tub with cold water above jets.
- Switch on whirlpool and run for 5 minutes.
- Drain tub completely.

DO NOT USE ABRASIVE CLEANERS as they will scratch and dull the surface of the acrylic.

Plaster can be removed using a sharpened wooden stick. **DO NOT USE METAL SCRAPERS, WIRE BRUSHES OR OTHER HARSH ABRASIVE TOOLS.** Usually a mild detergent will remove construction debris. More stubborn debris may be removed with denatured alcohol, or Clorox Soft Scrub® cleaner. Light scratches and dulled areas may be restored to original luster by rubbing with an automotive type cleaning compound such as DuPont White Polishing Compound®.

OPERATING INSTRUCTIONS

1. Fill the bath at least to 3 inches above the jets before activating the pump.
2. The air bath blower and/or whirlpool pump is activated by depressing the control panel buttons. Do not repeatedly depress the switch in rapid order if you do not see the whirlpool function right away, as it may take a few seconds before you can see it fully operating. Please see air bath control or Total Massage Control instructions on the following page for operation and features.
3. If any factory installed fittings are removed; do not operate the unit. A safety hazard may occur.
4. Do not use bubble bath when you operate the whirlpool pump. This might cause excessive foaming.
5. Bath oils may be used; however their frequent use will require more frequent purging and cleaning of the systems.
6. Both air and whirlpool systems are plumbed in a way that water will drain from the plumbing easily.
7. There are no user serviceable parts located under the tub.

JET OPERATION AND ADJUSTMENT

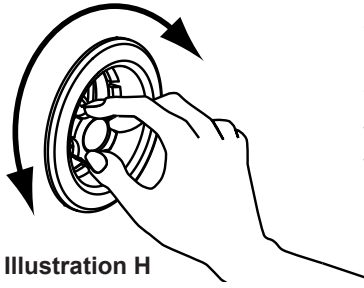

Illustration H

The jets can be easily adjusted by pointing the jet-nozzle in the desired direction. The strength of the water flow and air induction can be regulated through twisting the jet-nozzle. Twisting the nozzle clockwise will decrease the water flow and finally completely turn off the water flow of that particular jet. If the nozzle is twisted counter clockwise then the water flow will increase up to its maximum flow.

WHIRLPOOL CONTROL CENTER FEATURES

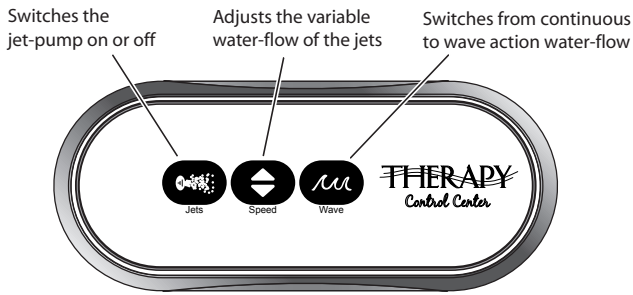

Illustration I

The whirlpool is controlled by a three button control.

1. The first button switches the water-pump on or off. The other features will not operate unless the pump is turned on.
2. The second button sets the power level of the pump. Holding the button depressed will cycle the pump power from low to high in a continuous cycle. When the desired level is reached, remove your finger quickly from the button to maintain that power setting.
3. The third button is a three step wave action button. Once activated, the jets expel water in a slow pulsating flow called wave action. There are 3 steps or positions for wave strength.
 - a. Position #1 operates the pump at a steady flow.
 - b. Position #2 operates the pump at a quick wave action.
 - c. Position #3 operates the pump at a slower wave action.

AIR BATH CONTROL CENTER FEATURES

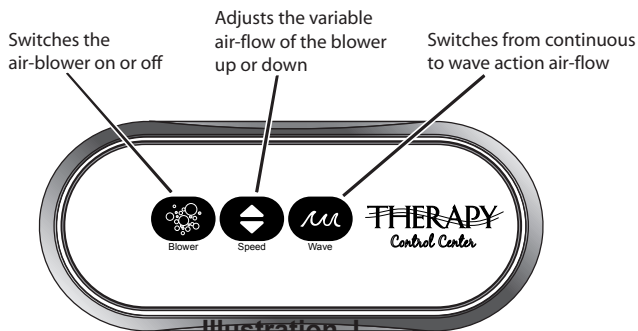

Illustration J

The air bath is controlled by a three button control.

1. The first button switches the blower on or off. The other features will not operate unless the blower is turned on.
2. The second button sets the power level of the blower. Holding the button depressed will cycle the blower power from low to high in a continuous cycle. When the desired level is reached, remove your finger quickly from the button to maintain that power setting.
3. The third button is a three step wave action button. Once activated, the air holes expel air in a slow pulsating flow called wave action. There are 3 steps or positions for wave strength.
 - a. Position #1 operates the blower at a steady flow.
 - b. Position #2 operates the blower at a quick wave action.
 - c. Position #3 operates the blower at a slower wave action.

TOTAL MASSAGE BATHS

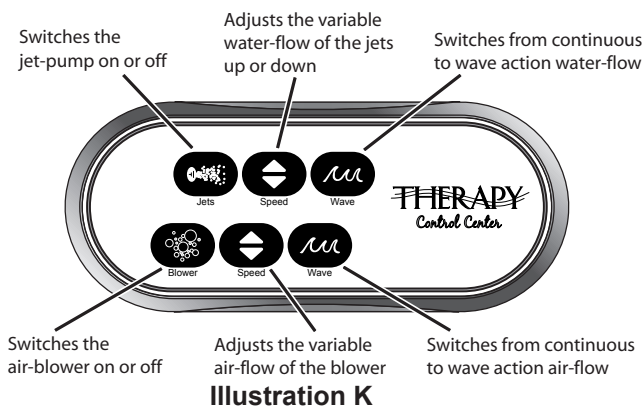

Illustration K

Total Massage units are a combination of whirlpool and air massages. The top three controls on the "Therapy Control Center" operate the whirlpool and the bottom three controls operate the air system. The whirlpool and air massage systems may be used at the same time if desired. The air bath control center is explained in the section above.

The whirlpool is controlled by a three button control.

1. The first button switches the pump on or off. The other features will not operate unless the pump is turned on.
2. The second button sets the power level of the pump. Holding the button depressed will cycle the pump power from low to high in a continuous cycle. When the desired level is reached, remove your finger quickly from the button to maintain that power setting.
3. The third button is a three step wave action button:
 - a. Position #1 operates the pump at a steady flow.
 - b. Position #2 operates the pump at a quick wave action.
 - c. Position #3 operates the pump with a slower wave action.

THIS PRODUCT IS DESIGNED FOR RESIDENTIAL USE AND USE BY HEALTHY INDIVIDUALS

Children should not be allowed to use these products without adult supervision. Pregnant women and those with heart conditions or other conditions that limit normal physical activity should consult a doctor before use.

REPAIR PROCEDURES

Most minor scratches (up to 1/64" deep) and cigarette burns can be removed by sanding the area with #180 or #240 wet or dry sand paper and progressing down to #600 or #1200 grit. Finally, apply light buffing compound and buff area with a clean stitched cotton buffing pad or equivalent. Use an extra application of fine buffing compound if necessary.

For Cracks and Major surface damage, call our service line (800) 426-8964.

WHIRLPOOL TROUBLE SHOOTING

MOTOR WILL NOT START:

1. Check Circuit Breakers.
2. Check for incorrect or loose wire connections.
3. Make sure the correct power supply is being used.
4. Electronic On/Off switch should be in the "On" mode.
5. Make sure that the jets are fully opened and water is flowing.

MOTOR OVERHEATING AND CYCLING ON AND OFF:

1. Check for incorrect or loose wire connections.
2. Check for low voltage supply (*frequently caused by undersized wire*).
3. Make sure the motor gets a fresh air supply and the vents are kept unclogged.

MOTOR MAKES HUMMING NOISE BUT WON'T START:

1. Open jets see "illustration I"
2. Make sure that the motor shaft turns free.
3. Check for jammed impeller or an obstruction on the (volute) casing.
4. Check for low voltage and undersized wire.

LOW WATER FLOW:

1. Check for clogged plumbing lines.
2. Check for low voltage.

WATER LEAKS:

1. Check compression fittings (union connectors) making sure they are properly aligned and secured. **HAND TIGHTEN ONLY. DO NOT USE ANY TOOLS.**
2. Make sure the O-ring is properly seated and not damaged.

SAVE THESE INSTRUCTIONS

This product and its components are ETL listed and IAPMO approved

WHIRLPOOL & TUB CUT OUTS

Mirabelle Cut-Out Template

Use for Item #'s:

MIRA6060L/R

MIRS6060L/R

MIRT6060L/R

MIRW6060L/R

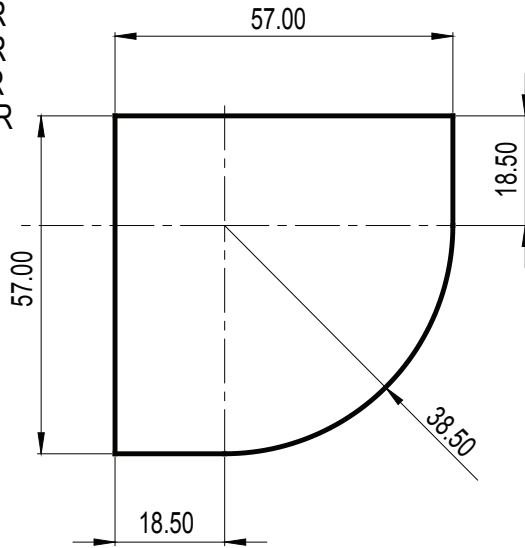

Mirabelle Cut-Out Template

Use for Item #'s:

MIRA7242V

MIRS7242V

MIRT7242V

MIRW7242V

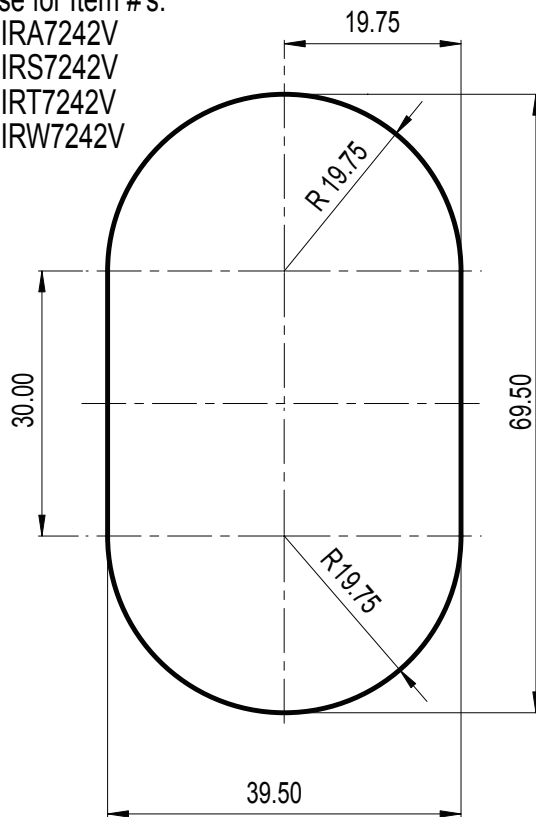

Mirabelle Cut-Out Template

Use for Item #'s:

MIRA6640V

MIRS6640V

MIRT6640V

MIRW6640V

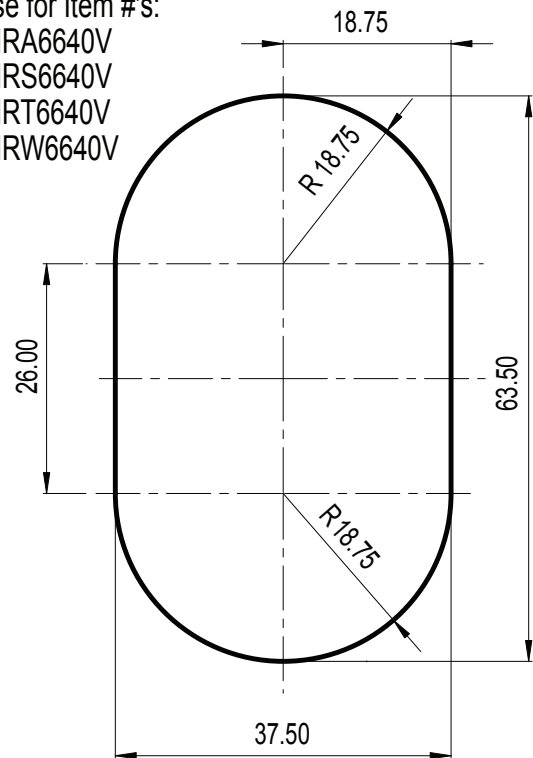

WHIRLPOOL & TUB CUT OUTS

FOR UNDER MOUNT TUB

Mirabelle Cut-Out Template

Use for Item #'s:

MIRA7140

MIRS7140

MIRT7140

MIRW7140

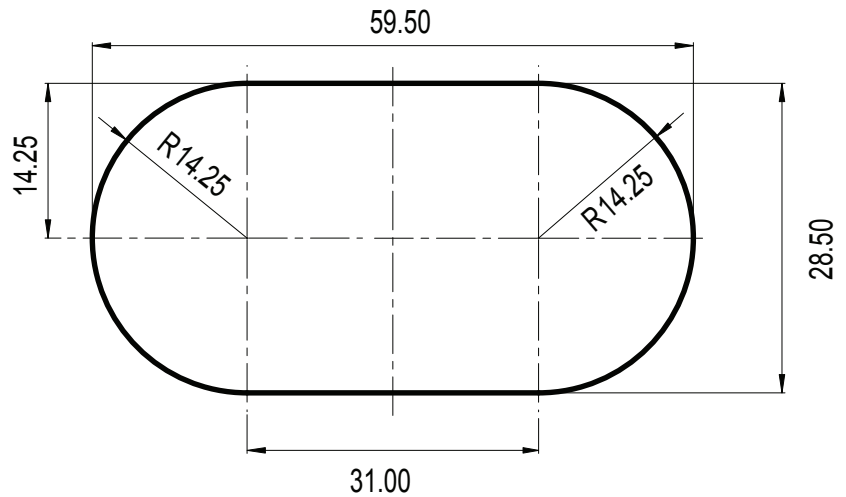

FOR DROP IN TUB

Mirabelle Cut-Out Template

Use for Item #'s:

MIRA7140

MIRS7140

MIRT7140

MIRW7140

R

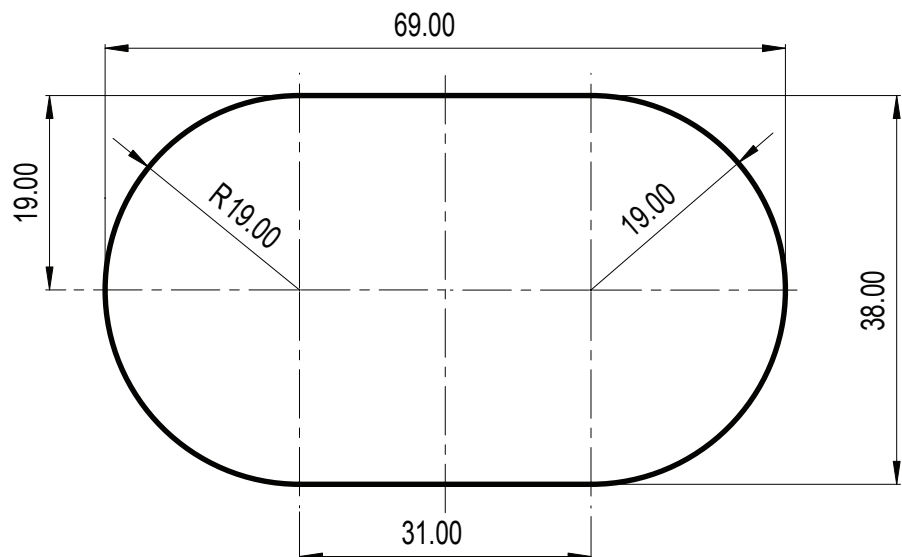



MIRABELLE™

FIVE YEAR LIMITED WARRANTY

All Mirabelle Whirlpools and Bathing Systems are warranted in accordance with the following Limited Warranty:

Mirabelle Whirlpools and Bathing Systems are warranted against defects in material and workmanship for a period of five (5) years from the date of the first consumer purchase.

This Warranty shall apply to defective acrylic surfaces which crack, fade or blister, and any defect in whirlpool and bathing system components.

The Warranty extends to the first consumer purchaser and not to subsequent owners, transferees or users other than the first purchaser. This warranty does not extend to products previously utilized as display models.

This Warranty shall apply to products installed and used only for personal, family or household purposes and which are installed and maintained in accordance with Mirabelle Whirlpool and Bathing Systems' recommended installation and maintenance procedures. This Warranty does not extend to defects or damage caused, in whole or in part, by any unauthorized or unreasonable use.

No liability shall exist for incidental or consequential damages caused in whole or part by any defects in Mirabelle Whirlpools and Bathing Systems. No warranty, expressed or implied, including any warranty of merchantability or fitness for a particular purpose, shall apply after the warranty period described above. Some states do not allow the exclusion or limitation of incidental or consequential damages or limitations on how long an implied warranty lasts. The above limitation may not apply to you.

In the event of a defect in material or workmanship of a Mirabelle Whirlpool or Bathing System during the Warranty period, defective products will be repaired or replaced as Mirabelle, at its sole and absolute discretion, determines. However, Mirabelle shall not be liable for the expense for removing defective products or installing replacement products. In certain circumstances, some states do not allow the limitation of liability for removal, transportation and reinstallation expenses. The above limitation may not apply to you.

Only Mirabelle is authorized to perform its warranty obligation. If you wish to obtain performance of the Mirabelle warranty obligation you should contact Mirabelle, telephone number (800) 221-3379. Other information about performance of the Mirabelle Whirlpool and Bathing Systems' warranty obligation may be obtained at the same address and telephone number.

This Warranty gives you specific legal rights and you may also have other rights which vary from state to state.