



EDENTON COLLECTION

6032

AIR BATH, SOAKER AND WHIRLPOOL TUBS

Dimensions: 59-3/4" L x 32" W x 19-1/2" H

Product Codes:

MIREDA6032WH (white air massage), MIREDA6032BS (biscuit air massage)

MIREDS6032WH (white soaker tub), MIREDS6032BS (biscuit soaker tub)

MIREDW6032WH (white whirlpool), MIREDW6032BS* (biscuit whirlpool)

MIRE6032TEMP (template)

- Intuitive electronic controls
- 8 high-flow directional and volume-adjustable whirlpool jets
- 65 channel-fed airjets (air bath and total massage)
- Powerful whirlpool pump with variable flow device
- Heated blower for air bath system
- 53-gallon operating capacity
- 62-gallon capacity to overflow
- Safety suction
- Pre-leveled base
- Constructed of highest grade acrylic
- 100% factory performance tested with water
- Textured slip-resistant bottom
- Pre-wired for simple plug-in installation
- Requires a single 20-amp GFCI circuit
- End drain position
- Drop-in or undermount applications
- 5 year limited warranty
- Meets or exceeds ANSI Z124.1-95
- ASME A112, 19.7-M-1995, UL 1795
- UPC/IAPMO listed
- Optional in-line heater available – MIRPRESSHTR (for use with whirlpool) – Requires a separate 20-amp GFCI circuit
- Tile flange kit available – PFTLK
- Recommended accessories
 - MB138886 Cable drain ABS with trim – CP
 - MB138885 Cable drain ABS with trim – BN
 - MB138887 Cable drain ABS with trim – ORB
 - MB138883 Cable drain PVC with trim – CP
 - MB138882 Cable drain PVC with trim – BN
 - MB138884 Cable drain PVC with trim – ORB



Mirabelle®

EDENTON COLLECTION

6032

AIR BATH, SOAKER AND WHIRLPOOL TUBS

Product Codes:

MIREDA6032WH (white air massage), MIREDA6032BS (biscuit air massage)

MIREDS6032WH (white soaker tub), MIREDS6032BS (biscuit soaker tub)

MIREDW6032WH (white whirlpool), MIREDW6032BS* (biscuit whirlpool)

MIRE6032TEMP (template)

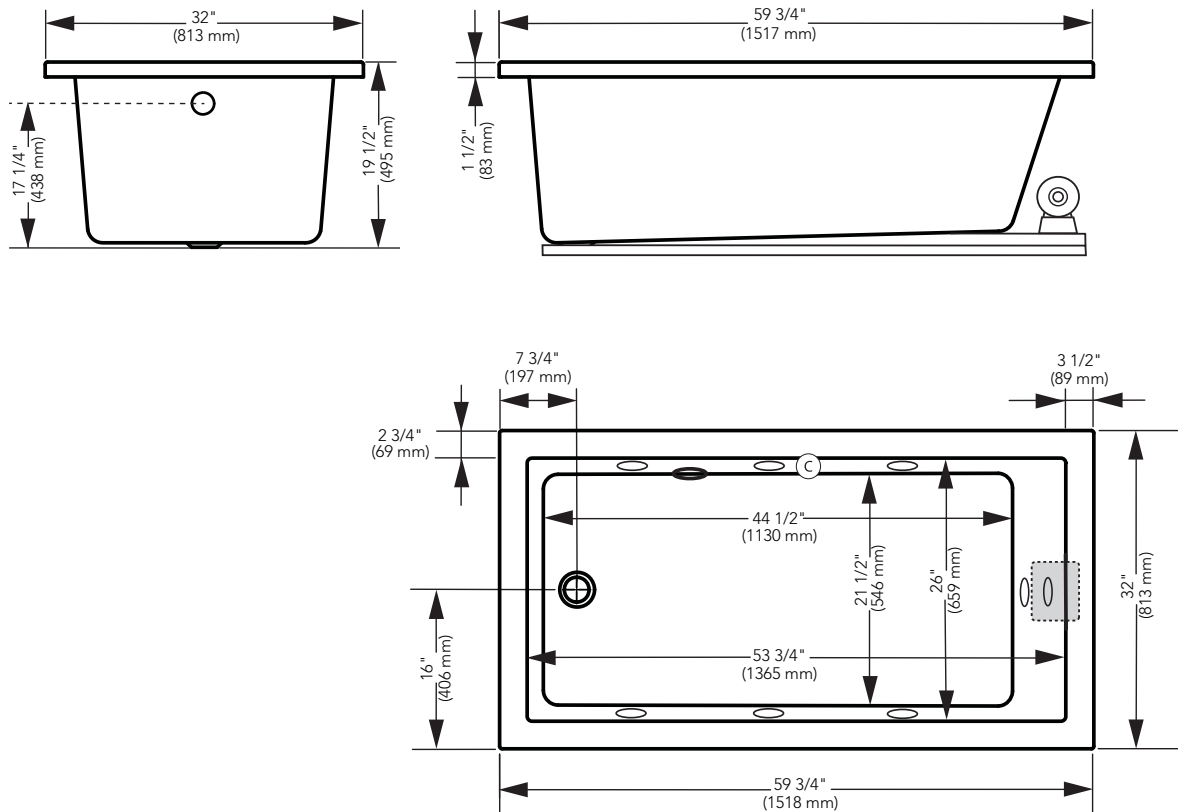

Ⓒ Designates control location

Note: All dimensions and specifications are nominal and may vary +/- 1/4". Use actual products for accuracy in critical situations.

Please contact your Mirabelle customer service representative at (800) 221-3379 for any updated specifications.