

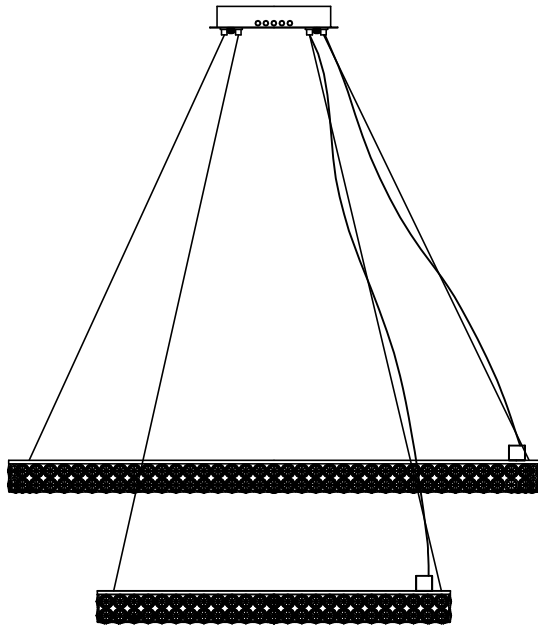

PRODUCT NAME: Eternity
ITEM NUMBER: 39777BCPC

Please consult your electrician for hanging fixture and wiring.



The fixture is designed to dim with a standard Triac forward phase dimmer. Dimming levels will vary by dimmer.
The above belongs in box with recommended drivers.

Below is a list of recommended dimmers:

Lutron MACL-153M

Lutron DVL-153P

Lutron SCL-153P

Leviton IPL06-10Z

Leviton 6674-POW

Due to inrush current wattage should not exceed 150 watts of product a 600 watt dimmer.

Warning! This fixture is supplied with an installed LED driver. These fixtures are dimmable using standard triac dimmer. For best operation we recommend using Lutron CL Dimmers.

IMPORTANT: Turn off power at the main fuse or circuit breaker box before starting installation



(A)
Mounting
Bracket



(B)
Anchor Bolts



(C)
Canopy



(D)
Finial

Locate all hardware & components before discarding packaging

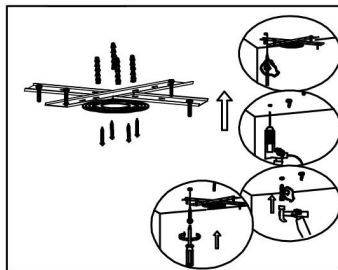
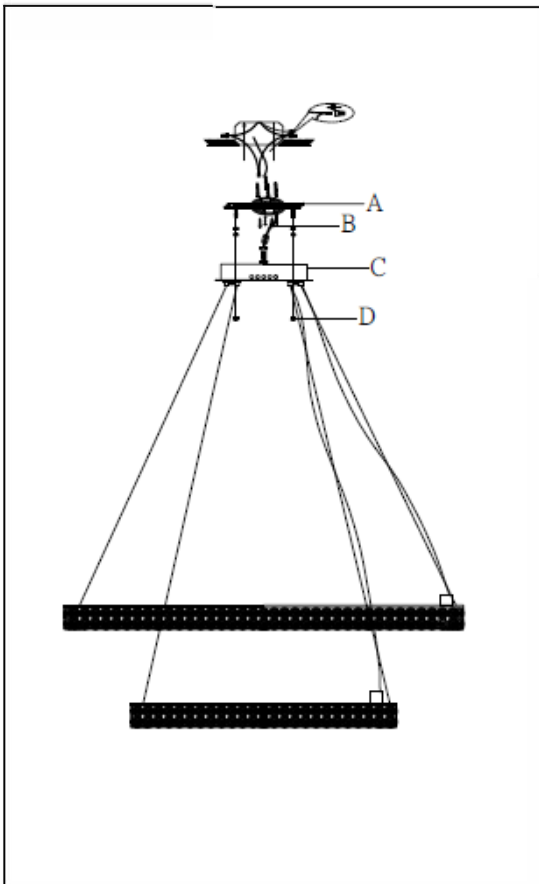

1.)

Step 1: Remove mounting bracket (A) and install to electrical box. Mark where anchors (B) meet ceiling, remove mounting bracket from ceiling, and then drill holes using 3/16" drill bit where marked (B). install and attach anchors to secure bracket at ends

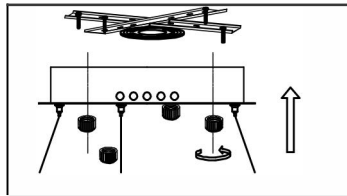

2.)

Step 2: Adjust wire to the desired mounting height. (If cutting wire is necessary see instructions 2 on page 3). Secure fixture to ceiling using finials (D) provided.

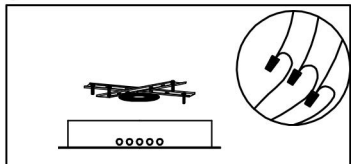

3.)

Step 3: Wire fixture to wire in outlet box. Black is live, White is neutral and Copper is ground.

Cleaning & Care:
Clean with a soft and a mild Detergent.
Do not use Abrasive cleaner

STEP 2a.

If wire was cut while adjusting the height, please note the wire consist of an outer mesh (-) and inner wire (+). Strip wire to expose inner wires(+), then separate mesh (-) from inner wire (+).

Pendant Wires

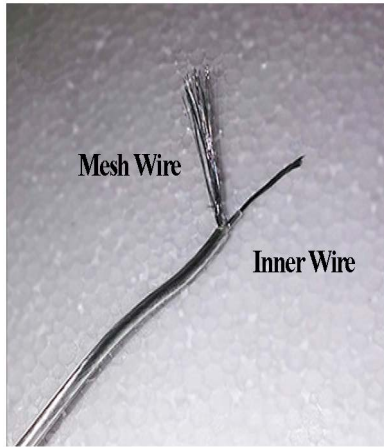

Driver Wires

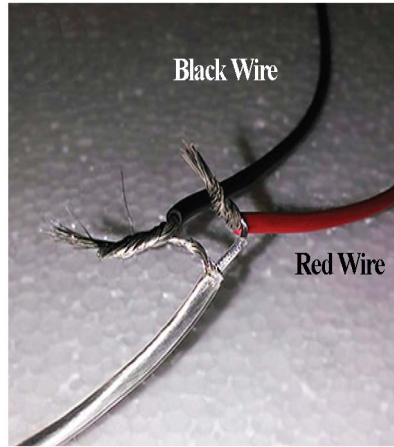

Pendant	Driver
InnerWire (+)	DriverRed (+)
OuterMesh (-)	DriverBlack (-)

2b.

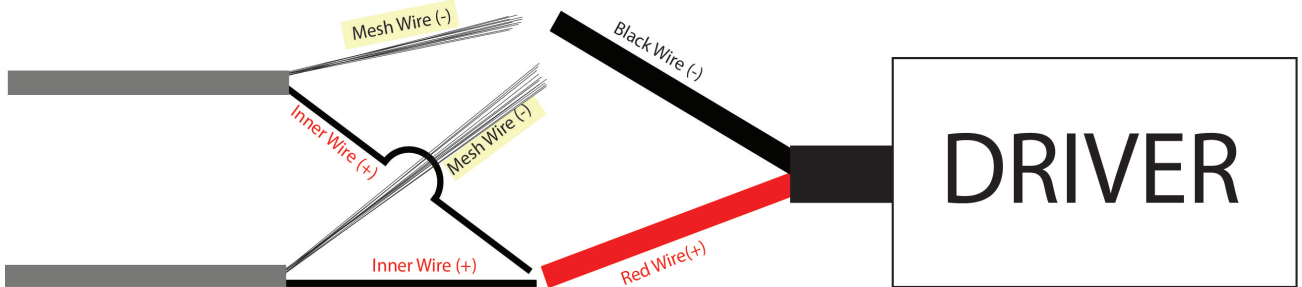

1. Connect both **MESH** (-) wire from each ring together. Connect **Mesh** to the Black wire.

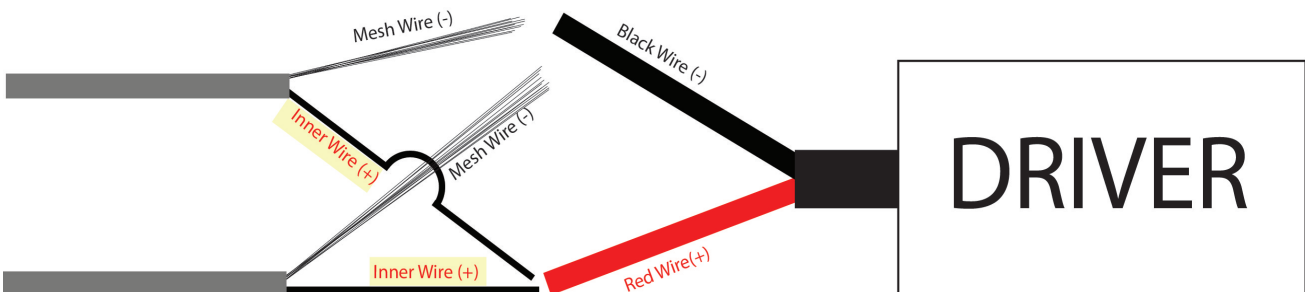

2. Connect both **INNER** (+), wire together. Connect **INNER**(+) wires to the Red wire