



Owner's Manual

HC12W Cool Mist Ultrasonic Humidifier

IMPORTANT SAFETY INFORMATION: Please carefully read this manual before attempting to install or use this humidifier. For your safety, comply with all safety instructions and warnings contained in this owner's manual to prevent personal injury or property damage.

To view the full line of Luma Comfort products, please visit www.lumacomfort.com.

Contents

Introduction 1

Product Benefits 1

Important Safety Information 1

Parts List 2

Operating Instructions 3

Filling the Water Tank 3

Operating the Humidifier 4

Using the Remote Control 4

Low Water Tank Alert 4

Maintenance 5

Technical Support 5

Product Specifications 5

Warranty 6

Introduction

Thank you for purchasing this humidifier from Luma Comfort, the world leader in home appliances and home comfort products.

This owner's manual provides specific operating instructions for your humidifier. Use the cool mist humidifier only as instructed in this owner's manual.

Product Benefits

- Provides soothing moisture for personal comfort
- Lasts up to 45 hours per single tank fill and covers 650 square feet
- 8 adjustable mist settings with musical alerts
- Modern design with adjustable height
- Demineralization cartridge prevents scale buildup
- Energy-efficient and uses ultrasonic technology
- Adds moisture to dry environments and naturally eliminates airborne dust particles
- Near-silent operation – perfect for bedrooms, nurseries and other living spaces

Important Safety Information

These instructions are not meant to cover every possible condition and situation that may occur. Please read all instructions before using this humidifier. Failure to carefully read all instructions may result in possible electric shock or fire hazard, and will void the manufacturer's warranty.

1. Use this humidifier only as instructed in this owner's manual. Other uses may cause electric shock, injury or fire.
2. Close supervision is required if this humidifier is used near children or pets.
3. To protect against electric shock, do not immerse this humidifier or its plug and cord in water.
4. If the humidifier is being transported or will not be in use, disconnect it from the power supply by tightly gripping the plug and pulling it from the power outlet. Do not disconnect the power supply by pulling on the humidifier's power cord.
5. Avoid contact with any of the humidifier's moving parts.
6. Place the humidifier on a level surface.
7. For best results, use purified water in the water tank. The ideal ambient temperature should be between 50 to 122 degrees Fahrenheit.
8. This humidifier's plug is intended to fit into a matching receptacle. Under no circumstances should the plug be altered in any way. An improper connection can result in electric shock.
9. If possible, avoid using extension cords with this humidifier. If an extension cord is absolutely necessary, do not use more than one extension cord to operate more than one unit.
10. Do not insert objects or allow fingers to enter into the humidifier's nozzles or air inlet, as this may cause electric shock or bodily injury. Do not block or tamper with the humidifier while it is in operation.
11. Do not run the power cord under mats or carpeting, and do not cover the power cord with runners. Arrange the power cord away from room traffic and where it can be tripped over.
12. Do not operate this humidifier in the presence of flammable substances or explosives.
13. Do not place the humidifier near an open flame or cooking/heating appliances.
14. This product is not intended for use in commercial or industrial areas.
15. If the humidifier will not be in use, empty the tank of any remaining water.
16. If the humidifier's plug or power cord is damaged, do not attempt to repair the components yourself. Please contact Luma Comfort's customer service hotline at 1-866-737-6390 or have the unit examined by an authorized service provider.

Parts List

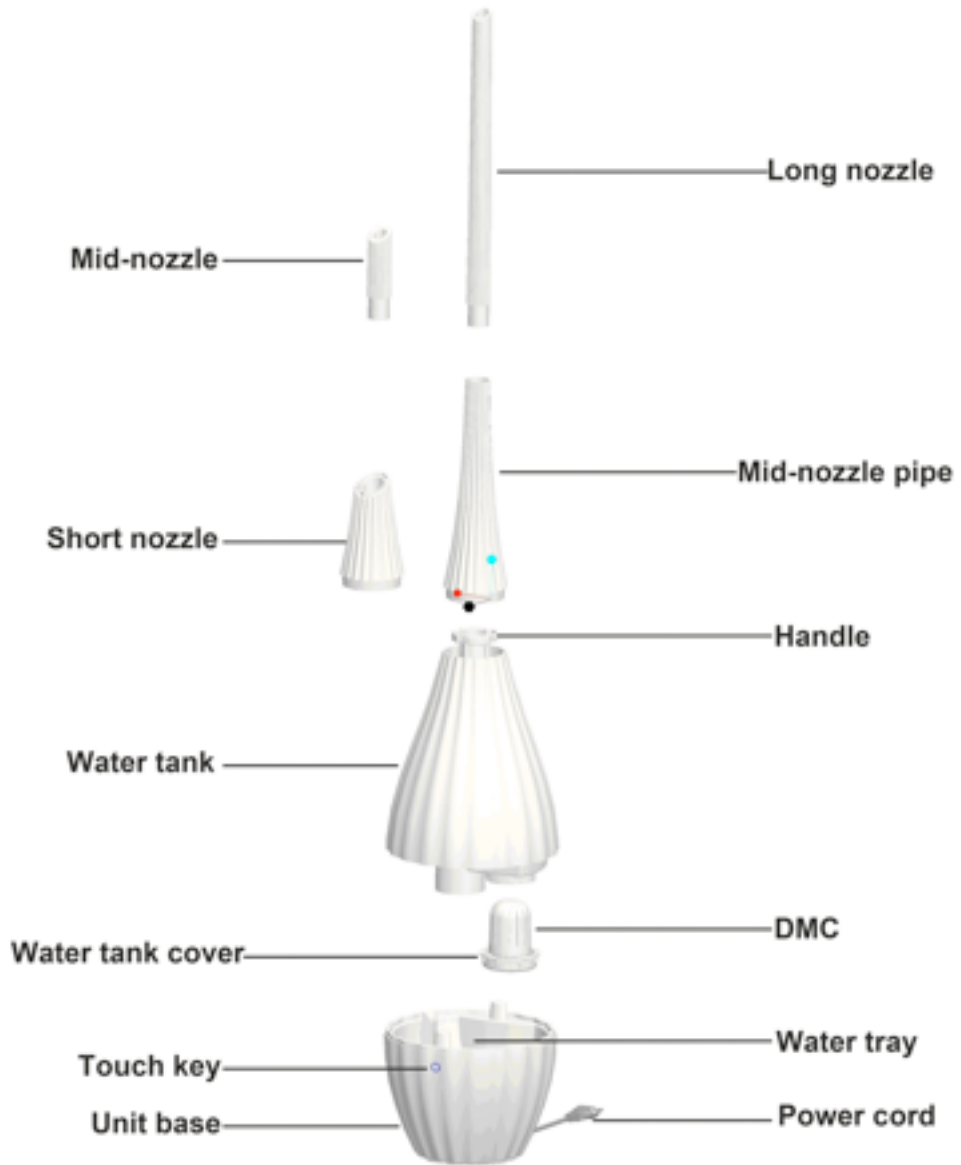

Wireless remote

Operating Instructions

Filling the Water Tank

Carefully remove all packaging materials and retain for future storage/use. Make sure there is no residual foam left in any of the components. No tools will be required to assemble this humidifier.

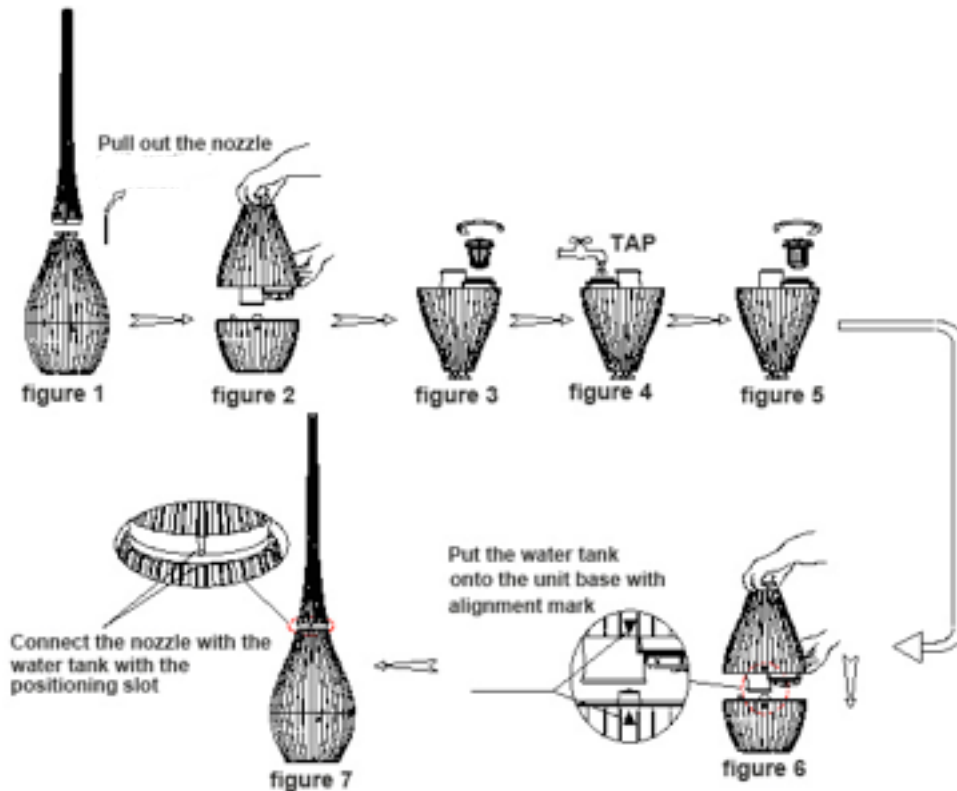

- Choose a suitable location for your humidifier. Make sure it is placed on a flat, level surface such as on a table, desk or on the floor. Pull the humidifier's nozzle up vertically as indicated in figure 1.
- Remove the water tank from the unit's base by lifting it up as indicated in figure 2 and unscrew the water tank cover as indicated in figure 3. Fill the tank with clean water as indicated in figure 4.
- Place the water tank cover back onto the tank and screw it tightly into place as indicated in figure 5.
- Place the water tank back on the unit's base, making sure that the positioning slots are aligned as indicated in figure 6.
- You should hear the water flowing through the water tank. If you do not hear the water flowing through the tank, remove the water tank from the base and reattach it.
- Depending on your chosen height, place the nozzle(s) back onto the water tank.
- Before plugging in and turning on the unit, check to see that the unit's surface is dry.

Operating the Humidifier

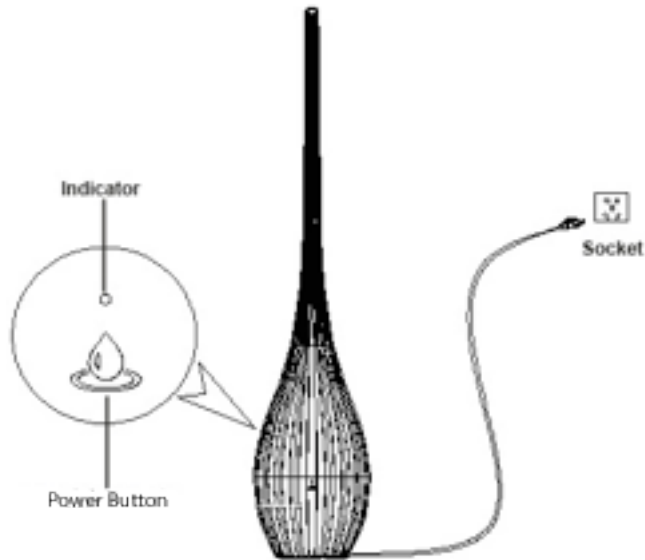

- a. After filling the water tank with water, wait 3-5 minutes before plugging in the unit and turning it on.
- b. After 3-5 minutes have passed, plug in the humidifier to an appropriate power supply. You should hear a chime, indicating that the humidifier is in standby mode.
- c. Press the power button. You will hear a beep, which indicates that the unit is beginning to operate. The humidifier will be on the lowest setting by default.
- d. To increase the mist volume, press the power button. The musical chime will indicate that the mist settings are increasing, and the indicator light will change from blue to white. After the unit is on the maximum mist setting (setting #8), press the power button again to decrease the mist setting. The musical chime will indicate that the mist settings are decreasing, and the indicator light will change from white to blue.
- e. This humidifier has a memory function. If the unit is turned off without unplugging the power supply, once it is turned on again using the power button, it will revert back to the last mist setting.
- f. All of the settings will reset to the default mist setting if the unit is unplugged from the power supply.

Using the Remote Control

- a. This humidifier is equipped with a remote control. The remote control has a range of 65 feet.
- b. Turn on/off the humidifier by pressing the "On/Off" button. The mist setting can be increased by pressing the "+" button. Decrease the mist setting by pressing the "-" button.

Low Water Tank Alert

- a. If the water tank does not have enough water, the humidifier will beep. If the water tank is not refilled after a short period of time, the indicator will flash red until the water tank is refilled.

Maintenance

Regular cleaning and maintenance is an essential step in maintaining the longevity of your humidifier and ensuring that it operates free of defects. Maintain your humidifier by following these steps:

- Always unplug the humidifier from the power supply before servicing or cleaning.
- Use a soft cloth and a mild soap and warm water solution to clean the unit's exterior. Do not use harsh cleaners, gasoline, paint thinner, benzene, etc., as these substances can damage the humidifier.
- Thoroughly dry all of the humidifier's parts with a soft cloth before reconnecting the unit to the power supply.
- Empty the water tank after the humidifier has been in use.
- If the humidifier will not be in use for an extended period of time, place the unit back in its original carton and keep it stored in a clean, dry place.

Technical Support

Luma Comfort is committed to providing a premier service experience. If you are experiencing any technical issues with your product related to either setup or operation, please contact our product support team at 1-866-737-6390 or support@lumacomfort.com.

Product Specifications

Model:	HC12W
Product Dimensions:	8.9" x 8.9" x 43.5"
Product Weight:	6.3 pounds
Voltage:	110V-120V
Wattage:	35W
Coverage Area:	Up to 650 square feet
Tank Size:	9.5 pints
Mist Settings:	8
Noise Level (dB):	35
Warranty:	1 year manufacturer's warranty

Warranty

Luma Comfort products are warranted to be free from defects in workmanship or materials for one (1) year from the date of purchase. If the product is found to be defective within this period, Luma Comfort, at its sole option, will repair or replace any components that fail during normal operation. The repairs or replacement will be made at no charge to the customer for parts and labor, assuming that the customer shall be responsible for all transportation costs to and from Luma Comfort.

Luma Comfort retains the right to repair or replace (with a new or newly-refurbished replacement product) the appliance at its sole discretion.

This warranty does NOT apply to the following:

- Products without a proof of purchase
- Products purchased from a source other than an authorized Luma Comfort dealer
- Cosmetic damage such as scratches or dents
- Damage caused by service performed by anyone who is not an authorized service provider of Luma Comfort
- Damage in transit
- Damage caused by accident, abuse, misuse, water, flood, fire, improper installation, maintenance negligence, commercial use for a non-commercial unit, acts of God or any other acts of nature or external causes
- Damage to a product caused by modifications or alterations without the written permission of Luma Comfort
- Normal wear and tear of parts that are designed to be replaced, such as filters or batteries
- Power failure and improper power supply such as low voltage, defective wiring or inadequate fuses
- Use of force or damage caused by external influences
- Complete or partially dismantled appliances

THE WARRANTIES AND REMEDIES CONTAINED HEREIN ARE EXCLUSIVE AND IN LIEU OF ALL OTHER WARRANTIES EXPRESS, IMPLIED, OR STATUTORY, INCLUDING ANY LIABILITY ARISING UNDER ANY WARRANTY OF MERCHANTABILITY OR FITNESS FOR A PARTICULAR PURPOSE, STATUTORY OR OTHERWISE. THIS WARRANTY GIVES YOU SPECIFIC LEGAL RIGHTS, WHICH MAY VARY FROM STATE TO STATE.

IN NO EVENT SHALL LUMA COMFORT BE LIABLE FOR ANY INCIDENTAL, SPECIAL, INDIRECT, OR CONSEQUENTIAL DAMAGES, WHETHER RESULTING FROM THE USE, MISUSE, OR INABILITY TO USE THIS PRODUCT OR FROM DEFECTS IN THE PRODUCT. SOME STATES DO NOT ALLOW THE EXCLUSION OF INCIDENTAL OR CONSEQUENTIAL DAMAGES, SO THE ABOVE LIMITATIONS MAY NOT APPLY TO YOU.

If you believe your product is defective, contact Luma Comfort for warranty service at 1-866-737-6390 or support@lumacomfort.com. In your correspondence with Luma Comfort, please describe the problem and request a return material authorization (RMA) number. You will also need to provide the proof of purchase, return shipping address and a daytime phone number.

After a Luma Comfort representative confirms that your product is defective and is still under warranty, you will receive an RMA and return shipping instructions. Products sent to our headquarters without an RMA will be refused.