

Features

- Brass construction
- Complements the Bancroft Suite

DECK- OR BATH-MOUNT HANDSHOWER HOLDER WITH HOSES **K-10573**

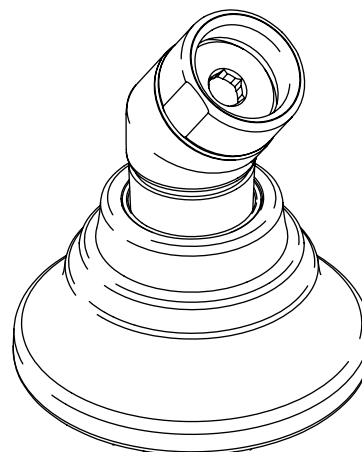

Colors/Finishes

- CP: Polished Chrome
- Other: Refer to Price Book for additional colors/finishes

Accessories

- NA: None applicable

Specified Model

Model	Description	Colors/Finishes
K-10573	Deck- or bath-mount handshower holder with hoses	<input type="checkbox"/> CP <input type="checkbox"/> Other_____

Optional Accessories		
79583	Roughing-in kit for deck-mount handshowers	<input type="checkbox"/> NA

Product Specification

Handshower holder shall be of brass construction. Product shall complement the Bancroft Suite. Product shall be Kohler Model K-10573-_____.

BANCROFT™

Installation Notes

Install this product according to the installation guide.

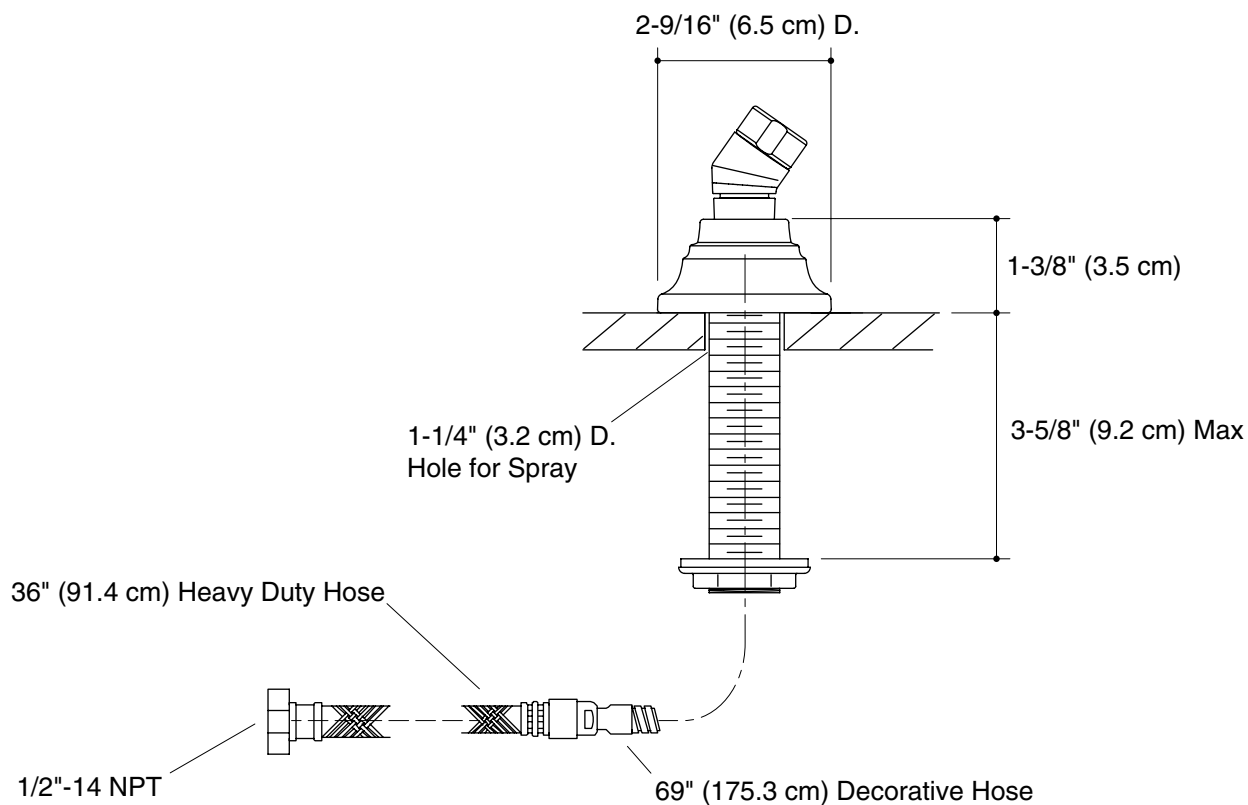

Product Diagram

Features

- Brass construction
- Finished deck-mount or rim-mount only
- 1/2" quarter-turn washerless ceramic disc valves
- High-flow valving
- 11 gpm (42 lpm) - 12 (45 lpm) flow at 45 psi (310 kPa)

Codes/Standards Applicable

Specified model meets or exceeds the following:

- ASME A112.18.1
- IAPMO/UPC
- CSA B125

HIGH-FLOW VALVE SYSTEM K-438

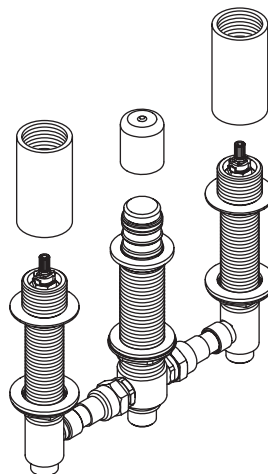

Colors/Finishes

- NA: None applicable

Specified Model

Model	Description	Colors/Finishes
K-438-K	1/2" valve system with diverter	<input type="checkbox"/> NA

Product Specification

High-flow valve system shall be of brass construction. Valve system shall feature 1/2" quarter-turn washerless ceramic disc valves, assuring positive handle stop positioning. Valve system shall be for finished deck-mount or rim-mount installation only. High flow valving, 11 gpm (42 lpm) - 12 (45 lpm) at 45 psi (310 kPa). Valve system shall be Kohler Model K-438-K-NA.

Installation Notes

Install this product according to the installation guide.

Performance Data

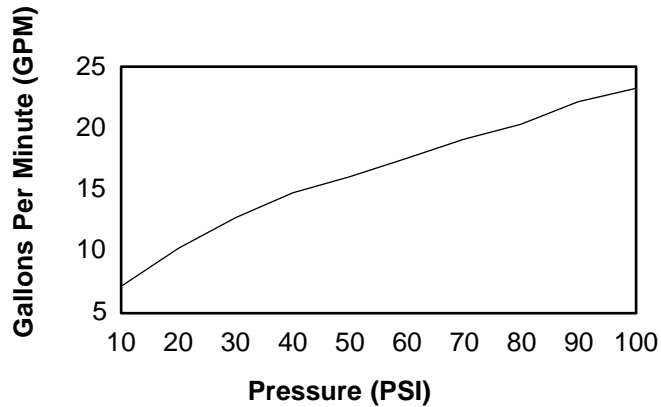

Finish Deck Installation Only

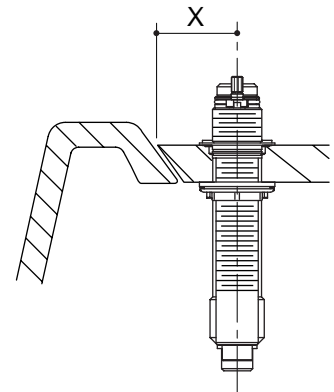
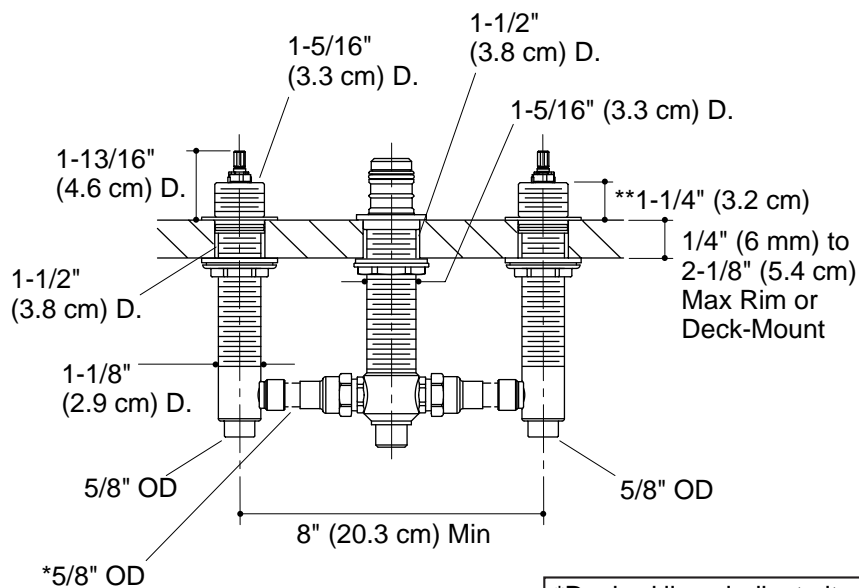

*Dashed lines indicate items to be supplied by installer
**Dimension allows +/- 1/4" (6 mm) handle adjustment during handle trim installation
X = Distance from centerline of spout inlet to front of spout base plus 1/2" (1.3 cm)

Product Diagram

Features

- Adjustable oversized sprayface
- MasterClean™ sprayface resists hard water buildup and is easy to clean
- Complements Bancroft® faucet line
- Ergonomic sprayhead pivots
- 1.75 gpm (6.6 L) per minute maximum flow rate
- Wide-coverage, medium-coverage, and forceful utility spray options

Codes/Standards Applicable

Specified model meets or exceeds the following:

- ASME A112.18.1/CSA B125.1
- EPA WaterSense®

MULTI-FUNCTION HANDSHOWER K-10549

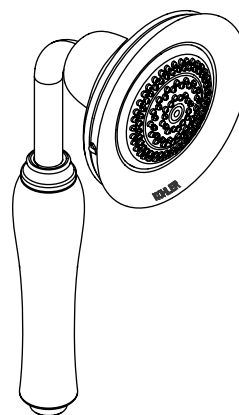

Colors/Finishes

- CP: Polished Chrome
- Other: Refer to Price Book for additional colors/finishes

Accessories

- CP: Polished Chrome

Specified Model

Model	Description	Colors/Finishes	
K-10549	Multi-function handshower	<input type="checkbox"/> CP	<input type="checkbox"/> Other _____
Required Accessories			
K-8593	72" (182.9 cm) metal shower hose OR		<input type="checkbox"/> CP
K-9514	60" (152.4 cm) metal shower hose		<input type="checkbox"/> CP

Product Specification

Multi-function handshower shall feature an adjustable oversized sprayface. Handshower shall feature a Masterclean sprayface which resists hard water buildup and is easy to clean. Handshower shall feature an ergonomic sprayhead which pivots. Handshower shall have a 1.75 gallon (6.6 L) per minute maximum flow rate. Handshower shall feature wide-coverage, medium-coverage, and forceful utility spray options. Handshower complements the Bancroft faucet line. Handshower shall be Kohler Model K-10549-_____.

BANCROFT®

Installation Notes

Install this product according to the installation guide.

Plumbing codes require an atmospheric vacuum breaker (such as Kohler Model K-9660) be installed in line with handshowers. Please consult with local plumbing officials.

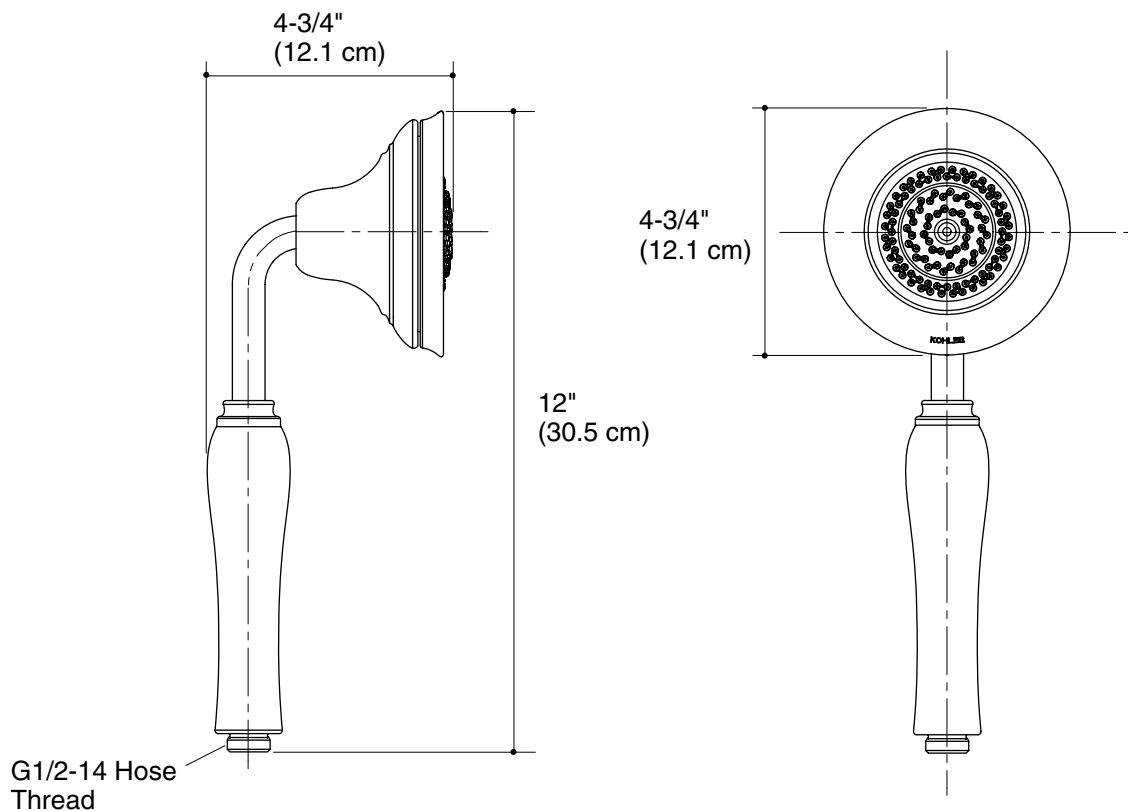

Product Diagram

BATH FAUCET TRIM
K-T10592
ADA
Features

- Brass construction
- Bath- or deck-mount
- Lever handles
- Complements Bancroft™ Suite
- 7" (17.8 cm) spout with slip-fit connection and diverter knob

Codes/Standards Applicable

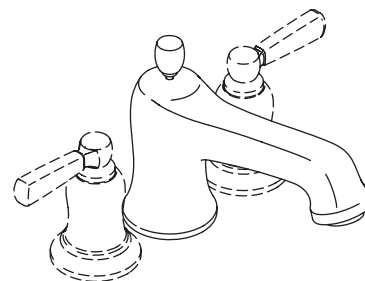

Specified model meets or exceeds the following:

- ASME A112.18.1
- IAPMO/UPC
- CSA B125
- ADA

Colors/Finishes

- CP: Polished Chrome
- Other: Refer to Price Book for additional colors/finishes

Specified Model

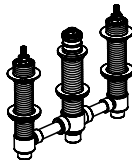
Model	Description	 ADA	 ADA
K-T10592-4	Faucet with metal lever handles	<input type="checkbox"/> CP <input type="checkbox"/> Other_____	
K-T10592-4P	Faucet with ceramic lever handles		<input type="checkbox"/> CP <input type="checkbox"/> Other_____
Required Accessory			
K-438-K	1/2" High-flow ceramic disc valve system with integral diverter	<input type="checkbox"/> NA	
Optional Accessories		Colors/Finishes	
K-10597	Handshower	<input type="checkbox"/> CP <input type="checkbox"/> Other_____	<input type="checkbox"/> CP <input type="checkbox"/> Other_____
K-10573	Deck handshower holder	<input type="checkbox"/> CP <input type="checkbox"/> Other_____	<input type="checkbox"/> CP <input type="checkbox"/> Other_____

Product Specification

Two-handle bath- or deck-mount bath faucet trim shall be of brass construction. Product shall install to bath or finished deck. Product shall include a 7" (17.8 cm) spout with slip-fit connection and diverter knob. Product shall include lever handles. Product complements Bancroft Suite. Faucet trim shall be Kohler Model K-T10592-_____-_____- and valve system shall be Kohler Model K-438-K-NA.

BANCROFT™

Installation Notes

Install this product according to the installation guide.

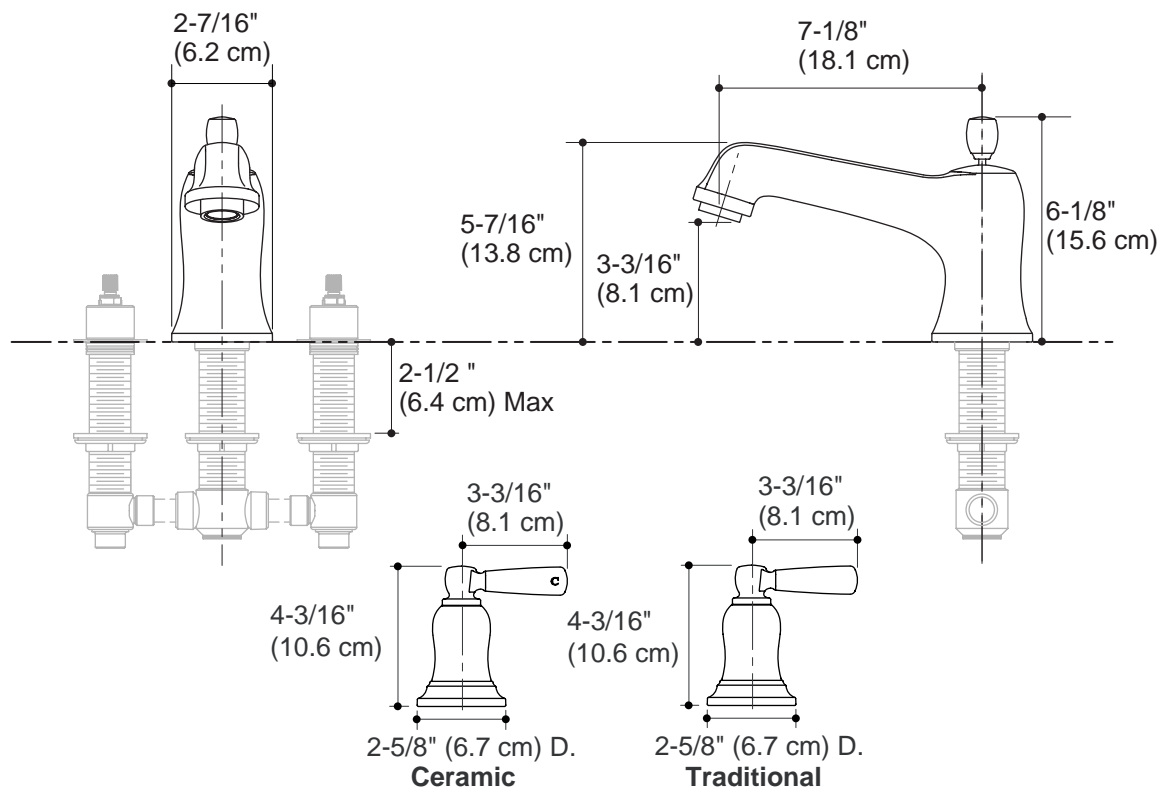

Product Diagram