

# KOHLER®

## Roughing-In

# K-3844

## OCTAVE™

### TOP-MOUNT KITCHEN SINK

### Product Information

Applicable product:	
Top-mount kitchen sink – 1-hole	K-3844-1
Top-mount kitchen sink – 3-hole	K-3844-3
Top-mount kitchen sink – 4-hole	K-3844-4

Fixture*:	
Bowl area, large	17-3/8" (441 mm) x 18-5/16" (465 mm)
Bowl area, medium	11-5/16" (287 mm) x 18-5/16" (465 mm)
Water depth	9" (229 mm)
Drain hole	Ø 3-5/8" (92 mm)
Faucet holes	Ø 1-7/16" (37 mm)
* Approximate measurements for comparison only.	

Included components:	
Hardware kit – top-mount	1177160

Included accessories:	
Sponge caddy	K-6139
Bottom bowl rack, left	K-6484
Stainless steel cleaner	1056368

### Optional accessories:

Bottom bowl rack, right	K-6485
Duostrainer® sink strainer	K-8801
Hardware kit for countertops up to 2-1/2" (64 mm) thickness	1177161

### Installation Notes

Install this product according to the installation guide.

Cut-out is 32-1/2" (826 mm) x 21-1/2" (546 mm) with 1/2" (13 mm) radius corners.

Fixture conforms to ASME Standard A112.19.3/CSA B45.4. All dimensions are nominal.

**K-3844-4**

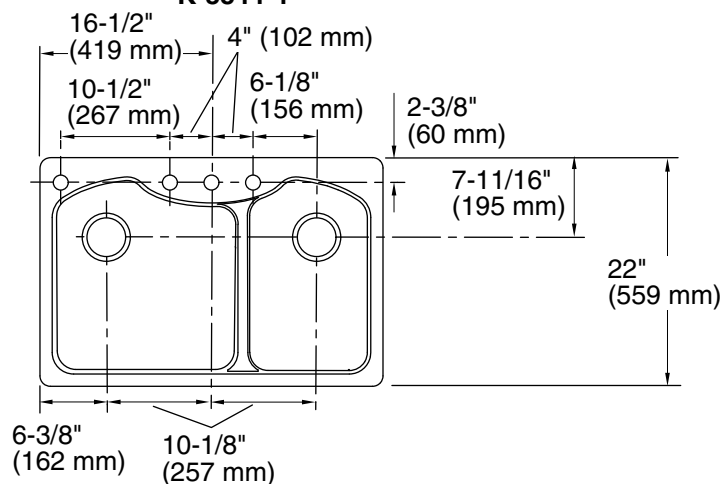

**K-3844-3**

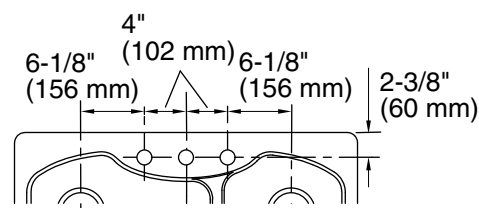

**K-3844-1**

