



Toccata™
Top-mount Kitchen Sink
K-3348-3

Features

- 27-inch minimum base cabinet width.
- Single bowl.
- Three faucet holes.
- 25" (635 mm) x 22" (559 mm)

Material

- 18-gauge stainless steel.

Installation

- Top-mount

Optional Accessories

K-8801 Sink Strainer

1177161 Installation Clip Kit

Components

Product includes:

1177160 Hardware Kit, Top-mount



Codes/Standards

ASME A112.19.2/CSA B45.1

**Lifetime Limited Warranty for
KOHLER® Stainless Steel Sinks**

See website for detailed warranty information.

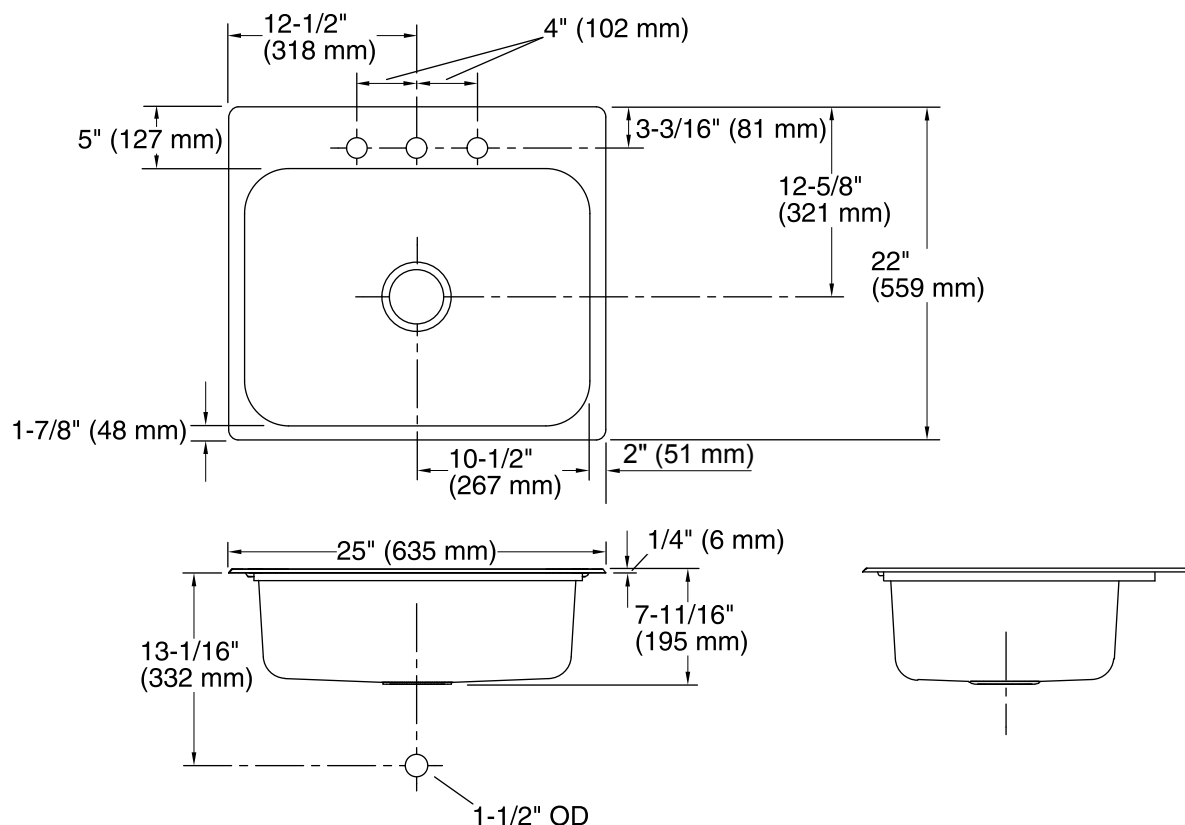

Technical Information

All product dimensions are nominal.

Bowl configuration: Single

Installation: Top-mount

Cutout: Top-mount, 24-1/2" x 21-1/2" (622 mm x 546 mm) with 1/2" (13 mm) radius corners

Min. base cabinet width: 27" (686 mm)

Bowl area (Only)

- Length: 21" (533 mm)
- Width: 15-1/4" (387 mm)
- Bowl depth: 8" (203 mm)

Number of deck holes: 3

Faucet hole(s): 1-7/16" (37 mm)

Drain hole: 3-5/8" (92 mm)

Notes

Install this product according to the installation instructions.

Installer must supply mounting hardware for countertops of 2-1/2" (64 mm) thickness or less. Refer to installation kit 1177161.