

**BIDET FAUCET
K-13142**

Features

- Metal construction
- Flexible connections for easy installation
- Brass valve bodies
- Pop-up drain with lift rod and tailpiece
- Vertical spray
- Fixture-mount transfer valve/vacuum breaker
- Available with cross or lever handles
- Quarter-turn washerless ceramic disc valves

Codes/Standards Applicable

Specified model meets or exceeds the following:



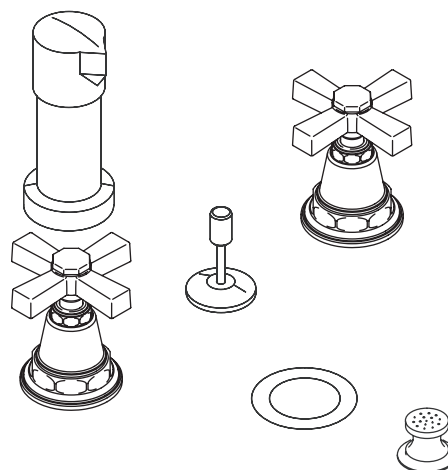

- ASME A112.18.1/CSA B125.1
- ASSE 1001



Colors/Finishes

- CP: Polished Chrome
- Other: Refer to Price Book for additional colors/finishes

Specified Model

| Model | Description |  | |  | |  | |  | |
|------------|---|---|--------------------------------------|--|--------------------------------------|---|--------------------------------------|---|--------------------------------------|
| K-13142-3A | Bidet faucet with plain cross handles | <input type="checkbox"/> CP | <input type="checkbox"/> Other _____ | | | | | | |
| K-13142-3B | Bidet faucet with grooved cross handles | | | <input type="checkbox"/> CP | <input type="checkbox"/> Other _____ | | | | |
| K-13142-4A | Bidet faucet with plain lever handles | | | | | <input type="checkbox"/> CP | <input type="checkbox"/> Other _____ | | |
| K-13142-4B | Bidet faucet with grooved lever handles | | | | | | | <input type="checkbox"/> CP | <input type="checkbox"/> Other _____ |

Product Specification

Two-handle fixture-mount bidet faucet shall be of metal construction. Faucet shall feature brass valve bodies. Faucet shall feature quarter-turn washerless ceramic disc valves, assuring positive handle stop positioning. Product shall include flexible connections, pop-up drain with lift rod and tailpiece, handles, vertical spray, and fixture-mount valve/vacuum breaker. Faucet shall be Kohler Model K-13142-_____-_____.

PINSTRIBE®

Installation Notes

Install this product according to the installation guide.

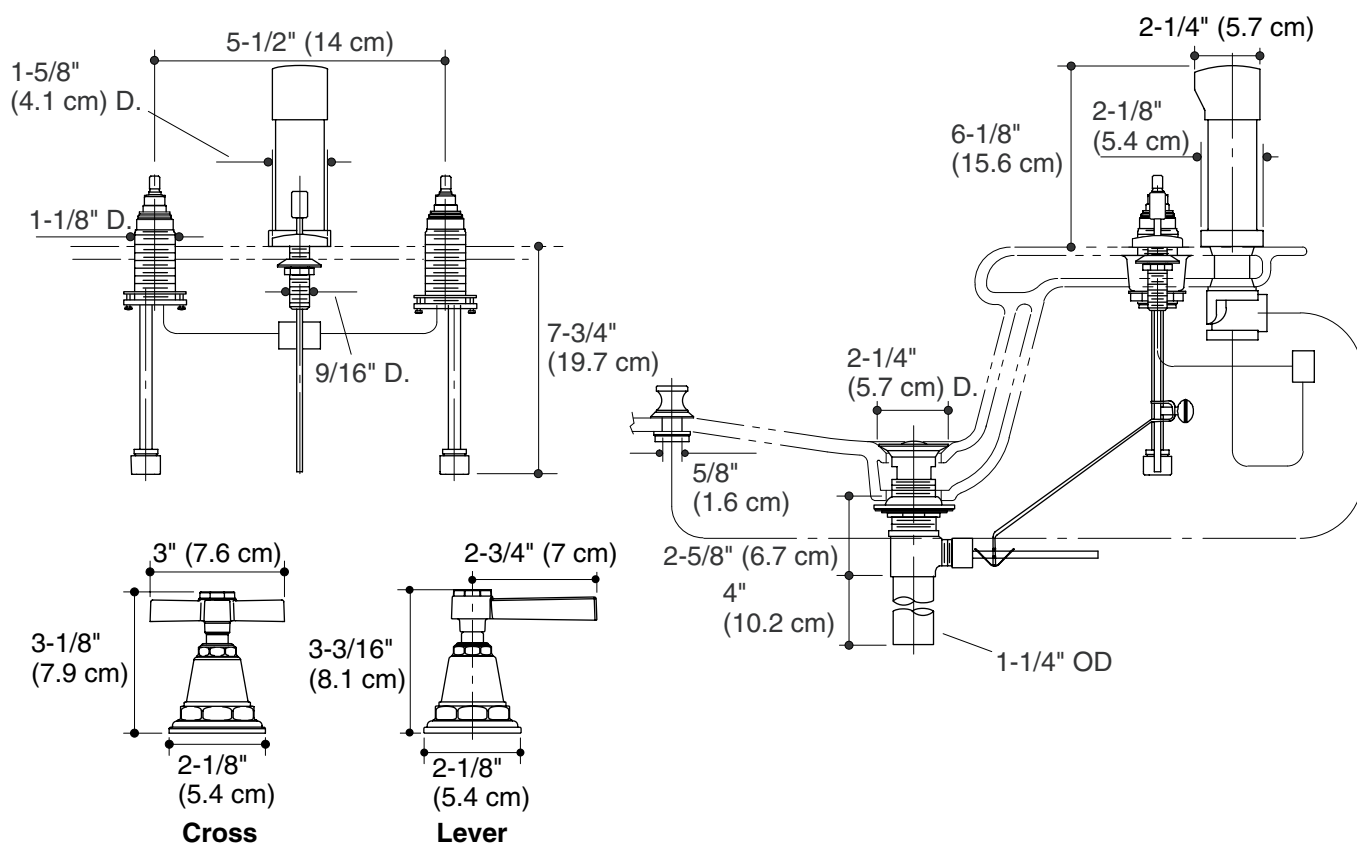

Product Diagram