



**Caxton®**  
Under-mount Bathroom Sink  
**K-2205**

**Features**

- Vitreous china.
- Under-mount.
- Oval basin.
- Without overflow.
- No faucet holes; requires wall- or counter-mount faucet.
- 17" (432 mm) x 14" (356 mm)

**Recommended Accessories**

K-9018 P-Trap

**Components**

Additional included component/s: 1193643 Basin Clamps.



ADA

**Codes/Standards**

ASME A112.19.2/CSA B45.1

ADA

ICC/ANSI A117.1

**KOHLER® One-Year Limited Warranty**

See website for detailed warranty information.

**Available Color/Finishes**

*Color tiles intended for reference only.*

Color	Code	Description
-------	------	-------------



0	White
---	-------



96	Biscuit
----	---------



47	Almond
----	--------

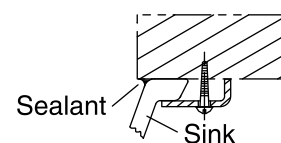
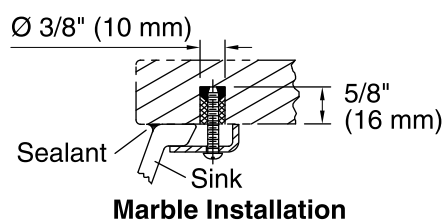
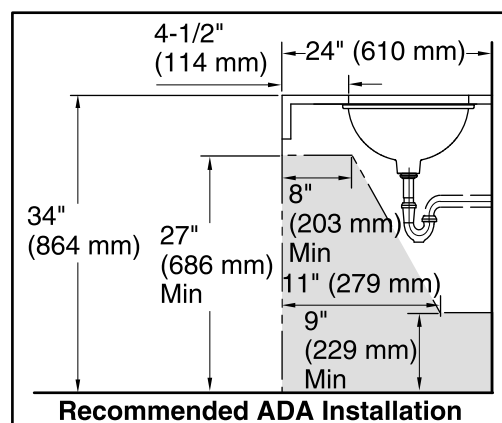
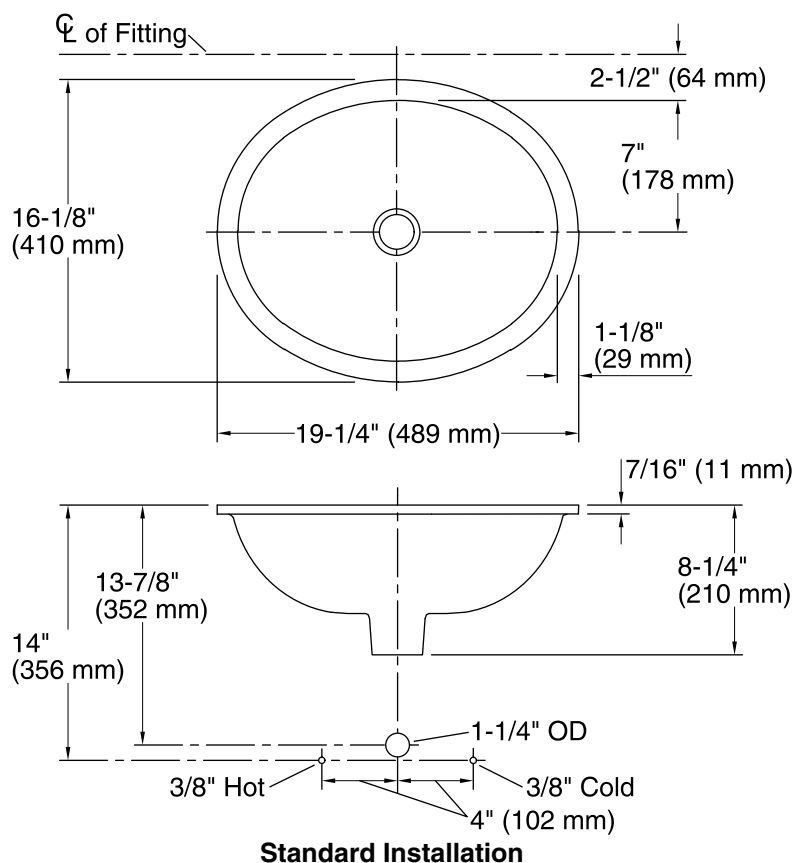

#### Technical Information

All product dimensions are nominal.

Bowl configuration: Single

Installation: Under-mount

Bowl area (Only) Length: 17" (432 mm)  
Width: 14" (356 mm)  
Water depth: 6-3/8" (162 mm)

Drain hole: 1-3/4" (44 mm)

Template: 1151011-7, required, not included

#### Notes

Install this product according to the installation instructions.

**NOTICE:** Countertop manufacturer or cutter must use the current product template available at [www.kohler.com](http://www.kohler.com), or by calling 1-800-4KOHLER. Kohler Co. is not responsible for cutout errors when the incorrect cutout template is used.

ADA compliant when installed to the specific requirements of these regulations.