

Product Information

Applicable product:				
Bath whirlpool			K-1162-HB	
Fixture*:				
Bathing well:				
Basin area, bottom		43" (109.2 cm) x 21-9/16" (54.8 cm)		
Basin area, top		53-1/2" (135.9 cm) x 32-1/8" (81.6 cm)		
Weight		110 lbs (50 kg)		
To overflow:				
Water depth		15" (38.1 cm)		
Capacity		57 gal (215.9 L)		
* Approximate measurements for comparison only.				
Included components:				
Cut-out template		1042556-7		
Pump:		V	Hz	A
1-speed		120	60	7.5
Heater:	kW	V	Hz	A
	1.5	120	60	12.5

Minimum access panel pump/control:

20" (50.8 cm) W x 15" (38.1 cm) H

required

Required Electrical Service

Two dedicated circuits are required, each protected with a Class A Ground-Fault Circuit-Interrupter (GFCI):

Pump/control 120 V, 15 A, 60 Hz

Heater 120 V, 15 A, 60 Hz

Locate the outlet behind the whirlpool and within 24" (61 cm) of the pump and heater.

Installation Notes

Install this product according to the installation guide.

Floor support under whirlpool must provide for a minimum of 35 lbs/square foot (171 kg/square meter) loading.

The pump extends 9" (22.9 cm) beyond the edge of the rim. Modify the framing as needed.

Fixture conforms to ANSI Standard Z124.1.2. All dimensions are nominal.

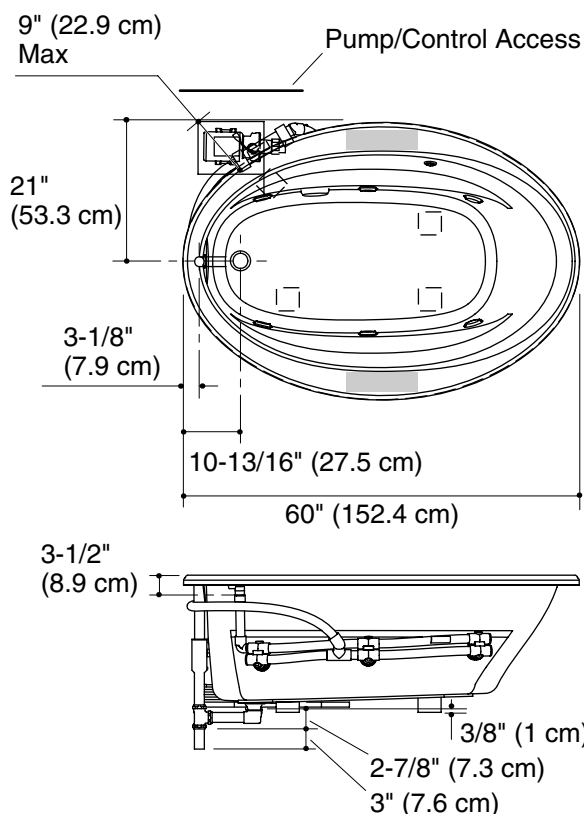

No change in measurements if connected with drain illustrated. (K-11677 or K-11677M)

Recommended faucet area

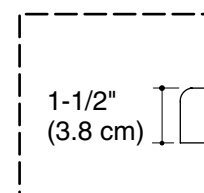

Drop-In Rim Detail

