

# KOHLER®

## Roughing-In

**K-1162-CB**  
**SUNWARD®**  
**BATH WHIRLPOOL**

### Product Information

Applicable products:			
Bath whirlpool – custom pump			K-1162-CB
Fixture*:			
Bathing well:			
Basin area, bottom	43" (109.2 cm) x 21-9/16" (54.8 cm)		
Basin area, top	53-1/2" (135.9 cm) x 32-1/8" (81.6 cm)		
Weight	110 lbs (50 kg)		
To overflow:			
Water depth	15" (38.1 cm)		
Capacity	57 gal (215.9 L)		
* Approximate measurements for comparison only.			
Included components:			
Cut-out template			1042556-7
Pump:	V	Hz	A
1-speed	120	60	7.5
Minimum access panel pump/control:			
20" (50.8 cm) W x 15" (38.1 cm) H			required

### Required Electrical Service

Dedicated circuit required, protected with Class A Ground-Fault Circuit-Interrupter (GFCI):	
Pump/control	120 V, 15 A, 60 Hz
Locate the outlet behind the whirlpool and within 24" (61 cm) of the pump.	

### Installation Notes

Install this product according to the installation guide.

Floor support under whirlpool must provide for a minimum of 35 lbs/square foot (171 kg/square meter) loading.

The pump extends 9" (22.9 cm) beyond the edge of rim. Modify the framing as needed.

Fixture conforms to ANSI Standard Z124.1.2. All dimensions are nominal.

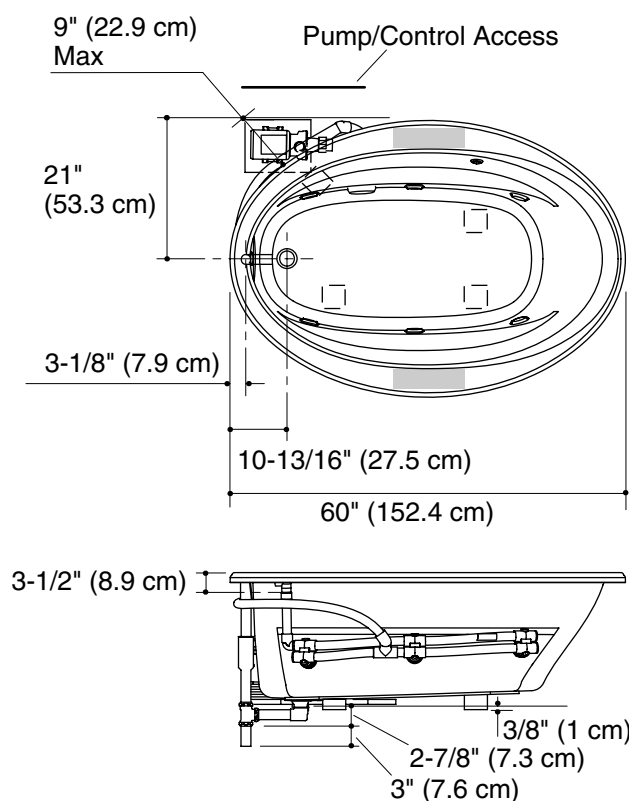

No change in measurements if connected with drain illustrated. (K-11677 or K-11677M)

Recommended faucet area

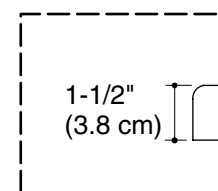

**Drop-In Rim Detail**

