

# KOHLER®

## Roughing-In

**K-1164**  
**SUNWARD®**  
**BATH WHIRLPOOL**

### Product Information

Applicable product:			
Bath whirlpool – drop-in			K-1164
Fixture*:			
Bathing well:			
Basin area, bottom	55-1/4" (140.3 cm) x 23-1/2" (59.7 cm)		
Basin area, top	64-1/2" (163.8 cm) x 32" (81.3 cm)		
Weight	112 lbs (50.9 kg)		
To overflow:			
Water depth	15" (38.1 cm)		
Capacity	75 gal (284.1 L)		
* Approximate measurements for comparison only.			
Pump:	V	Hz	A
1-speed	120	60	7.5
Minimum access panel pump/control:			
20" (50.8 cm) W x 15" (38.1 cm) H			required
Included components:			
Cut-out template		1042557-7	

### Required Electrical Service

Dedicated circuit required, protected with Class A Ground-Fault Circuit-Interrupter (GFCI):

Pump/control 120 V, 15 A, 60 Hz

Locate the outlet behind the whirlpool and within 24" (61 cm) of the pump.

### Installation Notes

Install this product according to the installation guide.

Floor support under whirlpool must provide for a minimum of 37 lbs/square foot (178 kg/square meter) loading.

This fixture conforms to ANSI Standard Z124.1.2. All dimensions are nominal.

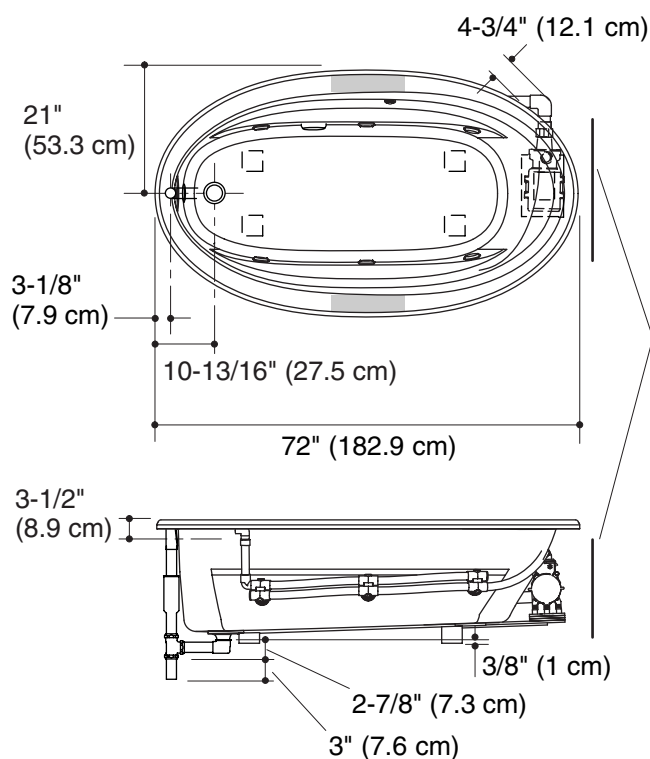

No change in measurements if connected with drain illustrated. (K-11677 or K-11677M)

Recommended faucet area

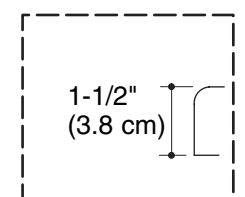

**Drop-In Rim Detail**

Pump/Control Access

