

KOHLER®

Roughing-In

K-1162
SUNWARD®
BATH WHIRLPOOL

Product Information

Applicable product:			
Bath whirlpool – drop-in		K-1162	
Fixture*:			
Bathing well:			
Basin area, bottom	43" (109.2 cm) x 21-9/16" (54.8 cm)		
Basin area, top	53-1/2" (135.9 cm) x 32-1/8" (81.6 cm)		
Weight	110 lbs (50 kg)		
To overflow:			
Water depth	15" (38.1 cm)		
Capacity	57 gal (215.9 L)		
* Approximate measurements for comparison only.			
Pump:	V	Hz	A
1-speed	120	60	7.5
Minimum access panel pump/control:			
20" (50.8 cm) W x 15" (38.1 cm) H			required
Included components:			
Cut-out template			1042556-7

Required Electrical Service

Dedicated circuit required, protected with Class A Ground-Fault Circuit-Interrupter (GFCI):

Pump/control 120 V, 15 A, 60 Hz

Locate the outlet behind the whirlpool and within 24" (61 cm) of the pump.

Installation Notes

Install this product according to the installation guide.

Floor support under whirlpool must provide for a minimum of 35 lbs/square foot (171 kg/square meter) loading.

The suction line extends 4-5/8" (11.7 cm) beyond the edge of the rim. The pump base extends 1/8" (3 mm) beyond the edge of the rim. Modify the framing as needed.

Fixture conforms to ANSI Standard Z124.1.2. All dimensions are nominal.

No change in measurements if connected with drain illustrated. (K-11677 or K-11677M)

Recommended faucet area

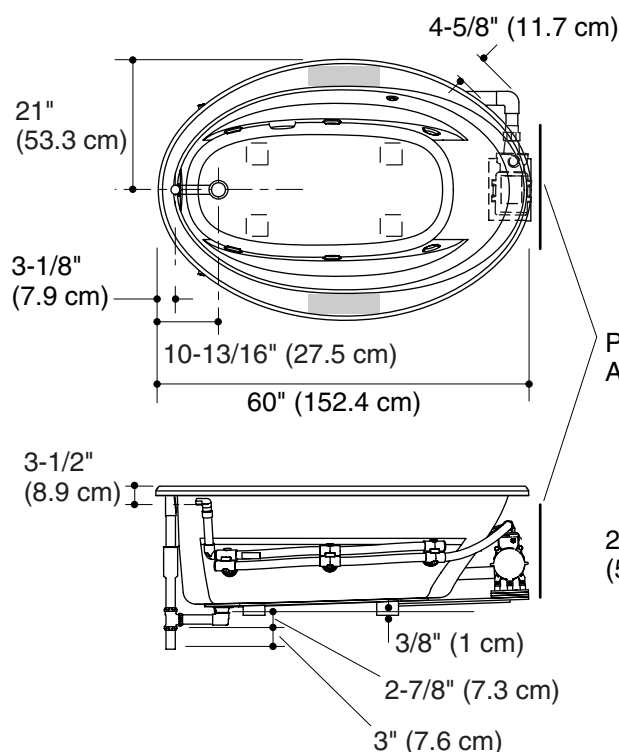

Pump/Control Access

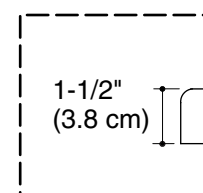

Drop-In Rim Detail

