



Juno Wafer™ LED Downlight Series

4" LED Regressed Switchable Downlight

650 Lumens

WF4 REG SWW5 Series



Dimensions

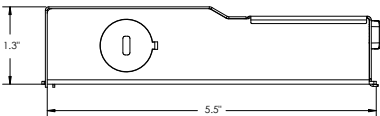
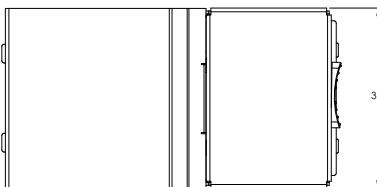
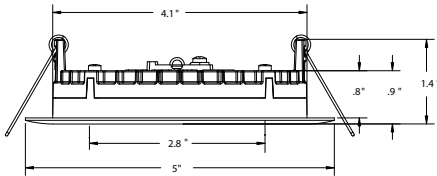

Project:
Fixture Type:
Location:
Contact/Phone:

Product Features

The 4" regressed round baffle with 5CCT Switchable White technology provides high-quality light output and efficiency featuring a switch for easy color temperature adjustment to choose between 2700K, 3000K, 3500K, 4000K, or 5000K - while eliminating the need for recessed housings.

- Regressed lens and baffle trim design to reduce glare for comfortable and even illumination
- Canless - no can required; equals easy to install and less labor
- 5 selectable color temperatures to choose with a switch ranging from warm (2700K) to daylight (5000K) allowing customization for endless applications

Applications

- Residential and light commercial including multi-family, hotels, assisted living, dormitories and other multi-level construction
- Shallow slim profile allows for easy retrofit, remodel or new construction insulated and drop ceiling installations
- Wet rated and airtight: perfect for showers, bathrooms, and outdoor soffits

Performance

Delivered Lumens	650L Nominal at 3000K
LED Color Temperature	Switchable White (2700K, 3000K, 3500K, 4000, 5000K) Default set at 3000K
CRI	90CRI
Voltage	Dedicated 120V
Dimming	Dimmable to 10% only with triac dimmers

For a list of compatible dimmers see JUNO-WAFERS-DIM

Specifications

Aperture:	2.8"
Ceiling opening:	4.2"
Overlap trim:	5"
Height:	1.4"
Lens regression:	.5"



Juno Wafer™ LED Downlight Series

4" LED Regressed Switchable Downlight

650 Lumens



ORDERING INFORMATION

Downlight

Example: WF4 SWW5 90CRI MW

Series	Trim Style	Color Temperature	Rendering Index		Finish
WF4 4" Regressed Baffle LED Downlights	REG Regressed	SWW5 Switchable White (2700K, 3000K, 3500K, 4000K, 5000K)	90CRI	90+ CRI	MW Matte White

Accessories: Order as separate catalog number.

Series	Description
WF8643 PAN U	Universal New Construction Pan
WF4 PAN R12	4" new construction pan, retail pack of 12
WF4GR MW JZ	4" Goof Ring
WFJB U	Remodel Joist Bar
WFEXC6 SW3PIN FT4	3-Pin 6ft Cable
WFEXC10 SW3PIN FT4	3-Pin 10ft Cable
WFEXC20 SW3PIN FT4	3-Pin 20ft Cable



WF8643 UNIVERSAL New Construction Pan

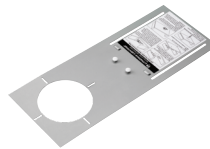

WF4 PAN 4" New Construction Pan



Remodel Joist Bar



WFEXCx 3-Pin Cable

PERFORMANCE DATA

WF4 REG SWW5	
Input Voltage	120V
Input Power Typical	9W (+/-5%)
Frequency	60 Hz
EMI/RFI	FCC Title 47, Part 15 Class B (consumer)
Minimum Starting Temp	-40°F (-40°C)

Note: Actual performance may differ as a result of end-user environment and application. All values are design or typical values, measured under laboratory conditions at 25°C.

LIGHTING PERFORMANCE DATA DONNÉES SUR LE RENDEMENT DE L'ÉCLAIRAGE	
Light Appearance (CCT) Aspect de la lumière (CCT)	
2700K soft white blanc doux	640 lumens 71 lumens per watt
3000K warm white blanc chaud	650 lumens 72 lumens per watt
3500K neutral white blanc neutre	660 lumens 73 lumens per watt
4000K cool white blanc froid	670 lumens 74 lumens per watt
5000K daylight blanc neutre	680 lumens 75 lumens per watt
Watts	9
Color Accuracy (CRI) Précision des couleurs (CRI)	90



Juno Wafer™ LED Downlight Series

4" LED Regressed Switchable Downlight

650 Lumens



Specifications

Housing

Die cast aluminum mounting frame with integral polycarbonate flange provides passive thermal cooling achieving L70 at 50,000 hours • Lens regressed to .5" with baffle trim design to reduce glare for comfortable and even illumination

- FT4 3-pin plenum rated cable connector to connect from module to remote driver box
- Steel spring clip for easy installation. 4" cut out template is provided to ensure a correct sized hole is cut into ceiling for proper installation of the trim. Size of hole should not exceed 4 ¼ inches for this product
- Can be installed from 3/8" to 1 ½" ceiling thickness
- Can be removed from below the ceiling for service or replacement.

LED Light Engine

LEDs are integrated to one piece high purity aluminum, thermally conductive housing to provide uninterrupted heat transfer to ensure long life of the LED

- Switchable white color temperature from 2700K, 3000K, 3500K, 4000K, 5000K • 90 CRI minimum • Color accuracy within 4 step McAdams Ellipse at the end CCT (2700K and 5000K), within 6 step McAdams Ellipse in the middle CCT (3000K, 3500K, and 4000K)
- Dimming 100% to 10% with most standard incandescent dimmers (see list of approved dimmers).

Driver

Connect directly to 120V Class-2 (CAN ICES-005 (B) / NMB-005 (B)) LED driver. 120V 60 Hz constant current driver provides noise free operation

- IC rated driver with convenience of a switch to choose between 5 selectable color temperature options ranging from 2700K (warm white), 3000K, 3500K, 4000K, or 5000K (daylight)
- The isolated driver integrated inside steel remote box with four 7/8" knockouts with slots for pryout. Suitable for pulling wires with the 12 cubic-inch wiring compartment to accommodate up to (6) 14 gauge insulated conductors; making the Wafer LED Downlights much easier to wire in 2in/2out (plus ground) daisy-chain applications and contractor friendly
- 3" plenum space required for installation of the remote driver box.

Optical System

Edge-lit LED technology uses light guided plate to distribute light • Polycarbonate lens provides even illumination throughout the space • Efficient system that can produce over 650 lumens while using 9W • Replaces 65W incandescent.

Life

Rated for 50,000 hours at 70% lumen maintenance.

Labels

CSA certified to US and Canadian safety standards • ENERGY STAR® certified product • Suitable for wet location • Air-Loc certified in accordance with ASTM E283-2004 • NOM Certified • Can be used to comply with California Title 24 Part 6 High Efficacy LED light Source Requirements • IP5X Rated, product is protected against dust • U.S. Patent No. 10,681,784.

Testing

All reports are based on published industry procedures; field performance may differ from laboratory performance.

Warranty 5-year limited warranty. Complete warranty terms located at: www.acuitybrands.com/CustomerResources/Terms_and_conditions.aspx

Specifications subject to change without notice.



Juno Wafer™ LED Downlight Series

4" LED Regressed Switchable Downlight

650 Lumens

PHOTOMETRICS

Distribution Curve

Distribution Data

Output Data

Coefficient of Utilization

Illuminance Data at 30" Above Floor for a Single Luminaire

WF4 REG SWW5 90CRI_2700K Input Watts: 9.0, Delivered Lumens: 664, LPW: 73.8, S/MH: 1.26, Test No: ISF 202635P1

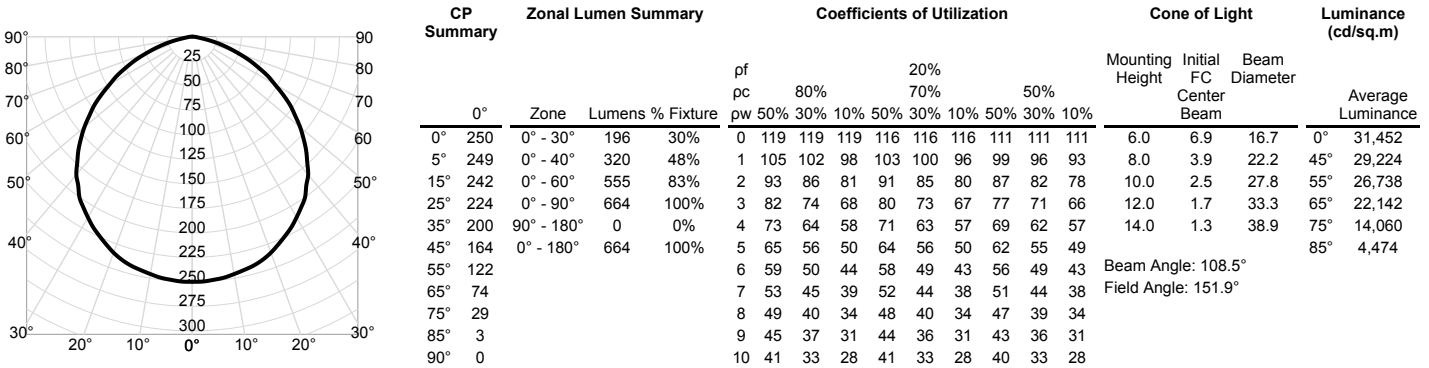

WF4 REG SWW5 90CRI_3000K Input Watts: 9.0, Delivered Lumens: 672, LPW: 74.7, S/MH: 1.26, Test No: ISF 202635P2

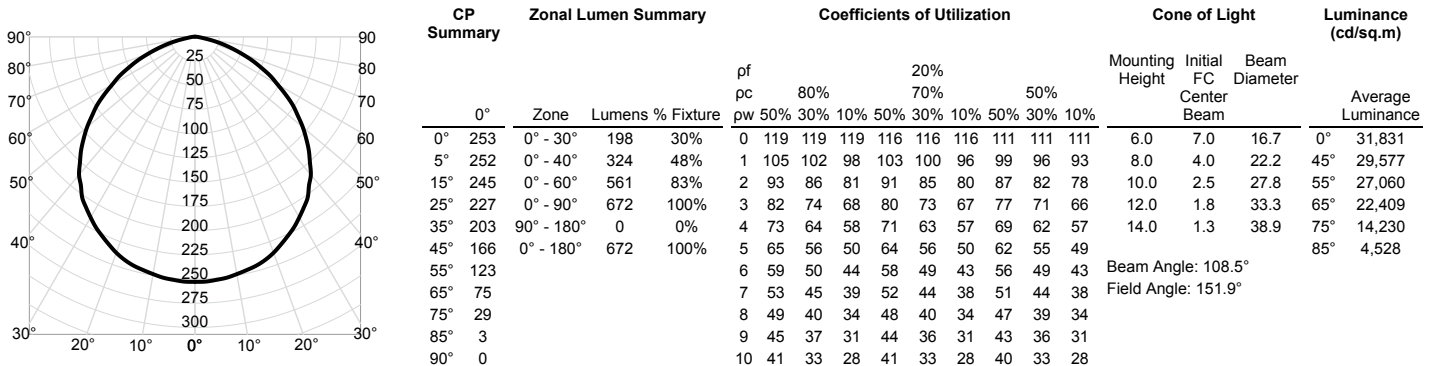

WF4 REG SWW5 90CRI_3500K Input Watts: 9.0, Delivered Lumens: 686, LPW: 76.2, S/MH: 1.26, Test No: ISF 202635P3

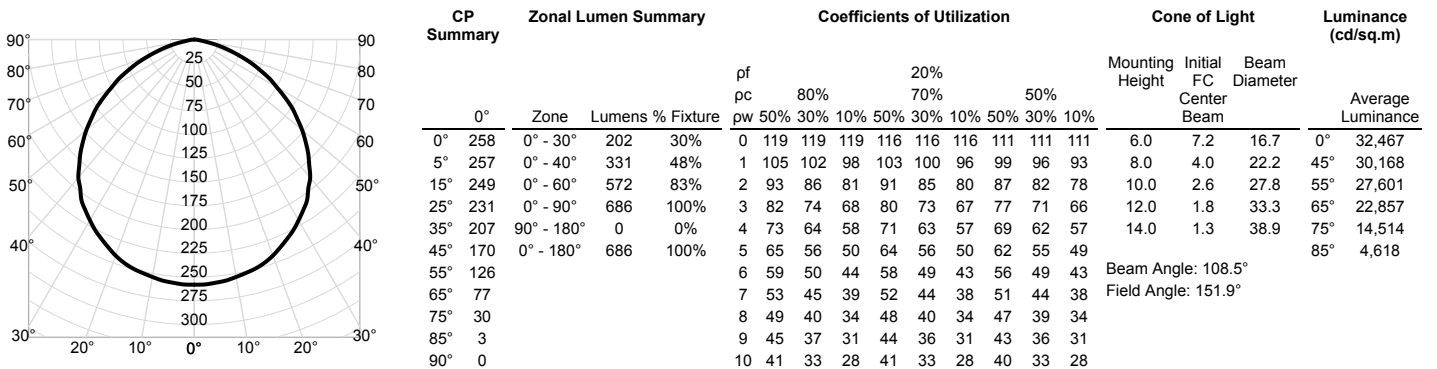



Juno Wafer™ LED Downlight Series

4" LED Regressed Switchable Downlight

650 Lumens

PHOTOMETRICS

Distribution Curve

Distribution Data

Output Data

Coefficient of Utilization

Illuminance Data at 30" Above Floor for a Single Luminaire

WF4 REG SWW5 90CRI_4000K Input Watts: 9.0, Delivered Lumens: 698, LPW: 77.6, S/MH: 1.26, Test No: ISF 202635P4

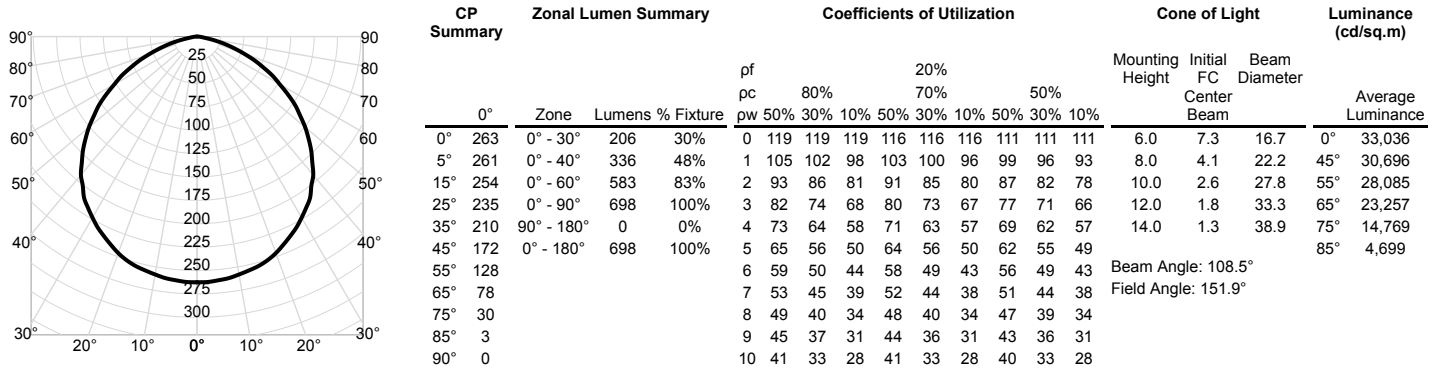

WF4 REG SWW5 90CRI_5000K Input Watts: 9.0, Delivered Lumens: 697, LPW: 77.4, S/MH: 1.26, Test No: ISF 202635P5

