



Operating Instructions and Parts Manual

SMH Series Hand Chain Hoists

With and Without Overload Protection



WMH TOOL GROUP

2420 Vantage Drive
Elgin, Illinois 60124
Ph.: 800-274-6848
www.wmhtoolgroup.com

Part No. M-121704
Revision C 04/23/08
Copyright © WMH Tool Group

Warranty and Service

WMH Tool Group, Inc. warrants every product it sells. If one of our tools needs service or repair, one of our Authorized Service Centers located throughout the United States can give you quick service. In most cases, any of these WMH Tool Group Authorized Service Centers can authorize warranty repair, assist you in obtaining parts, or perform routine maintenance and major repair on your JET® tools. For the name of an Authorized Service Center in your area call 1-800-274-6848.

MORE INFORMATION

WMH Tool Group is consistently adding new products to the line. For complete, up-to-date product information, check with your local WMH Tool Group distributor, or visit jettools.com.

WARRANTY

JET products carry a limited warranty which varies in duration based upon the product. (MW = Metalworking, WW = Woodworking)

90 DAY WARRANTY	1 YEAR WARRANTY	2 YEAR WARRANTY	5 YEAR WARRANTY	LIFE LIFETIME WARRANTY			
Lathe Accessories Machine Accessories Mobile Bases Safety Equipment Specialty Items Vise Accessories	Air Tools- Contractor Air Tools-Industrial Air Tools-Light Industrial Lubrication	Body Repair Kits Bottle Jacks Cable Pullers Cold Saws Hoists-Air Hoists-Electric Metalforming Mill/Drills Milling Machines	MW Bandsaws MW Drill Presses MW Finishing Equipment MW Lathes MW Precision Vises Pallet Trucks	Rigging Equip. Service Jacks Stackers Surface Grinders Tapping Trolleys-Air Trolleys-Electric Web Slings Winches-Electric	<i>Warranty reverts to 1 Year Warranty if woodworking (WW) products listed below are used for commercial, industrial or educational purposes.</i> Trolleys-Gear'd Trolleys-Plain Winches-Manual Manual WW Air Filtration WW Bandsaws Pullers-JCH Models Scissor Lift Tables Screw Jacks	WW Dust Filters WW Dust Fittings WW Joints WW Lathes WW Planers WW Sanders WW Shapers WW Tablesaws	Fastening Tools Mechanics Hand Tools Striking Tools Vises (non-precision) Clamps

WHAT IS COVERED?

This warranty covers any defects in workmanship or materials subject to the exceptions stated below. Cutting tools, abrasives and other consumables are excluded from warranty coverage.

WHO IS COVERED?

This warranty covers only the initial purchaser of the product.

WHAT IS THE PERIOD OF COVERAGE?

The general JET warranty lasts for the time period specified in the product literature of each product.

WHAT IS NOT COVERED?

Five Year Warranties do not cover woodworking (WW) products used for commercial, industrial or educational purposes. Woodworking products with Five Year Warranties that are used for commercial, industrial or education purposes revert to a One Year Warranty. This warranty does not cover defects due directly or indirectly to misuse, abuse, negligence or accidents, normal wear-and-tear, improper repair or alterations, or lack of maintenance.

HOW TO GET SERVICE

The product or part must be returned for examination, postage prepaid, to a location designated by us. For the name of the location nearest you, please call 1-800-274-6848.

You must provide proof of initial purchase date and an explanation of the complaint must accompany the merchandise. If our inspection discloses a defect, we will repair or replace the product, or refund the purchase price, at our option.

We will return the repaired product or replacement at our expense unless it is determined by us that there is no defect, or that the defect resulted from causes not within the scope of our warranty in which case we will, at your direction, dispose of or return the product. In the event you choose to have the product returned, you will be responsible for the shipping and handling costs of the return.

HOW STATE LAW APPLIES

This warranty gives you specific legal rights; you may also have other rights which vary from state to state.

LIMITATIONS ON THIS WARRANTY

WMH TOOL GROUP LIMITS ALL IMPLIED WARRANTIES TO THE PERIOD OF THE LIMITED WARRANTY FOR EACH PRODUCT. EXCEPT AS STATED HEREIN, ANY IMPLIED WARRANTIES OR MERCHANTABILITY AND FITNESS ARE EXCLUDED. SOME STATES DO NOT ALLOW LIMITATIONS ON HOW LONG THE IMPLIED WARRANTY LASTS, SO THE ABOVE LIMITATION MAY NOT APPLY TO YOU.

WMH TOOL GROUP SHALL IN NO EVENT BE LIABLE FOR DEATH, INJURIES TO PERSONS OR PROPERTY, OR FOR INCIDENTAL, CONTINGENT, SPECIAL, OR CONSEQUENTIAL DAMAGES ARISING FROM THE USE OF OUR PRODUCTS. SOME STATES DO NOT ALLOW THE EXCLUSION OR LIMITATION OF INCIDENTAL OR CONSEQUENTIAL DAMAGES, SO THE ABOVE LIMITATION OR EXCLUSION MAY NOT APPLY TO YOU.

WMH Tool Group sells through distributors only. The specifications in WMH catalogs are given as general information and are not binding. Members of WMH Tool Group reserve the right to effect at any time, without prior notice, those alterations to parts, fittings, and accessory equipment which they may deem necessary for any reason whatsoever. JET® branded products are not sold in Canada by WMH Tool Group.

Table of Contents

Warranty and Service.....	2
Table of Contents	3
Warning	4
Introduction	6
Specifications	6
Using the Chain Hoist	7
Prior to Operation	7
Hooking the Load	8
Raising the Load.....	8
Hand Chain – Cutting and Installing	9
Load Chain and Bottom Hook.....	10
Load Chain Inspection (all models).....	10
Load Chain Removal (all models).....	10
Load Chain and Bottom Hook Installation.....	11
Chain Installation – 1- and 2-Ton Hoists	11
Chain Installation – 3- and 5-Ton Hoists	11
Chain Installation – 10-Ton Hoists	12
Attaching Load Chain to Load Chain Sprocket (all models).....	10
Inspection and Maintenance	13
Load Limits.....	14
Load Chain	14
Hooks (Top & Bottom)	14
Replacement Parts.....	14
Parts.....	15
SMH Chain Hoist.....	15
Parts List: 1/2-Ton SMH Chain Hoist	16
Parts List: 1-Ton SMH Chain Hoist	17
Parts List: 1-1/2 Ton SMH Chain Hoist	18
Parts List: 2-Ton SMH Chain Hoist	19
Parts List: 3-Ton SMH Chain Hoist	20
Parts List: 5-Ton SMH Chain Hoist	21
Parts List: 10-Ton SMH Chain Hoist	22



Warnings

1. Read and understand this entire manual before attempting assembly or operation.
2. Read and understand the warnings posted on the hoist and in this manual. Failure to comply with all of these warnings may cause serious injury.
3. Replace the warning labels if they become obscured or removed.
4. Do not use this hoist for other than its intended use. If used for other purposes, WMH Tool Group disclaims any real or implied warranty and holds itself harmless from any injury that may result from that use.
5. Always wear approved safety glasses/face shields while using this hoist. Everyday eyeglasses only have impact resistant lenses; they are not safety glasses.
6. Before operating this hoist, remove tie, rings, watches and other jewelry, and roll sleeves up past the elbows. Remove all loose clothing and confine long hair. Non-slip footwear or anti-skid floor strips are recommended. Do **not** wear gloves.
7. This hoist is designed and intended for use by properly trained and experienced personnel only. If you are not familiar with the proper and safe operation of a hoist, do not use until proper training and knowledge have been obtained.
8. Do not use to lift people or loads over people.
9. Do not exceed the rated capacity of the hoist.
10. Do not use hoist chain as a sling. This may cause damage to the chain.
11. Always inspect the hoist for damage prior to use. If hoist is damaged, do not use until it has been repaired or replaced.
12. Do not use more than one hoist to lift or move a load. If this is unavoidable, each hoist must have the same capacity as the load to be moved.
13. Never allow chain to “set” over sharp edges. All pulls or lifts must be made with straight chain that is free of obstacles.
14. If the hoist is difficult to operate, then the load exceeds the capacity of the hoist. Select a hoist of larger capacity.
15. Do not use a hoist if the chain is twisted, kinked or damaged.
16. Do not operate hoist unless load is centered between top and bottom hooks.
17. Always take time to study the job to be performed and choose the safest method. Do not place yourself or other people in an unsafe position.
18. Leave all internal maintenance and inspections to a qualified JET repair station.
19. Replace chain with factory replacement chain only. Do not use any other type of chain.
20. Never use the hoist if either hook is stretched, deformed, or has a broken or missing safety latch. Always replace the safety latch and/or the hook before placing the hoist back in service.
21. Provide for adequate space surrounding work area and non-glare, overhead lighting.
22. Keep the floor around the machine clean and free of scrap material, oil and grease.
23. Keep visitors a safe distance from the work area. **Keep children away.**
24. Give your work undivided attention. Looking around, carrying on a conversation and “horse-play” are careless acts that can result in serious injury.
25. Stand to one side of the load being lifted and make sure no one else is standing underneath when lifting a load. Should a load slip, it will descend at a high rate of speed and can cause serious injuries to anyone standing directly underneath.

Warnings

26. Do not force a tool or attachment to do a job for which it was not designed. The right tool will do the job better and safer.
27. Use recommended accessories; improper accessories may be hazardous.
28. Maintain tools with care. Follow instructions for lubricating the hoist and changing accessories.
29. Understand and follow all procedures as set forth in American National Standards titled *Performance Standard for Hand Chain Manually Operated Chain Hoists*. ANSI/ASME HST-2. This standard is available through the American Society of Mechanical Engineers, 345 East 47th St., NY, NY 10017

Familiarize yourself with the following safety notices used in this manual:

CAUTION This means that if precautions are not heeded, it may result in minor injury and/or possible machine damage.

WARNING This means that if precautions are not heeded, it may result in serious injury or possibly even death.

- - SAVE THESE INSTRUCTIONS - -

Introduction

This manual is provided by WMH Tool Group covering the safe operation and maintenance procedures for a JET Model SMH Series Chain Hoist. This manual contains instructions on installation, safety precautions, general operating procedures, maintenance instructions and parts breakdown. This tool has been designed and constructed to provide years of trouble free operation if used in accordance with instructions set forth in this manual. If there are any questions or comments, please contact either your local supplier or WMH Tool Group. WMH Tool Group can also be reached at our web site: www.wmhtoolgroup.com.

Specifications

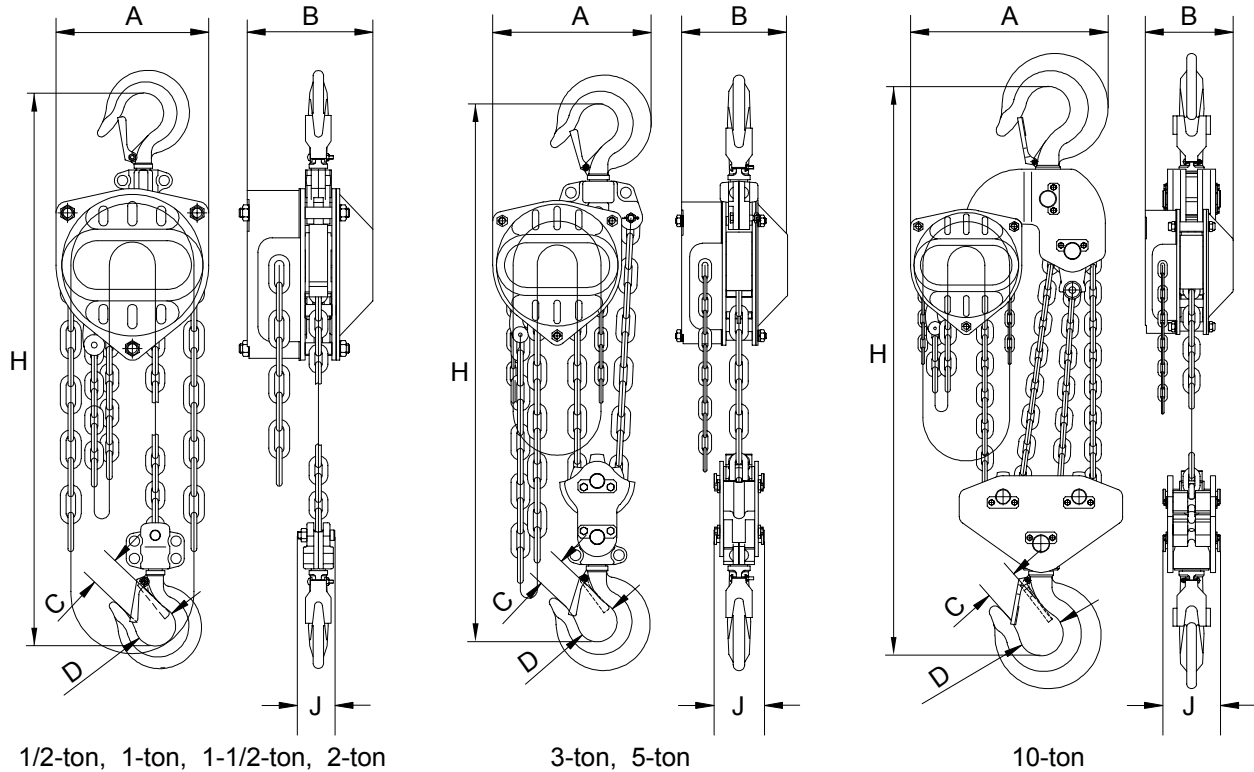

Rated Capacity (ton)	No. of Falls	Load Chain Dia. (m)	Pull to Lift Capacity (lbs)	Req'd Hand Chain (ft.) to lift load 1	A (in)	B (in)	C (in)	D (in)	H min. (in)	J (in)
1/2	1	5	49	32	5.20	4.41	1.02	1.38	13	1.26
1	1	6.3	80	37	6.14	5.20	1.18	1.57	15	1.36
1-1/2	1	7	82	58	7.00	5.75	1.34	1.77	17.5	1.61
2	1	8	91	70	7.72	5.75	1.50	1.97	18.5	1.67
3	2	7	86	116	8.66	5.75	1.65	2.17	23.5	2.72
5	2	9	97	172	10.31	6.69	1.89	2.56	28	3.03
10	4	9	104	344	14.96	6.69	2.56	3.35	35	4.33

* Chain is available in various lengths. Specify required length when ordering.

The above specifications were current at the time this manual was published, but because of our policy of continuous improvement, WMH Tool Group reserves the right to change specifications at any time and without prior notice, without incurring obligations.

Using the Chain Hoist

Prior to Operation

1. Support for the hoist may be hook, clevis pin, trolley, or beam clamp. Whatever method of suspension is chosen, the support components **must** be rated equal to, or greater than the capacity of the chain hoist.
2. If the chain hoist has not been used for an extended period of time, check for proper operation before putting into service.
3. The brake mechanism must be kept clean and free from dirt, water, and oil. Never allow oil to penetrate the brake mechanism. Always keep your chain hoist clean and store in a clean, dry location.
4. Although oiling the chain is not mandatory, a light coat of 30-weight oil applied periodically to the chain will create easier operation and prolong the life of the chain.
5. Check the chain for damage and elongation. Replace damaged chain before using the chain hoist.

The load chain supplied with your JET chain hoist is designed, manufactured, and tested for proper fit and durability. Over a period of time, the chain may need to be replaced. For your own safety, use factory replacement chain only.

⚠WARNING Use of other than factory replacement chain may cause serious injury and/or damage to the hoist.

6. The top and bottom hooks on your JET chain hoist are designed to open to warn of an overload. Both top and bottom hooks have three indicator points cast into the hook. See Figure 1. Measurements between all three indicator points should be the same. If they are not the same, the hook must be replaced.
7. It is important to check top and bottom hooks for proper opening. If the safety latch no longer contacts the hook opening, replace the hook. **Never side load the top or bottom hook; this practice is dangerous and could lead to serious injury.**
8. If the vertical angle at the neck of the bottom or top hook reaches 10° , replace the hook (see Figure 2).

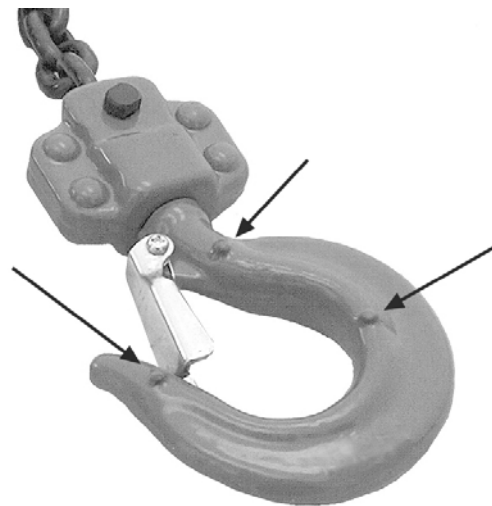

Figure 1

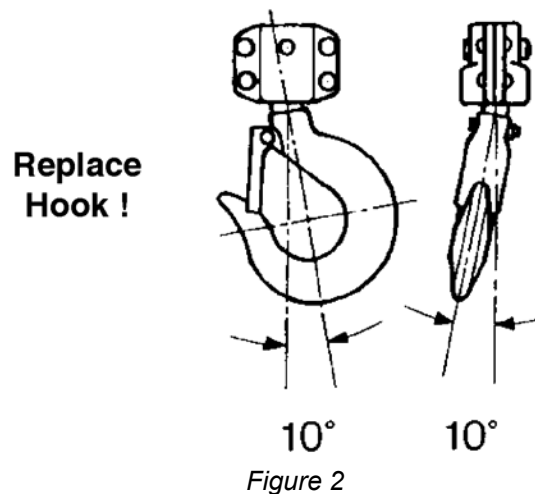

Figure 2

Hooking the Load

1. Secure the upper hook.
2. Place the bottom hook securely into the object to be lifted.
3. Place ropes or chain in the center of the bottom hook, making sure the safety latch is secure. Never load the hook in front of the safety latch. See Figure 3.
4. Avoid lifting one load with two hoists. If this is unavoidable, apply equal weight to both hoists and use hoists with the proper lift capacity. **Capacity of each hoist must be equal to the total load to be lifted.**
5. Check that the chain is not twisted at the bottom hook. All welds should face the same direction (Figure 4).
6. For hoists with two or more falls of chain, make sure the bottom hook is not turned over. This may cause the chain to twist.

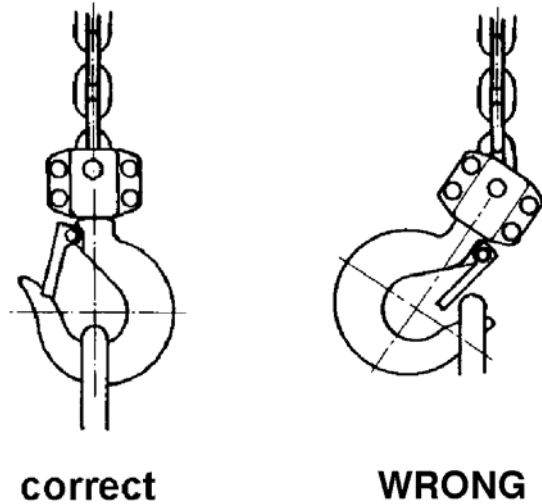

Figure 3

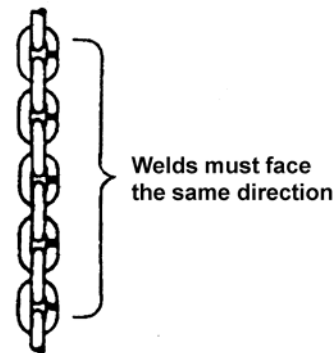

Figure 4

Raising the Load

To raise the load, pull the right side of the hand chain (A, Figure 5) clockwise.

To lower the load, pull the left side of the hand chain (B, Figure 5) counterclockwise.

Important: Make sure the hoist has an adequate length of load chain to raise or lower the load in a safe manner. Do not attempt to lower the hoist beyond its limit.

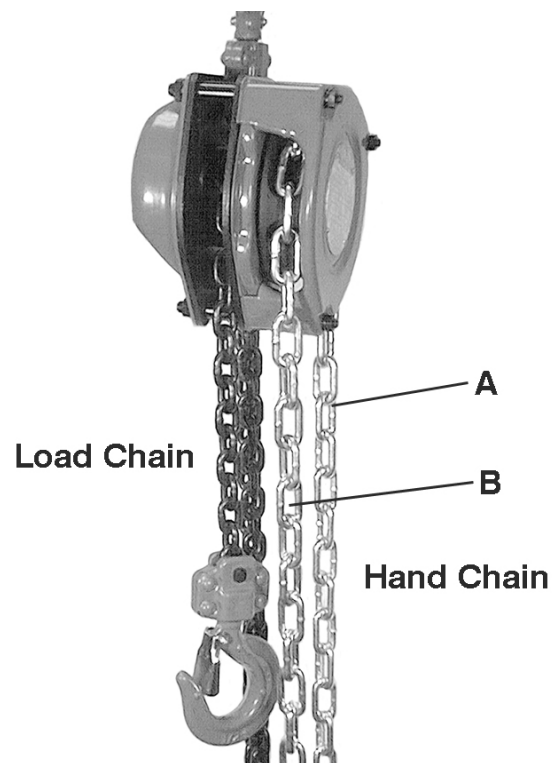

Figure 5

Hand Chain – Cutting and Installing

To cut the hand chain in order to increase or shorten:

1. Insert one link lengthwise into the vise (Figure 6). Be sure that the side opposite the weld lies completely below the surface of the vise jaw (about 1/3 of a link). This prevents nicking or cutting the lower part of the link.
2. Using a hack saw, cut through the upper part of the link at the weld.
3. Loosen the link, reposition the link vertically at the edge of the vise with the level of the cut above the vise jaw (Figure 7).
4. Tighten the vise jaw.
5. Using an adjustable wrench, twist the link horizontally from front to back. (Figure 8) Open just far enough to insert (or remove) a second chain link.

Note: Chain length is now ready to lengthen or shorten.

6. Insert or remove the second end link at the opening in the first end link.
7. Using an adjustable wrench, twist the link horizontally until the link is in the original closed position. See Figure 9.

CAUTION Do not push the link inward from the curved ends. This will distort the link. Check that the link is closed and free of twist.

8. If installing entire new chain, insert the end of the hand chain into the groove at the top of the hand chain wheel (see Figure 10). Rotate the handwheel and pull the chain through.
9. Re-weld the link at the cut.
10. Grind off excess on the weld so that it is smooth.

WARNING Do not operate the hoist with a twisted, kinked or damaged load chain. Do not splice the load chain. Check the chain for excessive wear or stretch. Failure to comply may cause serious injury.

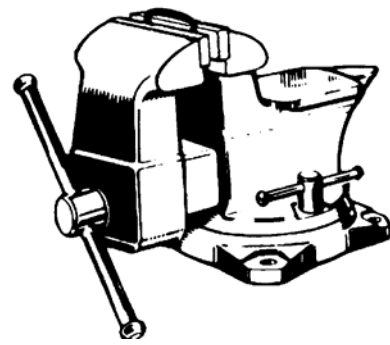

Figure 6

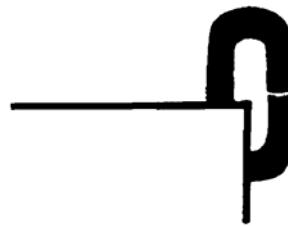

Figure 7

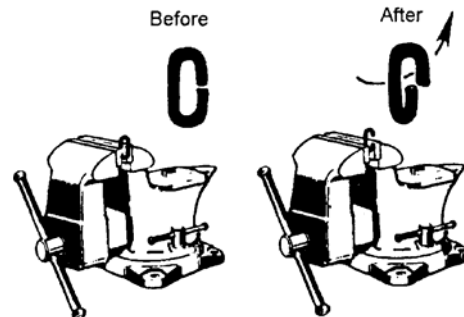

Figure 8

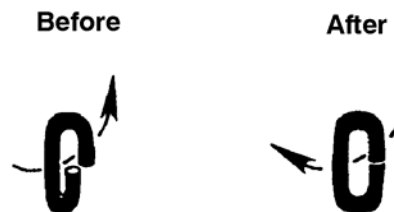

Figure 9

Load Chain and Bottom Hook

Load Chain Inspection (all models)

Over time, the load chain will wear or elongate. This can cause damage to the hoist, breakage, or non-engagement of the load sheave.

⚠WARNING Do not operate the hoist with a twisted, kinked or damaged load chain. Do not splice the load chain. Check the chain for excessive wear or stretch. Failure to comply may cause serious injury.

To inspect the load chain for wear:

1. Test the hoist under load in both the lifting and lowering directions, observing the operation of chain and sprockets. Chain should feed smoothly into and away from the sprockets.
2. If the chain binds, jumps, or is noisy, make sure it is clean and properly lubricated. If the trouble persists, inspect the chain and mating parts for wear, distortion, or other damage.
3. Clean the chain before inspection. Examine for gouges, nicks, weld splatter, corrosion, and distorted links. Slacken the chain and move adjacent links to one side, looking for wear at the contact points. If you see wear or suspect stretching, measure the chain as follows:
 - Select an unworn, unstretched length of chain (i.e. at the slack end).
 - Suspend the chain vertically under tension and, using a caliper type gauge, measure the outside length of several links about 12 to 24 inches.
 - Measure the same number of links in used sections and calculate the percentage of the increase in length.
4. If the length of used chain exceeds 2-1/2 percent of the unused chain, replace the chain.

⚠WARNING Do not add to the load chain. Replace the entire chain. Failure to comply may cause serious injury.

Load Chain Removal (all models)

Remove the old load chain as follows while referring to Figure 11:

1. Remove the *split pin* (A) and the *pin stopper* (B) on the *chain anchor* (C), allowing the end of the chain to fall free.
2. Pull the *hand chain* (Fig. 5) until the load chain is completely removed from the gear assembly.

Attaching Load Chain to Load Chain Sprocket (all models)

Install the new load chain onto the load chain sprocket as follows, referring to Fig. 10:

1. Position the *load chain sprocket* by rotating the *hand chain wheel* so that the wide and narrow grooves show.
2. Insert the load chain into the sprocket grooves so that the chain will wind up and back over the sprocket. *Welds must face away from the sprocket.*
3. Rotate the hand chain wheel so that the load chain falls six to eight inches at the back of the sprocket.

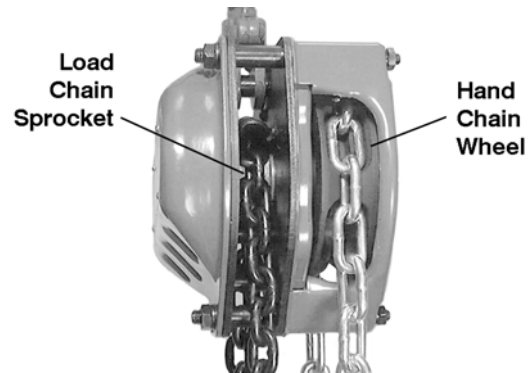

Figure 10

Referring to Figure 11:

4. Insert one end of the *chain link* (D) into the *chain anchor* (C).
5. Insert the *pin stopper* (B) through the *chain anchor* (C) and *chain link* (D) and secure with the *split pin* (A).

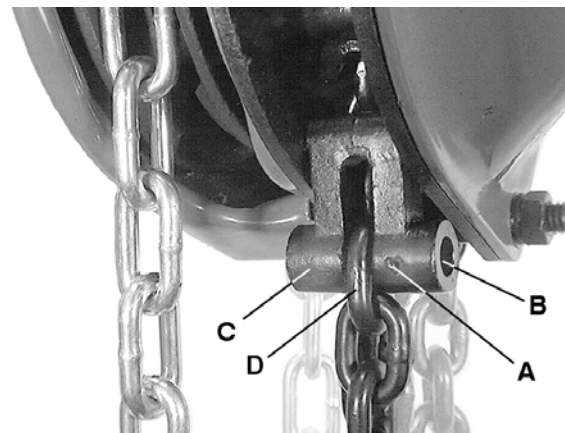

Figure 11

Continue with *Load Chain and Bottom Hook Installation* on the following page, proceeding to the section that applies to you, *1- and 2-Ton hoists* or *3- and 5-Ton hoists*.

Load Chain and Bottom Hook Installation

The following procedure assumes that the *load chain* has been attached to the *chain anchor* and fed through the *load chain sprocket* as described in the previous section. This section completes the load chain and bottom hook installation.

Chain Installation – 1- and 2-Ton Hoists

1. Referring to Figure 12:
2. Remove the *split pin*, *castle nut* and *bolt (D)* from the lower hook.
3. Insert the last *chain link (C)* into the lower hook slot.
4. Re-insert the bolt through the lower hook slot and chain link.
5. Re-attach the castle nut to the bolt and secure with the split pin.

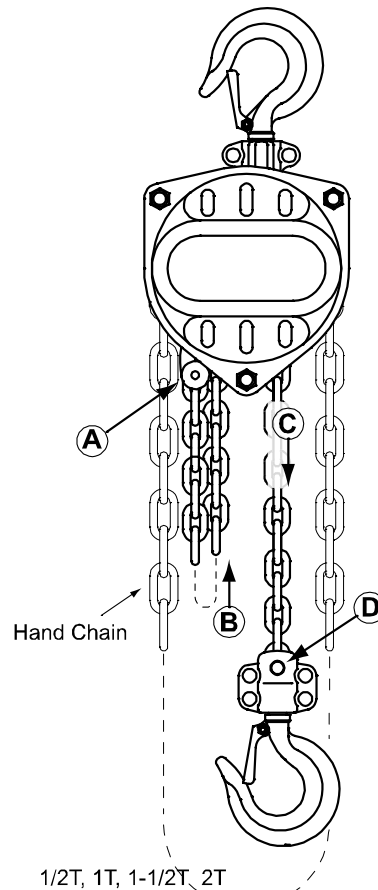

Figure 12

Chain Installation – 3- and 5-Ton Hoists

Referring to Figure 13:

1. After installing the load chain into the *load chain sprocket (B)*, run the remaining chain through your hand to remove any twist. The last link of the chain must be in the same direction as the first. If not, cut off the last link.
2. Insert the last link into the pulley of the *lower hook (C)*.
3. Pull the *load chain* through and up from the underside of the pulley (C, D).
4. Remove the *split pin* and *chain anchor pin* in the *upper hook slot (E)*.
5. Insert the last link into the upper hook slot.
6. Check that the load chain is not twisted.
7. Re-position the chain anchor pin back through the upper hook slot and the last chain link and secure with the split pin.

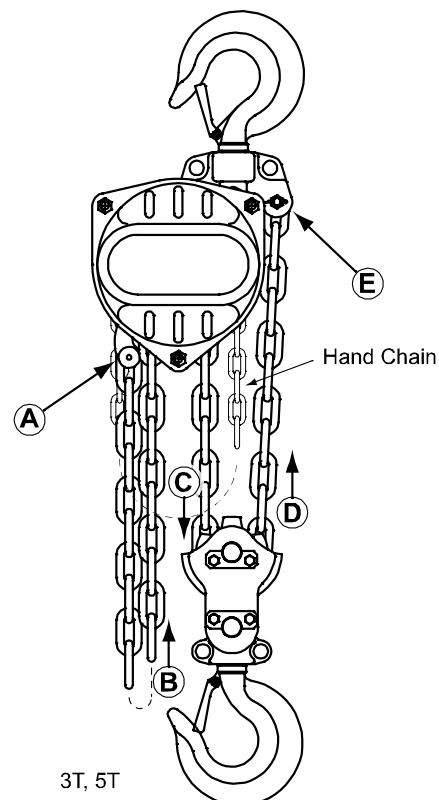

Figure 13

Chain Installation – 10-Ton Hoists

Referring to Figure 14:

1. After installing the load chain into the *load chain sprocket* (B), run the remaining chain through your hand to remove any twist. The last link of the chain must be in the same direction as the first. If not, cut off the last link.
2. Insert the last link into the left pulley of the *lower hook* (C).
3. Pull the *load chain* through and up from the underside of the pulley (C, D).
4. Insert the *last link* into the pulley of the upper hook (D), moving the chain up, around, and then down (E). Check that the load chain is not twisted and welds face away from the pulley.
5. To prevent the chain from free-wheeling, insert a screwdriver securely into a link at the base of the upper pulley (left side).
6. Insert the *last link* into the right pulley of the lower hook (E).
7. Pull the *load chain* through and up from the underside of the pulley (E, F).
8. Remove the *split pin*, *castle nut*, and the *chain bolt* in the upper hook slot (G).
9. Insert the last link into the upper hook slot.
10. Check that the load chain is not twisted.
11. Position the chain bolt back through the upper hook slot and the last chain link.
12. Place the castle nut onto the end of the bolt.
13. Secure the split pin in the tapered hole of the chain bolt.
14. Remove the screwdriver from the link at the base of the upper pulley.

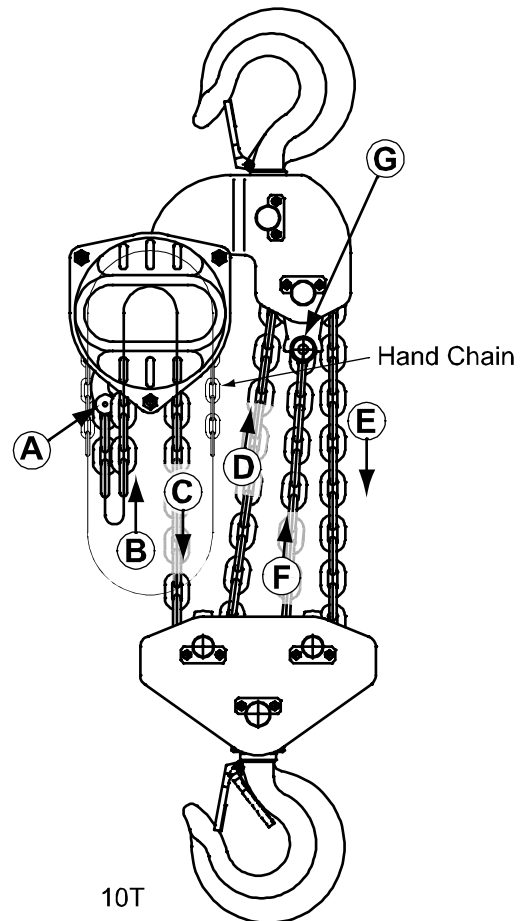

Figure 14

Inspection and Maintenance

Read and follow ANSI Inspection and Maintenance Instructions. Know the meaning of Frequent Inspection, Periodic Inspection, Normal Service, Heavy Service, and Severe Service. It is the customer's responsibility to understand and follow all ANSI and JET inspection and maintenance instructions.

▲WARNING All repairs and adjustments are to be performed by trained and experienced personnel using procedures that are approved for the hoist system being serviced.

▲WARNING All safety related deficiencies discovered in the inspection are to be corrected before the hoist is to be placed back into service.

▲WARNING Check for internal damage whenever external damage has occurred. Failure to comply may cause serious injury.

1. Clean hoist after each use and oil lightly.
2. Do not drop or drag the hoist.
3. Store the hoist in a clean and dry environment.
4. Chain oiling is not mandatory but will increase the life of the chain.
5. Leave all repairs and adjustments of internal parts to qualified repair personnel.
6. Inspect the load chain and the lower hook after lifting a maximum weight load.
7. This hoist uses special alloy hoisting chain and does not interchange with any other manufacturer. All replacement chain must be purchased from your JET distributor or from WMH Tool Group directly by calling 800-274-6848.
8. Check and inspect the brake system frequently.
9. Annually, the hoist should be disassembled, inspected, and cleaned by trained and experienced personnel only. Contact a WMH Tool Group authorized service center by calling your dealer or visiting our web site at wmhtoolgroup.com.
10. After servicing, test the hoist with no load, then test the hoist with a load.

Load Limits

Load Chain

Capacity	5 Links Normal	5 Links Limit
1/2 ton	2.95"	3.02"
1 ton	3.74"	3.83"
1-1/2 ton	4.13"	4.23"
2 ton	4.72"	4.84"
3 ton	4.13"	4.23"
5 ton	5.31"	5.44"
10 ton	5.31"	5.44"

Table 1

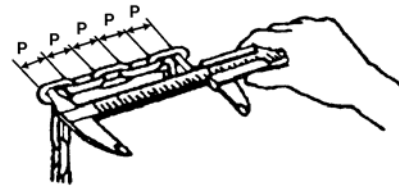

Figure 15

Carefully inspect the entire load chain. As illustrated in Figure 15, measure five consecutive links with calipers to measure the length. Check every three feet and especially where excessive wear is indicated. Any load chain that shows noticeable deformation or heat influence must be replaced with a new one. Never extend load chain by welding a second piece to the original.

Hooks (Top & Bottom)

Capacity	"A" Normal	"A" Limit
1/2 ton	1.02"	1.17"
1 ton	1.18"	1.36"
1-1/2 ton	1.34"	1.54"
2 ton	1.50"	1.73"
3 ton	1.65"	1.90"
5 ton	1.89"	2.17"
10 ton	2.56"	2.94"

Table 2

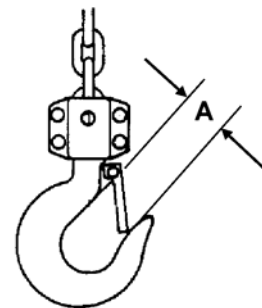

Figure 16

See Figure 16. Replace the hook when the "A" measurement is wider than "A" Limit in the table above. Never heat treat the hook or attach anything to the hook by welding.

Replacement Parts

Replacement parts are listed on the following pages. To order parts or reach our service department, call 1-800-274-6848 between 7:30 a.m. and 5:30 p.m. (CST), Monday through Friday. Having the Model Number and Serial Number of your machine available when you call will allow us to serve you quickly and accurately.

Parts SMH Chain Hoist

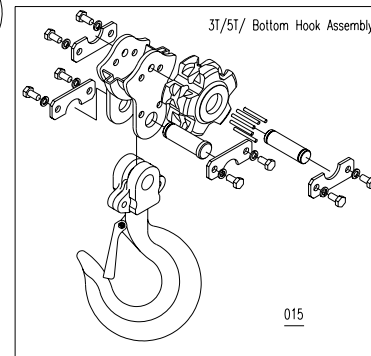
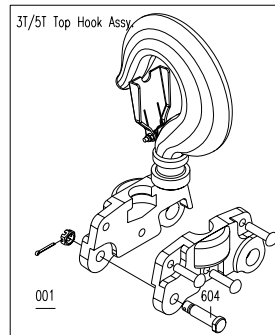
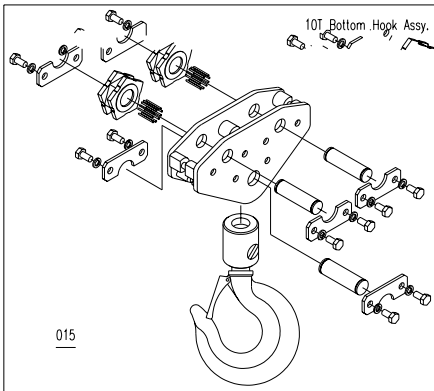
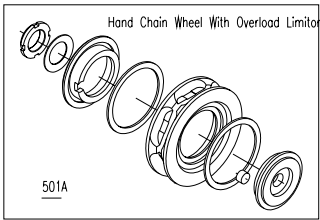
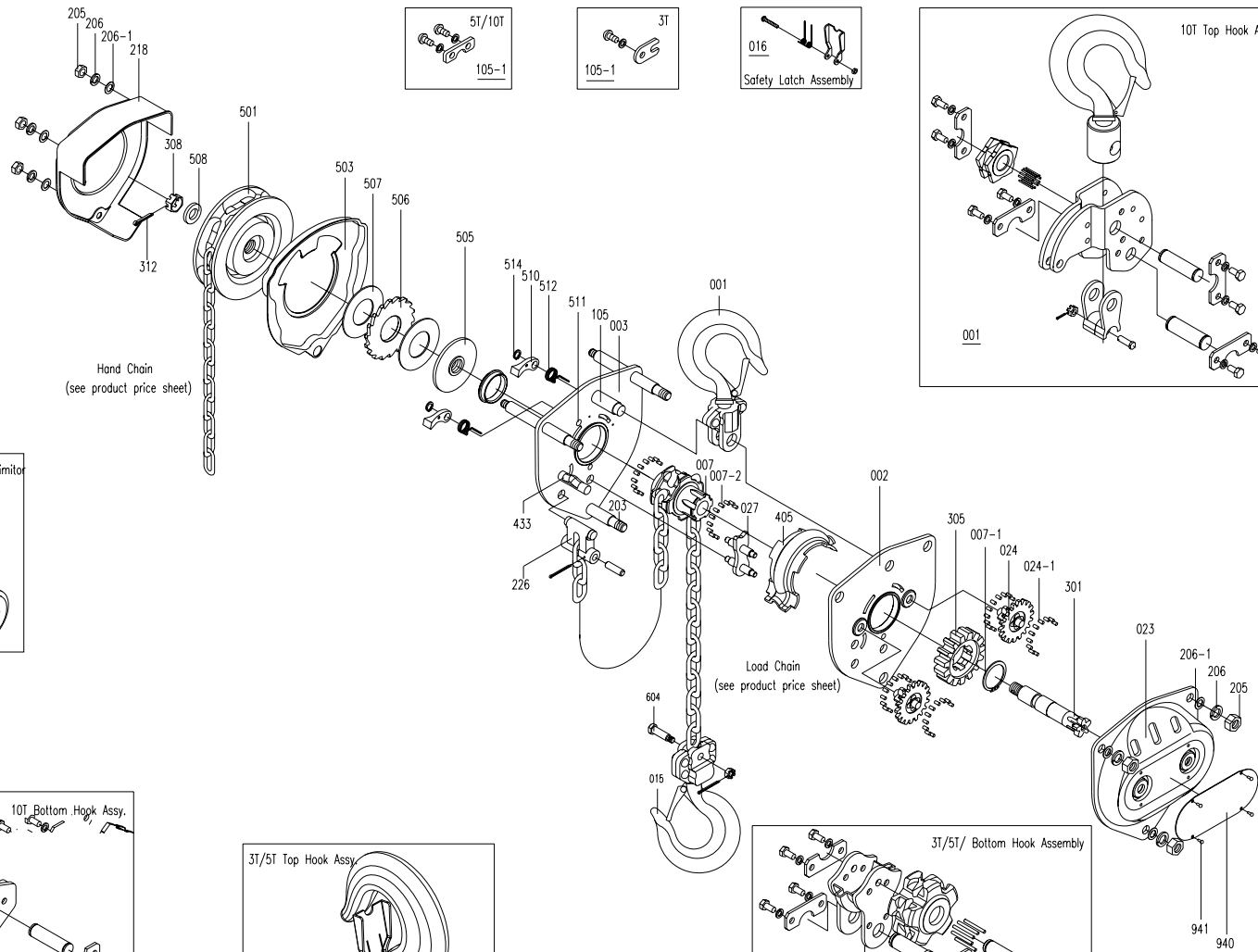
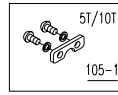
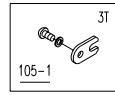
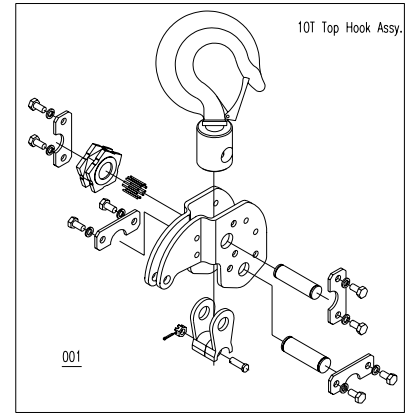

Parts List: 1/2-Ton SMH Chain Hoist

Index No.	Part No.	Description	Size	Qty
001	SMH-001A	Top Hook Assy		1
002	SMH-002A	Gear Side Plate Assy		1
003	SMH-003A	Wheel Side Plate Assy		1
007	SMH-007A	Load Sheave		1
007-1	SMH-007-1A	Snap Ring	28	1
007-2	SMH-007-2A	Roller Kit	58 Rollers	1
015	SMH-015A	Bottom Hook Assy		1
016	SMH-016A	Safety Latch Assy		2
023	SMH-023A	Gear Case Assy		1
024	SMH-024A	Spur Gear Assy		2
024-1	SMH-024-1A	Roller Kit	11 Rollers	4
027	SMH-027A	Stripper Assy		1
105	SMH-105A	TOP Top Hook Pin		1
203	SMH-203A	Stay Bolt		3
205	SMH-205A	Cover Nut		6
206	SMH-206A	Lock Washer		6
206-1	SMH-206-1A	Flat Washer		6
218	SMH-218A	Hand Wheel Cover		1
226	SMH-226A	Anchor Plate		1
301	SMH-301A	Drive Shaft		1
305	SMH-305A	Load Gear		1
308	SMH-308A	Castle Nut		1
312	SMH-312A	Split Pin	2.5x20	1
405	SMH-405A	Load Sheave Cover		1
433	SMH-433A	Load Sheave Cover Pin		1
501	SMH-501A	Hand Chain Wheel		1
503	SMH-503A	Brake Cove		1
505	SMH-505A	Disc Hub		1
506	SMH-506A	Ratchet Gear		1
507	SMH-507A	Friction Disc		2
508	SMH-508A	Check Washer		1
510	SMH-510A	Pawl		2
511	SMH-511A	Pawl Pin		2
512	SMH-512A	Pawl Spring		2
604	SMH-604A	Chain Stop Bolt Assy		1
940	SMH-940A	Name Plate	1/2 Ton	1
941	SMH-941A	Rivet	2.5x6	4
942	187728	Hand Chain*	Ø 5mm	1
943	187721	Load Chain* (1-Ton)	Ø 5mm	1

Parts List: 1-Ton SMH Chain Hoist

Index No.	Part No.	Description	Size	Qty
001	SMH-001B	Top Hook Assembly		1
002	SMH-002B	Gear Side Plate Assembly		1
003	SMH-003B	Wheel Side Plate Assembly		1
007	SMH-007B	Load Sheave		1
007-1	SMH-007-1B	Snap Ring	30	1
007-2	SMH-007-2B	Roller Kit	60 Rollers	1
015	SMH-015B	Bottom Hook Assembly		1
016	SMH-016B	Safety Latch Assembly		2
023	SMH-023B	Gear Case Assembly		1
024	SMH-024B	Spur Gear Assembly		2
024-1	SMH-024-1B	Roller Kit	12 Rollers	4
027	SMH-027B	Stripper Assembly		1
105	SMH-105B	Top Hook Pin		1
203	SMH-203B	Stay Bolt		3
205	SMH-205B	Cover Nut		6
206	SMH-206B	Lock Washer		6
206-1	SMH-206-1B	Flat Washer		6
218	SMH-218B	Hand Wheel Cover		1
226	SMH-226B	Anchor Plate		1
301	SMH-301B	Drive Shaft		1
305	SMH-305B	Load Gear		1
308	SMH-308B	Castle Nut		1
312	SMH-312B	Split Pin	3.2 x 25	1
405	SMH-405B	Load Sheave Cover		1
433	SMH-433B	Load Sheave Cover Pin		1
501	SMH-501B	Hand Chain Wheel		1
501A	SMHX-501B	Hand Chain Wheel Assembly (Overload Protection)		1
503	SMH-503B	Brake Cover		1
505	SMH-505B	Disc Hub		1
506	SMH-506B	Ratchet Gear		1
507	SMH-507B	Friction Disc		2
508	SMH-508B	Check Washer		1
510	SMH-510B	Pawl		2
511	SMH-511B	Pawl Pin		2
512	SMH-512B	Pawl Spring		2
514	SMH-514B	Snap Ring	8	1
604	SMH-604B	Chain Stop Bolt Assembly		1
940	SMH-940B	Name Plate	1 Ton	1
	SMHX-940B	Name Plate (Overload Protection)	1 Ton	1
941	SMH-941A	Rivet	2.5 x 6	4
942	187728	Hand Chain*	Ø 5mm	1
943	187725	Load Chain* (1-Ton)	Ø 6.3mm	1

* Specify required chain length when ordering.

Parts List: 1-1/2 Ton SMH Chain Hoist

Index No.	Part No.	Description	Size	Qty
001	SMH-001C	Top Hook Assy		1
002	SMH-002C	Gear Side Plate Assy		1
003	SMH-003C	Wheel Side Plate Assy		1
007	SMH-007C	Load Sheave		1
007-1	SMH-007-1C	Snap Ring	38	1
007-2	SMH-007-2C	Roller Kit	60 Rollers	1
015	SMH-015C	Bottom Hook Assy		1
016	SMH-016C	Safety Latch Assy		2
023	SMH-023C	Gear Case Assy		1
024	SMH-024C	Spur Gear Assy		2
027	SMH-027C	Stripper Assy		1
105	SMH-105C	Top Hook Pin		1
203	SMH-203C	Stay Bolt		3
205	SMH-205B	Cover Nut		6
206	SMH-206B	Lock Washer		6
206-1	SMH-206-1B	Flat Washer		6
208	SMH-218C	Hand Wheel Cove		1
226	SMH-226C	Anchor Plate		1
301	SMH-301C	Drive Shaft		1
305	SMH-305C	Load Gear		1
308	SMH-308A	Castle Nut		1
312	SMH-312A	Split Pin	2.5x20	1
405	SMH-405C	Load Sheave Cover		1
433	SMH-433C	PIN Load Sheave Cover Pin		1
501	SMH-501C	Hand Chain Wheel		1
503	SMH-503C	Brake Cover		1
505	SMH-505C	Disc Cover		1
506	SMH-506C	Ratchet Gear		1
507	SMH-507C	Friction Disc		2
508	SMH-508A	Check Washer		1
510	SMH-510C	Pawl		2
511	SMH-511C	Pawl Pin		2
512	SMH-512B	Pawl Spring		2
514	SMH-514B	Snap Ring	8	2
604	SMH-604C	Chain Stop Bolt Assy		1
940	SMH-940C	Name Plate	1.5 Ton	1
941	SMH-941A	Rivet	2.5 x 6	4
942	187728	Hand Chain*	Ø 5mm	1
943	187726	Load Chain* (1-Ton)	Ø 7mm	1

Parts List: 2-Ton SMH Chain Hoist

Index No.	Part No.	Description	Size	Qty
001	SMH-001D	Top Hook Assembly		1
002	SMH-002D	Gear Side Plate Assembly		1
003	SMH-003D	Wheel Side Plate Assembly		1
007	SMH-007D	Load Sheave		1
007-1	SMHX-007-1D	Snap Ring	38	1
007-2	SMH-007-2C	Roller Kit	60 Rollers	1
015	SMH-015D	Bottom Hook Assembly		1
016	SMH-016D	Safety Latch Assembly		2
023	SMH-023D	Gear Case Assembly		1
024	SMH-024D	Spur Gear Assembly		2
027	SMH-027C	Stripper Assembly		1
105	SMH-105D	Top Hook Pin		1
203	SMH-203D	Stay Bolt		3
205	SMH-205D	Cover Nut		6
206	SMH-206D	Lock Washer		6
206-1	SMH-206-1D	Flat Washer		6
218	SMH-218D	Hand Wheel Cover		1
226	SMH-226C	Anchor Plate		1
301	SMH-301D	Drive Shaft		1
305	SMH-305D	Load Gear		1
308	SMH-308B	Castle Nut		1
312	SMH-312B	Split Pin	3.2 x 25	1
405	SMH-405D	Load Sheave Cover		1
433	SMH-433C	Load Sheave Cover Pin		1
501	SMH-501D	Hand Chain Wheel		1
501A	SMHX-501D	Hand Chain Wheel Assembly (Overload Protection)		1
503	SMH-503D	Brake Cover		1
505	SMH-505D	Disc Hub		1
506	SMH-506C	Ratchet Gear		1
507	SMH-507C	Friction Disc		2
508	SMH-508B	Check Washer		1
510	SMH-510C	Pawl		2
511	SMH-511C	Pawl Pin		2
512	SMH-512B	Pawl Spring		2
514	SMH-514B	Snap Ring	8	1
604	SMH-604D	Chain Stop Bolt Assembly		1
940	SMH-940D	Name Plate	2 Ton	1
	SMHX-940D	Name Plate (Overload Protection)	2 Ton	1
941	SMH-941A	Rivet	2.5 x 6	4
942	187728	Hand Chain*	Ø 5mm	1
943	187723	Load Chain* (2-Ton)	Ø 8mm	1

* Specify required chain length when ordering.

Parts List: 3-Ton SMH Chain Hoist

Index No.	Part No.	Description	Size	Qty
001	SMH-001E	Top Hook Assembly, Complete		1
002	SMH-002E	Gear Side Plate Assembly		1
003	SMH-003E	Wheel Side Plate Assembly		1
007	SMH-007C	Load Sheave		1
007-1	SMHX-007-1D	Snap Ring	38	1
007-2	SMH-007-2C	Roller Kit	60 Rollers	1
015	SMH-015E	Bottom Hook Assembly		1
016	SMH-016E	Safety Latch Assembly		2
023	SMH-023C	Gear Case Assembly		1
024	SMH-024C	Spur Gear Assembly		2
027	SMH-027C	Stripper Assembly		1
105	SMH-105E	Top Hook Pin		1
105-1	SMH-105-1E	Retainer Plate Assembly		1
203	SMH-203C	Stay Bolt		3
205	SMH-205B	Cover Nut		6
206	SMH-206B	Lock Washer		6
206-1	SMH-206-1B	Flat Washer		6
218	SMH-218C	Hand Wheel Cover		1
226	SMH-226C	Anchor Plate		1
301	SMH-301C	Drive Shaft		1
305	SMH-305C	Load Gear		1
308	SMH-308A	Castle Nut		1
312	SMH-312A	Split Pin	2.5 x 20	1
405	SMH-405C	Load Sheave Cover		1
433	SMH-433C	Load Sheave Cover Pin		1
501	SMH-501C	Hand Chain Wheel		1
501A	SMHX-501C	Hand Chain Wheel Assembly (Overload Protection)		1
503	SMH-503C	Brake Cover		1
505	SMH-505C	Disc Hub		1
506	SMH-506C	Ratchet Gear		1
507	SMH-507C	Friction Disc		2
508	SMH-508A	Check Washer		1
510	SMH-510C	Pawl		2
511	SMH-511C	Pawl Pin		2
512	SMH-512B	Pawl Spring		2
514	SMH-514B	Snap Ring	8	1
604	SMH-604E	Chain Stop Bolt Assembly		1
940	SMH-940E	Name Plate	3 Ton	1
	SMHX-940E	Name Plate (Overload Protection)	3 Ton	1
941	SMH-941A	Rivet	2.5 x 6	4
942	187728	Hand Chain*	Ø 5mm	1
943	187726	Load Chain* (3-Ton)	Ø 7mm	1

* Specify required chain length when ordering.

Parts List: 5-Ton SMH Chain Hoist

Index No.	Part No.	Description	Size	Qty
001	SMH-001F	Top Hook Assembly, Complete		1
002	SMH-002F	Gear Side Plate Assembly		1
003	SMH-003F	Wheel Side Plate Assembly		1
007	SMH-007F	Load Sheave		1
007-1	SMH-007-1F	Snap Ring	45	1
007-2	SMH-007-2F	Roller Kit	70 Rollers	1
015	SMH-015F	Bottom Hook Assembly, Complete		1
016	SMH-016F	Safety Latch Assembly		2
023	SMH-023F	Gear Case Assembly		1
024	SMH-024F	Spur Gear Assembly		2
027	SMH-027F	Stripper Assembly		1
105	SMH-105F	Top Hook Pin		1
105-1	SMH-105-1F	Retainer Plate Assembly		1
203	SMH-203F	Stay Bolt		3
205	SMH-205D	Cover Nut		6
206	SMH-206D	Lock Washer		6
206-1	SMH-206-1D	Flat Washer		6
218	SMH-218F	Hand Wheel Cover		1
226	SMH-226F	Anchor Plate		1
301	SMH-301F	Drive Shaft		1
305	SMH-305F	Load Gear		1
308	SMH-308B	Castle Nut		1
312	SMH-312B	Split Pin	3.2 x 25	1
405	SMH-405F	Load Sheave Cover		1
433	SMH-433F	Load Sheave Cover Pin		1
501	SMH-501F	Hand Chain Wheel Assembly		1
501A	SMHX-501F	Hand Chain Wheel Assembly (Overload Protection)		1
503	SMH-503F	Brake Cover		1
505	SMH-505F	Disc Hub		1
506	SMH-506F	Ratchet Gear		1
507	SMH-507F	Friction Disc		2
508	SMH-508B	Check Washer		1
510	SMH-510F	Pawl		2
511	SMH-511F	Pawl Pin		2
512	SMH-512F	Pawl Spring		2
514	SMH-514F	Snap Ring	9	1
604	SMH-604F	Chain Stop Bolt Assembly		1
940	SMH-940F	Name Plate	5 Ton	1
	SMHX-940F	Name Plate (Overload Protection)	5 Ton	1
941	SMH-941A	Rivet	2.5 x 6	4
942	187728	Hand Chain*	Ø 5mm	1
943	187727	Load Chain* (5-Ton)	Ø 9mm	1

* Specify required chain length when ordering.

Parts List: 10-Ton SMH Chain Hoist

Index No.	Part No.	Description	Size	Qty
001	SMH-001G	Top Hook Assy Complete		1
002	SMH-002F	Gear Side Plate Assy		1
003	SMH-003F	Wheel Side Plate Assy		1
007	SMH-007F	Load Sheave		1
007-1	SMH-007-1F	Snap Ring	45	1
007-2	SMH-007-2F	Roller Kit	70 Rollers	1
015	SMH-015G	Bottom Hook Assy Complete		1
016	SMH-016G	Safety Latch Assy		2
023	SMH-023F	Gear Case Assy		1
024	SMH-024F	Spur Gear Assy		2
027	SMH-027F	Stripper Assy		1
105	SMH-105F	Top Hook Pin		1
105-1	SMH-105-1F	Retainer Plate Assy		1
203	SMH-203F	Stay Bolt		3
205	SMH-205D	Cover Nut		6
206	SMH-206D	Lock Washer		6
206-1	SMH-206-1D	Flat Washer		6
218	SMH-218F	Hand Wheel Cover		1
226	SMH-226F	Anchor Plate		1
301	SMH-301F	Drive Shaft		1
305	SMH-305F	Load Gear		1
308	SMH-308B	Castle Nut		1
312	SMH-312B	Split Pin	3.2x25	1
405	SMH-405F	Load Sheave Cover		1
433	SMH-433F	Load Sheave Cover Pin		1
501	SMH-501F	Hand Chain Wheel		1
503	SMH-503F	Brake Cover		1
505	SMH-505F	Disc Hub		1
506	SMH-506F	Ratchet Gear		1
507	SMH-507F	Friction Disc		2
508	SMH-508B	Check Washer		1
510	SMH-510F	Pawl		2
511	SMH-511F	Pawl Pin		2
512	SMH-512F	Pawl Spring		2
514	SMH-514F	Snap Ring	9	2
604	SMH-604G	Chain Stop Bolt Assy		1
940	SMH-940G	Name Plate	10 Tom	1
941	SMH-941A	Rivet	2.5x6	4
942	187728	Hand Chain*	Ø 5mm	1
943	187727	Load Chain* (5-Ton)	Ø 9mm	1

Notes

TEST CERTIFICATE

COMMODITY	Chain Hoist
MODEL	SMHX-
SERIAL NO.	
CAPACITY	_____ Ton
TEST LOAD	_____ Ton
LIFT	_____ ft.
DATE OF INSPECTION	
JUDGEMENT	PASSED
INSPECTOR	

Record your purchase and installation information here

Purchased from: _____ Date: _____
Serial Number: _____ Model Number: _____
Stock Number: _____
Location Installed: _____
Date Installed: _____ Date in Service: _____



WMH Tool Group
2420 Vantage Drive
Elgin, Illinois 60124
Phone: 800-274-6848
www.wmhtoolgroup.com