

QUARTZLITER® SERIES

QL

Cat. #		Approvals
Job	Type	



APPLICATIONS

- Quartz luminaires provide high output, instant on "white light" with low initial investment. Best used for flood applications with short burning hours due to higher energy consumption. Excellent when coupled with motion sensor controls. Great for residential security lighting, temporary work lights or holiday display

SPECIFICATIONS

- Full size, die cast aluminum housing with deep fins. Tool-free die cast aluminum lens/door assembly. Hinged at bottom for positive compression of silicone gasket. Large 1/2" universal swivel knuckle
- 3-piece anodized reflector for wide, uniform beam. Units supplied less lamp. QL 505 (300-500 watt) 120 volt. QL 1505 (1000-1500 watt) lamps available for 1000W-240V; 1500W-208, 240, 277V.
- Available in gray or bronze powder paint finish

LISTINGS

- Listed to UL1598 for use in wet locations

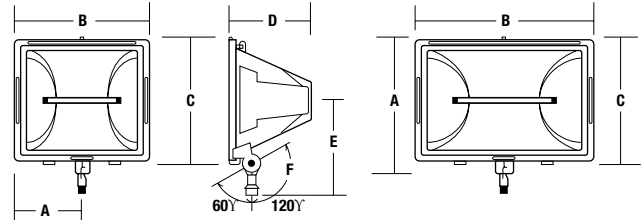

	A	B	C	D	E	F
QL-505	4 ⁵ / ₁₆ "	8 ⁵ / ₈ "	8 ⁷ / ₈ "	5 ¹ / ₄ "	7"	2 ¹ / ₂ "
	109 mm	219 mm	225 mm	133 mm	179 mm	63 mm
QL-1505	11 ¹ / ₂ "	14"	8 ¹ / ₂ "			
	292 mm	355 mm	216 mm			

ORDERING INFORMATION

ORDERING EXAMPLE

QL	-	15		0		5
Series		Wattage		Mounting 1/2" Knuckle		Beam Spread

Catalog Number	Max. Watts	Housing Finish	NEMA Beam Spread H° x V°	Weight lbs. (kg)	EPA ft² (m²)
Lamp Not Included					
QL-1505¹	1000/1500	Gray	6(115°) x 5(78°)	6 (2.7)	.9 (0.1)
QL-505	300/500	Gray	5(88°) x 5(82°)	4 (1.8)	.5 (0.1)
QL-505-BZ	300/500	Bronze	5(88°) x 5(82°)	4 (1.8)	.5 (0.1)
Lamp Included					
QL-1505-L15¹	1500w/240V	Gray	6(115°) x 5(78°)	5.1 (2.3)	.9 (0.1)
QL-505-L05	500w/120V	Gray	5(88°) x 5(82°)	3.5 (1.6)	.5 (0.1)

- Do not aim at ±10° from horizontal or higher
 - Fixture voltage is controlled by lamp voltage rating
- Note: Do not operate on voltage higher than lamp voltage rating, shortens lamp life and increases heat stress within the fixture

REPLACEMENT PARTS

Catalog Number	Description
264-0184-9803	Glass lens QL505
264-0183-9805	Glass lens QL1505
207-5011-0214	Knuckle, gray
800-2666-0108	Replacement Socket QL505
705327	Replacement Socket QL1505

ACCESSORIES - Order Separately

Catalog Number	Description	Weight lbs. (kg)
QL-505 Series		
QL-5G	Wire guard (2 inch square grid)	1 (0.5)
QL-VS	Top/side visor (max use two - at 180°)	.5 (0.2)
QL-1505 Series		
QL-15G	Wire guard (2 inch square grid)	1.3 (0.6)
QL-15V	Top visor / bottom visor	1.3 (0.6)
QL-VS	Side visor (will not work with QL-15V on same fixture)	.5 (0.2)
QL-500 / QL-1500		
QL-TB	Crossarm trunnion box; Half yoke with large wiring box for mounting to any flat surface, natural aluminum	.8 (0.4)
S-302	Pole top slipfitter for 1/2" swivel knuckle; slipfits 2 3/8" OD pipe; gray finish	.8 (0.4)
S-302-M51	Pole-top slipfitter for 1/2" knuckle, slipfits 2 3/8" OD pipe; bronze finish	.8 (0.4)

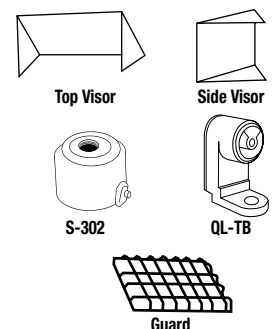

PHOTOMETRICS For additional photometric information and IES downloads, visit our web site at www.hubbell-ltg.com

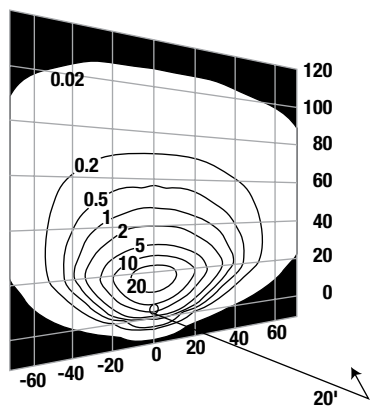

**QUARTZLITER QL
QL-1505**

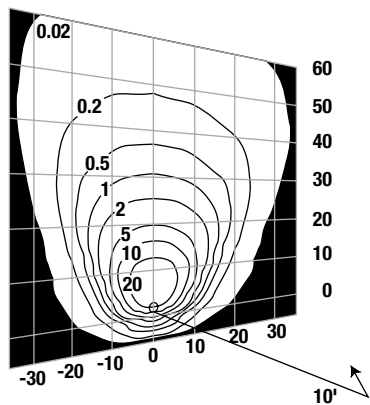

**QUARTZLITER QL
QL-505**

PHOTOMETRIC REPORTS

Catalog Number	Report #
QL505	HP00930.IES
QL1505	HP00854.IES

Due to our continued efforts to improve our products, product specifications are subject to change without notice.



Hubbell Outdoor Lighting • 701 Millennium Boulevard • Greenville, SC 29607 • PHONE: 864-678-1000
For more information visit our web site: www.hubbelloutdoor.com