

Dusk-to-Dawn DDR / DDC Series

INSTALLATION INSTRUCTION FOR DDR/DDC SERIES

READ THOROUGHLY BEFORE INSTALLING

WARNING:

Dangerous voltage exist within these units and all precautions usually observed in handling high voltage equipment should be observed when replacing lamps or otherwise servicing luminaries. Disregarding this warning could result in electrical shock and possible injury to the individual installing or servicing this equipment; all servicing should be done by qualified personnel.

Check the operating temperature limits marked on luminaire prior to installation to be sure it conforms to environmental restrictions identified by local inspection authorities and NEC classifications.

Make certain power is off before starting installation or performing any maintenance. Read lamp manufacturer warning notice on lamp carton before handling or installing. Do not install a damaged lamp.

The type NPD/NPU luminaire is designed for outdoor lighting applications in normal open air ambient and should not be used in limited ventilation or high ambient temperature enclosures. The fixture is shipped complete but partially unassembled to aid in installation. The fixture is designed for mounting on a round wood pole.

INSTALLATION INSTRUCTIONS:

1. When keyhole is provided in mounting arm bracket: Drill 11/16" diameter hole through pole. Put through bolt through pole with nut and washer on opposite side of mounting arm. Insert through bolt head through keyhole in mounting arm bracket and tighten through bolt nut. Secure mounting arm bracket.
2. Feed power supply leads through mounting arm with insulating sleeves installed in head end of leads.
3. Insert head on arm. (Loosen lamp fitter bolts if required). Tighten clamp fitter bolts securely.
4. Connect power supply leads as required. Ground fixture or arm as required.
5. Attach optical assembly to head.
6. Install lamp firmly seated into socket.
7. Loosen screw in photo control replacement. Follow instructions molded into tip of photo control and rotate until arrow points to north tighten screw. Install photo control rotating clockwise to lock into position.

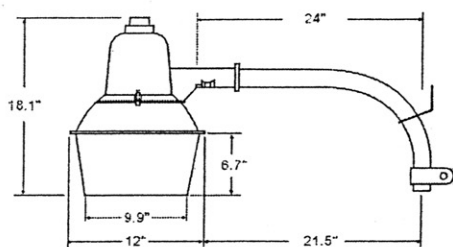

DDR

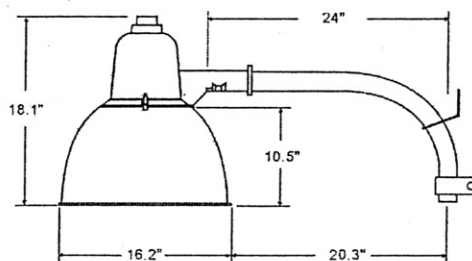

DDC