

Assembly & Installation Instructions



Meridian Post-Mount 34-5610

Page 1 of 4

CAUTION: FAILURE TO INSTALL THIS FIXTURE PROPERLY MAY RESULT IN SERIOUS PERSONAL INJURY OR DEATH AND PROPERTY DAMAGE. We recommend installation by a licensed electrician.

This product must be installed in accordance with applicable installation code(s), by a person familiar with the construction and operation of the product and the hazards involved.*

Caution: Do not exceed maximum wattage noted on fixture. Use only recommended bulbs with fixture.

Note: Fixture, Post and Cover Cap each sold separately

To Install Post (Figure 1)

Component Parts

- | | | | |
|---|----------------------|---|-----------|
| A | J Bolt (4) | G | Set Screw |
| B | Post | H | Fixture |
| C | Flat Washer (4) | | |
| D | Split Washer (4) | | |
| E | Hex Nut (4) | | |
| F | Cover Cap (optional) | | |

Caution: Be sure power is off at the main breaker box prior to installation.

Site Preparation

1. Run appropriate wiring to the site of the fixture, leaving enough excess wire to reach the top of the post, plus 12 inches.
2. Pour flat and level concrete base with wiring emerging at the center. Insert J bolts (A) so approximately 1" of the bolts are exposed above the concrete. Position J bolts according to the template on the last page of these instructions. Allow concrete to cure before installing fixture.

Installation

Note: Post may be cut to desired height before installation.

1. Position post over J bolts allowing supply wire to run up though the post and secure using flat washers (C), split washers (D) and hex nuts (E).
2. Place cover cap (sold separately) (F) over post to conceal mounting hardware.
3. Connect fixture wires to supply wires using appropriate wire connectors (not provided), black to black, white to white and bare copper or green to bare copper or green. If fixture is wired with twin lead lamp cord, connect smooth side of fixture wire to black and ridged side to white.
4. Place fixture (H) onto post carefully tucking all wiring down into post and making sure no wires are pinched between the post and the fixture. Secure with set screw (G).

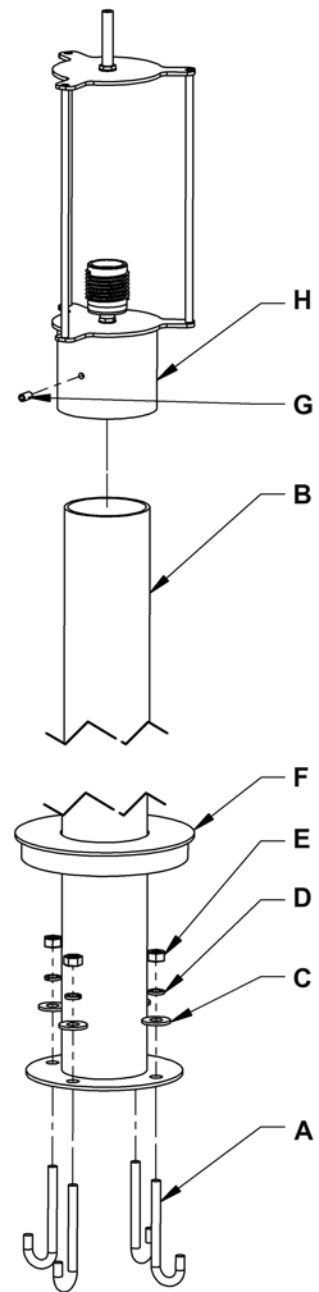

(Figure 1)

(continued)

To Install Inner Glass (Figure 2)

Component Parts

- I Socket
- J Nipple
- K Plate
- L Inner Glass
- Q Threaded Cap

1. Install light bulb (*not included*) into socket (I).
2. Remove threaded cap (Q) from nipple (J). Save for later use.
3. Place plate (K) over nipple (J) followed by inner glass (L).
4. Inner glass installation complete.

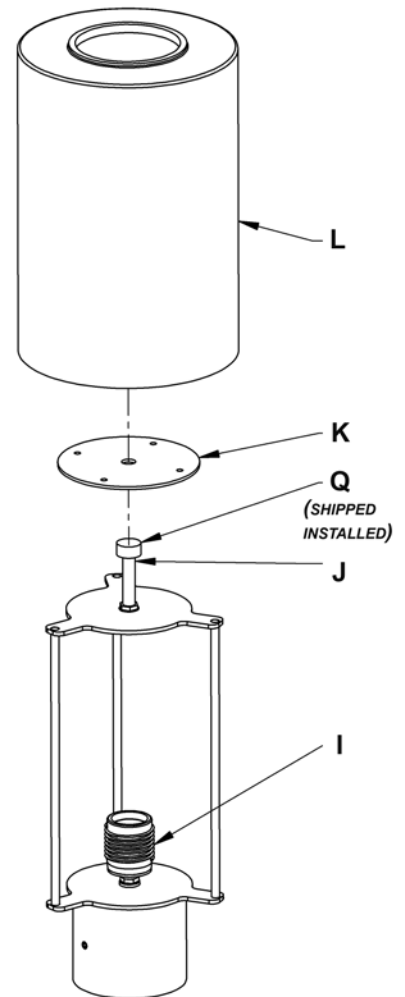

(Figure 2)

To Install Outer Glass (Figures 3 & 4)

Component Parts

- M 8-32 x 3/8" Screws (3)
- N Spider Assembly
- O Outer Glass
- P Top Cap

1. Loosen screws (M) so that spider assembly (N) will turn clock wise. It is not necessary to completely remove the screws (M) from fixture. Once spider assembly (N) is loose turn until it slips over the heads of the screws (M). Set aside for step 2 (Figure 4).
2. Slip glass (O) over spider assembly (N).
3. Place top cap (P) over glass (O) aligning screws (M) into slots. Turn the top cap counter clockwise until it stops.
4. Tighten screws (M).
5. Outer glass installation is complete.

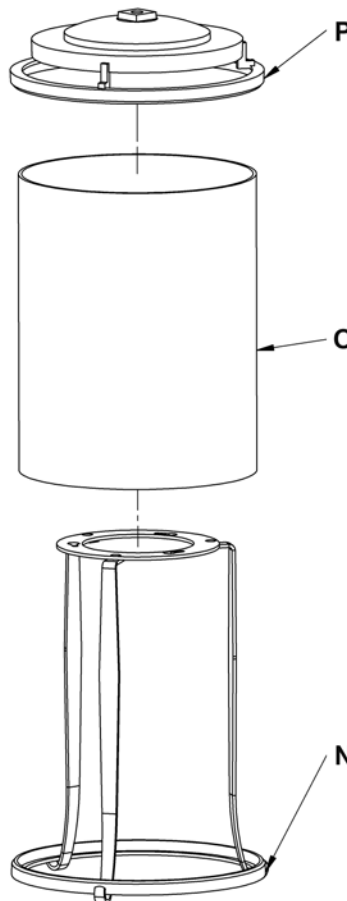

(Figure 3)

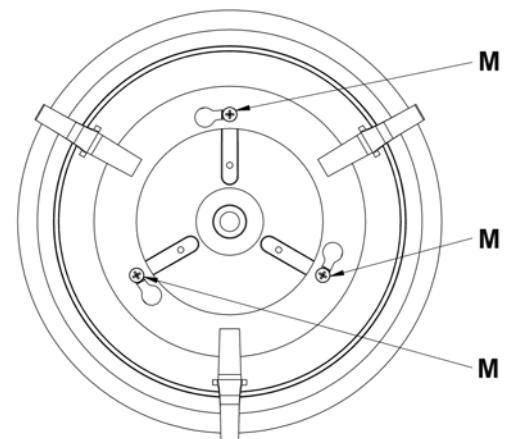

(Figure 4)

(continued)

Install Outer Glass Assemble Over Inner Glass Assemble (Figures 5 & 6)

Component Parts

- H Fixture
- N Spider Assembly
- J Nipple
- S Outer Glass Assembly
- R Rubber Washer
- Q Threaded Cap

1. Slide outer glass assembly (S) over nipple (J) (Figure 5).
2. Position rods within the fixture (H) so they are in line with spider assembly (N) (Figure 6).
3. Place rubber washer (R) over nipple (J).
4. Thread cap (Q) on to nipple (J).
5. Restore electricity at the main breaker.

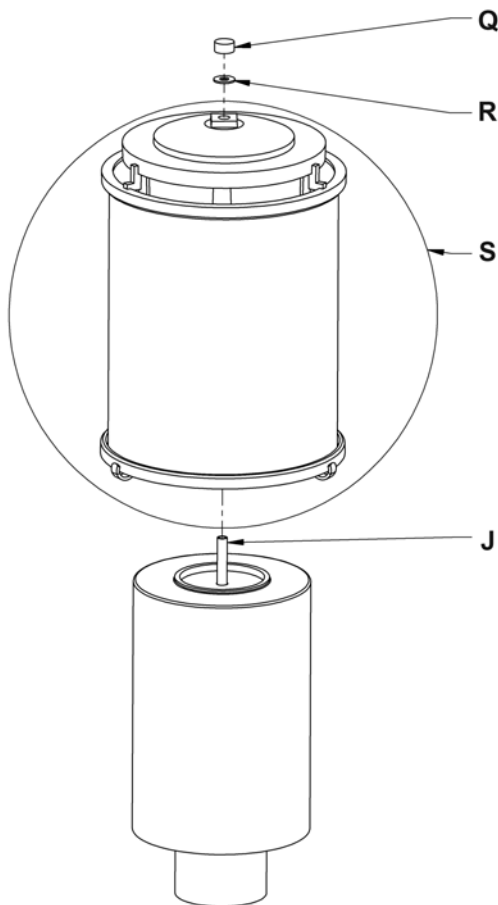

(Figure 5)

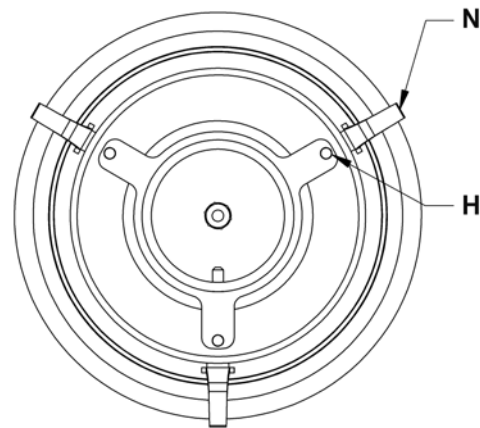

(Figure 6)

(continued)

Assembly & Installation Instructions



Meridian Post-Mount 34-5610

Page 4 of 4

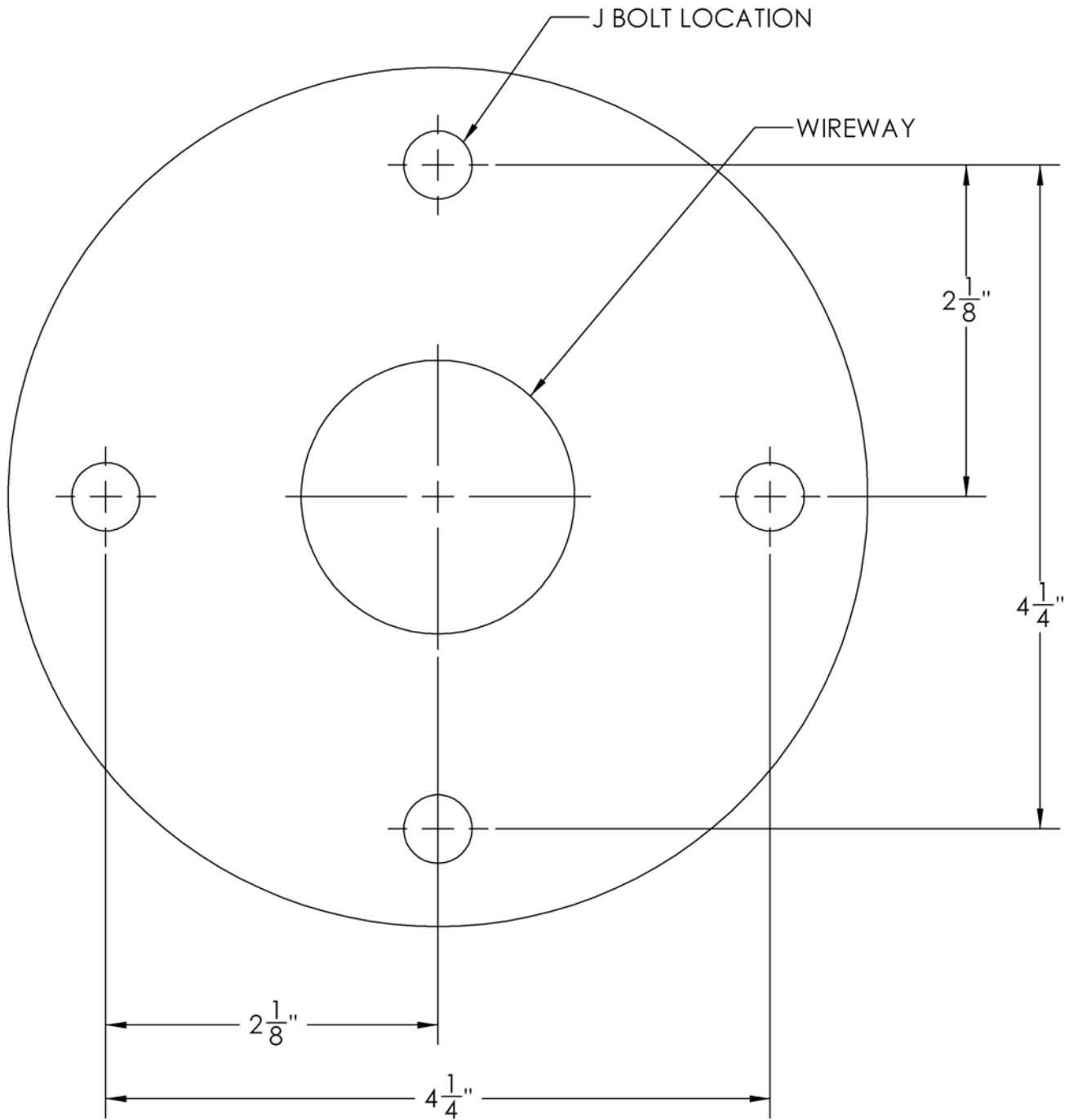

Use this template to position J bolts and wireway in concrete slab prior to installing outdoor post mounted lighting fixture.

If you need further assistance, or find that you are missing any parts, please contact the dealer from which you purchased this product. We hope you enjoy your fixture!

* Hubbardton Forge will not be liable for injury or damage caused by improper installation, lamping or use of this fixture.