

Family: Cooper | Item No. 4682

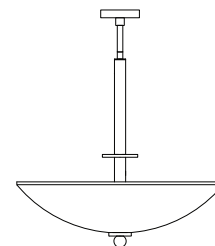

Drawing 1 - Assembly

▼ start here

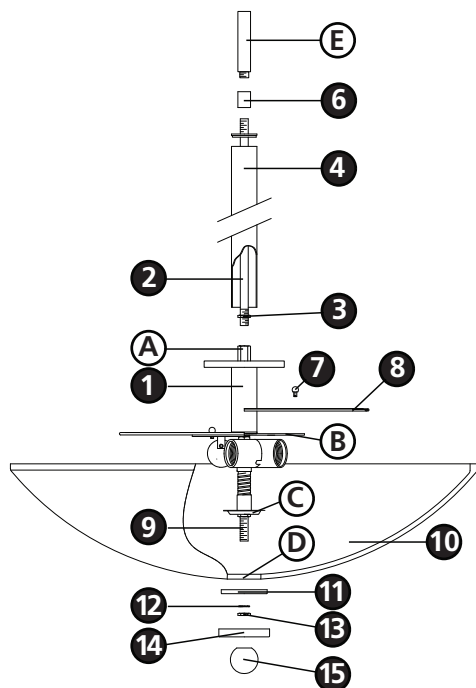

1

1. Find a clear area in which you can work.
2. Unpack fixture and glass from carton.
3. Carefully review instructions prior to assembly.

*** The construction of this fixture will be accomplished by first assembling the main body of the fixture, determining rod length, assembling the rods, attaching mounting assembly, hanging the fixture from the ceiling and then installing the glass.

SAFETY WARNING: READ WIRING AND GROUNDING INSTRUCTIONS (I.S. 18) AND ANY ADDITIONAL DIRECTIONS. TURN POWER SUPPLY OFF DURING INSTALLATION. IF NEW WIRING IS REQUIRED, CONSULT A QUALIFIED ELECTRICIAN OR LOCAL AUTHORITIES FOR CODE REQUIREMENTS.

2

1. To assemble the main body (1), first slip center stem (2) along wire and thread into coupler (A) approximately 3/8". Thread hex nut (3) down and tighten against coupler (A) to lock center stem in position.
2. Slip center tube (4) over center stem (2), followed by tube cap (5).
3. Slip coupler (6) along wire and thread onto end of center stem (2) to finish column assembly.
4. To install diffuser (8), remove ball knobs (7) from socket cover plate (B).
5. Line up holes in diffuser (8), with rolled edge facing down, with holes in socket cover plate (B) and thread ball knobs (7) back into holes to secure diffuser.
6. It is now necessary to determine the total lengths of rods (E) you will require to hang your fixture at the desired height. Fixture is supplied with a 4", 6", 12" and 24" rod.
7. After determining the rod lengths needed, slip them along the wire and thread the first rod into coupler (A). All subsequent rods (E) thread into each other.
8. Please refer to the hanging instruction sheet (I.S. 19-81) provided to hang fixture. Then refer back to this sheet to install glass.

3

1. To install glass (10), locate the large center hole (D) in the glass, onto the mounting plate (C) and hold in position. Assistance during the following steps recommended.
2. Slip cap (11) onto threaded center stem (9), followed by lockwasher (12). Hold parts and glass in position.
3. Thread hex nut (13) onto center stem (9) and tighten to secure glass.
4. Slip bottom cap (14) onto center stem (9) and hold in position.
5. Thread ball knob (15) onto end of center stem (9) and tighten to complete assembly.

Note: Maximum wattage for 4682 fixture is 100 watts per bulb.

10.15.10