

Family: Bloom | Item No. 4374 PL

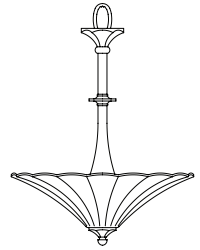

Drawing 1 - Fixture Assembly

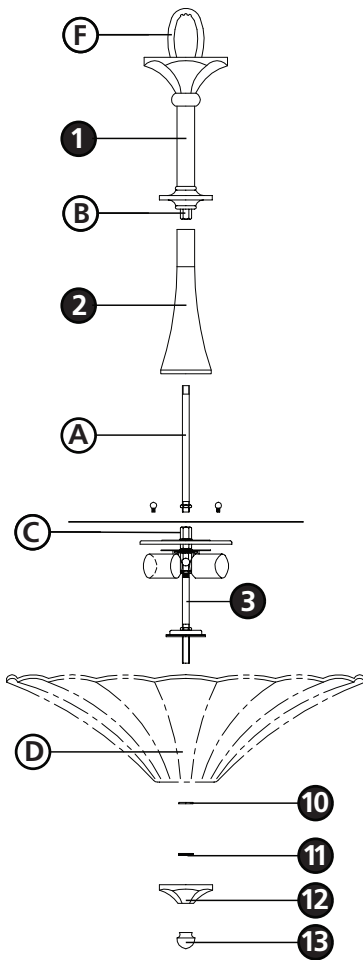

## ▼ start here

1

1. Find a clear area in which you can work.
2. Unpack fixture and glass from carton.
3. Carefully review instructions prior to assembly.

**\*\*\* the construction of this fixture will be accomplished by first assembling the main body of the fixture, making all necessary electrical connections, hanging the fixture from the ceiling and then installing the glass.**

**SAFETY WARNING: READ WIRING AND GROUNDING INSTRUCTIONS (I.S. 18) AND ANY ADDITIONAL DIRECTIONS. TURN POWER SUPPLY OFF DURING INSTALLATION. IF NEW WIRING IS REQUIRED, CONSULT A QUALIFIED ELECTRICIAN OR LOCAL AUTHORITIES FOR CODE REQUIREMENTS.**

2

1. Thread center stem (A) into coupler (C), located in the center of the socket assembly (3), approximately 1/4" - see **Drawing 1**
2. Slip center column (2) along wire and over center stem (A).
3. Attach assembly (1) by threading coupler (B) onto center stem (A). Thread on loop (F) and tighten.
4. Please refer to **I.S. 19** to properly hang fixture from ceiling. Then refer back to this sheet to continue installation of this fixture.

3

1. Slip glass (D) onto center stem (3) and hold in position - see **Drawing 1**.
2. Slip flat washer (10) onto center stem (3) and hold in position.
3. Thread hex nut (11) onto center stem (3) and tighten to secure glass to fixture.
4. Slip glass cap (12) onto center stem (3) and hold in position.
5. Thread finial (13) onto end of center stem (3) and tighten.

Note: Maximum wattage for 4374 fixture is 75 watts per bulb.

1.26.09