

Family: Thistledown | Item No. 4173 VZ

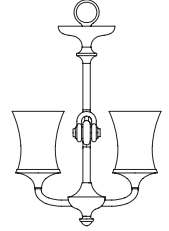

Drawing 1 - Fixture Assembly

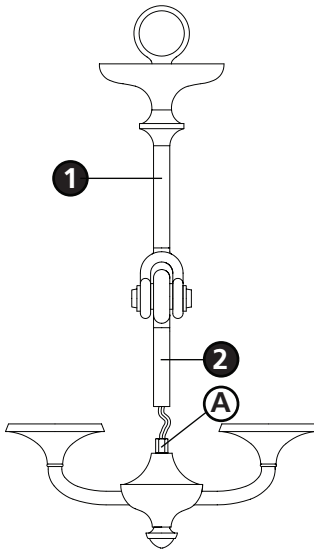

Drawing 2 - Glass Installation

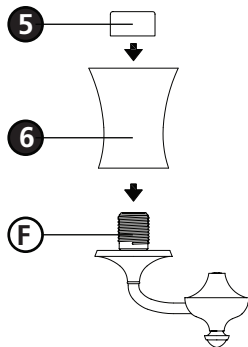

▼ start here

1

1. Find a clear area in which you can work.
2. Unpack fixture and glass from carton.
3. Carefully review instructions prior to assembly.

***** The construction of this fixture will be accomplished by first assembling the main body of the fixture, making all necessary electrical connections, hanging the fixture from the ceiling, and then installing the glass.**

SAFETY WARNING: READ WIRING AND GROUNDING INSTRUCTIONS (I.S. 18) AND ANY ADDITIONAL DIRECTIONS. TURN POWER SUPPLY OFF DURING INSTALLATION. IF NEW WIRING IS REQUIRED, CONSULT A QUALIFIED ELECTRICIAN OR LOCAL AUTHORITIES FOR CODE REQUIREMENTS.

2

1. To assemble main body, slip bottom tube (2) along wire and thread into coupler (A) - see **Drawing 1**.
2. Thread top column (1) onto bottom column (2).
3. Please refer to the hanging instruction sheet (I.S. 19) provided to hang this fixture. Then refer back to this sheet to install the glass.

3

1. To install glass, remove socket ring (5) from socket (F) - see **Drawing 2**.
2. Slip glass (6) over socket (F).
3. Thread socket ring (5) on socket (F). Hand tightening only.
Note: Over tightening ring, using a tool, may cause damage to glass.
4. Fixture can now be lamped accordingly.

Note: Maximum wattage for 4173 fixture is 75 watts per bulb.

2.7.08