

## INSTALLATION/ RETRO FIT STEPS

1. IF REPLACING AN EXISTING EYEWASH ASSEMBLY WITH SP65 FOLLOW STEPS 2 THROUGH 5  
IF INSTALLING SP65 ON NEW UNIT FOLLOW STEPS 3 THROUGH 5  
NOTE: SP65 COMES ASSEMBLED AS AN EYE/FACE WASH.

- 2 REMOVE EXISTING EYEWASH BY SPINNING EYEWASH TEE COUNTER CLOCKWISE.  
DO NOT REMOVE BRASS NIPPLE FROM BOWL HOLDER.
- 3 PLACE SP65 ADAPTER THROUGH DUST COVER LOOP. THREAD SP65 ADAPTER ONTO  
BRASS NIPPLE UNTIL SNUG AGAINST STRAINER.
- 4 THREAD SP65 ONTO ADAPTER. ORIENT TAB TOWARDS THE BACK (AWAY FROM USER).  
DO NOT OVER-TIGHTEN.
- 5 PLACE DUST COVER ONTO EYE/FACE WASH

EYE/FACE WASH HEAD SHOWN WITHOUT DUST COVER

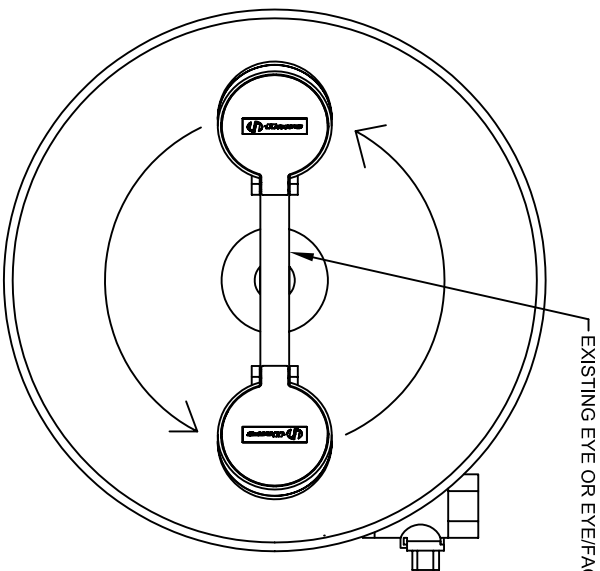
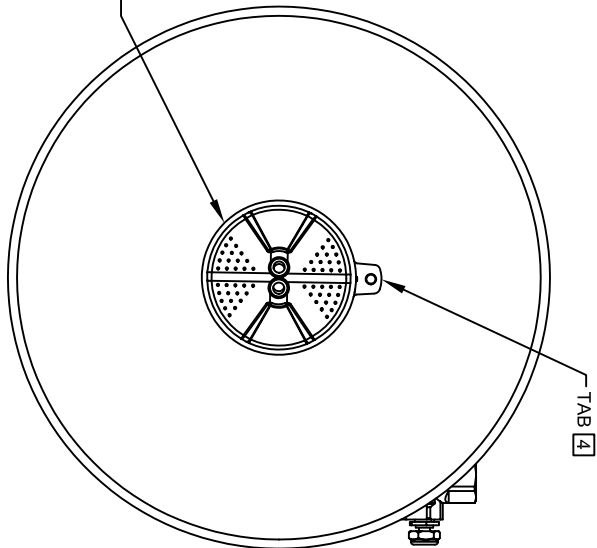

EXISTING EYE OR EYE/FACE WASH ASSEMBLY [2]

BOWL ASSEMBLY  
(SHOWN FOR REFERENCE ONLY)

[3] (EXISTING) STRAINER

(EXISTING) BOWL HOLDER

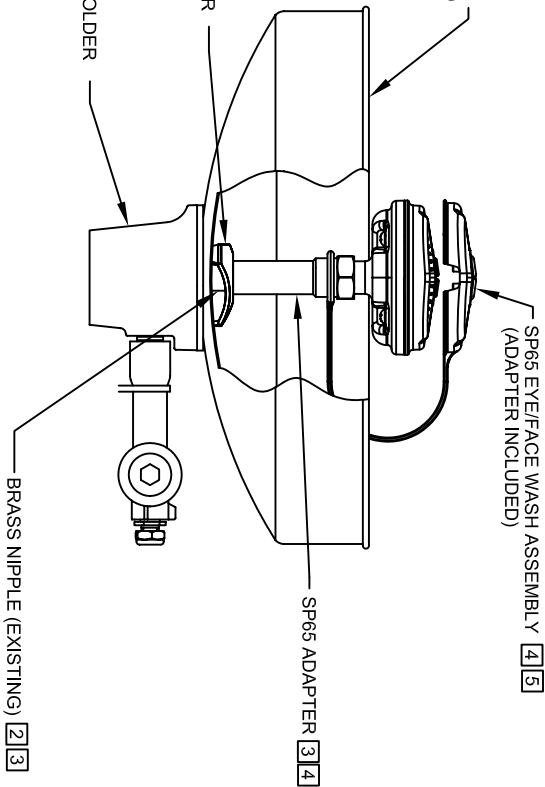

SP65 EYE/FACE WASH ASSEMBLY [4] [5]  
(ADAPTER INCLUDED)

SP65 ADAPTER [3] [4]

BRASS NIPPLE (EXISTING) [2] [3]

SEE SHEET 2 OF 2  
FOR FLOW CONTROL  
CLEANING STEPS



1455 KLEPPE LANE  
SPARKS, NEVADA 89431  
(775) 359-4712 FAX (775) 359-7424  
E-MAIL: HAWS@HAWS.CO.COM  
WEBSITE: WWW.HAWS.CO.COM

DESIGN: 4108	REVISION: 1	DATE: 04/24/08	BY: HNL	MODEL(S):	SP65 AXION EYE/FACE WASH	DATE: 04/24/08	BY: HNL
APPROVED: IR	DATE: 04/24/08	INFO FAX DOC #:	27765	INSTALLATION/FAXBACK		DATE: 04/24/08	BY: HNL
				SIZE: A	SHEET: 1 OF 2		

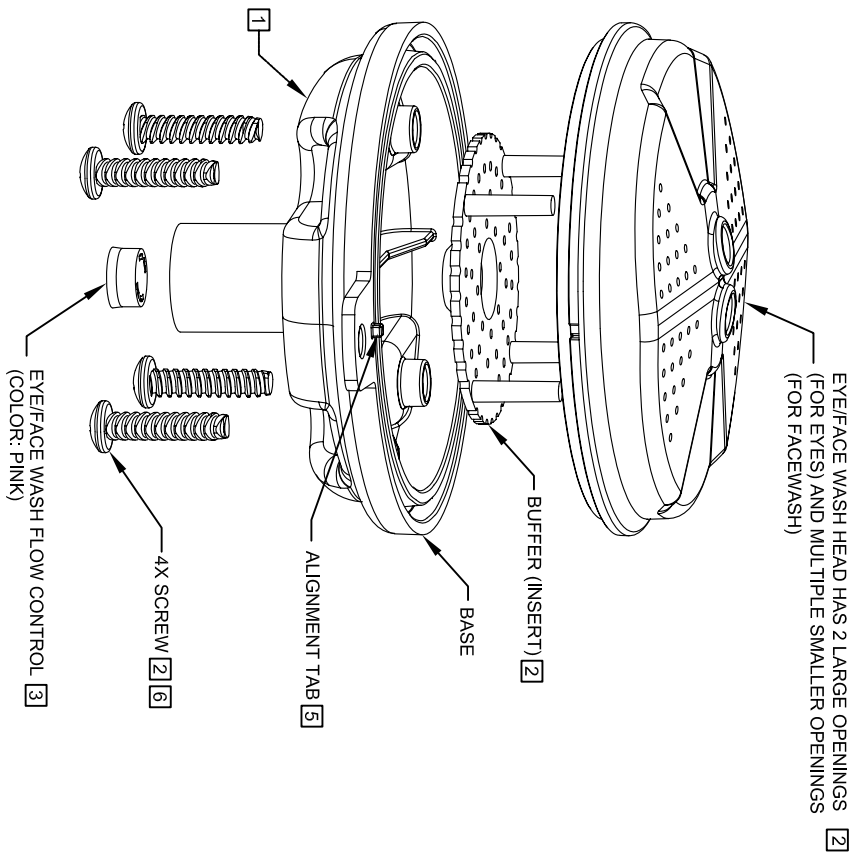

FLOW CONTROL SHOWN IN PLACE  
NOTE: PRESS FLOW CONTROL IN  
UNTIL IT BOTTOMS OUT

3 DETAIL A

