

Ecostat 1001 SL
13241XX1

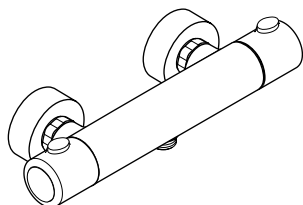

Ecostat 1001 SL
13261XX1

hansgrohe

Ecostat 1001 SL Thermostatic Exposed Tub Filler

13241XX1

Ecostat 1001 SL Thermostatic Exposed Shower Fitting

13261XX1

13241XX1

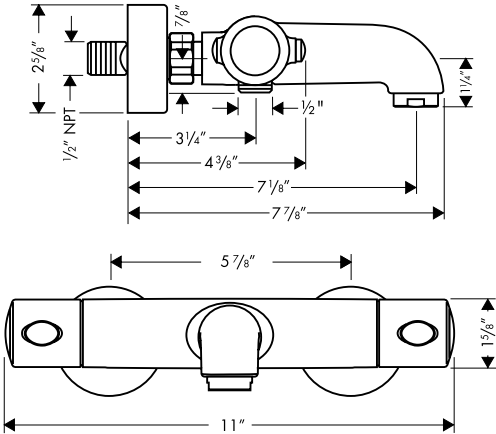

13261XX1

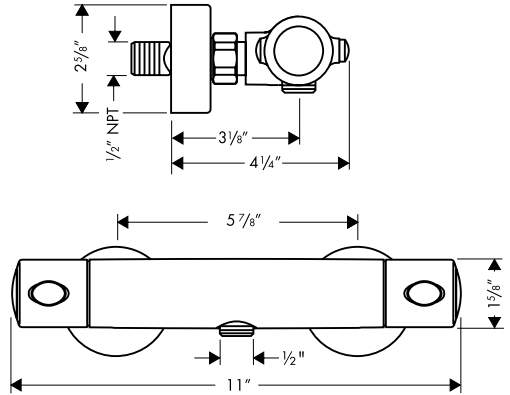

Technical Data

Operating pressure: max. 145 psi
Recommended operating pressure: 14.5 - 72 psi
Hot water temperature: 120° F - 140° F*
Rate of flow at 45 psi: 5.3 gpm

Protection against back siphonage provided by check valves in the hot and cold inlets and on the handshower outlet.

The high temperature limit stop may be reset to comply with local plumbing codes. See page 5.

*Please know and follow all applicable local plumbing codes when setting the temperature on the water heater. In Massachusetts, the water heater may be set no higher than 112°F.

Installation considerations

Large differences in pressure between the hot and cold water supplies should be balanced

Flush the supplies thoroughly of building debris before installing this unit.

The offset adapters included with this unit require 1/2" female fittings, recessed 3/16" behind the surface of the finished wall.

Rough-in

Install 1/2" female fittings, recessed 3/16" behind the surface of the finished wall, for the hot and cold water supplies. The fittings should be 5 7/8" apart on center.

For proper operation of the thermostatic mixer, the hot supply **must** be on the left and the cold supply **must** be on the right.

Install the finished wall. Make sure that the wall is watertight.

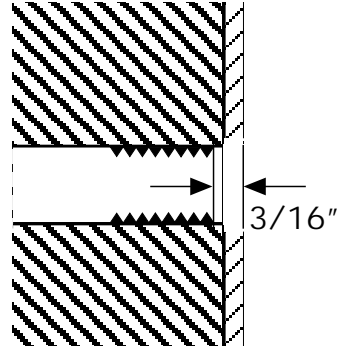

Installation

Wrap the inlet threads on the offset adapters with Teflon thread tape. Screw the offset adapters into the female fittings in the wall. When finished, the outlets of the offset adapters should be 5 7/8" apart on center, should be level, and should extend 1 3/8" outside the surface of the finished wall.

Seal the wall around the offset adapters with waterproof sealant.

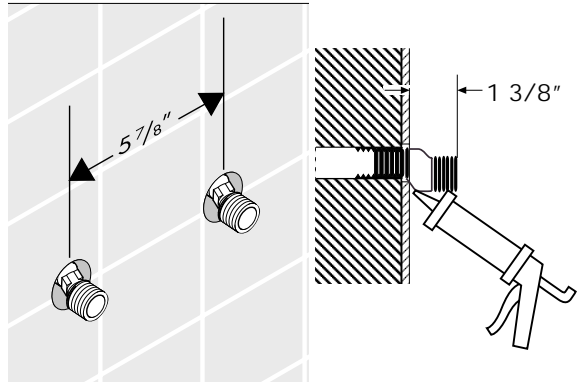

Screw the escutcheons over the offset adapters to the wall. Position the Ecostat 1001 SL over the offset adapters. Secure the Ecostat 1001 SL to the adapters by rotating the nuts clockwise.

Install the handshower check valve and washer.

Install the handshower and hose (not included).

Reset the high temperature limit stop, if required to comply with local plumbing codes. See page 5.

Justify the thermostatic mixer handle. See page 4.

13261XX1 only: Reset the Ecostop, if desired, to limit the flow of water to the handshower to 2.6 gpm. See page 6.

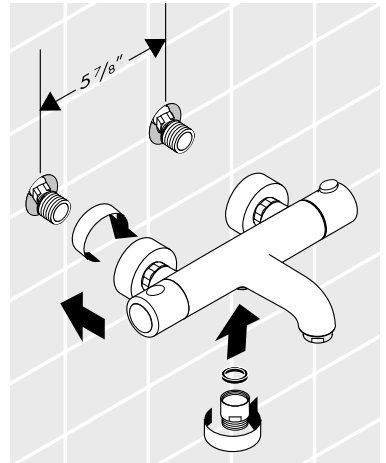

Justify the Thermostatic Mixer Handle:

Turn the water on. Turn the thermostatic mixer handle until the output water is 100°F. Turn the water off.

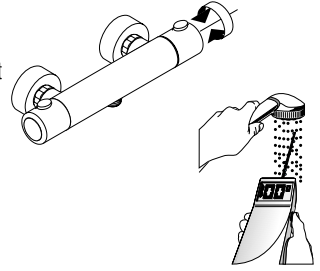

Remove the screw cover.

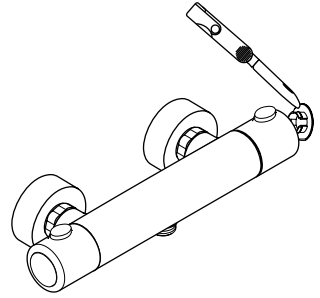

Remove the handle and safety set.

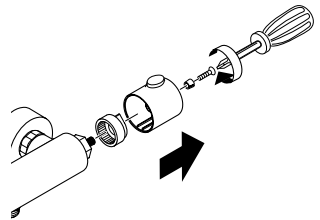

Reinstall the safety set so that it is oriented as shown in the diagram.

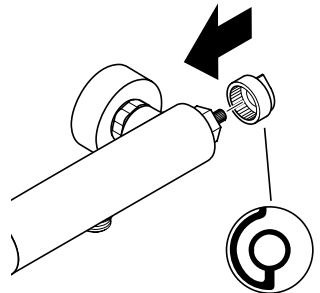

Reinstall the handle with the override button at the 12:00 position.

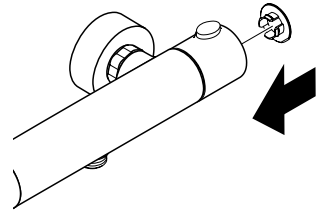

Reset the High Temperature Limit Stop (optional)

The high temperature limit stop may be reset to comply with local plumbing codes.

Remove the thermostatic mixer handle and safety step.

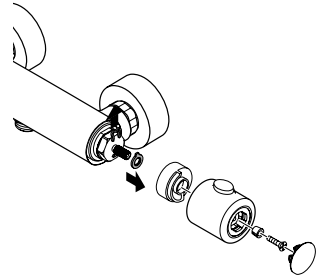

Remove the high temperature limit stop clip and ring.

Turn the water on. Turn the thermostatic mixer stem until the output water is the desired high temperature (usually 110°F). Turn the water off.

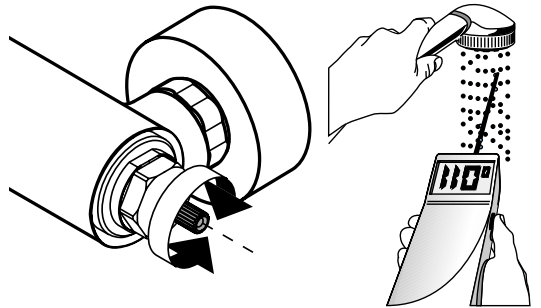

Replace the high temperature limit stop ring so that the tooth is against the stop. Replace the clip.

Justify and install the handle.

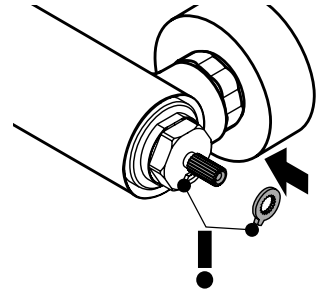

Set the EcoStop (model 13261XX1 only)

Remove the screw cover.

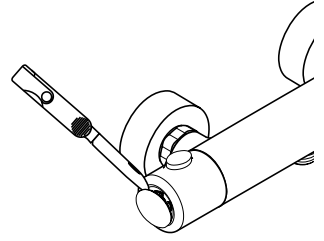

Remove the volume control / diverter handle and the flow control stop.

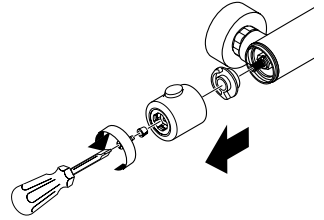

Turn the volume control stem until the flow rate is approximately 2.6 gpm.

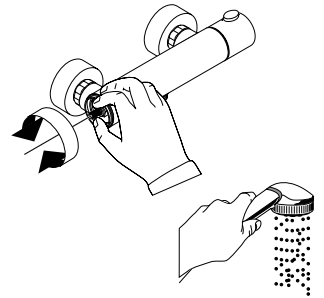

Install the ecostop ring so that it is oriented as shown in the diagram.

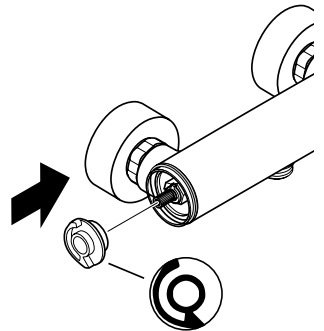

Reinstall the handle and screw cover.

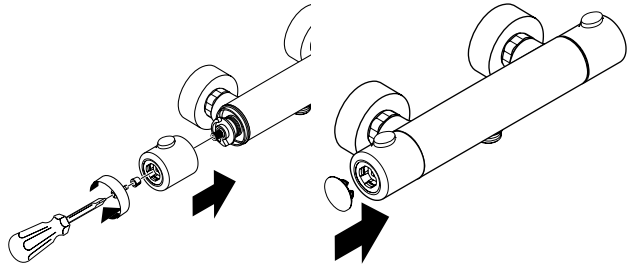

User Instructions

Using the thermostatic mixer:

Turn the handle to change the temperature of the water. Turn the handle clockwise to make the water cooler, counter-clockwise to make the water warmer. When making the water warmer, the handle will stop when the output water is 100°F. To obtain water warmer than 100°F, press the safety stop override button and continue turning the handle counter-clockwise.

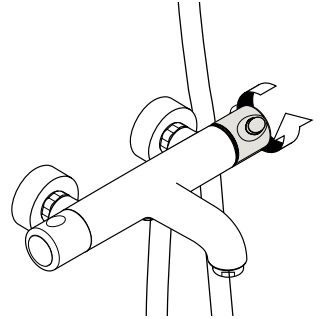

13241XX1: The volume control handle controls the volume of water and diverts the water between the tub spout and the handshower. Turn the handle to turn the water on and off from the tub spout.

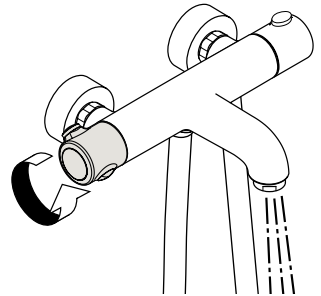

To turn the handshower on and off, press and hold the diverter button while turning the handle.

13261XX1: The volume control handle turns the water on and off to the handshower and controls the volume. The handle will stop when the amount of water coming from the valve is 2.6 gpm. If more water is desired, press the green button and continue turning the handle. **Note to US users:** by law, all handshowers sold in the US are flow restricted to 2.5 gpm.

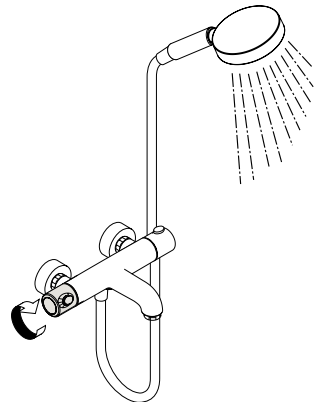

Replacement Parts

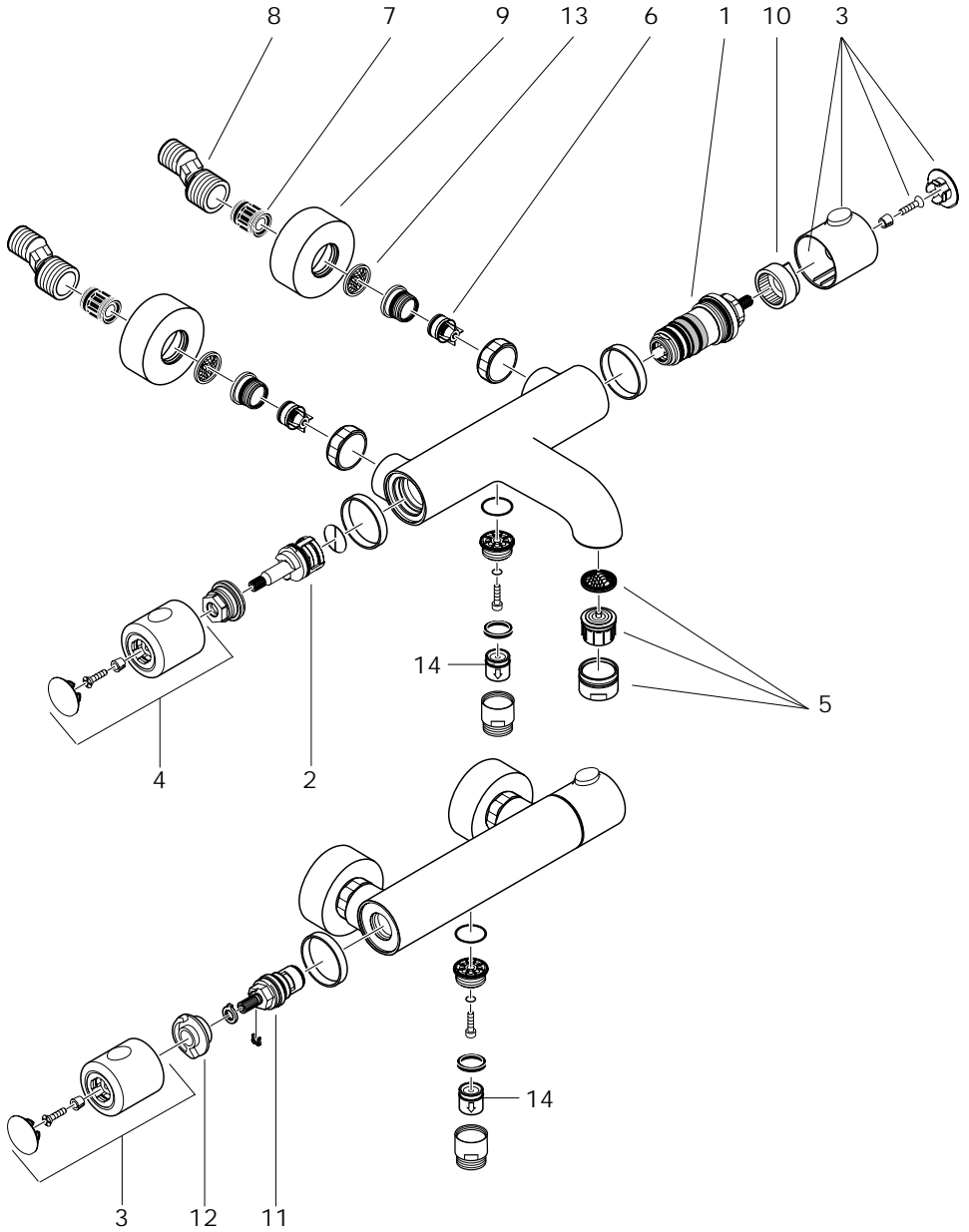

1	thermoelement	94282000
2	shut off and diverter unit	96509000
3	knob for thermoelement	96618XX0
4	knob for shut off and diverter unit	96619XXX
5	aerator cpl.	13485000
6	check valve	96737000
7	noise reduction	96429000
8	offset adapters	94140001
9	escutcheon	96467XXX
10	safety set for temperature control	95041000
11	shut off unit	94149000
12	ecostop ring	95042000
13	filter packing	96922000
14	check valve	94074000

XXX = Colors

001 chrome
801 steel
811 satinox
821 brushed nickel

Troubleshooting

Problem	Possible Cause	Solution
Insufficient water	- Supply pressure inadequate - Filters are dirty	- Check water pressure - Clean filters in front of the mixer and on the thermostat cartridge
	- Screen washer dirty	- Clean screen washer between shower and hose
Crossflow, hot water is forced into cold water pipe, or vice versa, when mixer is closed	- Check valves dirty or leaking	- Clean check valves, exchange if necessary
Spout temperature does not correspond with the temperature set	- Thermostat handle has not been justified	- Justify the handle
Temperature does not regulate	- thermo cartridge calcified	- Exchange thermo cartridge
Shower or spout dripping	- Dirt or sediment on valve seat, shut-off unit damaged	- Clean or exchange shut-off unit
Instantaneous water heater doesn't work with thermostat	- Ecostop ring isn't removed	- Remove ecostop ring
	- Filters are dirty	- Clean the filter/exchange filters
	- Check valves dirty or faulty	- Exchange check valves
Unit outputs both hot and cold water, but not mixed water.	- Unit is cross-piped	- Re-pipe. Make sure that the hot supply is on the left and the cold supply is on the right. No reversing cartridge is available.

Cleaning Recommendation for Hansgrohe Products

Modern faucetry and shower products utilize a combination of materials to comply with the needs of the market with regard to design and functionality.

To avoid damage, it is necessary to use some caution when cleaning. Damage caused by improper treatment is not covered under the Hansgrohe warranty.

Cleaning Materials for Faucets and Showers

- To remove lime scale, use only products made specifically for that purpose. Always follow the manufacturer's instructions when using.
- Do not use cleaners that contain hydrochloric, formic, acetic, or phosphoric acids, as these will cause considerable damage to finishes and to plastic components.
- Never mix cleaning materials.
- Never use cleaners containing abrasives. Do not use abrasive cleaning cloths, pads, or sponges.

Cleaning Procedures

- Clean your faucets and shower products as and when required. Regular cleaning will prevent scale buildup and water spotting.
- Follow the label instructions. Do not allow any cleaner to remain on the product for longer than necessary.
- When using spray cleaners, spray first onto a sponge or cloth – do not spray directly onto the product.
- After cleaning, rinse thoroughly with clear water to remove any cleaner residue.

Important

- Soap and shampoo residue can also cause damage to the product. Rinse well with clean water after use.
- If the surface is already damaged, harsh cleaning materials will cause further damage.

Limited Lifetime Consumer Warranty

This product has been manufactured and tested to the highest quality standards by Hansgrohe, Inc. ("Hansgrohe"). This warranty is limited to Hansgrohe products which are purchased by a consumer in the United States after March 1, 1996, and installed in either the United States or Canada.

WHO IS COVERED BY THE WARRANTY

This warranty extends to the original consumer purchaser only.

WHAT IS COVERED BY THE WARRANTY

This warranty covers only your Hansgrohe manufactured product. Hansgrohe warrants this product against defects in material or workmanship as follows: Hansgrohe will repair at no charge for parts only or, at its option, replace any product or part of the product which proves defective because of improper workmanship and/or material, under normal installation, use, service and maintenance. If Hansgrohe is unable to provide a replacement and repair is not practical or cannot be timely made, Hansgrohe may elect to refund the purchase price in exchange for the return of the product.

LENGTH OF WARRANTY

Replacement or repaired parts of products will be covered for the term of this warranty as stated in the following two sentences. If you are a consumer who purchased the product for use primarily for personal, family, or household purposes, this warranty extends for as long as you own the product and the home in which the product is installed. If you purchased the product for use primarily for any other purpose, including, without limitation, a commercial purpose, this warranty extends only (i) for 1 year, with respect to Interaktiv and Retroaktiv products, and (ii) for 5 years, with respect to AXOR, ShowerPower and Pharo products.

THIS WARRANTY DOES NOT COVER, AND HANSGROHE WILL NOT PAY FOR:

- A. Conditions, malfunctions or damage not resulting from defects in material or workmanship.
- B. Conditions, malfunctions or damage resulting from (1) improper installation, improper maintenance, misuse, abuse, negligence, accident or alteration, or (2) the use of abrasive or caustic cleaning agents or "no rinse" cleaning products, or the use of the product in any manner contrary to the product instructions.
- C. Labor or other expenses for the disconnection or return of the product for warranty service, or for installation or reinstallation of the product.
- D. Accessories or related products not manufactured by Hansgrohe.

TO OBTAIN WARRANTY SERVICE

Contact your Hansgrohe retailer, or write to Technical Service at:

Hansgrohe Inc.
1492 Bluegrass Lakes Parkway
Alpharetta GA 30004

Or, call Hansgrohe toll-free at (800) 334-0455.

In requesting warranty service, you will need to provide

- 1. The sales receipt or other evidence of the date and place of purchase.
- 2. A description of the problem.
- 3. Delivery of the product or the defective part, postage prepaid and carefully packed and insured, to Hansgrohe Inc. 1492 Bluegrass Lakes Parkway, Alpharetta, Georgia 30004, Attention: Technical Service, if required by Hansgrohe.

When warranty service is completed, any repaired or replacement product or part will be returned to you postage prepaid.

EXCLUSIONS AND LIMITATIONS

REPAIR OR REPLACEMENT (OR, IN LIMITED CIRCUMSTANCES, REFUND OF THE PURCHASE PRICE) AS PROVIDED UNDER THIS WARRANTY IS THE EXCLUSIVE REMEDY OF THE PURCHASER. HANSGROHE NEITHER ASSUMES NOR AUTHORIZES ANY PERSON TO CREATE FOR IT ANY OBLIGATION OR LIABILITY IN CONNECTION WITH THIS PRODUCT.

HANSGROHE SHALL NOT BE LIABLE TO PURCHASER OR ANY PERSON FOR ANY INCIDENTAL, SPECIAL, OR CONSEQUENTIAL DAMAGES, ARISING OUT OF BREACH OF THIS WARRANTY OR ANY IMPLIED WARRANTY (INCLUDING MERCHANTABILITY).

Some States do not allow the exclusion or limitation of incidental or consequential damages, so the above limitation or exclusion may not apply to you.

This warranty gives you specific legal rights, and you may have other rights which vary from State to State.

You may be required by law to give us a reasonable opportunity to correct or cure any failure to comply before you can bring any action in court against us under the Magnuson-Moss Warranty Act.

PRODUCT INSTRUCTIONS AND QUESTIONS

Upon purchase or prior to installation, please carefully inspect your Hansgrohe product for any damage or visible defect. Prior to installing, always carefully study the enclosed instructions on the proper installation and the care and maintenance of the product. If you have questions at any time about the use, installation, or performance of your Hansgrohe product, or this warranty, please call or write to us at the toll-free number and address printed above.

hansgrohe

Hansgrohe, Inc. • 1490 Bluegrass Lakes Parkway • Alpharetta, GA 30004
Tel. 770 360-9880 • Fax 770 360 9887

www.hansgrohe-USA.com